

COUNTY OF HAWAII - STATE OF HAWAII

ORDINANCE NO. 84 38

AN ORDINANCE AMENDING SECTION 25-92 (HAWI-KAPAAU ZONE MAP), ARTICLE 3, CHAPTER 25 (ZONING CODE) OF THE HAWAII COUNTY CODE, BY CHANGING THE DISTRICT CLASSIFICATION FROM SINGLE FAMILY RESIDENTIAL (RS-15) TO VILLAGE COMMERCIAL (CV-10) AT KAAUHUHU, NORTH KOHALA, HAWAII, COVERED BY TAX MAP KEY 5-5-09:57.

BE IT ORDAINED BY THE COUNCIL OF THE COUNTY OF HAWAII:

SECTION 1. Section 25-92, Article 3, Chapter 25 (Zoning Code) of the Hawaii County Code, is amended to change the district classification of property described hereinafter as follows:

The district classification of the following area situated at Kaauhuhu, North Kohala, Hawaii, shall be Village Commercial (CV-10):

All that certain parcel of land situated at Kaauhuhu, North Kohala, Island and State of Hawaii, being Lot 187, area 15,546 square feet, as shown on Map 33, filed in the Office of the Assistant Registrar of the Land Court of the State of Hawaii with Land Court Application 1120 of Kohala Sugar Company, being land described in Transfer Certificate of Title No. 230440.

All as outlined in red on the map attached hereto, marked Exhibit "A" and by reference made a part hereof.

SECTION 2. This change in district classification is conditioned upon the following: (A) the petitioner, successors or its assigns shall be responsible for complying with all of the stated conditions of approval; (B) the requirements of the

State Department of Health be complied with; (C) should any other commercial use of the property be contemplated, plans for such a use shall be submitted to the Planning Department for plan approval. At that time, additional conditions such as restriction of access to the property and landscaping will be imposed; and (D) all other applicable rules, regulations and requirements shall be complied with. Should any of the foregoing conditions not be met, rezoning of the area to its original or more appropriate designation may be initiated.

SECTION 3. In the event that any portion of the ordinance is declared invalid, such invalidity shall not affect other parts of this ordinance.

SECTION 4. This ordinance shall take effect upon its approval.

Introduced by:

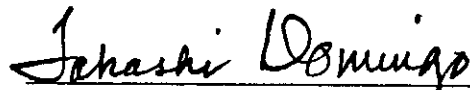

COUNCIL MEMBER, COUNTY OF HAWAII

Hilo, Hawaii

Date of Introduction:	June 20, 1984
Date of 1st Reading:	June 20, 1984
Date of 2nd Reading:	July 3, 1984
Effective Date:	July 9, 1984

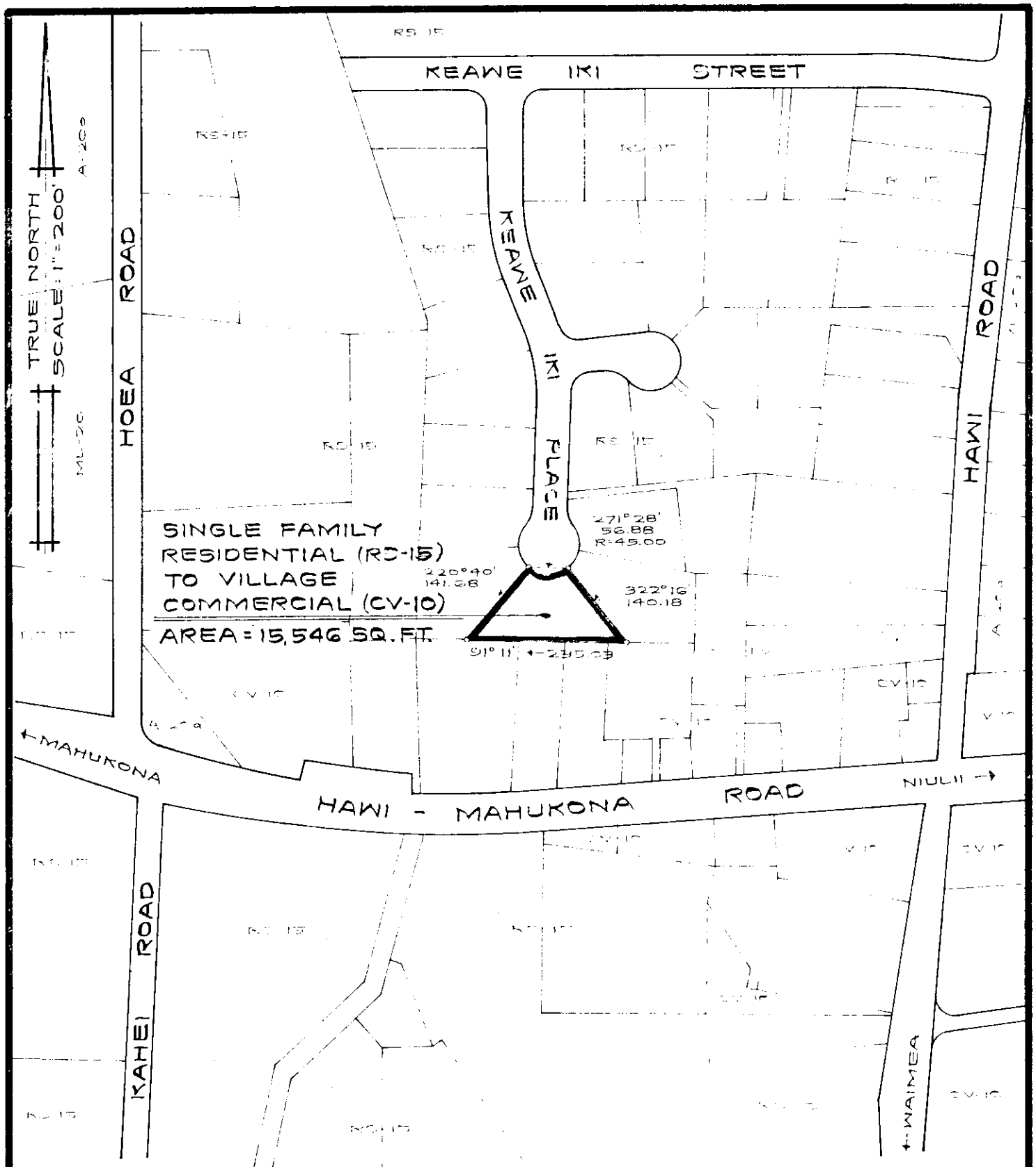

AMENDMENT TO THE ZONING CODE

AMENDING SECTION 25-92 (HAWI-KAPAAU ZONE MAP) ARTICLE 3, CHAPTER 25 (ZONING CODE) OF THE HAWAII COUNTY CODE, BY CHANGING THE DISTRICT CLASSIFICATION FROM SINGLE FAMILY RESIDENTIAL (RS-15) TO VILLAGE COMMERCIAL (CV-10) AT