

4 7° 30' 220.00 feet along Lot "G". Grant 11.006

BILL NO. 5
(Draft 2)

COUNTY OF HAWAII - STATE OF HAWAII

ORDINANCE NO. 85 1

AN ORDINANCE AMENDING SECTION 25-94 (KAMUELA ZONE MAP), ARTICLE 3, CHAPTER 25 (ZONING CODE) OF THE HAWAII COUNTY CODE, BY CHANGING THE DISTRICT CLASSIFICATION FROM AGRICULTURAL (A-1a) TO SINGLE FAMILY RESIDENTIAL (RS-20) AT WAIMEA, SOUTH KOHALA, HAWAII, COVERED BY TAX MAP KEY 6-5-02:168.

BE IT ORDAINED BY THE COUNCIL OF THE COUNTY OF HAWAII:

SECTION 1. Section 25-94, Article 3, Chapter 25 (Zoning Code) of the Hawaii County Code, is amended to change the district classification of property described hereinafter as follows:

The district classification of the following area situated at Waimea, South Kohala, Hawaii, shall be Single Family Residential (RS-20):

Beginning at a pipe at the southeast corner of this parcel of land, the coordinates of said point of beginning referred to Government Survey Triangulation Station "West Base" being 794.63 feet South and 5035.14 feet West and running by azimuths measured clockwise from True South:

1. 97° 30' 200.00 feet along Lot 1 to a pipe;
2. 187° 30' 220.00 feet along Lot 6, Grant 12,534 to E.D. Podmore to a pipe;
3. 277° 30' 200.00 feet along Lot 3 and Lot 4 to a pipe;

SECTION 3. In the event that any portion of the ordinance is declared invalid, such invalidity shall not affect other parts of this ordinance.

SECTION 4. This ordinance shall take effect upon its approval.

INTRODUCED BY:

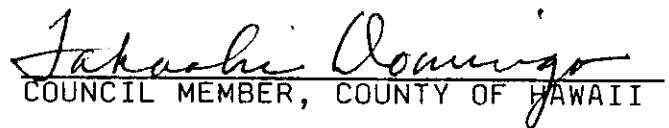
COUNCIL MEMBER, COUNTY OF HAWAII

Hilo, Hawaii

Date of Introduction: January 9, 1985
Date of 1st Reading: January 9, 1985
Date of 2nd Reading: January 23, 1985
Effective Date: January 24, 1985

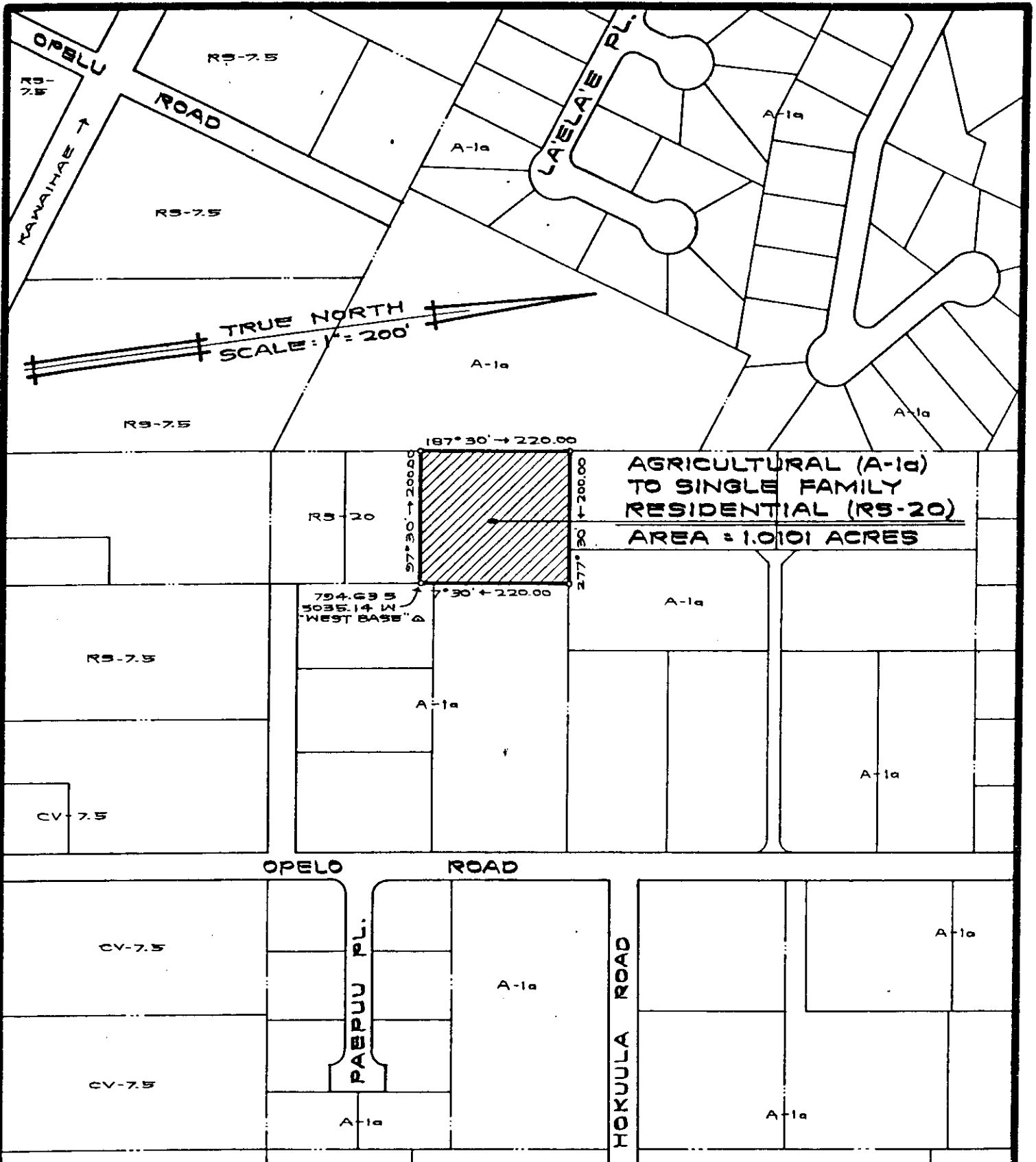

AMENDMENT TO THE ZONING CODE

AMENDING SECTION 25-94 (KAMUELA ZONE MAP)
 ARTICLE 3, CHAPTER 25 (ZONING CODE) OF THE HAWAII -
 COUNTY CODE, BY CHANGING THE DISTRICT CLASSI-
 FICATION FROM AGRICULTURAL (A-1a) TO SINGLE