

*Handwritten notes at top left.*

*10242*

*Sub 4620  
(2 Lots)*

*Trmk 6-5-7:36*

BILL NO. 9

COUNTY OF HAWAII - STATE OF HAWAII

ORDINANCE NO. 85 3

AN ORDINANCE AMENDING SECTION 25-94 (13), THE KAMUELA ZONE MAP, ARTICLE 3, CHAPTER 25 (ZONING CODE) OF THE HAWAII COUNTY CODE, AS AMENDED.

BE IT ORDAINED BY THE COUNCIL OF THE COUNTY OF HAWAII:

SECTION 1. Section 25-94 (13), Article 3, Chapter 25 (Zoning Code) of the Hawaii County Code, as amended, is hereby amended to read as follows:

"[7.09 (m).] The district classification of the following area situated at Waimea Homesteads, South Kohala, Hawaii, shall be Single Family Residential (RS-20):

Beginning at a pipe at the southeast corner of this lot, the coordinates of said point of beginning referred to Government Survey Triangulation Station "WEST BASE" being 99.89 feet South and 4298.17 feet West, and running by azimuths measured clockwise from True South:

- 1. 97° 30' 200.00 feet along Lot "C" to a pipe;
- 2. 187° 30' 240.05 feet along the east side of Opelo Road to a pipe;
- 3. 277° 30' 200.00 feet along Lot "F" to a pipe;
- 4. 7° 30' 240.05 feet along Lot "F" to a point of beginning and containing an area of 48,010 Square Feet.

"All as outlined in red on the map attached hereto, marked Exhibit 'A' and by reference made a part hereof."

*Dr Victor Jensen*

"This ordinance shall take effect forthwith upon the conditions that (A) the petitioner or his authorized representative submit a subdivision plan and secure tentative approval within one (1) year from the effective date of approval of the change of zone. The petitioner/representative shall also be responsible for securing final subdivision approval within one (1) year thereafter; (B) a single family dwelling shall be constructed on one (1) of the proposed lots within three (3) years from the date of receipt of final subdivision approval; (C) the rules and regulations of the Department of Water Supply shall be complied with; (D) a five (5) foot wide road widening strip be delineated and set aside along Opelo Road for future expansion of the roadway; (E) [prior to the issuance of final subdivision approval, the subdivider shall enter into an agreement with the County wherein the subdivider would agree to: (a) contribute \$4,000 within six (6) months of the date of final subdivision approval into a road and drainage improvement account for that area, if such an account is established by the County; or (b) make the improvements to the roadway and drainage systems in that area, meeting with the approval of the Chief Engineer within one (1) year from the date of final subdivision approval] should an Improvement District or similar arrangements be initiated for Opelo Road, the landowner shall automatically

participate in such an arrangement; and (F) all other applicable rules, regulations and requirements shall be complied with. Should any of the foregoing conditions not be met, rezoning of the area to its original or more appropriate zoning designation may be initiated."

SECTION 2. Material to be repealed is bracketed. New material is underscored. In printing this ordinance, the brackets, bracketed material and underscoring need not be included.

SECTION 3. In the event that any portion of this ordinance is declared invalid, such invalidity shall not affect the other parts of this ordinance.

SECTION 4. This ordinance shall take effect upon its approval.

Introduced by:

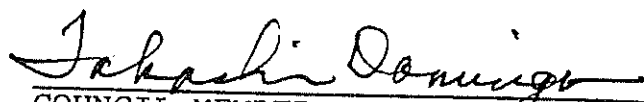
  
COUNCIL MEMBER, COUNTY OF HAWAII

Hilo, Hawaii

Date of Introduction:	January 23, 1985
Date of 1st Reading:	January 23, 1985
Date of 2nd Reading:	February 8, 1985
Effective Date:	February 19, 1985

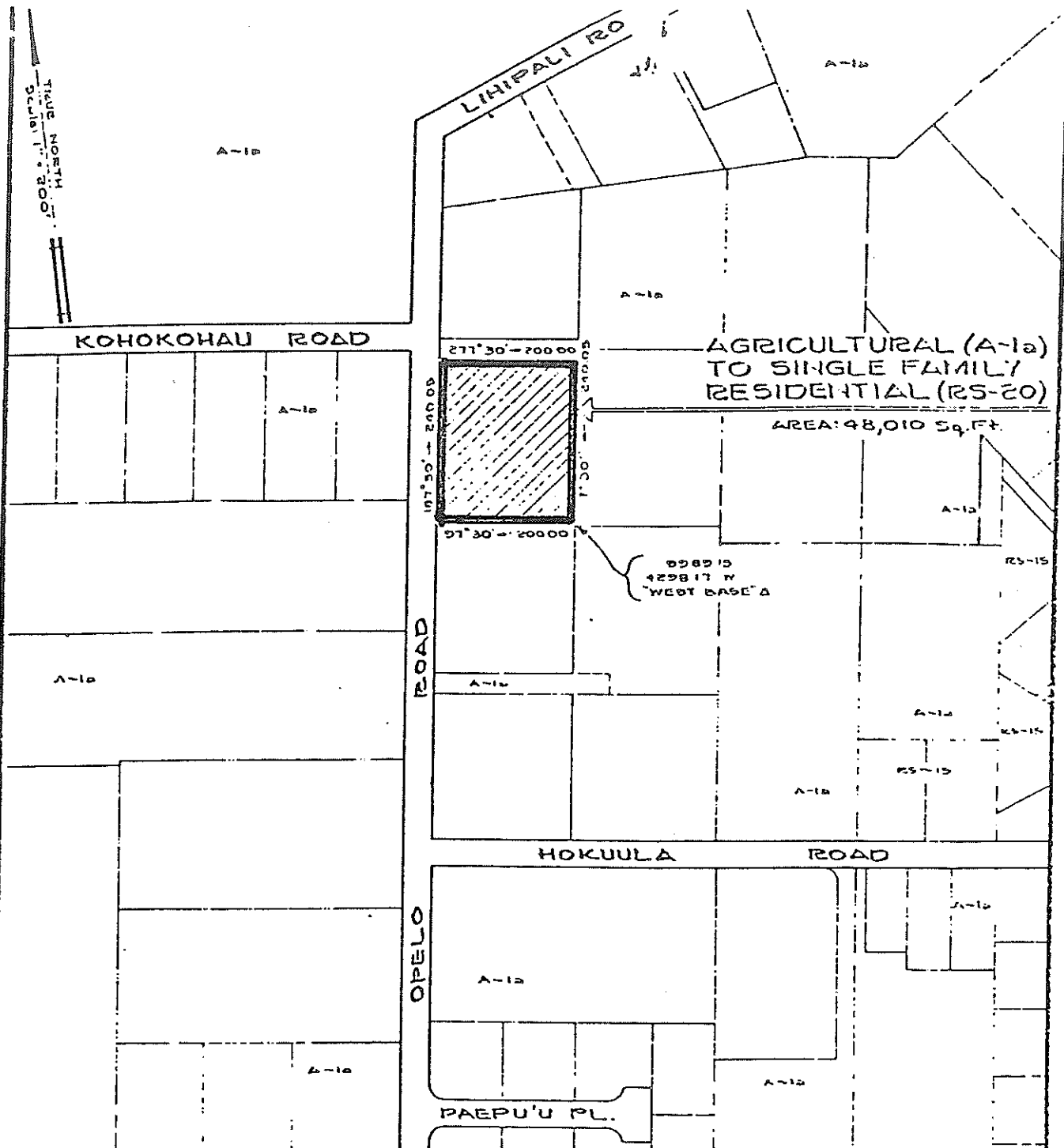

AMENDMENT TO THE ZONING CODE

AMENDMENT NO. 13 TO SECTION 7.09, THE KAMUELA ZONE MAP, ARTICLE 2, CHAPTER 8 (ZONING CODE) OF THE HAWAII COUNTY CODE, AS AMENDED, BY CHANGING THE DISTRICT CLASSIFICATION FROM AGRICULTURAL (A-1a) TO SINGLE FAMILY RESIDENTIAL (RS-20) AT WAIMEA HOMESTEADS, SOUTH KOHALA, HAWAII.

DATE OF PUBLIC HEARING: AUG 23, 1979  
 EFFECTIVE DATE: FEB. 12, 1980  
 ORDINANCE NUMBER: 515  
 PREPARED BY: PLANNING DEPARTMENT  
 COUNTY OF HAWAII