

COUNTY OF HAWAII STATE OF HAWAII

BILL NO. 77 (AMENDED)

ORDINANCE NO. 85 76

AN ORDINANCE AMENDING SECTION 25-91 (NORTH AND SOUTH KOHALA DISTRICTS ZONE MAP) ARTICLE 3, CHAPTER 25 (ZONING CODE) OF THE HAWAII COUNTY CODE, BY CHANGING THE DISTRICT CLASSIFICATIONS FROM UNZONED (PREVIOUSLY PROPOSED ROADWAYS) TO VILLAGE COMMERCIAL (CV-10), MULTIPLE FAMILY RESIDENTIAL (RM-1.5) AND (RM-3.0), RESORT-HOTEL (V-1.25) AND OPEN (O); FROM MULTIPLE FAMILY RESIDENTIAL (RM-1.5) TO UNZONED (PROPOSED ROADWAYS), OPEN (O) AND RESORT-HOTEL (V-1.25); FROM OPEN (O) TO UNZONED (PROPOSED ROADWAYS) AND RESORT-HOTEL (V-1.25); AND FROM RESORT-HOTEL (V-1.25) TO OPEN (O) AND MULTIPLE FAMILY RESIDENTIAL (RM-1.5) AT ANAEHOOMALU, SOUTH KOHALA, HAWAII, COVERED BY TAX MAP KEY 6-9-07:9, 12, 13, 14, 16, 17, 18, 25, 26 and 30.

BE IT ORDAINED BY THE COUNCIL OF THE COUNTY OF HAWAII:

SECTION 1. Section 25-91, Article 3, Chapter 25 (Zoning Code) of the Hawaii County Code, is amended to change the district classification of properties described hereinafter as follows:

The district classification of the following area situated at Anaehoomalu, South Kohala, Hawaii, shall be Village Commercial (CV-10):

(PARCEL 1)

Beginning at the West corner of this parcel of land, the coordinates of said point of beginning referred to Government Survey Triangulation Station "PUU HINAI" being 6,881.52 feet North and 37,311.15 feet West, thence running by azimuths measured clockwise from True South:

- 1. Along the remainder of R.P. 7522, L.C. Aw. 4452, Apana 4 to H. Kalama, on a curve to the left with a radius of 330.00 feet, the chord azimuth and distance being: 243° 48' 20" 7.09 feet;

2. 63° 11' 24" 7.09 feet along the remainder of R.P. 7522, L.C. Aw. 4452, Apana 4 to H. Kalama;
3. 153° 11' 24" 0.08 foot along the remainder of R.P. 7522, L.C. Aw. 4452, Apana 4 to H. Kalama to the point of beginning and containing an Area of 0.2 Square Feet. (Refer to Parcel 1 as shown on Exhibit "A")

The district classification of the following area situated at Anaehoomalu, South Kohala, Hawaii, shall be Multiple Family Residential (RM-1.5):

(PARCEL 2)

Beginning at the Southwest corner of this parcel of land, the coordinates of said point of beginning referred to Government Survey Triangulation Station "PUU HINAI" being 6,698.38 feet North and 37,584.85 feet West, thence running by azimuths measured clockwise from True South:

1. Along the remainder of R.P. 7522, L.C. Aw. 4452, Apana 4 to H. Kalama, on a curve to the right with a radius of 460.00 feet, the chord azimuth and distance being:
177° 04' 40" 76.59 feet;
2. 228° 38' 37" 51.40 feet along the remainder of R.P. 7522, L.C. Aw. 4452, Apana 4 to H. Kalama;
3. Thence along the remainder of R.P. 7522, L.C. Aw. 4452, Apana 4 to H. Kalama, on a curve to the right with a radius of 530.00 feet, the chord azimuth and distance being:
232° 26' 55.5" 70.35 feet;
4. Thence along the remainder of R.P. 7522, L.C. Aw. 4452, Apana 4 to H. Kalama, on a curve to the left with a radius of 330.00 feet, the chord azimuth and distance being:
260° 45' 35.5" 185.67 feet;

5. 333° 11' 24" 0.08 foot along the remainder of R.P. 7522, L.C. Aw. 4452, Apana 4 to H. Kalama;
6. 63° 11' 24" 113.00 feet along the remainder of R.P. 7522, L.C. Aw. 4452, Apana 4 to H. Kalama;
7. Thence along the remainder of R.P. 7522, L.C. Aw. 4452, Apana 4 to H. Kalama, on a curve to the left with a radius of 470.00 feet, the chord azimuth and distance being:
55° 55' 00.5" 119.00 feet;
8. 48° 38' 37" 99.01 feet along the remainder to R.P. 7522, L.C. Aw. 4452, Apana 4 to H. Kalama to the point of beginning and containing an Area of 0.270 Acre. (Refer to Parcel 2 as shown on Exhibit "A")

The district classification of the following area situated at Anaehoomalu, South Kohala, Hawaii, shall be Multiple Family Residential (RM-1.5):
(PARCEL 3)

Beginning at the Northeast corner of this parcel of land, the coordinates of said point of beginning referred to Government Survey Triangulation Station "PUU HINAI" being 6,706.58 feet North and 37,666.35 feet West, thence running by azimuths measured clockwise from True South:

1. Along the remainder of R.P. 7522, L.C. Aw. 4452, Apana 4, to H. Kalama, on a curve to the left with a radius of 540.00 feet, the chord azimuth and distance being:
352° 16' 39.5" 38.54 feet;
2. 138° 38' 37" 52.09 feet along the remainder of R.P. 7522, L.C. Aw. 4452, Apana 4 to H. Kalama;

3. Thence along the remainder of R.P. 7522, L.C. Aw. 4452, Apana 4 to H. Kalama, on a curve to the left with a radius of 20.00 feet, the chord azimuth and distance being:
273° 38' 37" 28.28 feet;
4. 228° 38' 37" 1.34 feet along the remainder of R.P. 7522, L.C. Aw. 4452, Apana 4 to H. Kalama to the point of beginning and containing an Area of 0.010 Acre. (Refer to Parcel 3 as shown on Exhibit "A")

The district classification of the following area situated at Anaehoomalu, South Kohala, Hawaii, shall be Unzoned (Proposed Roadway):

(PARCEL 4)

Beginning at the North corner of this parcel of land, the coordinates of said point of beginning referred to Government Survey Triangulation Station "PUU HINAI" being 6,698.38 feet North and 37,584 feet West, thence running by azimuths measured clockwise from True South:

1. Along the remainder of R.P. 7522, L.C. Aw. 4452, Apana 4 to H. Kalama, on a curve to the left with a radius of 460.00 feet, the chord azimuth and distance being:
335° 28' 22.5" 266.36 feet;
2. 138° 38' 37" 234.95 feet along the remainder of R.P. 7522, L.C. Aw. 4452, Apana 4 to H. Kalama;
3. Thence along the remainder of R.P. 7522, L.C. Aw. 4452 Apana 4 to H. Kalama, on a curve to the right with a radius of 20.00 feet, the chord azimuth and distance being:
183° 38' 37" 28.28 feet;

4. 228° 38' 37" 57.10 feet along the remainder of R.P. 7522, L.C. Aw. 4452, Apana 4 to H. Kalama to the point of beginning and containing an Area of 0.143 Acre. (Refer to Parcel 4 as shown on Exhibit "A")

The district classification of the following area situated at Anaehoomalu, South Kohala, Hawaii, shall be

Open (O):

(PARCEL 5)

Beginning at the Southeast corner of this parcel of land, the coordinates of said point of beginning referred to Government Survey Triangulation Station "PUU HINAI" being 6,990.03 feet North and 37,229.29 feet West, thence running by azimuths measured clockwise from True South:

1. 63° 11' 24" 114.91 feet along the remainder of R.P. 7522, L.C. Aw. 4452, Apana 4 to H. Kalama;
2. Thence along the remainder of R.P. 7522, L.C. Aw. 4452, Apana 4 to H. Kalama, on a curve to the right with a radius of 270.00 feet, the chord azimuth and distance being:
85° 25' 12" 204.88 feet;
3. Thence along the remainder of R.P. 7522, L.C. Aw. 4452, Apana 4 to H. Kalama, on a curve to the right with a radius of 20.00 feet, the chord azimuth and distance being:
156° 02' 45" 29.85 feet;
4. Thence along the remainder of R.P. 7522, L.C. Aw. 4452, Apana 4 to H. Kalama, on a curve to the right with a radius of 460.00 feet, the chord azimuth and distance being:
205° 51' 45" 24.95 feet;

5. 207° 25' 104.85 feet along the remainder of R.P. 7522, L.C. Aw. 4452, Apana 4 to H. Kalama;
6. Thence along the remainder of R.P. 7522, L.C. Aw. 4452, Apana 4 to H. Kalama, on a curve to the left with a radius of 840.00 feet, the chord azimuth and distance being:
193° 42' 30" 398.13 feet;
7. 180° 00' 111.78 feet along the remainder of R.P. 7522, L.C. Aw. 4452, Apana 4 to H. Kalama;
8. Thence along the remainder of R.P. 7522, L.C. Aw. 4452, Apana 4 to H. Kalama, on a curve to the right with a radius of 960.00 feet, the chord azimuth and distance being:
186° 07' 32.5" 204.88 feet;
9. 356° 20' 565.85 feet along the remainder of R.P. 7522, L.C. Aw. 4452, Apana 4 to H. Kalama;
10. 333° 11' 24" 238.03 feet along the remainder of R.P. 7522, L.C. Aw. 4452, Apana 4 to H. Kalama to the point of beginning and containing an Area of 1.912 Acres. (Refer to Parcel 5 as shown on Exhibit "A")

The district classification of the following area situated at Anaehoomalu, South Kohala, Hawaii, shall be Unzoned (Proposed Roadway):

(PARCEL 6)

Beginning at the Southeast corner of this parcel of land, the coordinates of said point of beginning referred to Government Survey Triangulation Station "PUU HINAI" being 7,982.31 feet North and 37,386.62 feet West, thence running by azimuths measured clockwise from True South:

1. 356° 20' 215.59 feet along the remainder of R.P. 7522, L.C. Aw. 4452, Apana 4 to H. Kalama;
2. Thence along the remainder of R.P. 7522, L.C. Aw. 4452, Apana 4 to H. Kalama, on a curve to the left with a radius of 960.00 feet, the chord azimuth and distance being:
6° 07' 32.5" 204.88 feet;
3. 0° 00' 111.78 feet along the remainder of R.P. 7522, L.C. Aw. 4452, Apana 4 to H. Kalama;
4. Thence along the remainder of R.P. 7522, L.C. Aw. 4452, Apana 4 to H. Kalama, on a curve to the right with a radius of 840.00 feet, the chord azimuth and distance being:
13° 42' 30" 398.13 feet;
5. 27° 25' 104.85 feet along the remainder of R.P. 7522, L.C. Aw. 4452, Apana 4 to H. Kalama;
6. Thence along the remainder of R.P. 7522, L.C. Aw. 4452, Apana 4 to H. Kalama, on a curve to the left with a radius of 460.00 feet, the chord azimuth and distance being:
25° 51' 45" 24.95 feet;
7. Thence along the remainder of R.P. 7522, L.C. Aw. 4452, Apana 4 to H. Kalama, on a curve to the left with a radius of 20.00 feet, the chord azimuth and distance being:
336° 02' 45" 29.85 feet;
8. Thence along the remainder of R.P. 7522, L.C. Aw. 4452, Apana 4 to H. Kalama, on a curve to the left with a radius of 270.00 feet, the chord azimuth and distance being:
265° 25' 12" 204.88 feet;

9. 63° 11' 24" 120.09 feet along the remainder of R.P. 7522, L.C. Aw. 4452, Apana 4 to H. Kalama;
10. Thence along the remainder of R.P. 7522, L.C. Aw. 4452, Apana 4 to H. Kalama, on a curve to the left with a radius of 530.00 feet, the chord azimuth and distance being:
59° 43' 19" 64.12 feet;
11. Thence along the remainder of R.P. 7522, L.C. Aw. 4452, Apana 4 to H. Kalama, on a curve to the right with a radius of 330.00 feet, the chord azimuth and distance being:
102° 26' 27.5" 61.45 feet;
12. Thence along the remainder of R.P. 7522, L.C. Aw. 4452, Apana 4 to H. Kalama, on a curve to the left with a radius of 20.00 feet, the chord azimuth and distance being:
59° 31' 15" 29.85 feet;
13. Thence along the remainder of R.P. 7522, L.C. Aw. 4452, Apana 4 to H. Kalama, on a curve to the left with a radius of 460.00 feet, the chord azimuth and distance being:
6° 33' 21.5" 75.42 feet;
14. 48° 38' 37" 103.37 feet along the remainder of R.P. 7522, L.C. Aw. 4452, Apana 4 to H. Kalama;
15. Thence along the remainder of R.P. 7522, L.C. Aw. 4452, Apana 4 to H. Kalama, on a curve to the right with a radius of 540.00 feet, the chord azimuth and distance being:
190° 52' 10.5" 307.59 feet;
16. 207° 25' 104.85 feet along the remainder of R.P. 7522, L.C. Aw. 4452, Apana 4 to H. Kalama;

17. Thence along the remainder of R.P. 7522, L.C. Aw. 4452, Apana 4 to H. Kalama, on a curve to the left with a radius of 760.00 feet, the chord azimuth and distance being:
193° 42' 30" 360.21 feet;
18. 180° 00' 111.78 feet along the remainder of R.P. 7522, L.C. Aw. 4452, Apana 4 to H. Kalama;
19. Thence along the remainder of R.P. 7522, L.C. Aw. 4452, Apana 4 to H. Kalama, on a curve to the right with a radius of 1,040.00 feet, the chord azimuth and distance being:
191° 52' 30" 428.02 feet;
to the point of beginning and containing an Area of 2.358 Acres. (Refer to Parcel 6 as shown on Exhibit "A")

The district classification of the following area situated at Anaehoomalu, South Kohala, Hawaii, shall be Resort-Hotel (V-1.25):

(PARCEL 7)

Beginning at the North corner of this parcel of land, the coordinates of said point of beginning referred to Government Survey Triangulation Station "PUU HINAI" being 8,172.37 feet North and 37,442.41 feet West, thence running by azimuths measured clockwise from True South:

1. 328° 16' 14" 92.51 feet along the remainder of R.P. 7522, L.C. Aw. 4452, Apana 4 to H. Kalama;
2. 356° 20' 111.60 feet along the remainder of R.P. 7522, L.C. Aw. 4452, Apana 4 to H. Kalama;
3. Thence along the remainder of R.P. 7522, L.C. Aw. 4452, Apana 4 to H. Kalama, on a curve to the left with a radius of 1,040.00 feet, the chord azimuth and distance being:
11° 52' 30" 428.02 feet;

4. 0° 00' 111.78 feet along the remainder of R.P. 7522, L.C. Aw. 4452, Apana 4 to H. Kalama;
5. Thence along the remainder of R.P. 7522, L.C. Aw. 4452, Apana 4 to H. Kalama, on a curve to the right with a radius of 760.00 feet, the chord azimuth and distance being:
12° 37' 38" 332.28 feet;
6. 141° 48' 198.99 feet along the remainder of R.P. 7522, L.C. Aw. 4452, Apana 4 to H. Kalama;
7. 90° 00' 89.71 feet along the remainder of R.P. 7522, L.C. Aw. 4452, Apana 4 to H. Kalama;
8. 20° 40' 40.61 feet along the remainder of R.P. 7522, L.C. Aw. 4452, Apana 4 to H. Kalama;
9. 90° 00' 225.35 feet along the remainder of R.P. 7522, L.C. Aw. 4452, Apana 4 to H. Kalama;
10. 175° 48' 49" 180.96 feet along the remainder of R.P. 7522, L.C. Aw. 4452, Apana 4 to H. Kalama;
11. Thence along the remainder of R.P. 7522, L.C. Aw. 4452, Apana 4 to H. Kalama, on a curve to the right with a radius of 660.00 feet, the chord azimuth and distance being:
290° 47' 28.5" 737.71 feet;
12. 243° 46' 08" 130.19 feet along the remainder of R.P. 7522, L.C. Aw. 4452, Apana 4 to H. Kalama;
13. Thence along the remainder of R.P. 7522, L.C. Aw. 4452, Apana 4 to H. Kalama, on a curve to the left with a radius of 1,040.00 feet, the chord azimuth and distance being:

241° 01' 11" 99.76 feet;
to the point of beginning and
containing an Area of
9.523 Acres. (Refer to
Parcel 7 as shown on
Exhibit "A")

The district classification of the following area
situated at Anaehoomalu, South Kohala, Hawaii, shall be
Resort-Hotel (V-1.25):

(PARCEL 8)

Beginning at the Northeast corner of this parcel of land, the
coordinates of said point of beginning referred to Government
Survey Triangulation Station "PUU HINAI" being 6,607.99 feet
North and 37,647.16 feet West, thence running by azimuths
measured clockwise from True South:

1. Along the remainder of R.P. 7522, L.C. Aw. 4452, Apana 4
to H. Kalama, on a curve to
the left with a radius of
540.00 feet, the chord
azimuth and distance being:
331° 08' 49" 233.82 feet;
2. 138° 38' 37" 347.81 feet along the remainder of
R.P. 7522, L.C. Aw. 4452,
Apana 4 to H. Kalama;
3. Thence along the remainder of R.P. 7522, L.C. Aw. 4452,
Apana 4 to H. Kalama, on a
curve to the left with a
radius of 242.00 feet, the
chord azimuth and distance
being:
115° 41' 52.5" 129.82 feet;
to the point of beginning and
containing an Area of
0.138 Acre. (Refer to
Parcel 8 as shown on
Exhibit "A")

The district classification of the following area
situated at Anaehoomalu, South Kohala, Hawaii, shall be
Multiple Family Residential (RM-1.5):

(PARCEL 9)

Beginning at the South corner of this parcel of land, the coordinates of said point of beginning referred to Government Survey Triangulation Station "PUU HINAI" being 6,607.99 feet North and 37,647.16 feet West, thence running by azimuths measured clockwise from True South:

1. Along the remainder of R.P. 7522, L.C. Aw. 4452, Apana 4 to H. Kalama, on a curve to the right with a radius of 242.00 feet, the chord azimuth and distance being: 115° 41' 52.5" 129.82 feet;
2. 138° 38' 37" 283.03 feet along the remainder of R.P. 7522, L.C. Aw. 4452, Apana 4 to H. Kalama;
3. Thence along the remainder of R.P. 7522, L.C. Aw. 4452, Apana 4 to H. Kalama, on a curve to the right with a radius of 500.00 feet, the chord azimuth and distance being: 157° 13' 43" 318.71 feet;
4. 175° 48' 49" 250.52 feet along the remainder of R.P. 7522, L.C. Aw. 4452, Apana 4 to H. Kalama;
5. Thence along the remainder of R.P. 7522, L.C. Aw. 4452, Apana 4 to H. Kalama, on a curve to the right with a radius of 740.00 feet, the chord azimuth and distance being: 186° 03' 45" 263.33 feet;
6. 285° 20' 20.36 feet along the remainder of R.P. 7522, L.C. Aw. 4452, Apana 4 to H. Kalama;
7. 0° 00' 431.11 feet along the remainder of R.P. 7522, L.C. Aw. 4452, Apana 4 to H. Kalama;
8. 270° 00' 45.55 feet along the remainder of R.P. 7522, L.C. Aw. 4452, Apana 4 to H. Kalama;

9. 355° 48' 49" 69.56 feet along the remainder of R.P. 7522, L.C. Aw. 4452, Apana 4 to H. Kalama;
10. Thence along the remainder of R.P. 7522, L.C. Aw. 4452, Apana 4 to H. Kalama, on a curve to the left with a radius of 420.00 feet, the chord azimuth and distance being:
337° 13' 43" 267.72 feet;
11. 318° 38' 37" 347.98 feet along the remainder of R.P. 7522, L.C. Aw. 4452, Apana 4 to H. Kalama;
12. Thence along the remainder of R.P. 7522, L.C. Aw. 4452, Apana 4 to H. Kalama, on a curve to the left with a radius of 540.00 feet, the chord azimuth and distance being:
346° 56' 29.5" 62.00 feet;
to the point of beginning and containing an Area of 1.762 Acres. (Refer to Parcel 9 as shown on Exhibit "A")

The district classification of the following area situated at Anaehoomalu, South Kohala, Hawaii, shall be Resort-Hotel (V-1.25):

(PARCEL 10)

Beginning at the Northeast corner of this parcel of land, the coordinates of said point of beginning referred to Government Survey Triangulation Station "PUU HINAI" being 8,172.37 feet North and 37,442.41 feet West, thence running by azimuths measured clockwise from True South:

1. Along the remainder of R.P. 7522, L.C. Aw. 4452, Apana 4 to H. Kalama, on a curve to the right with a radius of 1,040.00 feet, the chord azimuth and distance being:
61° 01' 11" 99.76 feet;

2. 63° 46' 08" 130.19 feet along the remainder of R.P. 7522, L.C. Aw. 4452, Apana 4 to H. Kalama;
3. Thence along the remainder of R.P. 7522, L.C. Aw. 4452, Apana 4 to H. Kalama, on a curve to the left with a radius of 660.00 feet, the chord azimuth and distance being:
29° 47' 28.5" 737.71 feet;
4. 355° 48' 49" 180.96 feet along the remainder of R.P. 7522, L.C. Aw. 4452, Apana 4 to H. Kalama;
5. 90° 00' 45.55 feet along the remainder of R.P. 7522, L.C. Aw. 4452, Apana 4 to H. Kalama;
6. 180° 00' 431.11 feet along the remainder of R.P. 7522, L.C. Aw. 4452, Apana 4 to H. Kalama;
7. 105° 20' 20.36 feet along the remainder of R.P. 7522, L.C. Aw. 4452, Apana 4 to H. Kalama;
8. Thence along the remainder of R.P. 7522, L.C. Aw. 4452, Apana 4 to H. Kalama, on a curve to the right with a radius of 740.00 feet, the chord azimuth and distance being:
220° 02' 24.5" 595.56 feet;
9. 243° 46' 08" 130.19 feet along the remainder of R.P. 7522, L.C. Aw. 4452, Apana 4 to H. Kalama;
10. Thence along the remainder of R.P. 7522, L.C. Aw. 4452, Apana 4 to H. Kalama, on a curve to the left with a radius of 960.00 feet, the chord azimuth and distance being:
241° 01' 11" 92.09 feet;

11. 328° 16' 14" 80.00 feet along the remainder of R.P. 7522, L.C. Aw. 4452, Apana 4 to H. Kalama to the point of beginning and containing an Area of 1.854 Acres. (Refer to Parcel 10 as shown on Exhibit "A")

The district classification of the following area situated at Anaehoomalu, South Kohala, Hawaii, shall be Unzoned (Proposed Roadway):

(PARCEL 11)

Beginning at the North corner of this parcel of land, the coordinates of said point of beginning referred to Government Survey Triangulation Station "PUU HINAI" being 8,530.08 feet North and 36,818.41 feet West, thence running by azimuths measured clockwise from True South:

1. 350° 11' 81.88 feet along the remainder of R.P. 7522, L.C. Aw. 4452, Apana 4 to H. Kalama;
2. Thence along the remainder of R.P. 7522, L.C. Aw. 4452, Apana 4 to H. Kalama, on a curve to the left with a radius of 960.00 feet, the chord azimuth and distance being:
39° 47' 56.5" 887.97 feet;
3. 176° 20' 215.59 feet along the remainder of R.P. 7522, L.C. Aw. 4452, Apana 4 to H. Kalama;
4. Thence along the remainder of R.P. 7522, L.C. Aw. 4452, Apana 4 to H. Kalama, on a curve to the right with a radius of 1,040.00 feet, the chord azimuth and distance being:
226° 02' 58" 789.25 feet;
to the point of beginning and containing an Area of 1.576 Acres. (Refer to Parcel 11 as shown on Exhibit "A")

The district classification of the following area situated at Anaehoomalu, South Kohala, Hawaii, shall be Resort-Hotel (V-1.25):

(PARCEL 12)

Beginning at the South corner of this parcel of land, the coordinates of said point of beginning referred to Government Survey Triangulation Station "PUU HINAI" being 7,982.31 feet North and 37,386.62 feet West, thence running by azimuths measured clockwise from True South:

1. 176° 20' 111.60 feet along the remainder of R.P. 7522, L.C. Aw. 4452, Apana 4 to H. Kalama;
2. 148° 16' 14" 92.51 feet along the remainder of R.P. 7522, L.C. Aw. 4452, Apana 4 to H. Kalama;
3. Thence along the remainder of R.P. 7522, L.C. Aw. 4452, Apana 4 to H. Kalama, on a curve to the left with a radius of 1,040.00 feet, the chord azimuth and distance being:
232° 06' 37" 223.21 feet;
4. 225° 57' 130.19 feet along the remainder of R.P. 7522, L.C. Aw. 4452, Apana 4 to H. Kalama;
5. Thence along the remainder of R.P. 7522, L.C. Aw. 4452, Apana 4 to H. Kalama, on a curve to the right with a radius of 660.00 feet, the chord azimuth and distance being:
243° 04' 388.50 feet;
6. 350° 11' 46.55 feet along the remainder of R.P. 7522, L.C. Aw. 4452, Apana 4 to H. Kalama;
7. Thence along the remainder of R.P. 7522, L.C. Aw. 4452, Apana 4 to H. Kalama, on a curve to the left with a radius of 1,040.00 feet, the chord azimuth and distance being:

46° 02' 58" 789.25 feet;
to the point of beginning and
containing an Area of
1.428 Acres. (Refer to
Parcel 12 as shown on
Exhibit "A")

The district classification of the following area
situated at Anaehoomalu, South Kohala, Hawaii, shall be
Resort-Hotel (V-1.25):

(PARCEL 13)

Beginning at the South corner of this parcel of land, the
coordinates of said point of beginning referred to Government
Survey Triangulation Station "PUU HINAI" being 8,530.08 feet
North and 36,818.41 feet West, thence running by azimuths
measured clockwise from True South:

1. 170° 11' 46.55 feet along the remainder of
R.P. 7522, L.C. Aw. 4452,
Apana 4 to H. Kalama;
2. Thence along the remainder of R.P. 7522, L.C. Aw. 4452,
Apana 4 to H. Kalama, on a
curve to the right with a
radius of 660.00 feet, the
chord azimuth and distance
being:
266° 34' 146.74 feet;
3. 272° 57' 38.71 feet along the remainder of
R.P. 7522, L.C. Aw. 4452,
Apana 4 to H. Kalama;
4. Thence along the remainder of R.P. 7522, L.C. Aw. 4452,
Apana 4 to H. Kalama, on a
curve to the left with a
radius of 1,040.00 feet, the
chord azimuth and distance
being:
73° 26' 53.5" 184.88 feet;
to the point of beginning and
containing an Area of
0.103 Acre. (Refer to
Parcel 13 as shown on
Exhibit "A")

The district classification of the following area situated at Anaehoomalu, South Kohala, Hawaii, shall be Unzoned (Proposed Roadway):

(PARCEL 14)

Beginning at the Northwest corner of this parcel of land, the coordinates of said point of beginning referred to Government Survey Triangulation Station "PUU HINAI" being 8,530.08 feet North and 36,818.41 feet West, thence running by azimuths measured clockwise from True South:

1. Along the remainder of R.P. 7522, L.C. Aw. 4452, Apana 4 to H. Kalama, on a curve to the right with a radius of 1,040.00 feet, the chord azimuth and distance being:
253° 26' 53.5" 184.88 feet;
2. 272° 57' 61.46 feet along the remainder of R.P. 7522, L.C. Aw. 4452, Apana 4 to H. Kalama;
3. Thence along the remainder of R.P. 7522, L.C. Aw. 4452, Apana 4 to H. Kalama, on a curve to the right with a radius of 2,760.00 feet, the chord azimuth and distance being:
286° 03' 30" 1,251.90 feet;
4. 23° 10' 1.44 feet along the remainder of R.P. 7522, L.C. Aw. 4452, Apana 4 to H. Kalama;
5. Thence along the remainder of R.P. 7522, L.C. Aw. 4452, Apana 4 to H. Kalama, on a curve to the left with a radius of 2,360.00 feet, the chord azimuth and distance being:
108° 44' 38.5" 792.48 feet;
6. 99° 04' 42" 157.40 feet along the remainder of R.P. 7522, L.C. Aw. 4452, Apana 4 to H. Kalama;

7. Thence along the remainder of R.P. 7522, L.C. Aw. 4452, Apana 4 to H. Kalama, on a curve to the left with a radius of 960.00 feet, the chord azimuth and distance being:
83° 12' 45" 524.90 feet;
8. 170° 11' 81.88 feet along the remainder of R.P. 7522, L.C. Aw. 4452, Apana 4 to H. Kalama to the point of beginning and containing an Area of 1.120 Acres. (Refer to Parcel 14 as shown on Exhibit "A")

The district classification of the following area situated at Anaehoomalu, South Kohala, Hawaii, shall be Unzoned (Proposed Roadway):

(PARCEL 15)

Beginning at the East corner of this parcel of land, the coordinates of said point of beginning referred to Government Survey Triangulation Station "PUU HINAI" being 8,120.52 feet North and 35,192.18 feet West, thence running by azimuths measured clockwise from True South:

1. Along the remainder of R.P. 7522, L.C. Aw. 4452, Apana 4 to H. Kalama, on a curve to the left with a radius of 2,360.00 feet, the chord azimuth and distance being:
121° 02' 02.5" 216.11 feet;
2. 203° 10' 1.44 feet along the remainder of R.P. 7522, L.C. Aw. 4452, Apana 4 to H. Kalama;
3. Thence along the remainder of R.P. 7522, L.C. Aw. 4452, Apana 4 to H. Kalama on a curve to the right with a radius of 2,760.00 feet, the chord azimuth and distance being;

301° 24' 45" 216.31 feet;
to the point of beginning and
containing an Area of
104 Square Feet or
0.002 Acre. (Refer to
Parcel 15 as shown on
Exhibit "A")

The district classification of the following area
situated at Anaehoomalu, South Kohala, Hawaii, shall be
Multiple Family Residential (RM-3.0):

(PARCEL 16)

Beginning at the East corner of this parcel of land, the
coordinates of said point of beginning referred to Government
Survey Triangulation Station "PUU HINAI" being 8,187.11 feet
North and 35,147.84 feet West, thence running by azimuths
measured clockwise from True South:

1. Along the remainder of R.P. 7522, L.C. Aw. 4452, Apana 4
to H. Kalama, on a curve to
the left with a radius of
2,440.00 feet, the chord
azimuth and distance being:
116° 24' 28.5" 615.89 feet;
2. Thence along the remainder of R.P. 7522, L.C. Aw. 4452,
Apana 4 to H. Kalama, on a
curve to the right with a
radius of 20.00 feet, the
chord azimuth and distance
being:
154° 39' 43.5" 28.53 feet;
3. 200° 10' 10.98 feet along the remainder of
R.P. 7522, L.C. Aw. 4452,
Apana 4 to H. Kalama;
4. Thence along the remainder of R.P. 7522, L.C. Aw. 4452,
Apana 4 to H. Kalama, on a
curve to the left with a
radius of 20.00 feet, the
chord azimuth and distance
being:
335° 40' 03" 28.04 feet;

5. Thence along the remainder of R.P. 7522, L.C. Aw. 4452, Apana 4 to H. Kalama on a curve to the right with a radius of 2,840.00 feet, the chord azimuth and distance being;
 - 297° 24' 48" 617.87 feet;
 - to the point of beginning and containing an Area of 0.057 Acre. (Refer to Parcel 16 as shown on Exhibit "A")

The district classification of the following area situated at Anaehoomalu, South Kohala, Hawaii, shall be

Open (O):
(PARCEL 17)

Beginning at the Northeast corner of this parcel of land, the coordinates of said point of beginning referred to Government Survey Triangulation Station "PUU HINAI" being 8,517.83 feet North and 35,764.19 feet West, thence running by azimuths measured clockwise from True South:

1. 20° 10' 14.78 feet along the remainder of R.P. 7522, L.C. Aw. 4452, Apana 4 to H. Kalama;
2. Thence along the remainder of R.P. 7522, L.C. Aw. 4452, Apana 4 to H. Kalama, on a curve to the right with a radius of 20.00 feet, the chord azimuth and distance being:
 - 63° 29' 48" 27.45 feet;
3. Thence along the remainder of R.P. 7522, L.C. Aw. 4452, Apana 4 to H. Kalama, on a curve to the left with a radius of 2,440.00 feet, the chord azimuth and distance being:
 - 102° 57' 09" 329.72 feet;
4. 99° 04' 42" 157.40 feet along the remainder of R.P. 7522, L.C. Aw. 4452, Apana 4 to H. Kalama;

5. Thence along the remainder of R.P. 7522, L.C. Aw. 4452, Apana 4 to H. Kalama, on a curve to the left with a radius of 1,040.00 feet, the chord azimuth and distance being:
88° 58' 21" 364.97 feet;
6. 173° 20' 79.69 feet along the remainder of R.P. 7522, L.C. Aw. 4452, Apana 4 to H. Kalama;
7. 272° 57' 69.16 feet along the remainder of R.P. 7522, L.C. Aw. 4452, Apana 4 to H. Kalama;
8. Thence along the remainder of R.P. 7522, L.C. Aw. 4452, Apana 4 to H. Kalama, on a curve to the right with a radius of 2,840.00 feet, the chord azimuth and distance being:
281° 03' 27" 803.06 feet;
9. Thence along the remainder of R.P. 7522, L.C. Aw. 4452, Apana 4 to H. Kalama on a curve to the left with a radius of 20.00 feet, the chord azimuth and distance being:
244° 39' 57" 28.04 feet;
to the point of beginning and containing an Area of 0.738 Acre. (Refer to Parcel 17 as shown on Exhibit "A")

The district classification of the following area situated at Anaehoomalu, South Kohala, Hawaii, shall be Resort-Hotel (V-1.25):

(PARCEL 18)

Beginning at the South corner of this parcel of land, the coordinates of said point of beginning referred to Government Survey Triangulation Station "PUU HINAI" being 8,172.37 feet North and 37,442.41 feet West, thence running by azimuths measured clockwise from True South:

1. 148° 16' 14" 80.00 feet along the remainder of R.P. 7522, L.C. Aw. 4452, Apana 4 to H. Kalama;
2. Thence along the remainder of R.P. 7522, L.C. Aw. 4452, Apana 4 to H. Kalama, on a curve to the left with a radius of 960.00 feet, the chord azimuth and distance being:
232° 06' 37" 206.04 feet;
3. 225° 57' 130.19 feet along the remainder of R.P. 7522, L.C. Aw. 4452, Apana 4 to H. Kalama;
4. Thence along the remainder of R.P. 7522, L.C. Aw. 4452, Apana 4 to H. Kalama, on a curve to the right with a radius of 740.00 feet, the chord azimuth and distance being:
249° 27' 590.15 feet;
5. 272° 57' 31.01 feet along the remainder of R.P. 7522, L.C. Aw. 4452, Apana 4 to H. Kalama;
6. 353° 20' 79.69 feet along the remainder of R.P. 7522, L.C. Aw. 4452, Apana 4 to H. Kalama;
7. Thence along the remainder of R.P. 7522, L.C. Aw. 4452, Apana 4 to H. Kalama, on a curve to the left with a radius of 1,040.00 feet, the chord azimuth and distance being:
78° 42' 25.5" 5.79 feet;
8. 92° 57' 38.71 feet along the remainder of R.P. 7522, L.C. Aw. 4452, Apana 4 to H. Kalama;
9. Thence along the remainder of R.P. 7522, L.C. Aw. 4452, Apana 4 to H. Kalama, on a curve to the left with a radius of 660.00 feet, the chord azimuth and distance being:
69° 27' 526.35 feet;

10. 45° 57' 130.19 feet along the remainder of R.P. 7522, L.C. Aw. 4452, Apana 4 to H. Kalama;
11. Thence along the remainder of R.P. 7522, L.C. Aw. 4452, Apana 4 to H. Kalama on a curve to the right with a radius of 1,040.00 feet, the chord azimuth and distance being;
 - 52° 06' 37" 223.21 feet;
 - to the point of beginning and containing an Area of 1.758 Acres. (Refer to Parcel 18 as shown on Exhibit "A")

The district classification of the following area situated at Anaehoomalu, South Kohala, Hawaii, shall be Resort-Hotel (V-1.25):

(PARCEL 19)

Beginning at the North corner of this parcel of land, the coordinates of said point of beginning referred to Government Survey Triangulation Station "PUU HINAI" being 9,651.47 feet North and 36,988.64 feet West, thence running by azimuths measured clockwise from True South:

1. 313° 30' 251.76 feet along the remainder of R.P. 7522, L.C. Aw. 4452, Apana 4 to H. Kalama;
2. 353° 20' 785.04 feet along the remainder of R.P. 7522, L.C. Aw. 4452, Apana 4 to H. Kalama;
3. 263° 20' 65.52 feet along the remainder of R.P. 7522, L.C. Aw. 4452, Apana 4 to H. Kalama;
4. 353° 20' 43.31 feet along the remainder of R.P. 7522, L.C. Aw. 4452, Apana 4 to H. Kalama;
5. 92° 57' 31.01 feet along the remainder of R.P. 7522, L.C. Aw. 4452, Apana 4 to H. Kalama;

6. Thence along the remainder of R.P. 7522, L.C. Aw. 4452, Apana 4 to H. Kalama, on a curve to the left with a radius of 740.00 feet, the chord azimuth and distance being:
87° 53' 27" 130.51 feet;
7. Thence along the remainder of R.P. 7522, L.C. Aw. 4452, Apana 4 to H. Kalama, on a curve to the right with a radius of 20.00 feet, the chord azimuth and distance being:
126° 44' 57" 27.74 feet;
8. 170° 40' 988.13 feet along the remainder of R.P. 7522, L.C. Aw. 4452, Apana 4 to H. Kalama to the point of beginning and containing an Area of 2.885 Acres. (Refer to Parcel 19 as shown on Exhibit "A")

The district classification of the following area situated at Anaehoomalu, South Kohala, Hawaii, shall be Resort-Hotel (V-1.25):
(PARCEL 20)

Beginning at the East corner of this parcel of land, the coordinates of said point of beginning referred to Government Survey Triangulation Station "PUU HINAI" being 9,723.28 feet North and 37,064.31 feet West, thence running by azimuths measured clockwise from True South:

1. 80° 57' 30" 857.56 feet along the remainder of R.P. 7522, L.C. Aw. 4452, Apana 4 to H. Kalama;
2. 63° 20' 280.00 feet along the remainder of R.P. 7522, L.C. Aw. 4452, Apana 4 to H. Kalama;
3. Thence along high water mark at seashore, the direct azimuth and distance between points being:
104° 51' 12.37 feet;

4. 230° 45' 431.32 feet along the remainder of R.P. 7522, L.C. Aw. 4452, Apana 4 to H. Kalama;
5. 263° 20' 680.00 feet along the remainder of R.P. 7522, L.C. Aw. 4452, Apana 4 to H. Kalama;
6. 313° 30' 137.40 feet along the remainder of R.P. 7522, L.C. Aw. 4452, Apana 4 to H. Kalama to the point of beginning and containing an Area of 2.552 Acres. (Refer to Parcel 20 as shown on Exhibit "A")

The district classification of the following area situated at Anaehoomalu, South Kohala, Hawaii, shall be Open (O):

(PARCEL 21)

Beginning at the Southeast corner of this parcel of land, the coordinates of said point of beginning referred to Government Survey Triangulation Station "PUU HINAI" being 9,651.47 feet North and 36,988.64 feet West, thence running by azimuths measured clockwise from True South:

1. 133° 30' 104.32 feet along the remainder of R.P. 7522, L.C. Aw. 4452, Apana 4 to H. Kalama;
2. 260° 57' 30" 63.02 feet along the remainder of R.P. 7522, L.C. Aw. 4452, Apana 4 to H. Kalama;
3. 350° 40' 82.81 feet along the remainder of R.P. 7522, L.C. Aw. 4452, Apana 4 to H. Kalama to the point of beginning and containing an Area of 0.060 Acre. (Refer to Parcel 21 as shown on Exhibit "A")

The district classification of the following area situated at Anaehoomalu, South Kohala, Hawaii, shall be Resort-Hotel (V-1.25):

(PARCEL 22)

Beginning at the Northeast corner of this parcel of land, the coordinates of said point of beginning referred to Government Survey Triangulation Station "PUU HINAI" being 9,307.36 feet North and 36,932.07 feet West, thence running by azimuths measured clockwise from True South:

1. 350° 40' 639.42 feet along the remainder of R.P. 7522, L.C. Aw. 4452, Apana 4 to H. Kalama;
2. Thence along the remainder of R.P. 7522, L.C. Aw. 4452, Apana 4 to H. Kalama, on a curve to the left with a radius of 20.00 feet, the chord azimuth and distance being:
306° 44' 57" 27.74 feet;
3. Thence along the remainder of R.P. 7522, L.C. Aw. 4452, Apana 4 to H. Kalama, on a curve to the left with a radius of 740.00 feet, the chord azimuth and distance being:
79° 03' 29" 97.41 feet;
4. Thence along the remainder of R.P. 7522, L.C. Aw. 4452, Apana 4 to H. Kalama, on a curve to the left with a radius of 20.00 feet, the chord azimuth and distance being:
212° 58' 32" 26.93 feet;
5. 170° 40' 637.08 feet along the remainder of R.P. 7522, L.C. Aw. 4452, Apana 4 to H. Kalama;
6. 255° 46' 60.22 feet along the remainder of R.P. 7522, L.C. Aw. 4452, Apana 4 to H. Kalama to the point of beginning and containing an Area of 0.908 Acre. (Refer to Parcel 22 as shown on Exhibit "A")

The district classification of the following area situated at Anaehoomalu, South Kohala, Hawaii, shall be Resort-Hotel (V-1.25):

(PARCEL 23)

Beginning at the Northwest corner of this parcel of land, the coordinates of said point of beginning referred to Government Survey Triangulation Station "PUU HINAI" being 9,159.81 feet North and 37,513.87 feet West, thence running by azimuths measured clockwise from True South:

1. 255° 46' 539.97 feet along the remainder of R.P. 7522, L.C. Aw. 4452, Apana 4 to H. Kalama;
2. 350° 40' 637.08 feet along the remainder of R.P. 7522, L.C. Aw. 4452, Apana 4 to H. Kalama;
3. Thence along the remainder of R.P. 7522, L.C. Aw. 4452, Apana 4 to H. Kalama, on a curve to the right with a radius of 20.00 feet, the chord azimuth and distance being:
32° 58' 32" 26.93 feet;
4. Thence along the remainder of R.P. 7522, L.C. Aw. 4452, Apana 4 to H. Kalama, on a curve to the left with a radius of 740.00 feet, the chord azimuth and distance being:
64° 57' 45" 265.18 feet;
5. 144° 38' 26" 115.61 feet along the remainder of R.P. 7522, L.C. Aw. 4452, Apana 4 to H. Kalama;

Thence along high water mark at seashore for the next fourteen (14) courses, the direct azimuths and distances between points being:
6. 214° 00' 77.00 feet;

7.	173° 29'	41.00 feet;
8.	89° 09' 30"	80.43 feet;
9.	95° 19'	47.90 feet;
10.	108° 34'	65.30 feet;
11.	140° 49'	19.20 feet;
12.	189° 53'	23.80 feet;
13.	219° 50'	47.00 feet;
14.	97° 46'	33.50 feet;
15.	127° 56'	24.20 feet;
16.	150° 45'	43.50 feet;
17.	189° 01'	37.40 feet;
18.	195° 38'	176.00 feet;
19.	114° 10'	170.00 feet to the point of beginning and containing an Area of 6.262 Acres. (Refer to Parcel 23 as shown on Exhibit "A")

The district classification of the following area situated at Anaehoomalu, South Kohala, Hawaii, shall be Resort-Hotel (V-1.25):
(PARCEL 24)

Beginning at the North corner of this parcel of land, the coordinates of said point of beginning referred to Government Survey Triangulation Station "PUU HINAI" being 8,790.10 feet North and 37,501.26 feet West, thence running by azimuths measured clockwise from True South:

Along high water mark at seashore for the first eight (8) courses, the direct azimuths and distances between points being:

1.	40°	15'	49.98 feet;
2.	311°	52'	40.80 feet;
3.	299°	58'	23.70 feet;
4.	294°	12'	45.40 feet;
5.	284°	30'	23.70 feet;
6.	302°	32'	62.00 feet;
7.	295°	55'	27.00 feet;
8.	300°	47'	23.30 feet;

Thence along former shoreline, along the remainder of R.P. 7522, L.C. Aw. 4452, Apana 4 to H. Kalama, for the next twenty-six (26) courses, the direct azimuths and distances between points being:

9.	348°	05'	96.00 feet;
10.	58°	33'	44.00 feet;
11.	80°	47'	44.00 feet;
12.	204°	48'	101.00 feet;
13.	180°	25'	44.00 feet;
14.	93°	53'	39.00 feet;
15.	5°	29'	142.00 feet;
16.	38°	00'	150.00 feet;
17.	298°	30'	67.00 feet;
18.	35°	10'	29.00 feet;
19.	142°	43'	33.00 feet;
20.	84°	32'	155.00 feet;
21.	137°	25'	53.00 feet;

- | | | | |
|-----|------|-----|--|
| 22. | 233° | 51' | 73.00 feet; |
| 23. | 183° | 10' | 139.00 feet; |
| 24. | 293° | 12' | 94.00 feet; |
| 25. | 201° | 46' | 39.00 feet; |
| 26. | 140° | 43' | 94.00 feet; |
| 27. | 35° | 23' | 76.00 feet; |
| 28. | 106° | 15' | 37.00 feet; |
| 29. | 211° | 11' | 145.00 feet; |
| 30. | 65° | 47' | 97.00 feet; |
| 31. | 69° | 29' | 107.00 feet; |
| 32. | 135° | 52' | 29.00 feet; |
| 33. | 246° | 10' | 111.00 feet; |
| 34. | 238° | 42' | 182.00 feet along the remainder of
R.P. 7522, L.C. Aw. 4452,
Apana 4 to H. Kalama to the
point of beginning and
containing an Area of
1.820 Acres. (Refer to
Parcel 24 as shown on
Exhibit "A") |

The district classification of the following area situated at Anaehoomalu, South Kohala, Hawaii, shall be Resort-Hotel (V-1.25):

(PARCEL 25)

Beginning at the South corner of this parcel of land, the coordinates of said point of beginning referred to Government Survey Triangulation Station "PUU HINAI" being 7,936.39 feet North and 37,932.90 feet West, thence running by azimuths measured clockwise from True South:

- | | | | | |
|----|------|-----|-----|---|
| 1. | 121° | 00' | 57" | 173.87 feet along the remainder of
R.P. 7522, L.C. Aw. 4452,
Apana 4, to H. Kalama; |
|----|------|-----|-----|---|

2.	192° 34' 51"	210.00 feet along the remainder of R.P. 7522, L.C. Aw. 4452, Apana 4, to H. Kalama;
3.	269° 09' 23"	139.18 feet along the remainder of R.P. 7522, L.C. Aw. 4452, Apana 4, to H. Kalama;
4.	220° 53' 56"	187.86 feet along the remainder of R.P. 7522, L.C. Aw. 4452, Apana 4, to H. Kalama;
5.	196° 07' 39"	86.40 feet along the remainder of R.P. 7522, L.C. Aw. 4452, Apana 4, to H. Kalama;
6.	225° 05'	177.22 feet along the remainder of R.P. 7522, L.C. Aw. 4452, Apana 4, to H. Kalama;
		Thence along former shoreline, along the remainder of R.P. 7522, L.C. Aw. 4452, Apana 4 to H. Kalama, for the next twenty-one (21) courses, the direct azimuths and distances between points being:
7.	286° 15'	37.00 feet;
8.	215° 23'	76.00 feet;
9.	320° 43'	94.00 feet;
10.	21° 46'	39.00 feet;
11.	113° 12'	94.00 feet;
12.	3° 10'	139.00 feet;
13.	53° 51'	73.00 feet;
14.	317° 25'	53.00 feet;
15.	264° 32'	155.00 feet;
16.	322° 43'	33.00 feet;
17.	215° 10'	29.00 feet;

- | | | |
|-----|---|---|
| 18. | 118° 30' | 67.00 feet; |
| 19. | 218° 00' | 150.00 feet; |
| 20. | 185° 29' | 142.00 feet; |
| 21. | 273° 53' | 39.00 feet; |
| 22. | 0° 25' | 44.00 feet; |
| 23. | 24° 48' | 101.00 feet; |
| 24. | 260° 47' | 44.00 feet; |
| 25. | 238° 33' | 44.00 feet; |
| 26. | 168° 05' | 96.00 feet; |
| 27. | Thence along highwater mark at shoreline, the direct azimuth and distance between points being:
274° 00' 113.00 feet; | |
| 28. | 324° 38' 26" | 115.61 feet along the remainder of R.P. 7522, L.C. Aw. 4452, Apana 4, to H. Kalama; |
| 29. | Thence along the remainder of R.P. 7522, L.C. Aw. 4452, Apana 4 to H. Kalama, on a curve to the left with a radius of 740.00 feet, the chord azimuth and distance being:
50° 17' 43" 112.13 feet; | |
| 30. | 45° 57' | 130.19 feet along the remainder of R.P. 7522, L.C. Aw. 4452, Apana 4, to H. Kalama; |
| 31. | Thence along the remainder of R.P. 7522, L.C. Aw. 4452, Apana 4 to H. Kalama, on a curve to the right with a radius of 960.00 feet, the chord azimuth and distance being:
54° 51' 34" 297.36 feet; | |
| 32. | 63° 46' 08" | 130.19 feet along the remainder of R.P. 7522, L.C. Aw. 4452, Apana 4, to H. Kalama; |

33. Thence along the remainder of R.P. 7522, L.C. Aw. 4452, Apana 4 to H. Kalama, on a curve to the left with a radius of 740.00 feet, the chord azimuth and distance being:
 51° 11' 51.5" 322.13 feet to the point of beginning and containing an Area of 5.085 Acres. (Refer to Parcel 25 as shown on Exhibit "A")

The district classification of the following area situated at Anaehoomalu, South Kohala, Hawaii, shall be Multiple Family Residential (RM-1.5):

(PARCEL 26)

Beginning at the Southeast corner of this parcel of land, the coordinates of said point of beginning referred to Government Survey Triangulation Station "PUU HINAI" being 7,672.63 feet North and 38,067.73 feet West, thence running by azimuths measured clockwise from True South:

1. 105° 32' 382.22 feet along the remainder of R.P. 7522, L.C. Aw. 4452, Apana 4, to H. Kalama;
2. 85° 41' 30" 340.00 feet along the remainder of R.P. 7522, L.C. Aw. 4452, Apana 4, to H. Kalama;

Thence along the high water mark at seashore for the next eight (8) courses, the direct azimuths and distances between points being:

3. 146° 56' 133.20 feet;
4. 124° 30' 131.40 feet;
5. 145° 48' 79.30 feet;
6. 188° 57' 58.50 feet;
7. 227° 23' 97.60 feet;

- | | | |
|-----|---|---|
| 8. | 275° 40' | 44.60 feet; |
| 9. | 236° 19' | 46.30 feet; |
| 10. | 210° 44' | 128.80 feet; |
| 11. | 2° 30' | 116.19 feet along the remainder of
R.P. 7522, L.C. Aw. 4452,
Apana 4, to H. Kalama; |
| 12. | 323° 00' | 185.12 feet along the remainder of
R.P. 7522, L.C. Aw. 4452,
Apana 4, to H. Kalama; |
| 13. | 303° 20' | 74.34 feet along the remainder of
R.P. 7522, L.C. Aw. 4452,
Apana 4, to H. Kalama; |
| 14. | 342° 40' | 74.33 feet along the remainder of
R.P. 7522, L.C. Aw. 4452,
Apana 4, to H. Kalama; |
| 15. | 323° 00' | 50.00 feet along the remainder of
R.P. 7522, L.C. Aw. 4452,
Apana 4, to H. Kalama; |
| 16. | 285° 20' | 145.64 feet along the remainder of
R.P. 7522, L.C. Aw. 4452,
Apana 4, to H. Kalama; |
| 17. | 250° 45' | 61.63 feet along the remainder of
R.P. 7522, L.C. Aw. 4452,
Apana 4, to H. Kalama; |
| 18. | 319° 55' | 105.68 feet along the remainder of
R.P. 7522, L.C. Aw. 4452,
Apana 4, to H. Kalama; |
| 19. | 285° 20' | 226.64 feet along the remainder of
R.P. 7522, L.C. Aw. 4452,
Apana 4, to H. Kalama; |
| 20. | Thence along the remainder of R.P. 7522, L.C. Aw. 4452,
Apana 4 to H. Kalama, on a
curve to the left with a
radius of 740.00 feet, the
chord azimuth and distance
being: | |

15° 55' 20.5" 10.05 feet
to the point of beginning and
containing an Area of
2.886 Acres. (Refer to
Parcel 26 as shown on
Exhibit "A")

The district classification of the following area
situated at Anaehoomalu, South Kohala, Hawaii, shall be
Resort Hotel (V-1.25):

(PARCEL 27)

Beginning at the East corner of this parcel of land, the
coordinates of said point of beginning referred to Government
Survey Triangulation Station "PUU HINAI" being 6,838.41 feet
North and 37,920.10 feet West, thence running by azimuths
measured clockwise from True South:

1. 48° 38' 37" 790.64 feet along the remainder of
R.P. 7522, L.C. Aw. 4452,
Apana 4, to H. Kalama;
2. 85° 41' 30" 200.00 feet along the remainder of
R.P. 7522, L.C. Aw. 4452,
Apana 4, to H. Kalama;

Thence along high water mark
at seashore for the next
two (2) courses, the direct
azimuths and distances
between points being:

3. 169° 00' 380.00 feet;
4. 191° 20' 20" 194.56 feet;
5. 251° 41' 460.01 feet along the remainder of
R.P. 7522, L.C. Aw. 4452,
Apana 4, to H. Kalama;
6. 304° 41' 72.30 feet along the remainder of
R.P. 7522, L.C. Aw. 4452,
Apana 4, to H. Kalama;
7. 254° 37' 107.80 feet along the remainder of
R.P. 7522, L.C. Aw. 4452,
Apana 4, to H. Kalama;

8. 268° 11' 113.90 feet along the remainder of R.P. 7522, L.C. Aw. 4452, Apana 4, to H. Kalama;
9. Thence along the remainder of R.P. 7522, L.C. Aw. 4452, Apana 4 to H. Kalama, on a curve to the left with a radius of 502.00 feet, the chord azimuth and distance being:
327° 09' 54" 148.77 feet;
10. 318° 38' 37" 49.26 feet along the remainder of R.P. 7522, L.C. Aw. 4452, Apana 4 to H. Kalama to the point of beginning and containing an Area of 8.765 Acres. (Refer to Parcel 27 as shown on Exhibit "A")

The district classification of the following area situated at Anaehoomalu, South Kohala, Hawaii, shall be Multiple Family Residential (RM-1.5):

(PARCEL 28)

Beginning at the West corner of this parcel of land, the coordinates of said point of beginning referred to Government Survey Triangulation Station "PUU HINAI" being 6,838.41 feet North and 37,920.10 feet West, thence running by azimuths measured clockwise from True South:

1. 228° 38' 37" 2.00 feet along the remainder of R.P. 7522, L.C. Aw. 4452, Apana 4, to H. Kalama;
2. 318° 38' 37" 233.77 feet along the remainder of R.P. 7522, L.C. Aw. 4452, Apana 4, to H. Kalama;
3. Thence along the remainder of R.P. 7522, L.C. Aw. 4452, Apana 4 to H. Kalama, on a curve to the right with a radius of 242.00 feet, the chord azimuth and distance being:
134° 57' 31.18 feet;

4. 138° 38' 37" 202.65 feet along the remainder of R.P. 7522, L.C. Aw. 4452, Apana 4 to H. Kalama to the point of beginning and containing an Area of 449 Square Feet or 0.010 Acre. (Refer to Parcel 28 as shown on Exhibit "A")

All as shown on the map attached hereto, marked Exhibit "A" and by reference made a part hereof.

SECTION 2. This change in district classification is conditioned upon the following: (A) the petitioner, successors or its assigns shall comply with the stated conditions of approval; (B) all applicable conditions of Change of Zone Ordinance No. 265, as amended, shall be complied with; (C) the consolidation/resubdivision plan for the affected area shall be submitted for tentative approval within one (1) year from the effective date of the accompanying Special Management Area (SMA) Use Permit; (D) plans for plan approval shall be submitted for the proposed development within one year from the effective date of the accompanying Special Management Area (SMA) Use Permit; (E) construction shall commence within one year from the date of receipt of Final Plan Approval and be completed within three years thereafter, subject to time extension for force majeure conditions; (F) the requirements of the Department of Water Supply shall be complied with; (G) the method of sewage disposal shall meet with the approval of the appropriate governmental agencies;

(H) drainage system(s) shall be installed in accordance with the requirements of the Department of Public Works; (I) the petitioner, successors or assigns shall be responsible for satisfying a basic housing requirement by providing or causing the provision of affordable housing units to meet the direct and indirect resort hotel employee housing demands generated by the resort development or by undertaking other related mitigation measures. An affordable housing need study shall be prepared and submitted to the Planning Director and the Hawaii County Housing Agency estimating the resort hotel employee housing demand to be generated by the proposed hotel development. The Planning Director and the Hawaii County Housing Agency may adjust the resort hotel employee housing requirement based on the findings contained in the report and other applicable information. The manner in which the required affordable employee housing units or other related mitigation measures are to be provided shall meet with the approval of the Planning Director and the concurrence of the Hawaii County Housing Agency. Furthermore, the requirements of this condition including the provision of the required employee housing units or other related mitigation measures, shall be complied with prior to the hotel commencing operation; and, (J) all other applicable rules, regulations and requirements shall be complied with. Should any of the foregoing conditions not be met, rezoning of the area to its original or more appropriate designation may be initiated.

SECTION 3. In the event that any portion of this ordinance is declared invalid, such invalidity shall not affect the other parts of this ordinance.

SECTION 4. This ordinance shall take effect upon its approval.

INTRODUCED BY:



COUNCIL MEMBER, COUNTY OF HAWAII

Hilo, Hawaii

Date of Introduction:	August 21, 1985
Date of 1st Reading:	August 21, 1985
Date of 2nd Reading:	September 4, 1985
Effective Date:	September 9, 1985

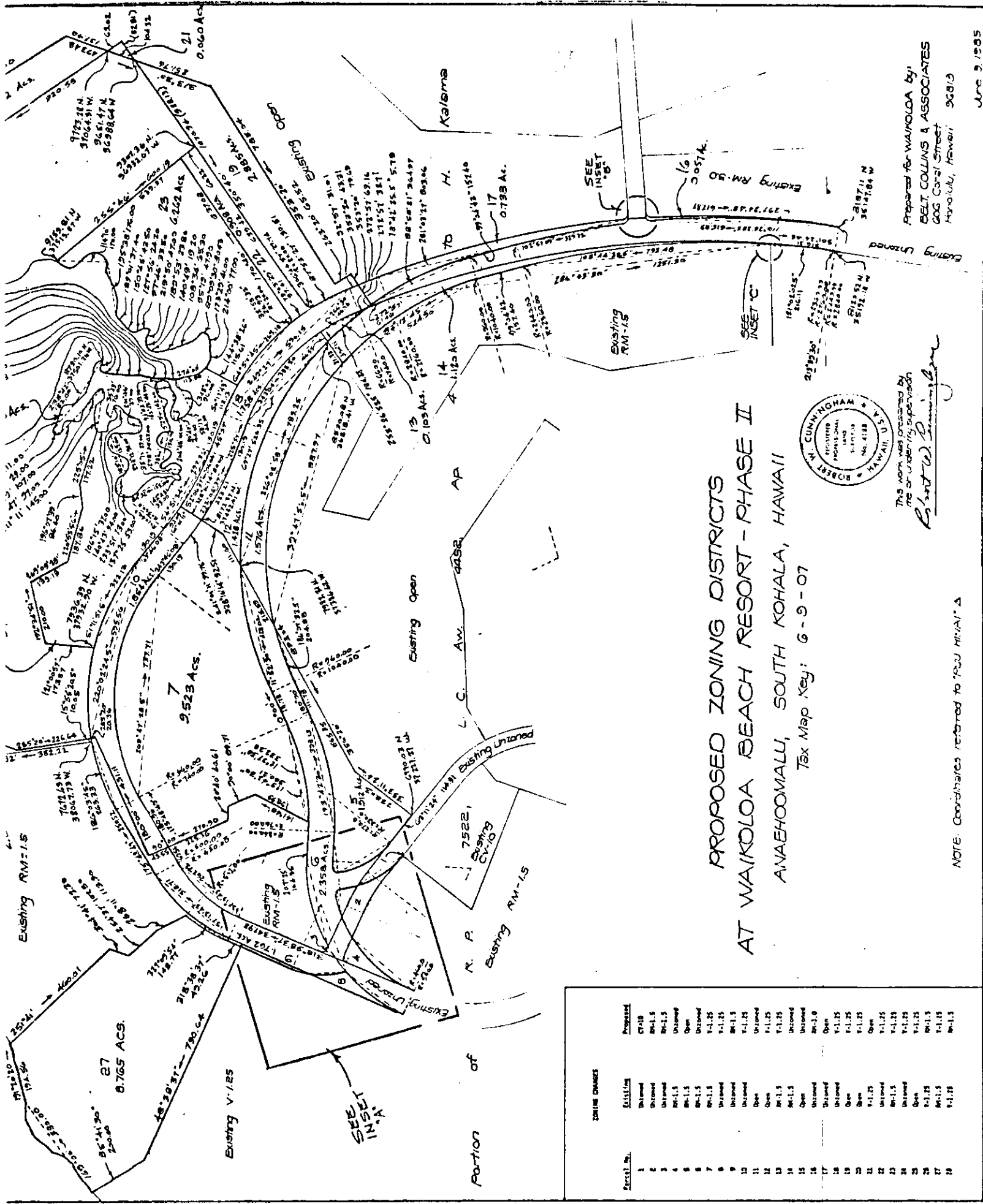

PROPOSED ZONING DISTRICTS
 AT WAIKOLOA BEACH RESORT - PHASE II
 ANAEOHOMALLI, SOUTH KOHALA, HAWAII
 Tax Map Key: G-9-07



This work was prepared by me or under my supervision
Robert M. Cunningham

Prepared for WAIKOLOA by:
 BELT COLLINS & ASSOCIATES
 608 Canal Street
 Honolulu, Hawaii 96813

NOTE: Coordinates referred to T.S.U. HAWAII '83

June 2, 1985

Parcel No.	Existing	Proposed
1	RM-1.5	CV-1.0
2	RM-1.5	RM-1.5
3	RM-1.5	RM-1.5
4	RM-1.5	RM-1.5
5	RM-1.5	Open
6	RM-1.5	Open
7	RM-1.5	RM-1.5
8	RM-1.5	RM-1.5
9	RM-1.5	RM-1.5
10	RM-1.5	Open
11	RM-1.5	Open
12	RM-1.5	Open
13	RM-1.5	Open
14	RM-1.5	Open
15	Open	Open
16	Open	Open
17	Open	Open
18	Open	Open
19	Open	Open
20	Open	Open
21	Open	Open
22	Open	Open
23	Open	Open
24	Open	Open
25	Open	Open
26	Open	Open
27	Open	Open
28	Open	Open
29	Open	Open
30	Open	Open

