

COUNTY OF HAWAII STATE OF HAWAII

Bill No. 178

ORDINANCE NO. 86 61

AN ORDINANCE AMENDING SECTION 25-87 (NORTH KONA ZONE MAP) ARTICLE 3, CHAPTER 25 (ZONING CODE) OF THE HAWAII COUNTY CODE, BY CHANGING THE DISTRICT CLASSIFICATION FROM AGRICULTURAL (A-5a) TO AGRICULTURAL (A-1a) AT KEAUHOU 1ST, NORTH KONA, HAWAII COVERED BY TAX MAP KEY 7-8-06:PORTION OF 55.

BE IT ORDAINED BY THE COUNCIL OF THE COUNTY OF HAWAII:

SECTION 1. Section 25-87, Article 3, Chapter 25 (Zoning Code) of the Hawaii County Code, is amended to change the district classification of property described hereinafter as follows:

The district classification of the following area situated at Keauhou 1st, North Kona, Hawaii, shall be Agricultural (A-1a):

Beginning at the northwest corner of this parcel of land and on the northeasterly side of Mamalahoa Highway, the coordinates of said point of beginning referred to Government Survey Triangulation Station "KEAUHOU", being 3,679.11 feet North and 81.91 feet East, thence running by azimuths measured clockwise from true South:

- 1. 258° 00' 200.00 feet along the remainder of R.P. 4475, L.C. Aw. 7713, Ap. 7 to Victoria Kamamalu (Kahaluu-Keauhou 1 House Lots);
2. 328° 39' 30" 649.43 feet along the remainder of R.P. 4475, L.C. Aw. 7713, Ap. 7 to Victoria Kamamalu (Keauhou-Kahaluu Farm Lots);
3. 55° 11' 727.25 feet along the remainder of R.P. 4475, L.C. Aw. 7713, Ap. 7 to Victoria Kamamalu (Lot B);

4. 142° 18' 160.63 feet along Mamalahoa Highway;
5. Thence along Mamalahoa Highway on a curve to the right with a radius of 95.00 feet, the chord azimuth and distance being:
179° 36' 30" 115.16 feet;
6. 216° 55' 151.48 feet along Mamalahoa Highway;
7. Thence along Mamalahoa Highway on a curve to the left with a radius of 485.00 feet, the chord azimuth and distance being:
198° 07' 30" 312.46 feet;
8. 179° 20' 124.17 feet along Mamalahoa Highway;
9. Thence along Mamalahoa Highway on a curve to the left with a radius of 325.00 feet, the chord azimuth and distance being:
173° 40' 64.18 feet;
10. 168° 00' 81.83 feet along Mamalahoa Highway to the point of beginning and containing an area of 7.821 Acres.

All as shown on the map attached hereto, marked Exhibit "A" and by reference made a part hereof.

SECTION 2. This change in district classification is conditioned upon the following: (A) the petitioner, its successors or assigns shall be responsible for complying with all of the stated conditions of approval; (B) subdivision plans shall be submitted within one year from the effective date of the change of zone. Final subdivision plans shall be submitted within one year from the effective date of the tentative subdivision approval; and (C) all other applicable rules, regulations and requirements shall be complied with. The

Planning Director may administratively grant extensions to the foregoing time conditions. Further, should any of the foregoing conditions not be met or substantially complied with in a timely fashion, the Planning Director may initiate rezoning of the property to its original or more appropriate designation.

SECTION 3. In the event that any portion of this ordinance is declared invalid, such invalidity shall not affect the other parts of this ordinance.

SECTION 4. This ordinance shall take effect upon its approval.

INTRODUCED BY:

COUNCIL MEMBER, COUNTY OF HAWAII

Hilo, Hawaii

Date of Introduction:	May 21, 1986
Date of 1st Reading:	May 21, 1986
Date of 2nd Reading:	June 4, 1986
Effective Date:	June 9, 1986

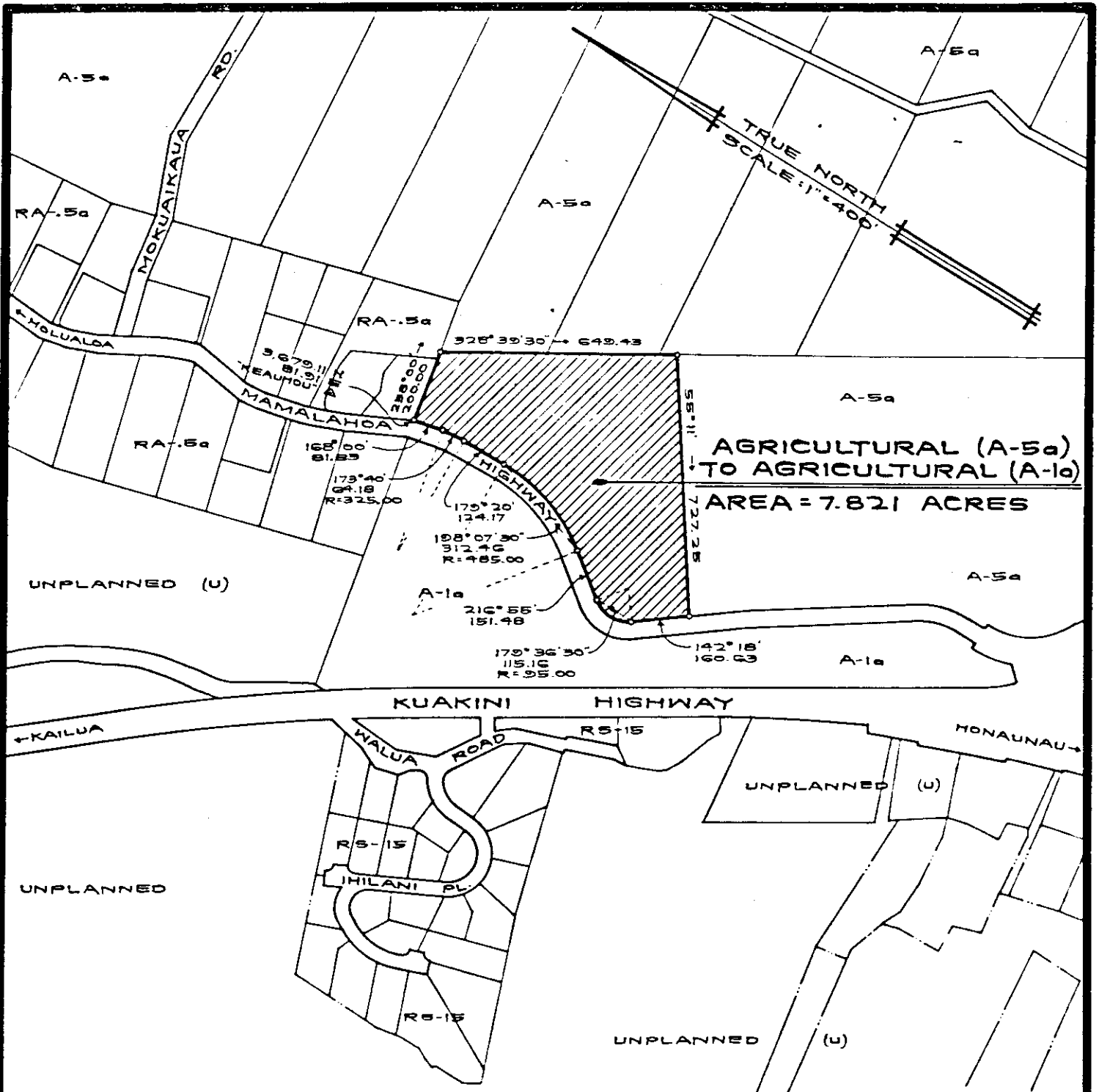

AMENDMENT TO THE ZONING CODE

AMENDING SECTION 25-87 (NORTH KONA ZONE MAP) ARTICLE 3, CHAPTER 25 (ZONING CODE) OF THE HAWAII COUNTY CODE, BY CHANGING THE DISTRICT CLASSIFICATION FROM AGRICULTURAL (A-5a) TO AGRICULTURAL (A-1a) AT KEAUKOU 1ST, NORTH KONA, HAWAII.

PREPARED BY: PLANNING DEPARTMENT
COUNTY OF HAWAII