

COUNTY OF HAWAII STATE OF HAWAII



Bill No. 206 (Draft 2)

ORDINANCE NO. 86 84

AN ORDINANCE AMENDING SECTION 25-103 (PUNA DISTRICT ZONE MAP), ARTICLE 3, CHAPTER 25 (ZONING CODE) OF THE HAWAII COUNTY CODE, BY CHANGING THE DISTRICT CLASSIFICATION FROM OPEN (O) TO AGRICULTURAL (A-1a) AT PUUA, PUNA, HAWAII, COVERED BY TAX MAP KEY 1-4-83:20.

BE IT ORDAINED BY THE COUNCIL OF THE COUNTY OF HAWAII:

SECTION 1. Section 25-103, Article 3, Chapter 25 (Zoning Code) of the Hawaii County Code, is amended to change the district classification of property described hereinafter as follows:

The district classification of the following area situated at Puua, Puna, Hawaii, shall be Agricultural (A-1a):

Beginning at the southeast corner of this parcel of land, being also the southwest corner of Lot 752 and on the northerly side of Roadway Lot 853 (Hilo Road), the coordinates of said point of beginning referred to Government Survey Triangulation Station "KAPOHO", being 5,448.88 feet North and 25,366.71 feet West, thence running by azimuths measured clockwise from True South:

- 1. 107° 36' 222.00 feet along Roadway Lot 853 (Hilo Road);
2. Thence along Roadway Lot 853 (northeast corner of the intersection of Hilo Road and Kapuna Road) on a curve to the right with a radius of 20.00 feet, the chord azimuth and distance being: 152° 36' 28.28 feet;
3. 197° 36' 148.25 feet along Roadway Lot 853 (Kapuna Road);

4. Thence along Roadway Lot 853 (southeast corner of the intersection of Kapuna Road and Mauna Kea Road) on a curve to the right with a radius of 20.00 feet, the chord azimuth and distance being:  

226° 02' 30"      19.05 feet;
5. 254° 29'                      129.60 feet along Roadway Lot 853 (Mauna Kea Road);
6. 332° 00'                      174.09 feet along Lot 754;
7. 17° 36'                        134.00 feet along Lot 752 to the point of beginning and containing an area of 49,714 Square Feet.

All as shown on the map attached hereto, marked Exhibit "A" and by reference made a part hereof.

SECTION 2. This change in district classification is conditioned upon the requirement that the applicants, successors or assigns shall be responsible for complying with all applicable rules, regulations and requirements. Further, should any of the conditions not be met or substantially complied with in a timely fashion, the director may initiate rezoning of the property to its original or more appropriate designation.

SECTION 3. In the event that any portion of this ordinance is declared invalid, such invalidity shall not affect the other parts of this ordinance.

SECTION 4. This ordinance shall take effect upon its approval.

INTRODUCED BY:

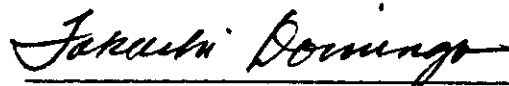

COUNCIL MEMBER, COUNTY OF HAWAII

Hilo, Hawaii

Date of Introduction:	July 16, 1986
Date of 1st Reading:	July 16, 1986
Date of 2nd Reading:	August 6, 1986
Effective Date:	August 19, 1986

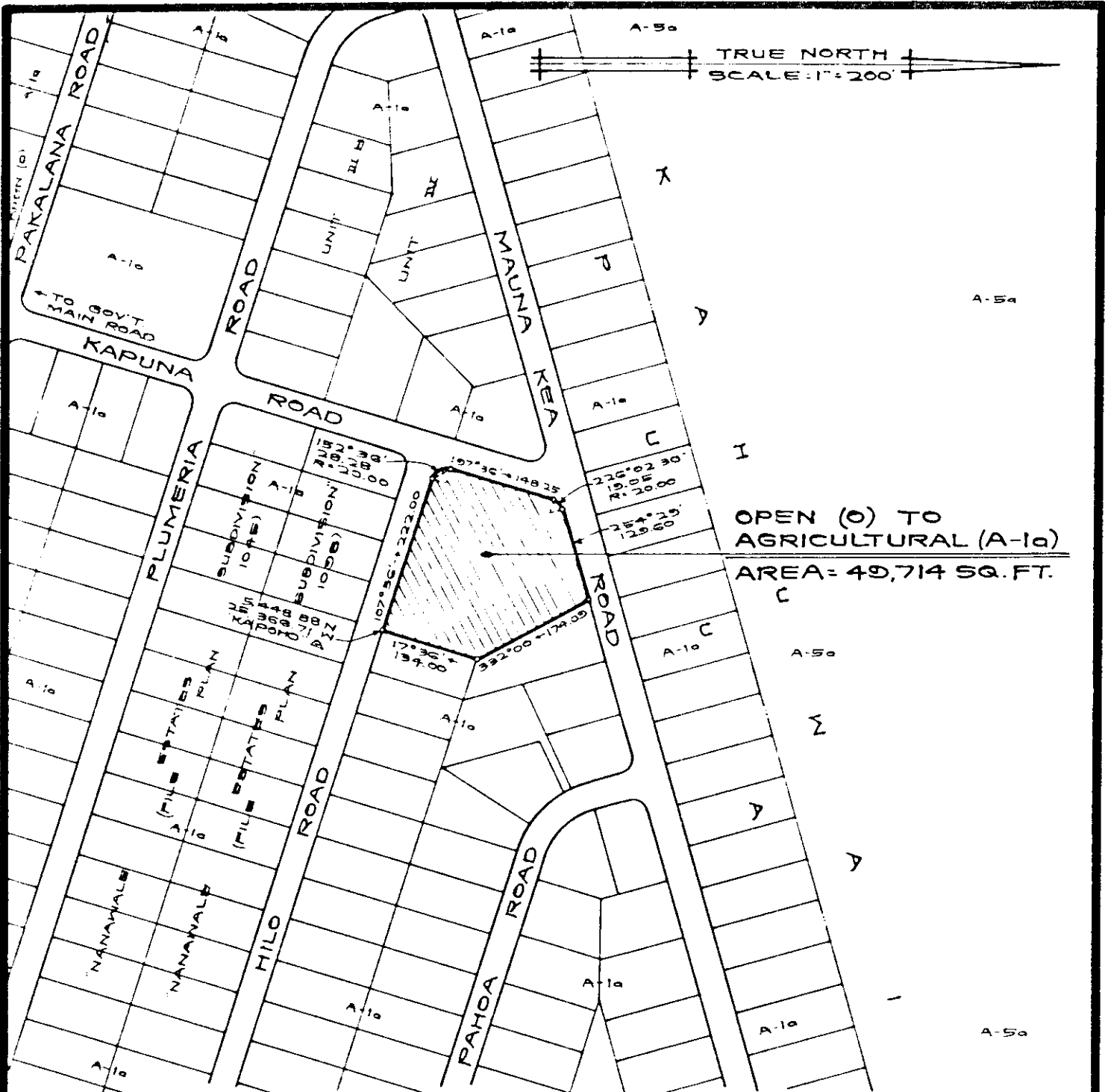

OPEN (O) TO  
AGRICULTURAL (A-1a)  
AREA = 49,714 SQ. FT.

# AMENDMENT TO THE ZONING CODE

AMENDING SECTION 25-103 (PUNA DISTRICT ZONE MAP) ARTICLE 3, CHAPTER 25 (ZONING CODE) OF THE HAWAII COUNTY CODE, BY CHANGING THE DISTRICT CLASSIFICATION FROM OPEN (O) TO AGRICULTURAL (A-1a) AT PUUA, PUNA, HAWAII.

PREPARED BY : PLANNING DEPARTMENT  
COUNTY OF HAWAII

TMK: 1-4-83:20

MAY 12, 1986

EXHIBIT "A"