

COUNTY OF HAWAII STATE OF HAWAII



Bill No. 267

ORDINANCE NO. 86 141

AN ORDINANCE AMENDING SECTION 25-114 (CITY OF HILO ZONE MAP) ARTICLE 3, CHAPTER 25 (ZONING CODE) OF THE HAWAII COUNTY CODE, BY CHANGING THE DISTRICT CLASSIFICATION FROM SINGLE FAMILY RESIDENTIAL (RS-10) TO NEIGHBORHOOD COMMERCIAL (CN-7.5) AT WAIAKEA, SOUTH HILO, HAWAII, COVERED BY TAX MAP KEY 2-2-34:98.

BE IT ORDAINED BY THE COUNCIL OF THE COUNTY OF HAWAII:

SECTION 1. Section 25-114, Article 3, Chapter 25 (Zoning Code) of the Hawaii County Code, is amended to change the district classification of property described hereinafter as follows:

The district classification of the following area situated at Waiakea, South Hilo, Hawaii, shall be Neighborhood Commercial (CN-7.5):

Beginning at a pipe at the northeast corner of this parcel of land, the coordinates of said point of beginning referred to Government Survey Triangulation Station "HALAI" being ,1663.00 feet South and 8,791.00 feet East and running by azimuths measured clockwise from True South:

1. 0° 00' 100.00 feet along Lot 15-B, remainder of Grant 9208 to Mary K. Kaaumoana or Heirs to a pipe on the northerly side of Kekuanaoa Street;
2. 90° 00' 80.00 feet along the northerly side of Kekuanaoa Street to a pipe;
3. 180° 00' 11.00 feet along Parcel "A" to a pipe;
4. 90° 00' 20.00 feet along Parcel "A" to a pipe on the easterly side of Mililani Street;

- 5. 180° 00' 89.00 feet along the easterly side of Mililani Street to a nail in concrete (found);
- 6. 270° 00' 100.00 feet along Lot 13, Grant 9638 to Louise K. Apu to the point of beginning and containing an area of 9,780 Square Feet.

SECTION 2. In the event that any portion of this ordinance is declared invalid, such invalidity shall not affect the other parts of this ordinance.

SECTION 3. This ordinance shall take effect upon its approval.

INTRODUCED BY:

Joseph D. ...

 COUNCIL MEMBER, COUNTY OF HAWAII

Hilo, Hawaii

Date of Introduction: December 3, 1986
 Date of 1st Reading: December 3, 1986
 Date of 2nd Reading: December 15, 1986
 Effective Date: December 23, 1986

TRUE NORTH
SCALE: 1" = 100'

MANONO

STREET

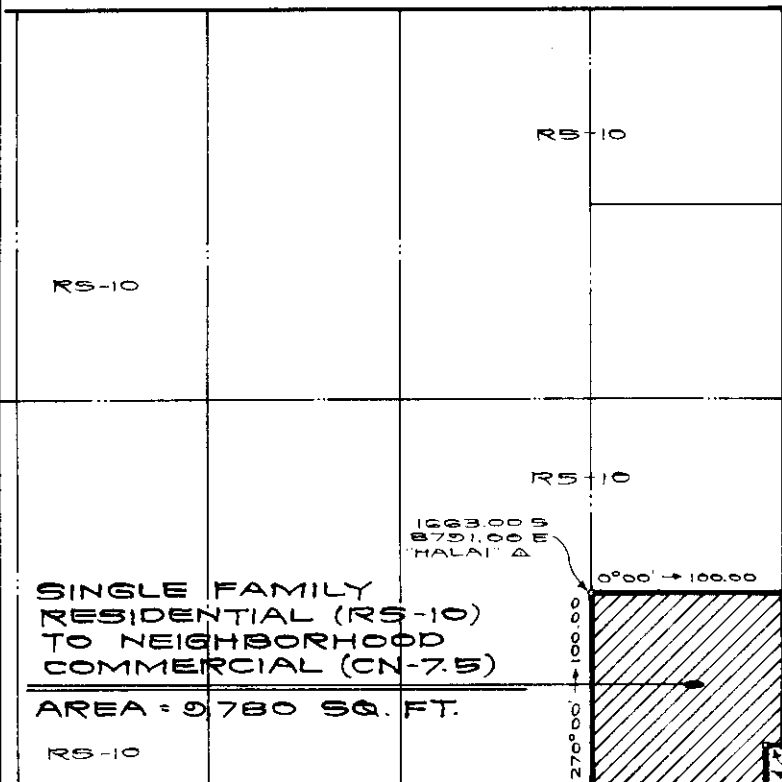

AIRPORT ↑

STREET

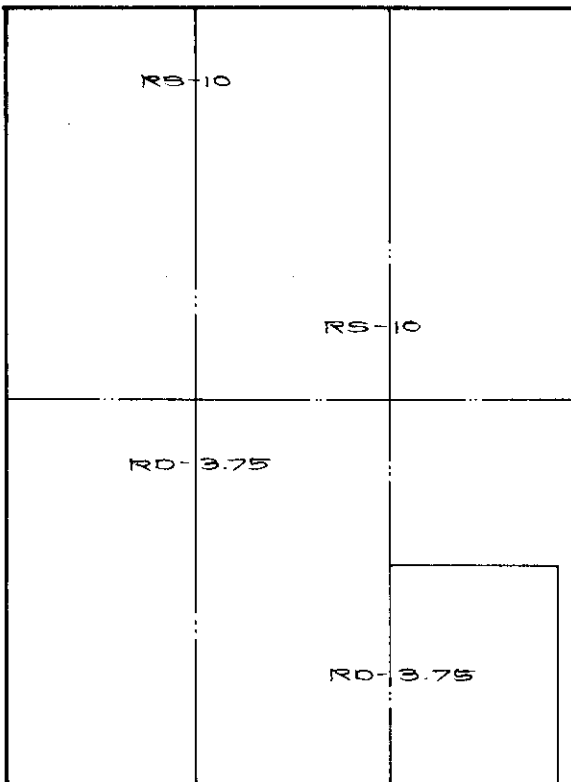

MILILANI

STREET

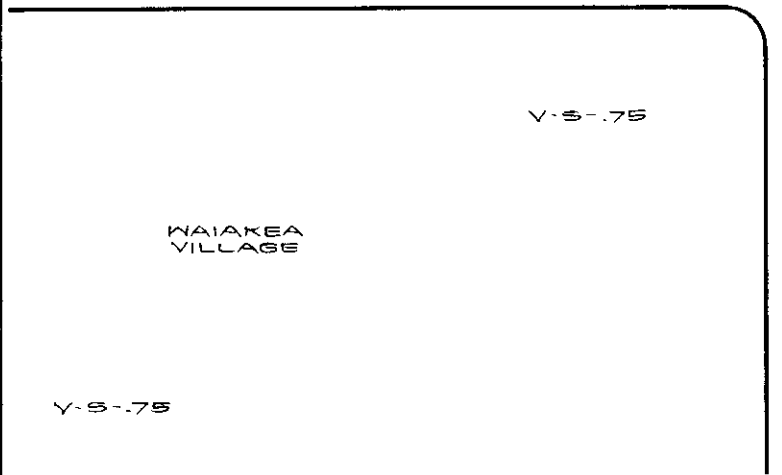

↑ KILAUEA AVENUE

↑ KILAUEA AVENUE

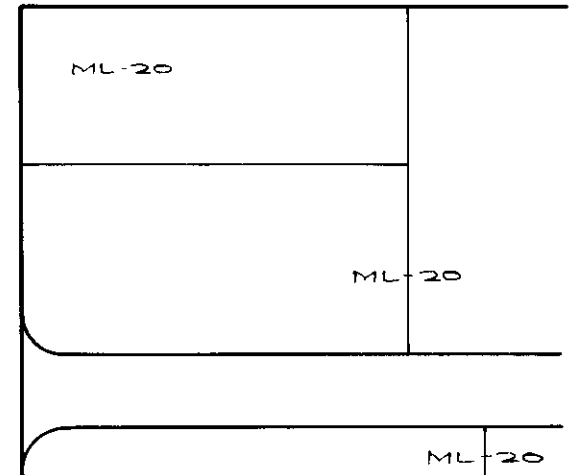

AMENDMENT TO THE ZONING CODE

AMENDING SECTION 25-114 (CITY OF HILO ZONE MAP) ARTICLE 3, CHAPTER 25 (ZONING CODE) OF THE HAWAII COUNTY CODE, BY CHANGING THE DISTRICT CLASSIFICATION FROM SINGLE FAMILY RESIDENTIAL (RS-10) TO NEIGHBORHOOD COMMERCIAL (CN-7.5) AT WAIAKEA, SOUTH HILO, HAWAII.

PREPARED BY : PLANNING DEPARTMENT
COUNTY OF HAWAII

TMK : 2-2-34 : 98

JUNE 19, 1986

EXHIBIT "A"