

# COUNTY OF HAWAII STATE OF HAWAII



Bill No. 337

## ORDINANCE NO. 87 48

AN ORDINANCE AMENDING SECTION 25-87 (NORTH KONA ZONE MAP) ARTICLE 3, CHAPTER 25 (ZONING CODE) OF THE HAWAII COUNTY CODE, BY CHANGING THE DISTRICT CLASSIFICATION FROM UNPLANNED (U) TO AGRICULTURAL (A-1a) AT O'OMA 1ST, NORTH KONA, HAWAII, COVERED BY TAX MAP KEY 7-3-07:44.

BE IT ORDAINED BY THE COUNCIL OF THE COUNTY OF HAWAII:

SECTION 1. Section 25-87, Article 3, Chapter 25 (Zoning Code) of the Hawaii County Code, is amended to change the district classification of property described hereinafter as follows:

The district classification of the following area situated at O'oma 1st, North Kona,, Hawaii, shall be Agricultural (A-1a):

Beginning at a found pipe at the Northeast corner of this parcel of land, being on the West side of Mamalahoa Highway, being also the Southeast corner of Lot 1, the coordinates of said point of beginning referred to Government Survey Triangulation Station "MOANUIAHEA" being 9,946.31 feet South and 8,343.60 feet West and running by azimuths measured clockwise from True South:

1. 347° 13' 00" 245.96 feet along the West side of Mamalahoa Highway to a nail in concrete;
2. 96° 59' 00" 172.12 feet along Lot 36, Kona Hills Estates to a pipe in concrete;
3. 108° 06' 00" 295.28 feet along Lots 35, 34 and 33, Kona Hills Estates to a pipe in concrete;
4. 103° 47' 00" 167.94 feet along Lots 33 and 32, Kona Hills Estates to a pipe in concrete;

5. 104° 32' 30" 230.65 feet along Lots 32 and 30, Kona Hills Estates to a pipe in concrete;
6. 173° 39' 00" 78.28 feet along Lot 51, along Grant 3805 to L. Kahinu to a pipe in concrete;
7. 179° 34' 00" 151.76 feet along Lot 51, along Grant 3805 to L. Kahinu to a pipe in concrete;
8. 275° 29' 30" 435.54 feet along the remainder of Grant 4343 to J. M. Lilinoe to a nail in concrete;
9. 5° 29' 30" 123.45 feet along Lot 1, along the remainder of Grant 4343 to J. M. Lilinoe to a nail in concrete;
10. 275° 29' 30" 373.25 feet along Lot 1, along the remainder of Grant 4343 to J. M. Lilinoe to the point of beginning and containing an area of 4.472 acres.

All as shown on the map attached hereto, marked Exhibit "A" and by reference made a part hereof.

SECTION 2. This change in district classification is conditioned upon the following: (A) the applicant, successors or its assigns shall be responsible for complying with all of the stated conditions of approval; (B) subdivision plans shall be submitted to the Planning Department within one year from the effective date of the zone change. Final subdivision approval shall be secured within one year from the date of receipt of tentative subdivision approval; (C) a drainage

system shall be installed in accordance with the requirements of the Department of Public Works; (D) access to the proposed development shall meet with the approval of the State Department of Transportation, Highways Division; and (E) all other applicable rules, regulations and requirements be complied with. The Planning Director may administratively grant extensions to the foregoing time conditions. Further, should any of the foregoing conditions not be met or substantially complied with in a timely fashion, the Planning Director may initiate rezoning of the property to its original or more appropriate designation.. Should any of the foregoing conditions not be met, rezoning of the area to its original or more appropriate zoning designation may be initiated.

SECTION 3. In the event that any portion of the ordinance is declared invalid, such invalidity shall not affect the other parts of this ordinance.

SECTION 4. This ordinance shall take effect upon its approval.

INTRODUCED BY:

  
COUNCIL MEMBER, COUNTY OF HAWAII

Hilo, Hawaii

Date of Introduction: April 15, 1987  
Date of 1st Reading: April 15, 1987  
Date of 2nd Reading: May 6, 1987  
Effective Date: May 11, 1987

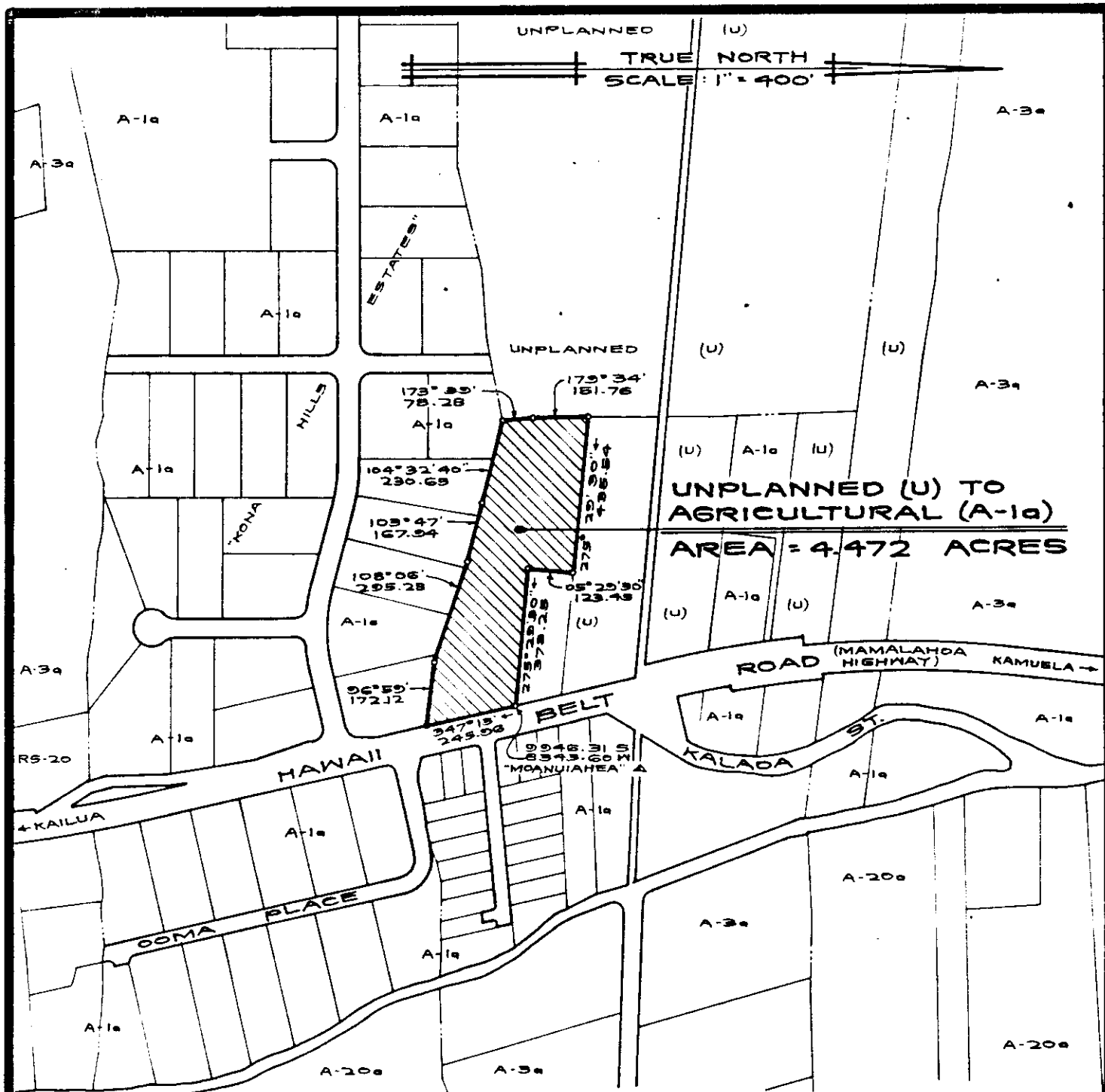

## AMENDMENT TO THE ZONING CODE

AMENDING SECTION 25-87 (NORTH KONA ZONE MAP) ARTICLE 3, CHAPTER 25 (ZONING CODE) OF THE HAWAII COUNTY CODE, BY CHANGING THE DISTRICT CLASSIFICATION FROM UNPLANNED (U) TO AGRICULTURAL (A-1a) AT O'OMA 1ST, NORTH KONA, HAWAII.

PREPARED BY : PLANNING DEPARTMENT  
COUNTY OF HAWAII