

COUNTY OF HAWAII STATE OF HAWAII

Bill No. 369

ORDINANCE NO. 87 72

AN ORDINANCE AMENDING SECTION 25-95A (NORTH AND SOUTH KOHALA DISTRICTS ZONE MAP), ARTICLE 3, CHAPTER 25 (ZONING CODE) OF THE HAWAII COUNTY CODE, BY CHANGING THE DISTRICT CLASSIFICATION FROM UNPLANNED (U) TO AGRICULTURAL (A-1a) AT WAIKOLOA, SOUTH KOHALA, HAWAII, COVERED BY TAX MAP KEY 6-8-01:PORTION OF 52.

BE IT ORDAINED BY THE COUNCIL OF THE COUNTY OF HAWAII:

SECTION 1. Section 25-95A, Article 3, Chapter 25 (Zoning Code) of the Hawaii County Code, is amended to change the district classification of property described hereinafter as follows:

The district classification of the following area situated at Waikoloa, South Kohala, Hawaii, shall be Agricultural (A-1a):

Beginning at the east corner of this parcel of land and on the northwest side of Queen Kaahumanu Highway, the coordinates of said point of beginning referred to Government Survey Triangulation Station "PUUHINAI" being 16,253.14 feet North and 19,175.73 feet West and running by azimuths measured clockwise from True South:

- 1. Following along Queen Kaahumanu Highway, along a curve to the right having a radius of 22,470.35 feet, the chord azimuth and distance being: 34° 00' 23" 215.04 feet;
2. 123° 56' 219.73 feet along the remainder of R.P. 5671, L.C. Aw. 8521-B, Apana 1 to G.D. Hueu;
3. 213° 56' 215.04 feet along the remainder of R.P. 5671, L.C. Aw. 8521-B, Apana 1 to G.D. Hueu;

4. 303° 56' 220.00 feet along the remainder of R.P. 5671, L.C. Aw. 8521-B, Apana 1 to G.D. Hueu to the point of beginning and containing an area of 47,317 Square Feet.

All as shown on the map attached hereto, marked Exhibit "A" and by reference made a part hereof.

SECTION 2. This change in district classification is conditioned upon the following: (A) the petitioner shall submit the required water commitment payment to the Department of Water Supply in accordance with its "Water Commitment Guidelines Policy" within ninety days from the date of approval of the change of zone. The zoning of the property shall not be in effect until the water commitment payment is accepted by the Department of Water Supply; (B) the applicant, its successors or assigns shall comply with all of the state conditions of approval, including those required in Special Management Area (SMA) Use Permit No. 240 and Special Permit No. 619; (C) subdivision plans shall be submitted for tentative approval within one year from the effective date of the change of zone; (D) a drainage system as required by the Department of Public Works shall be installed; and (E) all other applicable rules, regulations and requirements shall be complied with. The Planning Director may administratively grant extensions to the foregoing conditions. Further, should any of the conditions not be met or substantially complied with in a timely fashion, the Director may initiate procedures to rezone the property to its original zoning designation.

SECTION 3. In the event that any portion of this ordinance is declared invalid, such invalidity shall not affect the other parts of this ordinance.

SECTION 4. This ordinance shall take effect upon its approval.

INTRODUCED BY:

  
COUNCIL MEMBER, COUNTY OF HAWAII

Hilo, Hawaii

Date of Introduction: June 15, 1987  
Date of 1st Reading: June 15, 1987  
Date of 2nd Reading: July 1, 1987  
Effective Date: July 13, 1987

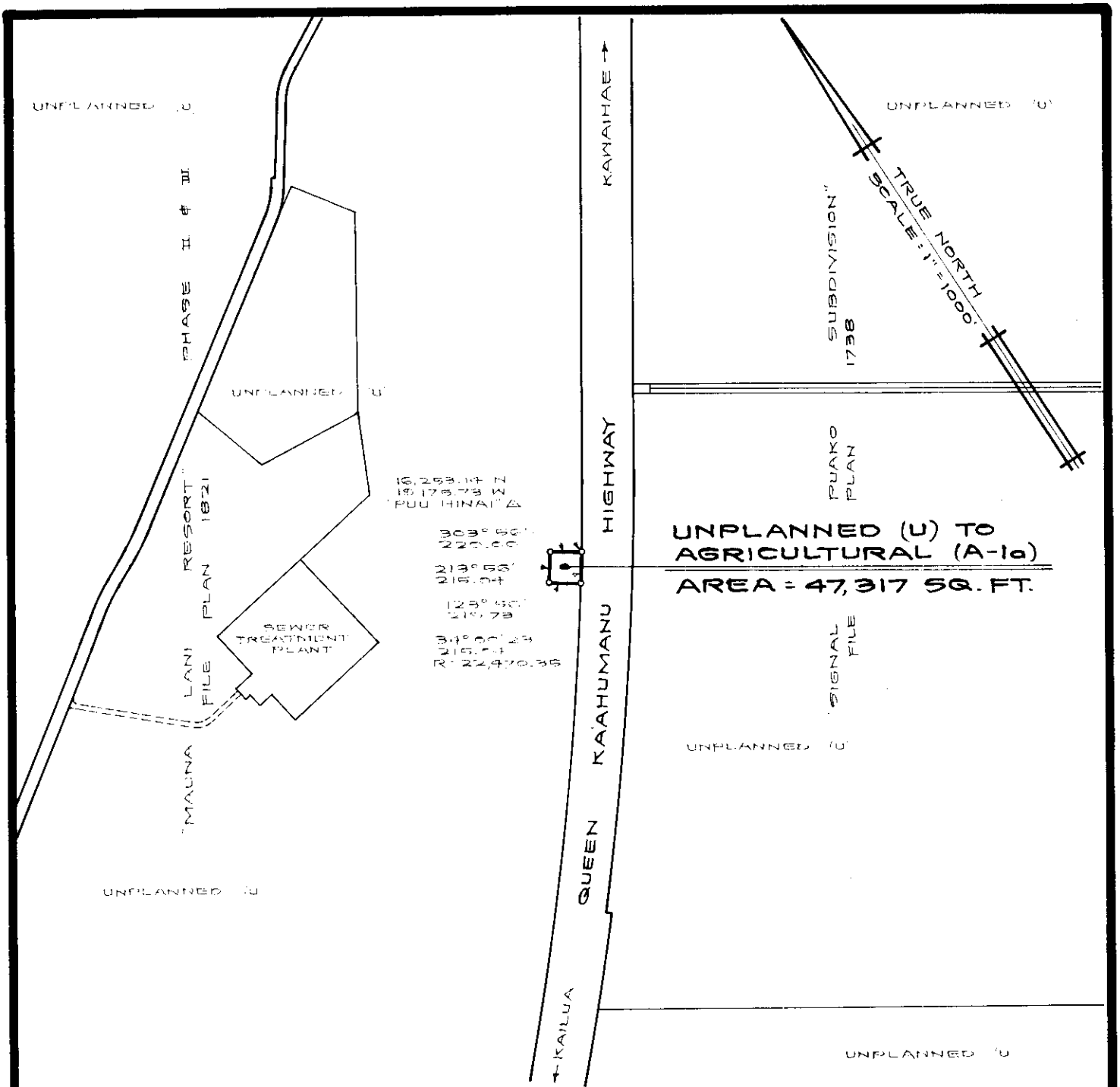

## AMENDMENT TO THE ZONING CODE

AMENDING SECTION 25-95 A (NORTH AND SOUTH KOHALA DISTRICTS ZONE MAP) ARTICLE 3, CHAPTER 25 (ZONING CODE) OF THE HAWAII COUNTY CODE, BY CHANGING THE DISTRICT CLASSIFICATION FROM UNPLANNED (U) TO AGRICULTURAL (A-1a) AT WAIKOLOA, SOUTH KOHALA, HAWAII.

PREPARED BY: PLANNING DEPARTMENT  
COUNTY OF HAWAII

TMK: 6-8-01: PORTION OF 52

APRIL 22, 1987

EXHIBIT "A"