

COUNTY OF HAWAII STATE OF HAWAII

BILL NO. 374

ORDINANCE NO. 91 2

AN ORDINANCE REPEALING ORDINANCE NO. 323, AND AMENDED BY ORDINANCE NO. 89 133, WHICH AMENDED SECTION 7.03, CURRENTLY SECTION 25-88, THE SOUTH KONA ZONE MAP, ARTICLE 2, CHAPTER 8, CURRENTLY ARTICLE 3, CHAPTER 25 (ZONING CODE) OF THE HAWAII COUNTY CODE 1983, AS AMENDED, AND CHANGED THE DISTRICT CLASSIFICATION FROM SINGLE FAMILY RESIDENTIAL (RS-15) TO NEIGHBORHOOD COMMERCIAL (CN-10) AT HALEKII, SOUTH KONA, HAWAII, COVERED BY TAX MAP KEY 8-1-01:25 (FORMERLY 8-1-01:25, 27 AND PORTIONS OF 13 AND 15). UPON THE REPEAL OF ORDINANCE NO. 323, AS AMENDED, THE PROPERTY SHALL BE DESIGNATED BY THE DISTRICT CLASSIFICATION OF SINGLE FAMILY RESIDENTIAL (RS-15).

BE IT ORDAINED BY THE COUNCIL OF THE COUNTY OF HAWAII:

SECTION 1. Ordinance No. 323 and amended by Ordinance No. 89 133, which amended Section 7.03, currently Section 25-88, the South Kona Zone Map, Article 2, Chapter 8, currently Article 3, Chapter 25, (Zoning Code) of the Hawaii County Code as amended is hereby repealed in its entirety.

[SECTION 1. Section 7.03 of Chapter 8 (Zoning Code), Article 2, Hawaii County Code, as amended, is hereby further amended by adding thereto the following subsection:

"7.03(). The district classification of the following area situated at Halekii, South Kona, Hawaii, shall be Neighborhood Commercial (CN-10):

Beginning at the southeast corner of this parcel of land, being also the southwest corner of Lot "A" (portion of L.C. Aw. 387, Part 4, Section 2 to the American Board of Commissioners for Foreign Missions), the coordinates of said point of beginning referred to Government Survey Triangulation Station "PUU OHAU" being 2373.56 feet North and 12341.73 feet East and running by azimuths measured clockwise from True South:

1.	94° 33' 30"	156.86 feet along the remainder of a portion of L.C. Aw. 387, Part 4, Section 2 to the American Board of Commissioners for Foreign Missions;
2.	99° 30'	45.00 feet along Lot 14 (portion of L.C. Aw. 387, Part 4, Section 2 to the American Board of Commissioners for Foreign Missions);
3.	95° 28'	95.79 feet along same;
4.	90° 19' 30"	17.60 feet along same;
5.	84° 05' 30"	298.35 feet along the remainder of a portion of L.C. Aw. 387, Part 4, Section 2 to the American Board of Commissioners for Foreign Missions;
6.	181° 00'	291.51 feet along Lot 1 (portion of L.C. Aw. 387, Part 4, Section 2 to the American Board of Commissioners for Foreign Missions);
7.	272° 55'	19.66 feet along Kona Hospital Site;
8.	266° 55'	52.00 feet along Kona Hospital Site;
9.	274° 26'	39.00 feet along Kona Hospital Site;
10.	269° 02'	169.00 feet along Kona Hospital Site;
11.	265° 15'	42.00 feet along Kona Hospital Site;
12.	272° 00'	105.00 feet along Kona Hospital Site;
13.	270° 25'	54.87 feet along Kona Hospital Site;

14. 270° 24' 30" 66.44 feet along Kona Hospital Site;
15. 348° 44' 296.15 feet along Lot "A" (portion of L.C. Aw. 387 Part 4, Section 2 to the American Board of Commissioners for Foreign Missions) to the point of beginning and containing an area of 3.671 Acres.

"All as outlined in red on the map attached hereto, marked Exhibit 'A' and by reference made a part hereof."

SECTION 2. Section 1 of this ordinance shall take effect forthwith upon the conditions that (A) construction of the proposed facility commence within one (1) year from the effective date of this amendment and be completed within two (2) years thereafter; (B) prior to construction, in accordance with Chapter 323, Hawaii Revised Statutes, as amended, the petitioner shall obtain a Certificate of Need from the appropriate State agency; (C) the rules, regulations and requirements of the State Department of Health and the Department of Water Supply shall be complied with; and (D) all other applicable rules and regulations including the Plan Approval process shall be complied with. Should any of the foregoing conditions not be met, rezoning of the area to its original zoning designation may be initiated.]

SECTION 2. The property shall be reclassified back to its original Single Family Residential (RS-15) zoned district as shown on the map attached hereto, marked Exhibit "A" and by reference made a part hereof.

SECTION 3. Material to be repealed is bracketed.

SECTION 4. This ordinance shall take effect upon its approval.

INTRODUCED BY:

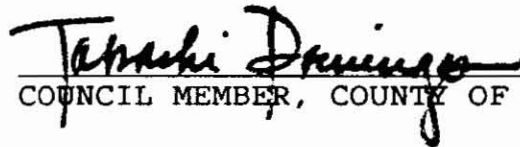
COUNCIL MEMBER, COUNTY OF HAWAII

Hilo, Hawaii

Date of Introduction:	December 19, 1990
Date of 1st Reading:	December 19, 1990
Date of 2nd Reading:	January 3, 1991
Effective Date:	January 11, 1991

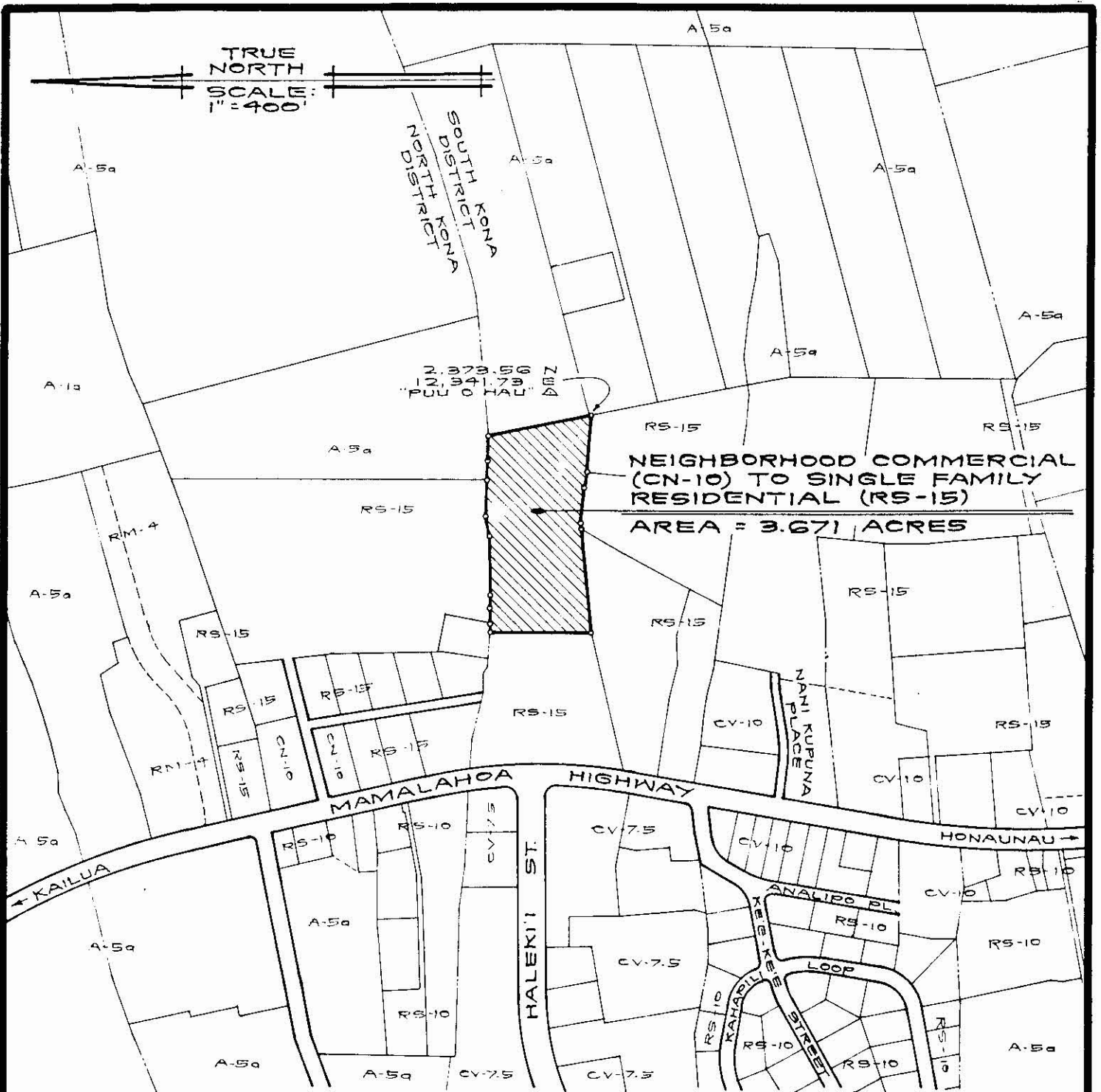

AMENDMENT TO THE ZONING CODE

REPEAL OF ORDINANCE NO. 323 AND AMENDED BY ORDINANCE NO. 89-133, WHICH AMENDED SECTION 203, CURRENTLY SECTION 25-88, THE SOUTH KONA ZONE MAP, ARTICLE 2, CHAPTER 8, CURRENTLY ARTICLE 3, CHAPTER 25 (ZONING CODE) OF THE HAWAII COUNTY CODE, AS AMENDED, AND CHANGED THE DISTRICT CLASSIFICATION FROM SINGLE FAMILY RESIDENTIAL (RS-15) TO NEIGHBORHOOD COMMERCIAL (CN-10) AT HALEKII, SOUTH KONA, HAWAII. UPON THE REPEAL OF ORDINANCE NO. 323, AS AMENDED BY ORDINANCE NO. 89-133, THE SUBJECT PROPERTY SHALL BE DESIGNATED BY THE DISTRICT CLASSIFICATION OF SINGLE FAMILY RESIDENTIAL (RS-15).

PREPARED BY: PLANNING DEPARTMENT
COUNTY OF HAWAII