

COUNTY OF HAWAII STATE OF HAWAII

BILL NO. 458

ORDINANCE NO. 91 84

AN ORDINANCE AMENDING SECTION 25-86 (NORTH AND SOUTH KONA DISTRICTS ZONE MAP) ARTICLE 3, CHAPTER 25 (ZONING CODE) OF THE HAWAII COUNTY CODE, BY CHANGING THE DISTRICT CLASSIFICATION FROM OPEN (O) TO RESORT-HOTEL (V-7) AND FROM RESORT-HOTEL (V-7) TO OPEN (O) AT KAUPULEHU, NORTH KONA, HAWAII, COVERED BY TAX MAP KEY 7-2-03:PORTION OF 2.

BE IT ORDAINED BY THE COUNCIL OF THE COUNTY OF HAWAII:

SECTION 1. Section 25-86, Article 3, Chapter 25 (Zoning Code) of the Hawaii County Code, is amended to change the district classification of properties described hereinafter as follows:

The district classification of the following area situated at Kaupulehu, North Kona, Hawaii, shall be Resort-Hotel (V-7):

PARCEL 1:

Beginning at the East corner of this parcel of land, about fifty (50) feet Southeast of the shoreline, the coordinates of said point of beginning referred to Government Survey Triangulation Station "AKAHIPUU" being 28,438.66 feet North and 6,532.88 feet West and running by azimuths measured clockwise from true South:

- 1. 64° 00' 48" 203.81 feet;
2. 154° 00' 48" 24.00 feet;
3. 242° 10' 48" 59.00 feet;
4. 254° 08' 48" 147.14 feet to the point of beginning and containing an area of 3346 square feet, more or less. (Refer to Parcel 1 as shown on Exhibit "A")

The district classification of the following area situated at Kaupulehu, North Kona, Hawaii, shall be Resort-Hotel (V-7):

PARCEL 2:

Beginning at the South corner of this parcel of land, about fifty (50) feet Southeast of the shoreline, the coordinates of said point of beginning referred to Government Survey Triangulation Station "AKAHIPUU" being 28,489.70 feet North and 6,457.15 feet West and running by azimuths measured clockwise from true South:

1. 206° 14' 48" 40.00 feet;
2. 212° 01' 48" 69.00 feet;
3. 235° 00' 48" 89.60 feet;
4. 315° 00' 48" 12.81 feet;
5. 45° 00' 48" 193.35 feet to the point of beginning and containing an area of 3447 square feet, more or less.
(Refer to Parcel 2 as shown on Exhibit "A")

The district classification of the following area situated at Kaupulehu, North Kona, Hawaii, shall be Open (O):

PARCEL 3:

Beginning at the West corner of this parcel of land, about 350 feet Southeast of the shoreline, the coordinates of said point of beginning referred to Government Survey Triangulation Station "AKAHIPUU" being 28,354.32 feet North and 6,024.48 feet West and running by azimuths measured clockwise from true South:

1. 268° 27' 48" 397.08 feet;
2. 231° 11' 18" 56.49 feet;

3. 94° 00' 48" 353.78 feet to the point of beginning and containing an area of 6793 square feet, more or less. (Refer to Parcel 3 as shown on Exhibit "A")

All as shown on the map attached hereto, marked Exhibit "A" and by reference made a part hereof.

SECTION 2. These changes in district classification are conditioned upon the following: (A) the applicant, successors or its assigns shall comply with conditions of Change of Zone Ordinance No. 87-113 and Special Management Area Use Permit No. 260.

SECTION 3. In the event that any portion of the ordinance is declared invalid, such invalidity shall not affect the other parts of this ordinance.

SECTION 4. This ordinance shall take effect upon its approval.

INTRODUCED BY:

COUNCIL MEMBER, COUNTY OF HAWAII

Hilo, Hawaii

Date of Introduction: August 7, 1991
Date of 1st Reading: August 7, 1991
Date of 2nd Reading: August 21, 1991
Effective Date: August 29, 1991

APPROVED AS TO FORM AND LEGALITY:

DEPUTY CORPORATION COUNSEL

DATE: 6/25/91

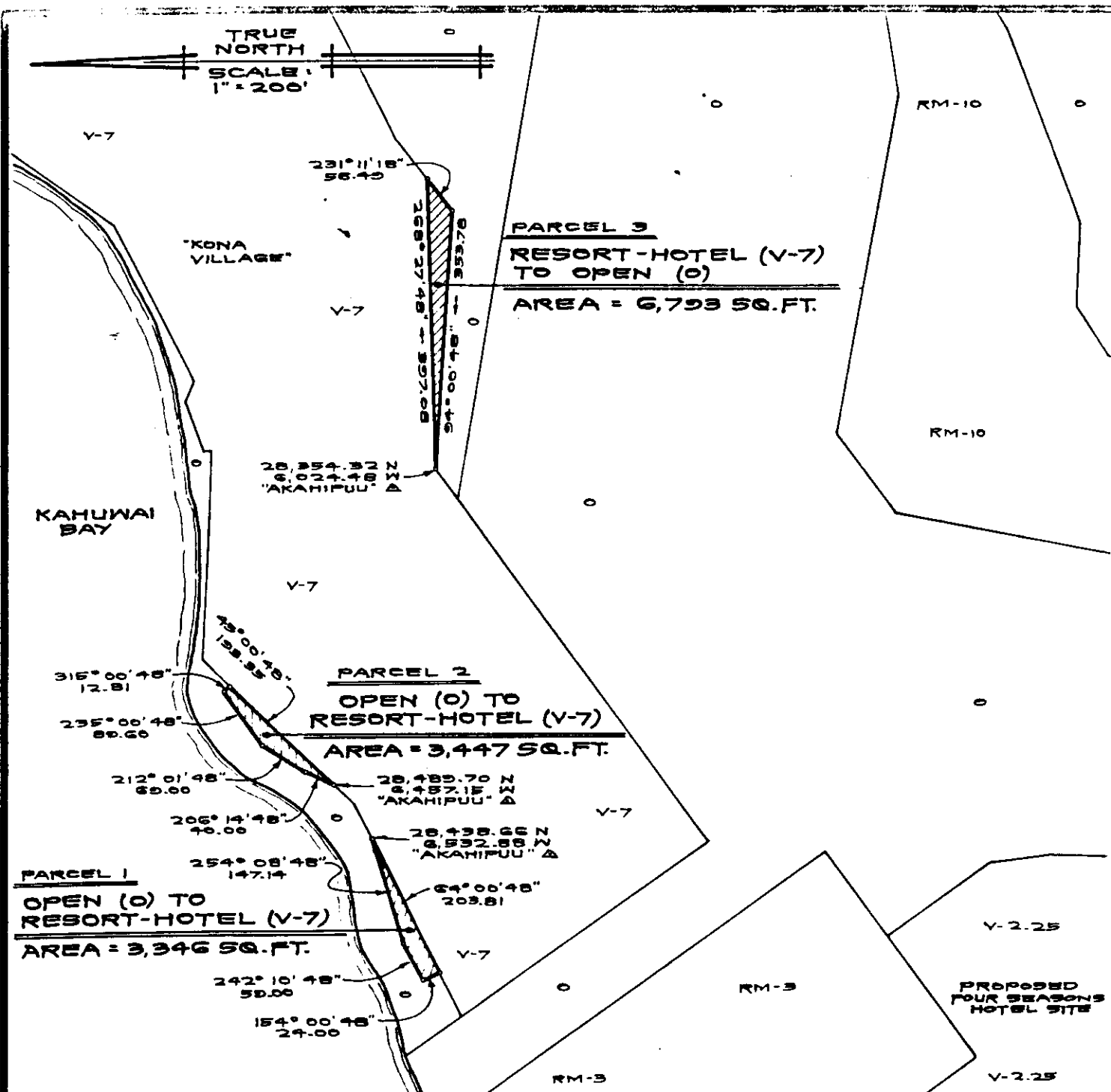

AMENDMENT TO THE ZONING CODE

AMENDING SECTION 25-86 (NORTH AND SOUTH KONA DISTRICTS ZONE MAP) ARTICLE 3, CHAPTER 25 (ZONING CODE) OF THE HAWAII COUNTY CODE BY CHANGING THE DISTRICT CLASSIFICATION FROM OPEN (O) TO RESORT-HOTEL (V-7) AND FROM RESORT-HOTEL (V-7) TO OPEN (O) AT KAUPULEHU, NORTH KONA, HAWAII.

PREPARED BY: PLANNING DEPARTMENT
COUNTY OF HAWAII

TMK: 7-2-03: PORTIONS OF 2

JUNE 3, 1991

EXHIBIT "A"

(AIRCOA HOSPITALITY SERVICES, INC.)