

COUNTY OF HAWAII STATE OF HAWAII

BILL NO. 321  
(Draft 2)

ORDINANCE NO. 96 131

AN ORDINANCE REPEALING ORDINANCE NO. 90-96 WHICH AMENDED SECTION 25-87 (NORTH KONA ZONE MAP), ARTICLE 3, CHAPTER 25 (ZONING CODE) OF THE HAWAII COUNTY CODE, BY CHANGING THE DISTRICT CLASSIFICATION FROM UNPLANNED (U) TO SINGLE FAMILY RESIDENTIAL (RS-15) AND AGRICULTURAL (A-1a) AT LAALOA 1st AND 2nd AND KAPALAALAEA 1st, NORTH KONA, HAWAII, COVERED BY TAX MAP KEY 7-7-07:30 (PORTION).

BE IT ORDAINED BY THE COUNCIL OF THE COUNTY OF HAWAII:

SECTION 1. Ordinance No. 90-96 which amended Section 25-87 (North Kona Zone Map), Article 3, Chapter 25 (Zoning Code) of the Hawaii County Code, as amended, is hereby repealed in its entirety and the subject property shall be classified back to its original zoning district.

SECTION 2. Section 25-87, Article 3, Chapter 25 (Zoning Code) of the Hawaii County Code, is amended to change the district classification of property described hereinafter as follows:

The district classification of the following area situated at Laaloa 1st and 2nd,

North Kona, Hawaii, shall be Unplanned (U):

Parcel 1

Beginning at the Southwesterly corner of this parcel of land, being also the Southeasterly corner of Lot 52 of Kuakini Heights Subdivision, Unit II, the coordinates of said point of beginning referred to Government Survey Triangulation Station "KAILUA (NORTH MERIDIAN)" being 18,224.13 feet South and 13,495.78 feet East and running by azimuths clockwise from True South:

1. 179° 13' 1,301.21 feet along Lots 52, 51, 50, 48, 47, 26, Ainanani Street, Lots 25, 24, 20, 19, 11, 10 and 9 of the Kuakini Heights Subdivision, Unit II, to a point;
2. 173° 52' 30" 158.23 feet along Lot 9 of Kuakini Heights Subdivision, Unit II to a point;
3. 165° 40' 40" 84.78 feet along Lot 8 of Kuakini Heights Subdivision, Unit II to a point;

Thence, for the next nine (9) courses following along Grant 1869 to Kekamakahi:

4. 227° 16' 31.25 feet to a point;
5. 249° 11' 30" 31.17 feet to a point;
6. 243° 57' 30" 189.75 feet to a point;
7. 235° 39' 37.16 feet to a point;
8. 242° 54' 81.63 feet to a point;
9. 256° 36' 30" 46.42 feet to a point;
10. 245° 51' 30" 58.57 feet to a point;
11. 248° 43' 35.63 feet to a point;
12. 258° 19' 60.00 feet to a point;

Thence, for the next twelve (12) courses following along the remainders of Land Commission Award 7716, Apana 4 to R. Keelikolani, Grant 1757 to Kanewa, and Land Commission Award 4452, Apana 2 to Kalama:

13. 345° 23' 87.71 feet to a point;
14. 69° 15' 176.50 feet to a point;
15. 16° 37' 176.12 feet to a point;
16. 344° 07' 265.61 feet to a point;

17.	9° 50'	177.82	feet to a point;
18.	333° 07'	177.32	feet to a point;
19.	352° 24'	177.18	feet to a point;
20.	339° 37'	48.46	feet to a point;
21.	352° 18'	191.18	feet to a point;
22.	345° 56'	173.09	feet to a point;
23.	12° 03'	110.55	feet to a point;
24.	335° 49'	70.76	feet to a point;

Thence, for the next thirteen (13) courses following along Grant 3019 to Kaaipulu:

25.	79° 28' 45"	59.15	feet to a point;
26.	74° 38' 30"	25.30	feet to a point;
27.	84° 21' 30"	29.58	feet to a point;
28.	69° 59'	38.62	feet to a point;
29.	79° 01' 30"	73.99	feet to a point;
30.	62° 30'	25.56	feet to a point;
31.	52° 53'	28.61	feet to a point;
32.	73° 30' 50"	75.44	feet to a point;
33.	96° 43'	17.60	feet to a point;
34.	84° 12'	32.46	feet to a point;
35.	91° 09' 30"	32.88	feet to a point;
36.	77° 28' 30"	39.75	feet to a point;

37. 45.13 feet to the point of beginning and containing an area of 14.999 Acres. (Refer to Parcel 1 as shown on Exhibit "A").

The district classification of the following area situated at Laaloa 1st & 2nd and Kapalaalaea 1st, North Kona, Hawaii shall be Unplanned (U):

Parcel 2

Beginning at the Northeastly corner of this parcel of land, being also the Northwestly corner of Parcel 24 of TMK: 7-7-07, the coordinates of said point of beginning referred to Government Survey Triangulation Station "KAILUA (NORTH MERIDIAN)" being 16,404.53 feet South and 14,120.77 feet East and running by azimuths measured clockwise from True South:

1.	345° 13'	30"	202.08	feet along the remainder of Land Commission Award 7716, Apana 4 to R. Keelikolani to a point;
2.	344° 53'		281.47	feet along Land Commission Award 7716, Apana 4 to R. Keelikolani to a point;
3.	253° 41'		300.00	feet along Land Commission Award 7716, Apana 4 to R. Keelikolani to a point;
4.	343° 41'		302.16	feet along the remainder of Grant 1751 to Kanewa;
5.	78° 35'	05"	48.01	feet along the remainder of Grant 1757 to Kanewa;
6.	359° 05'	30"	225.03	feet along the remainder of Grant 1757 to Kanewa;
7.	359° 22'	50"	153.05	feet along the remainder of Grant 1757 to Kanewa and along the remainder of Land Commission Award 4452, Apana 2 to Kalamā to a point;

Thence, along the next three (3) courses following along the remainder of Land Commission Award 4452, Apana 2 to Kalamā:

- 8. 359° 14' 20" 201.24 feet to a point;
- 9. 254° 58' 50" 469.00 feet to a point;
- 10. 354° 00' 217.95 feet to a point;

Thence, for the next nineteen (19) courses following along Grant 3019 to Kaaipulu:

- 11. 77° 34' 64.68 feet to a point;
- 12. 66° 59' 49.87 feet to a point;
- 13. 74° 21' 10" 69.30 feet to a point;
- 14. 64° 10' 49.60 feet to a point;
- 15. 82° 56' 30" 52.06 feet to a point;
- 16. 74° 34' 30" 63.63 feet to a point;
- 17. 84° 30' 41.32 feet to a point;
- 18. 78° 20' 50" 67.51 feet to a point;
- 19. 68° 54' 30" 31.85 feet to a point;
- 20. 57° 46' 23.84 feet to a point;
- 21. 68° 29' 30" 82.09 feet to a point;
- 22. 74° 44' 30" 39.55 feet to a point;
- 23. 66° 03' 50" 168.06 feet to a point;
- 24. 67° 55' 30" 98.93 feet to a point;
- 25. 73° 18' 30" 79.85 feet to a point;
- 26. 61° 27' 30" 23.11 feet to a point;
- 27. 78° 01' 33.37 feet to a point;

- 28. 68° 02' 30" 25.48 feet to a point;
- 29. 79° 28' 45" 52.80 feet to a point;

Thence, for the next twelve (12) courses following along the remainders of Land Commission Award 4452, Apana 2 to Kalama, Grant 1757 to Kanewa, and Land Commission Award 7716, Apana 4 to R. Keelikolani, the azimuths and distances being:

- 30. 155° 49' 70.76 feet to a point;
- 31. 192° 03' 110.55 feet to a point;
- 32. 165° 56' 173.09 feet to a point;
- 33. 172° 18' 191.18 feet to a point;
- 34. 159° 37' 48.46 feet to a point;
- 35. 172° 24' 177.18 feet to a point;
- 36. 153° 07' 177.32 feet to a point;
- 37. 189° 50' 177.82 feet to a point;
- 38. 164° 07' 265.61 feet to a point;
- 39. 196° 37' 176.12 feet to a point;
- 40. 249° 15' 176.50 feet to a point;
- 41. 165° 23' 87.71 feet to a point;
- 42. 258° 19' 29.39 feet along Grant 1869 to Kekamakahi to a point;
- 43. 253° 42' 30" 141.03 feet along Grant 1869 to Kekamakahi to the point of beginning and containing an area of 24.155 Acres. (Refer to Parcel 2 as shown on Exhibit "A").

All as shown on the map attached hereto, marked Exhibit "A" and by reference made a part hereof.

SECTION 3. Material to be deleted is bracketed. New material is underscored.

SECTION 4. In the event that any portion of this ordinance is declared invalid, such invalidity shall not affect the other parts of this ordinance.

SECTION 5. This ordinance shall take effect upon its approval.

INTRODUCED BY:

  
\_\_\_\_\_  
COUNCIL MEMBER, COUNTY OF HAWAII

Hilo, Hawaii

Date of Introduction: October 2, 1996  
Date of 1st Reading: October 2, 1996  
Date of 2nd Reading: October 16, 1996  
Effective Date: October 23, 1996

APPROVED AS TO FORM AND LEGALITY

  
\_\_\_\_\_  
DEPUTY CORPORATION COUNSEL

DATED: 10/21/96

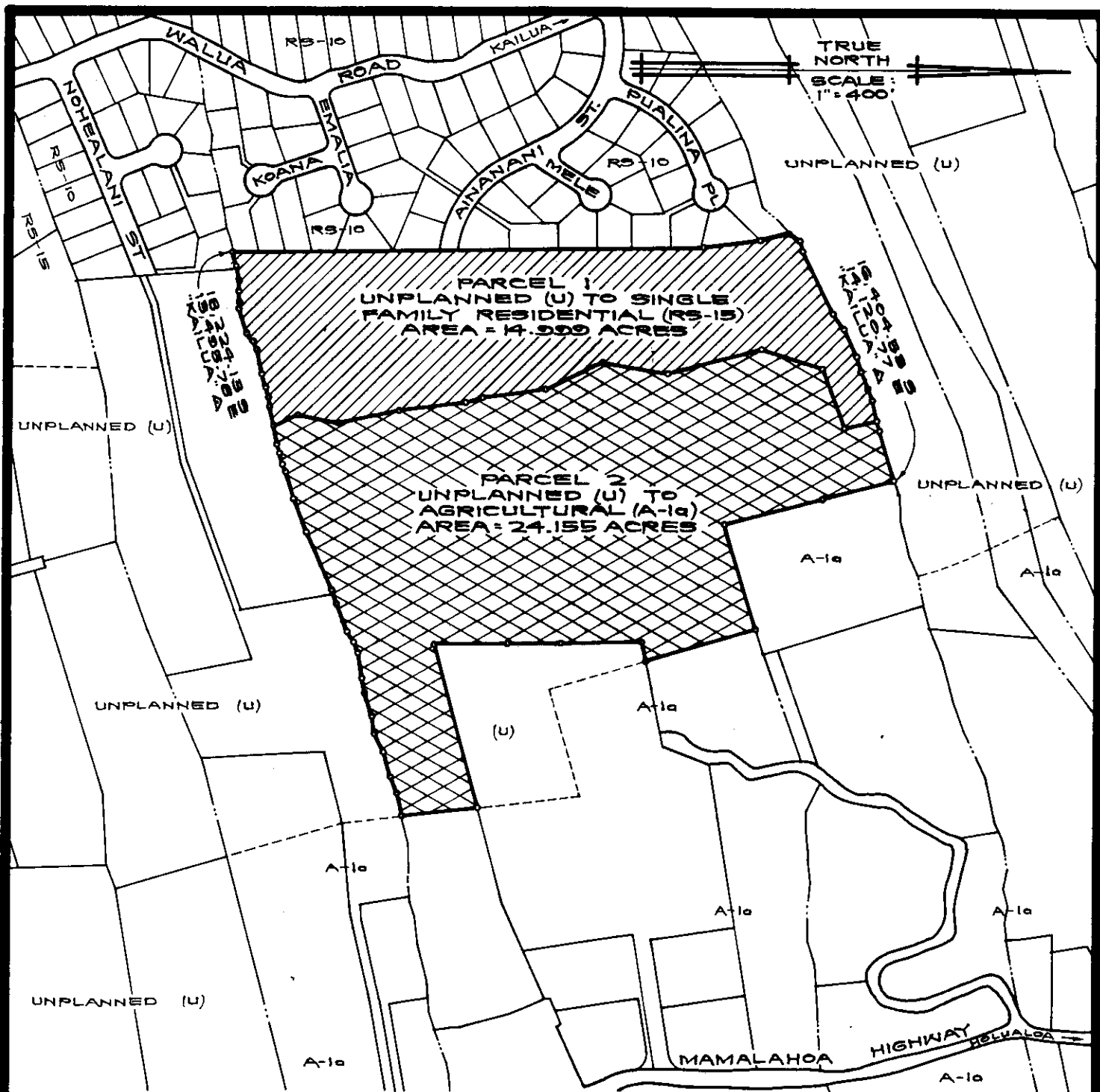

## AMENDMENT TO THE ZONING CODE

AMENDING SECTION 25-87 (NORTH KONA ZONE MAP) ARTICLE 3, CHAPTER 25 (ZONING CODE) OF THE HAWAII COUNTY CODE, BY CHANGING THE DISTRICT CLASSIFICATION FROM UNPLANNED (U) TO SINGLE FAMILY RESIDENTIAL (RS-15) AND AGRICULTURAL (A-1a) AT LAALOA 1ST & 2ND AND KAPALAALAEA 1ST, NORTH KONA, HAWAII.

PREPARED BY: PLANNING DEPARTMENT  
COUNTY OF HAWAII

TMK: 7-7-07: 30 (PORTION)

AUG. 25, 1988



OFFICE OF THE COUNTY CLERK

County of Hawaii

Hilo, Hawaii

96 OCT 23 PM 3 02  
(DRAFT 2)

Introduced By: Takashi Domingo  
 Date Introduced: October 2, 1996  
 First Reading: October 2, 1996  
 Published: N/A

REMARKS:

\_\_\_\_\_  
 \_\_\_\_\_  
 \_\_\_\_\_  
 \_\_\_\_\_

OFFICE OF THE COUNTY CLERK				
ROLL CALL VOTE				
COUNTY OF HAWAII	AYES	NOES	ABS	EX
Arakaki	X			
Easley	X			
Childs	X			
De Lima	X			
Domingo	X			
Osorio	X			
Van De Car	X			
Ray	X			
Smith	X			
	9	0	0	0



Second Reading: October 16, 1996  
 To Mayor: October 17, 1996  
 Returned: October 23, 1996  
 Effective: October 23, 1996  
 Published: November 8, 1996

REMARKS:

\_\_\_\_\_  
 \_\_\_\_\_  
 \_\_\_\_\_  
 \_\_\_\_\_

ROLL CALL VOTE				
	AYES	NOES	ABS	EX
Arakaki	X			
Easley			X	
Childs	X			
De Lima	X			
Domingo	X			
Osorio	X			
Van De Car	X			
Ray	X			
Smith	X			
	8	0	1	0

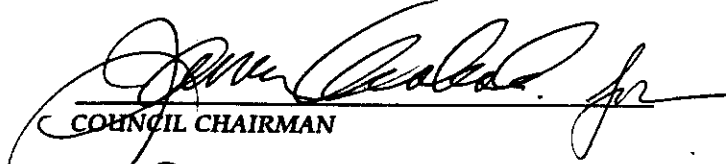
I DO HEREBY CERTIFY that the foregoing BILL was adopted by the County Council and published as indicated above.

  
 \_\_\_\_\_  
 COUNCIL CHAIRMAN  
  
 \_\_\_\_\_  
 COUNTY CLERK

Approved / Disapproved this 23 day  
 of October, 19 96

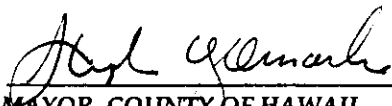
  
 \_\_\_\_\_  
 MAYOR, COUNTY OF HAWAII

Bill No.: 321 (Draft 2)  
 Reference: C-1350/PC-151  
 Ord. No.: 96 131