

2006 DEC 29 AM 7 51

PLANNING DEPARTMENT
COUNTY OF HAWAII

COUNTY OF HAWAII

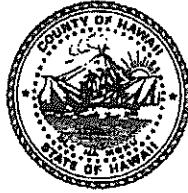

STATE OF HAWAII

ORDINANCE NO. **06 154** BILL NO. 339

AN ORDINANCE AMENDING THE STATE LAND USE BOUNDARIES MAPS FOR THE COUNTY OF HAWAII BY CHANGING THE DISTRICT CLASSIFICATION FROM THE AGRICULTURAL TO THE RURAL DISTRICT AT OULI, SOUTH KOHALA, HAWAII, COVERED BY TAX MAP KEY 6-2-11:20.

BE IT ORDAINED BY THE COUNCIL OF THE COUNTY OF HAWAII:

SECTION 1. The State Land Use Boundaries Maps for the County of Hawaii are amended to change the district classification of property described hereinafter as follows:

The district classification of the following area situated at Ouli, South Kohala, Hawaii, shall be Rural:

Beginning at the Northeasterly corner of this parcel of land, being also the Northwestern corner of Lot 19-B of Anekona Estates, and being a point on the Southerly side of Kanehoa Street (Private Road), the coordinates of said point of beginning referred to Government Survey Triangulation Station "PUU PA" being 10,988.02 feet North and 15,602.55 feet West and running by azimuths measured clockwise from True South:

1. 2° 06' 753.78 feet along Lot 19-B of Anekona Estates and along the remainder of Royal Patent 2237, Land Commission Award 8518-B, Apana 1 to James Young Kanehoa to a point in the middle of Keanuiomano Stream;

Thence, following along the middle of Keanuiomano Stream and along Government Land (State of Hawaii):

2. 97° 28' 40" 347.74 feet to a point;
3. 190° 35' 746.87 feet along Lot 21 of Anekona Estates and along the remainder of Royal Patent 2237, Land Commission Award 8518-B, Apana 1 to James Young Kanehoa to a point;

Thence, from a tangent azimuth of 280° 35' following along the Southerly side of Kanehoa Street (Private Road) on a curve to the left with a radius of 1,600.00 feet, the chord azimuth and distance being:

4. 276° 20' 30" 236.68 feet to the point of beginning and containing an area of 5.003 Acres.

All as shown on the map attached hereto, marked Exhibit "A" and by reference made a part hereof.

SECTION 2. In the event that any portion of this ordinance is declared invalid, such invalidity shall not affect the other parts of this ordinance.

SECTION 3. This ordinance shall take effect upon its approval.

INTRODUCED BY:

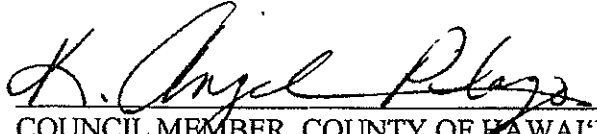
COUNCIL MEMBER, COUNTY OF HAWAII

Hilo, Hawai'i

Date of Introduction: November 15, 2006
Date of 1st Reading: November 15, 2006
Date of 2nd Reading: November 29, 2006
Effective Date: December 7, 2006

REFERENCE: Comm. 1081

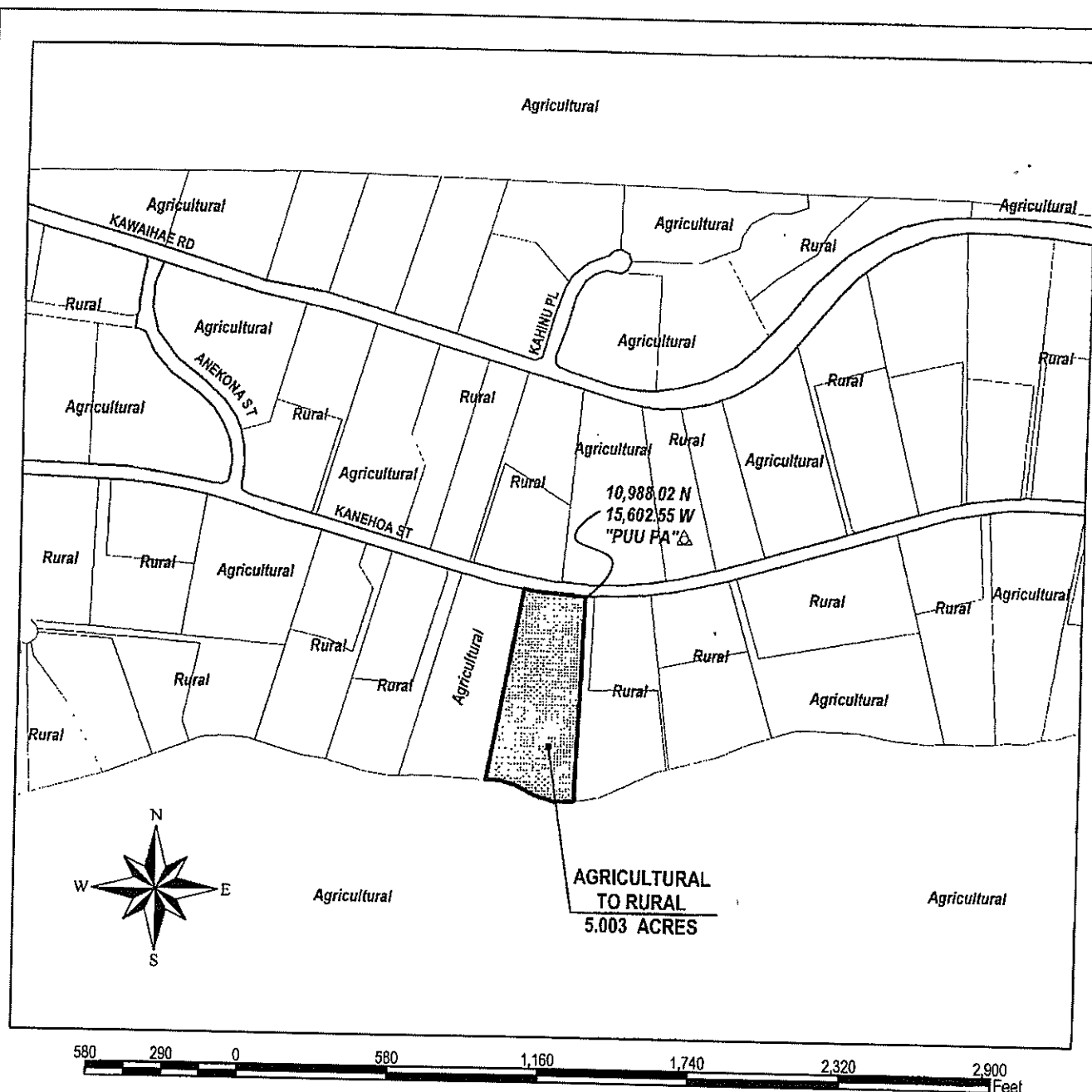

AMENDMENT TO STATE LAND USE BOUNDARIES MAPS

AMENDING THE STATE LAND USE BOUNDARIES MAPS FOR THE
COUNTY OF HAWAII, BY CHANGING THE DISTRICT CLASSIFICATION FROM
THE AGRICULTURAL TO THE RURAL DISTRICT
AT OULI, SOUTH KOHALA, HAWAII

PREPARED BY: PLANNING DEPARTMENT
COUNTY OF HAWAII

TMK: 6-2-011:020

EXHIBIT "A"

Date: June 6, 2006

(James C. and Madeleine T. Budde:06-162)

OFFICE OF THE COUNTY CLERK
County of Hawai'i
Hilo, Hawai'i

Introduced By: K. Angel Pilago
Date Introduced: November 15, 2006
First Reading: November 15, 2006
Published: N/A

REMARKS: _____

Second Reading: November 29, 2006
To Mayor: December 1, 2006
Returned: December 7, 2006
Effective: December 7, 2006
Published: December 22, 2006

REMARKS: _____

ROLL CALL VOTE				
	AYES	NOES	ABS	EX
Arakaki	X			
Higa	X			
Hoffmann		X		
Holschuh	X			
Ikeda	X			
Isbell	X			
Jacobson		X		
Pilago		X		
Safarik	X			
	6	3	0	0

ROLL CALL VOTE				
	AYES	NOES	ABS	EX
Arakaki	X			
Higa	X			
Hoffmann		X		
Holschuh	X			
Ikeda	X			
Isbell	X			
Jacobson		X		
Pilago		X		
Safarik	X			
	6	3	0	0

I DO HEREBY CERTIFY that the foregoing BILL was adopted by the County Council published as indicated above.

APPROVED AS TO
FORM AND LEGALITY:

[Signature]
DEPUTY CORPORATION COUNSEL
COUNTY OF HAWAII

Date 12/01/06

Approved Disapproved this 7th day

of December, 20 06

[Signature]
MAYOR, COUNTY OF HAWAII

[Signature]
COUNCIL CHAIRMAN

[Signature]
COUNTY CLERK

Bill No.: 339

Reference: C-1081/PC-120

Ord No.: 06 154