

COUNTY OF HAWAI'I

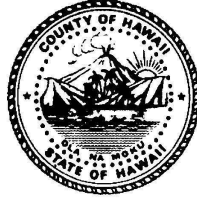

STATE OF HAWAI'I

ORDINANCE NO. 20 63 BILL NO. 150

AN ORDINANCE AMENDING SECTION 25-8-33 (CITY OF HILO ZONE MAP), ARTICLE 8, CHAPTER 25 (ZONING CODE) OF THE HAWAI'I COUNTY CODE 1983 (2005 EDITION), BY CHANGING THE DISTRICT CLASSIFICATION FROM MULTIPLE-FAMILY RESIDENTIAL – 1,500 SQUARE FEET (RM-1.5) TO SINGLE-FAMILY RESIDENTIAL – 7,500 SQUARE FEET (RS-7.5) AT WAIĀKEA, SOUTH HILO, HAWAI'I, COVERED BY TAX MAP KEY: 2-4-028:009.

BE IT ORDAINED BY THE COUNCIL OF THE COUNTY OF HAWAI'I:

SECTION 1. Section 25-8-33, Article 8, Chapter 25 (Zoning Code) of the Hawai'i County Code 1983 (2016 Edition, as amended), is amended to change the district classification of property described hereinafter as follows:

The district classification of the following area situated at Waiākea, South Hilo, Hawai'i, shall be Single-Family Residential – 7,500 square feet (RM-7.5):

Beginning at the southeast corner of this parcel of land and along the northerly boundary of Lot 39, Hualālai Subdivision and along the southwesterly side of Hualālai Street, the coordinates of said point of beginning referred to Government Survey Triangulation Station "HALAI", being 1,227.51 feet South and 3,637.22 feet East, thence running by azimuths measured clockwise from true South:

1. 58° 10' 433.93 feet along the remainders of L.P. 8063, L.C. Aw. 2663 to Kahue and R.P. 6790, L.C. Aw. 2402 to Keaniho (Lots 39, 38, 37, 36, 35, 34 and 33, Hualālai Subdivision);
2. 148° 10' 68.38 feet along the remainder of R.P. 6790, L.C. Aw. 2402 to Keaniho (Lot 31, Hualālai Subdivision);

3.	76° 08' 45"	303.03	feet along the remainder of R.P. 6790, L.C. Aw. 2402 to Keaniho (Lots 30, 29 and 28, Hualālai Subdivision);
4.	184° 30'	324.02	feet along Lot 144, 143 and 142 of Land Court Application 1205 (Map 51);
5.	277° 12'	320.40	feet along Lots 9-L-19 and 9-L-15 of Land Court Application 1205 (Map 9) and Lot 169 of Land Court Application 1205 (Map 72);
6.	255° 46'	154.80	feet along Lot 169 of Land Court Application 1205 (Map 72);
7.	243° 28'	32.33	feet along Lot 169 of Land Court Application 1205 (Map 72);
8.	328° 10'	121.35	feet along the remainder of L.P. 8063, L.C. Aw. 2663 to Kahue (Lot 1);
9.	238° 10'	120.00	feet along the remainder of L.P. 8063; L.C. Aw. 2663 to Kahue (Lot 1);
10.	349° 02'	19.67	feet along Hualālai Street;
11.	348° 02'	33.62	feet along Hualālai Street to the point of beginning and containing an area of 3.292 Acres.

All as shown on the map attached hereto, marked Exhibit "A" and by reference made a part hereof.

SECTION 2. In the event that any portion of this ordinance is declared invalid, such invalidity shall not affect the other parts of this ordinance.

SECTION 3. This ordinance shall take effect upon its approval.

INTRODUCED BY:

A handwritten signature in black ink, appearing to be 'O. Wilson B/R', written over a horizontal line.

COUNCIL MEMBER, COUNTY OF HAWAI'I

 Kona , Hawai'i
Date of Introduction: August 5, 2020
Date of 1st Reading: August 5, 2020
Date of 2nd Reading: August 19, 2020
Effective Date: September 2, 2020

REFERENCE Comm. 798

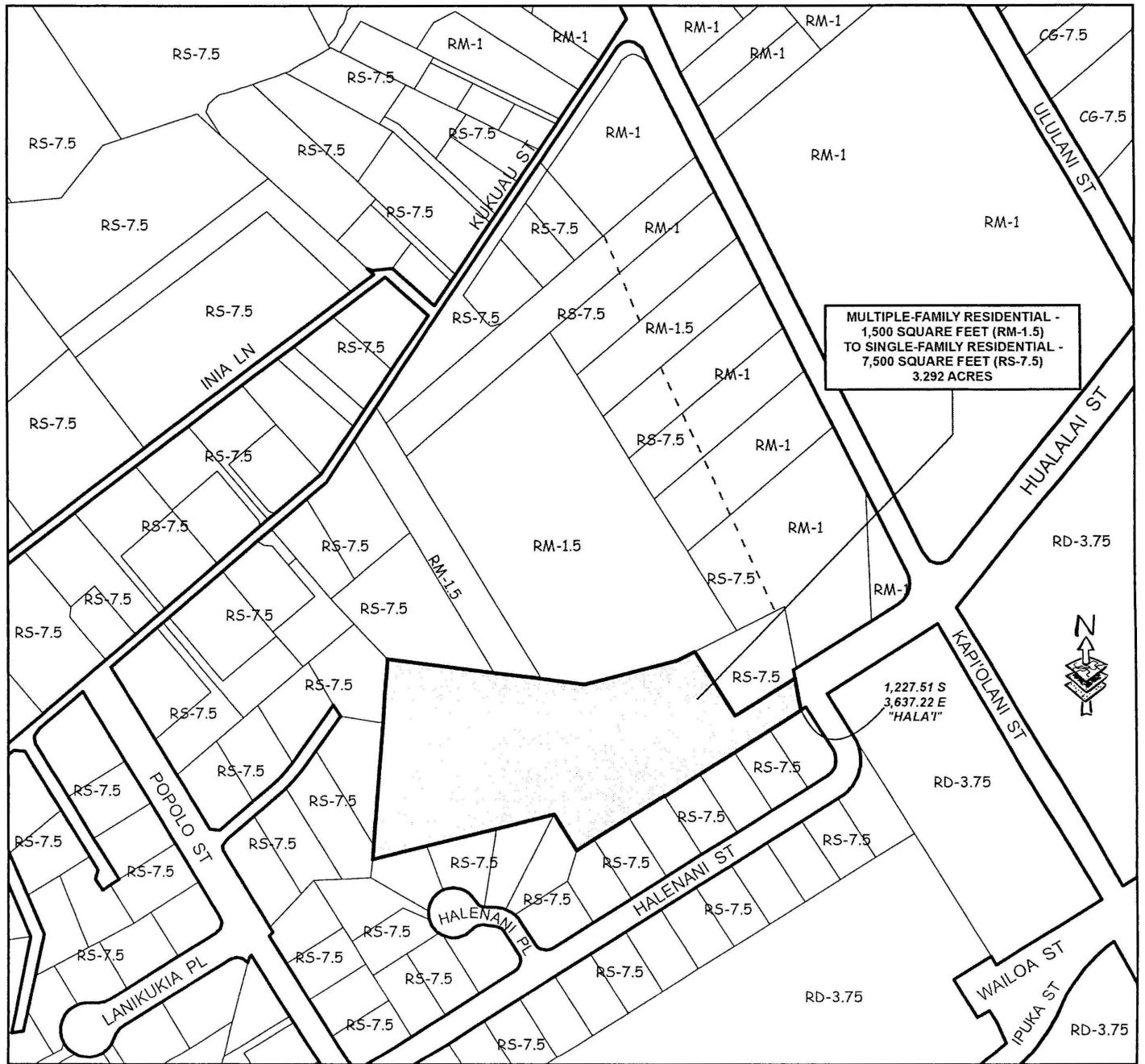

MULTIPLE-FAMILY RESIDENTIAL - 1,500 SQUARE FEET (RM-1.5) TO SINGLE-FAMILY RESIDENTIAL - 7,500 SQUARE FEET (RS-7.5) 3.292 ACRES

1,227.51 S
3,637.22 E
"HALA'I"

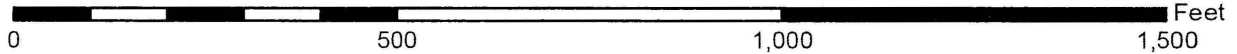

AMENDMENT TO THE ZONING CODE

AMENDING SECTION 25-8-33 (CITY OF HILO ZONE MAP) ARTICLE 8, CHAPTER 25 (ZONING CODE) OF THE HAWAII COUNTY CODE 1983 (2005 EDITION), BY CHANGING THE DISTRICT CLASSIFICATION FROM MULTIPLE-FAMILY RESIDENTIAL - 1,500 SQUARE FEET (RM-1.5) TO SINGLE-FAMILY RESIDENTIAL - 7,500 SQUARE FEET (RS-7.5) AT WAIAKEA, SOUTH HILO, HAWAII

MAP PREPARED BY:
COUNTY OF HAWAII, PLANNING DEPARTMENT

OFFICE OF THE COUNTY CLERK
 County of Hawai'i
Kona, Hawai'i

COUNTY CLERK
 COUNTY OF HAWAII

2020 SEP -2 AM 11: 44

Introduced By: Ashley L. Kierkiewicz (B/R)
 Date Introduced: August 5, 2020
 First Reading: August 5, 2020
 Published: August 14, 2020

REMARKS: _____

Second Reading: August 19, 2020
 To Mayor: August 28, 2020
 Returned: September 2, 2020
 Effective: September 2, 2020
 Published: September 11, 2020

REMARKS: _____

ROLL CALL VOTE				
	AYES	NOES	ABS	EX
Chung	X			
David	X			
Eoff	X			
Kaneali'i-Kleinfelder	X			
Kierkiewicz	X			
Lee Loy	X			
Poindexter	X			
Richards	X			
Villegas	X			
	9	0	0	0

ROLL CALL VOTE				
	AYES	NOES	ABS	EX
Chung	X			
David	X			
Eoff	X			
Kaneali'i-Kleinfelder	X			
Kierkiewicz	X			
Lee Loy	X			
Poindexter			X	
Richards	X			
Villegas	X			
	8	0	1	0

I DO HEREBY CERTIFY that the foregoing BILL was adopted by the County Council published as indicated above.

~~Approved~~/Disapproved this 2nd day
 of September, 2020.

 MAYOR, COUNTY OF HAWAII

 COUNCIL CHAIRPERSON

 COUNTY CLERK

Bill No.: 150
 Reference: C-798/PC-49
 Ord No.: 20 63