

ORDINANCE NO. 21 31

AN ORDINANCE REPEALING ORDINANCE NO. 12-128, WHICH AMENDED SECTION 25-8-23 (MOUNTAIN VIEW ZONE MAP), ARTICLE 8, CHAPTER 25 (ZONING CODE) OF THE HAWAI'I COUNTY CODE 1983 (2016 EDITION, AS AMENDED), BY CHANGING THE DISTRICT CLASSIFICATION FROM SINGLE-FAMILY RESIDENTIAL – 10,000 SQUARE FEET (RS-10) TO VILLAGE COMMERCIAL – 10,000 SQUARE FEET (CV-10) AT 'OLA'A, PUNA, HAWAI'I, COVERED BY TAX MAP KEY: 1-8-002:064.

BE IT ORDAINED BY THE COUNCIL OF THE COUNTY OF HAWAI'I:

SECTION 1. Ordinance No. 12-128 which amended Section 25-8-23 (Mountain View Zone Map), Article 8, Chapter 25 (Zoning Code) of the Hawai'i County Code 1983 (2016 Edition, as amended), is hereby repealed in its entirety and the subject property shall be classified back to its original zoning district.

SECTION 2. Section 25-8-23, Article 8, Chapter 25 (Zoning Code) of the Hawai'i County Code, is amended to change the district classification of property described hereinafter as follows:

The district classification of the following area situated at 'Ola'a, Puna, Hawai'i, shall be Single-Family Residential – 10,000 square feet (RS-10):

Beginning at the northeast corner of this parcel of land and on the southwesterly side of Old Volcano Road, the coordinates of said point of beginning referred to Government Survey Triangulation Station "OLAA", being 18,195.43 feet South and 18,479.17 feet West, thence running by azimuths measured clockwise from true South:

1. Along Old Volcano Road on a curve to the left with a radius of 102.00 feet, the chord azimuth and distance being:
309° 30' 12" 33.75 feet;
2. 1° 59' 30" 12.70 feet along the remainder of Grant 4053 to W. Wolters;

- | | | | |
|-----|---|-------------|--|
| 3. | 37° 11' | 57.43 feet | along same; |
| 4. | 51° 39' | 18.48 feet | along same; |
| 5. | 320° 35' | 97.14 feet | along same; |
| 6. | Thence along Volcano Road, F.A.P. No. F-2(4) on a curve to the right with a radius of 1,869.86 feet, the chord azimuth and distance being:
51° 49' 71.31 feet; | | |
| 7. | Thence along Nichols Road on a curve to the right with a radius of 20.00 feet, the chord azimuth and distance being:
99° 17' 17" 28.96 feet; | | |
| 8. | 145° 40' | 124.59 feet | along Nichols Road; |
| 9. | 275° 01' 30" | 20.50 feet | along the remainder of Grant 4053 to W. Wolters; |
| 10. | 237° 42' 30" | 44.61 feet | along same; |
| 11. | 231° 39' | 35.71 feet | along same; |
| 12. | 217° 11' | 44.11 feet | along same; |
| 13. | 181° 59' 30" | 20.76 feet | along same; |
| 14. | 228° 56' | 4.38 feet | along same to the point of beginning and containing an area of 13,785 Square Feet. |

All as shown on the map attached hereto, marked Exhibit "A" and by reference made a part hereof.

SECTION 3. Severability. If any provision of this ordinance, or the application thereof to any person or circumstance, is held invalid, the invalidity does not affect other provisions or applications of the ordinance which can be given effect without the invalid provision or application, and to this end the provisions of this ordinance are severable.

SECTION 4. This ordinance shall take effect upon approval.

INTRODUCED BY:

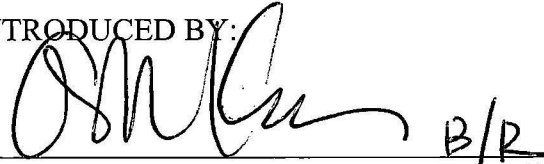

COUNCIL MEMBER, COUNTY OF HAWAI'I

 Kona , Hawai'i
Date of Introduction: April 7, 2021
Date of 1st Reading: April 7, 2021
Date of 2nd Reading: April 21, 2021
Effective Date: May 3, 2021

REFERENCE Comm. 143

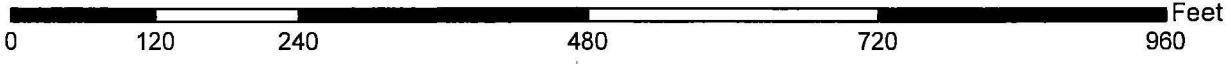
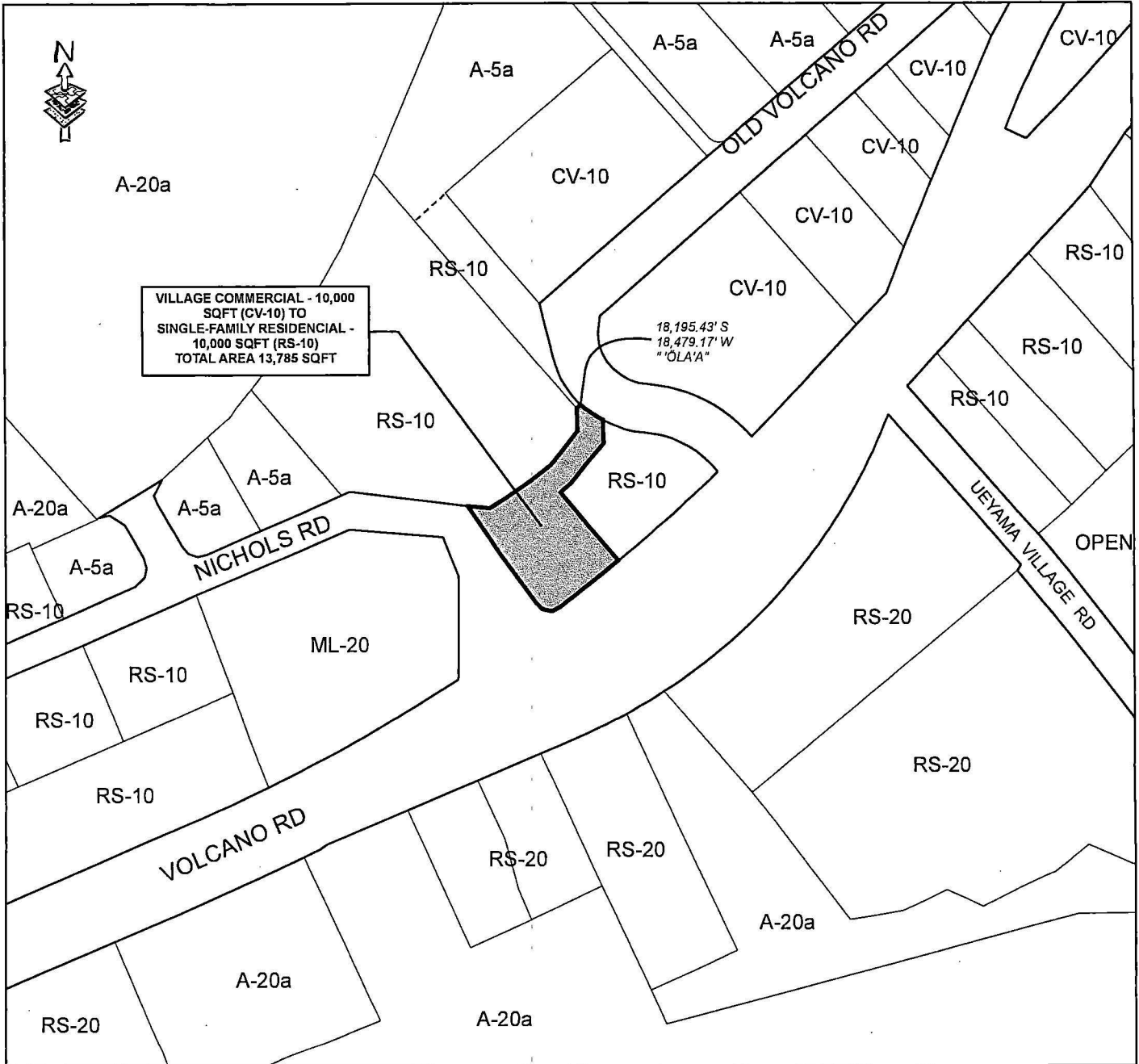

AMENDMENT TO THE ZONING CODE

AMENDING SECTION 25-8-23 (VOLCANO - MT. VIEW ZONE MAP) ARTICLE 8, CHAPTER 25 (ZONING CODE) OF THE HAWAII COUNTY CODE 1983 (2016 EDITION, AS AMENDED), BY CHANGING THE DISTRICT CLASSIFICATION FROM VILLAGE COMMERCIAL - 10,000 SQ. FT. (CV-10) TO SINGLE-FAMILY RESIDENCIAL - 10,000 SQ. FT. (RS-10) AT 'OLA'A, PUNA, HAWAII

MAP PREPARED BY:
COUNTY OF HAWAII, PLANNING DEPARTMENT

OFFICE OF THE COUNTY CLERK
 County of Hawai'i
Kona, Hawai'i

COUNTY CLERK
 COUNTY OF HAWAII

2021 MAY -3 PM 4:16

Introduced By: Ashley L. Kierkiewicz (B/R)
 Date Introduced: April 7, 2021
 First Reading: April 7, 2021
 Published: April 16, 2021

ROLL CALL VOTE				
	AYES	NOES	ABS	EX
Chung	X			
David	X			
Inaba	X			
Kāneali'i-Kleinfelder	X			
Kierkiewicz	X			
Kimball	X			
Lee Loy	X			
Richards	X			
Villegas	X			
	9	0	0	0

REMARKS: _____

Second Reading: April 21, 2021
 To Mayor: April 29, 2021
 Returned: May 3, 2021
 Effective: May 3, 2021
 Published: May 21, 2021

ROLL CALL VOTE				
	AYES	NOES	ABS	EX
Chung	X			
David	X			
Inaba	X			
Kāneali'i-Kleinfelder	X			
Kierkiewicz	X			
Kimball	X			
Lee Loy	X			
Richards			X	
Villegas	X			
	8	0	1	0

REMARKS: _____

I DO HEREBY CERTIFY that the foregoing BILL was adopted by the County Council published as indicated above.



COUNCIL CHAIRPERSON



COUNTY CLERK

Approved/Disapproved this 3rd day
 of May, 2021



MAYOR, COUNTY OF HAWAII

Bill No.: 26
 Reference: C-143/PC-15
 Ord No.: 21 31