

COUNTY OF HAWAI'I

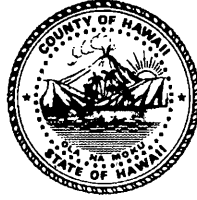

STATE OF HAWAI'I

ORDINANCE NO. 23 57 BILL NO. 52

AN ORDINANCE REPEALING ORDINANCE NO. 98 63, WHICH AMENDED ORDINANCE NO. 95 70, AND REPEALING ORDINANCE NO. 95 70, WHICH AMENDED SECTION 25-86 (NORTH AND SOUTH KONA DISTRICTS ZONE MAP), ARTICLE 3, CHAPTER 25 (ZONING CODE) OF THE HAWAI'I COUNTY CODE, BY CHANGING THE DISTRICT CLASSIFICATION FROM AGRICULTURAL-TWENTY ACRES (A-20a) TO AGRICULTURAL-ONE ACRE (A-1a), AGRICULTURAL-THREE ACRES (A-3a), AGRICULTURAL-TWO HUNDRED ACRES (A-200a), AGRICULTURAL-TWO HUNDRED FIFTY-FIVE ACRES (A-255a), AND AGRICULTURAL – EIGHT THOUSAND ACRES (A-8000a) AT KEALAKEKUA, KILOA, WAIPUNLA, KALAMA KUMU, AND KALAMAKOWALI, SOUTH KONA, HAWAI'I, COVERED BY TAX MAP KEYS: 8-2-012:001, 012, 014 (POR.), 015, AND 8-2-001:101 (FORMERLY TAX MAP KEYS: 8-2-012:012 AND A PORTION OF 001).

BE IT ORDAINED BY THE COUNCIL OF THE COUNTY OF HAWAI'I:

SECTION 1. Ordinance Nos. 98 63 and 95 70 which amended Section 25-8-2 (North and South Kona Districts Zone Map), Article 8, Chapter 25 (Zoning Code) of the Hawai'i County Code 1983 (2016 Edition, as amended), are hereby repealed in their entirety and the subject properties shall be classified back to their original zoning district.

SECTION 2. Section 25-8-2, Article 8, Chapter 25 (Zoning Code) of the Hawai'i County Code, is amended to change the district classification of properties described hereinafter as follows:

The district classification of the following area situated at Kealakekua, South Kona, Hawai'i, shall be Agricultural – Twenty Acres (A-20a):

PARCEL A:

Beginning at the Southwest corner of this parcel of land, being also the Southeast corner of Parcel C, the coordinates of said point of beginning referred to Government Survey Triangulation Station "PU'U OHAU", being 8,399.29 feet South and 40,509.01 feet East, and thence running by azimuths measured clockwise from true South:

- | | | | |
|----|----------|--------|---|
| 1. | 190° 00' | 604.85 | feet along Parcel C, along remainder of Royal Patents 7533 and 3607, Land Commission Award 8452: 9 to A. Keohokalole; |
| 2. | 184° 00' | 485.00 | feet along Parcel C, along remainder of Royal Patents 7533 and 3607, Land Commission Award 8452: 9 to A. Keohokalole; |
| 3. | 182° 00' | 665.00 | feet along Parcel C, along remainder of Royal Patents 7533 and 3607, Land Commission Award 8452: 9 to A. Keohokalole; |
| 4. | 177° 00' | 987.00 | feet along Parcel C, along remainder of Royal Patents 7533 and 3607, Land Commission Award 8452: 9 to A. Keohokalole; |
| 5. | 175° 30' | 280.00 | feet along Parcel C, along remainder of Royal Patents 7533 and 3607, Land Commission Award 8452: 9 to A. Keohokalole; |
| 6. | 178° 00' | 255.00 | feet along Parcel C, along remainder of Royal Patents 7533 and 3607, Land Commission Award 8452: 9 to A. Keohokalole; |
| 7. | 175° 30' | 450.00 | feet along Parcel C, along remainder of Royal Patents 7533 and 3607, Land Commission Award 8452: 9 to A. Keohokalole; |

8.	181° 30'	210.00	feet along Parcel C, along remainder of Royal Patents 7533 and 3607, Land Commission Award 8452: 9 to A. Keohokalole;
9.	180° 45'	255.00	feet along Parcel B, along remainder of Royal Patents 7533 and 3607, Land Commission Award 8452: 9 to A. Keohokalole;
10.	179° 15'	625.00	feet along Parcel B, along remainder of Royal Patents 7533 and 3607, Land Commission Award 8452: 9 to A. Keohokalole;
11.	169° 30'	403.00	feet along Parcel B, along remainder of Royal Patents 7533 and 3607, Land Commission Award 8452: 9 to A. Keohokalole;
12.	175° 40'	300.00	feet along Parcel B, along remainder of Royal Patents 7533 and 3607, Land Commission Award 8452: 9 to A. Keohokalole;
13.	174° 20'	205.00	feet along Parcel B, along remainder of Royal Patents 7533 and 3607, Land Commission Award 8452: 9 to A. Keohokalole;
14.	182° 30'	310.00	feet along Parcel B, along remainder of Royal Patents 7533 and 3607, Land Commission Award 8452: 9 to A. Keohokalole;
15.	83° 00'	81.00	feet along Parcel B, along remainder of Royal Patents 7533 and 3607, Land Commission Award 8452: 9 to A. Keohokalole;
16.	179° 40'	783.00	feet along Parcel B, along remainder of Royal Patents 7533 and 3607, Land Commission Award 8452: 9 to A. Keohokalole;

17.	177° 30'	130.00	feet along Parcel B, along remainder of Royal Patents 7533 and 3607, Land Commission Award 8452: 9 to A. Keohokalole;
18.	176° 50'	515.00	feet along Parcel B, along remainder of Royal Patents 7533 and 3607, Land Commission Award 8452: 9 to A. Keohokalole;
19.	60° 00'	60.00	feet along Parcel B, along remainder of Royal Patents 7533 and 3607, Land Commission Award 8452: 9 to A. Keohokalole;
20.	148° 00'	591.00	feet along Parcel B, along remainder of Royal Patents 7533 and 3607, Land Commission Award 8452: 9 to A. Keohokalole;
21.	153° 00'	590.00	feet along Parcel B, along remainder of Royal Patents 7533 and 3607, Land Commission Award 8452: 9 to A. Keohokalole;
22.	148° 00'	500.00	feet along Parcel B, along remainder of Royal Patents 7533 and 3607, Land Commission Award 8452: 9 to A. Keohokalole;
23.	157° 00'	290.00	feet along Parcel B, along remainder of Royal Patents 7533 and 3607, Land Commission Award 8452: 9 to A. Keohokalole;
24.	166° 00'	240.00	feet along Parcel B, along remainder of Royal Patents 7533 and 3607, Land Commission Award 8452: 9 to A. Keohokalole;
25.	170° 00'	315.00	feet along Parcel B, along remainder of Royal Patents 7533 and 3607, Land Commission Award 8452: 9 to A. Keohokalole;

26.	175° 00'	215.00	feet along Parcel B, along remainder of Royal Patents 7533 and 3607, Land Commission Award 8452: 9 to A. Keohokalole;
27.	183° 00'	185.00	feet along Parcel B, along remainder of Royal Patents 7533 and 3607, Land Commission Award 8452: 9 to A. Keohokalole;
28.	191° 00'	150.00	feet along Parcel B, along remainder of Royal Patents 7533 and 3607, Land Commission Award 8452: 9 to A. Keohokalole;
29.	63° 00'	775.00	feet along Parcel B, along remainder of Royal Patents 7533 and 3607, Land Commission Award 8452: 9 to A. Keohokalole;
30.	54° 45'	952.00	feet along Parcel B, along remainder of Royal Patents 7533 and 3607, Land Commission Award 8452: 9 to A. Keohokalole;
31.	63° 30'	625.00	feet along Parcel B, along remainder of Royal Patents 7533 and 3607, Land Commission Award 8452: 9 to A. Keohokalole;
32.	56° 00'	368.00	feet along Parcel B, along remainder of Royal Patents 7533 and 3607, Land Commission Award 8452: 9 to A. Keohokalole;
33.	59° 00'	212.00	feet along Parcel B, along remainder of Royal Patents 7533 and 3607, Land Commission Award 8452: 9 to A. Keohokalole;
34.	68° 00'	145.00	feet along Parcel B, along remainder of Royal Patents 7533 and 3607, Land Commission Award 8452: 9 to A. Keohokalole;

35.	74°	00'		595.00	feet along Parcel B, along remainder of Royal Patents 7533 and 3607, Land Commission Award 8452: 9 to A. Keohokalole;
36.	91°	20'		468.00	feet along Parcel B, along remainder of Royal Patents 7533 and 3607, Land Commission Award 8452: 9 to A. Keohokalole;
37.	62°	30'		240.00	feet along Parcel B, along remainder of Royal Patents 7533 and 3607, Land Commission Award 8452: 9 to A. Keohokalole;
38.	78°	00'		2,926.00	feet along Parcel B, along remainder of Royal Patents 7533 and 3607, Land Commission Award 8452: 9 to A. Keohokalole;
39.	351°	00'		1,340.00	feet along Parcel C, along remainder of Royal Patents 7533 and 3607, Land Commission Award 8452: 9 to A. Keohokalole;
40.	80°	48'		4,110.00	feet along Parcel C, along remainder of Royal Patents 7533 and 3607, Land Commission Award 8452: 9 to A. Keohokalole;
41.	236°	53'	50"	14,822.76	feet along Royal Patents 4386 and 7532, Land Commission Award 8452, Apana 11 to A. Keohokalole;
42.	293°	30'		2,376.00	feet along Grant 3155 to H.N. Greenwell;
43.	244°	30'		3,082.83	feet along Grant 3155 to H.N. Greenwell;
44.	293°	30'		3,286.45	feet along Grant 3155 to H.N. Greenwell;
45.	281°	10'		2,739.00	feet along Grant 3155 to H.N. Greenwell;

46.	265°	00'		2,574.00	feet along Grant 3155 to H.N. Greenwell;
47.	274°	08'	11"	5,800.94	feet along Grant 3155 to H.N. Greenwell;
48.	256°	42'	37"	5,645.69	feet along Royal Patent 7844, Land Commission Award 7715, Apana 12 to Lota Kamehameha;
49.	357°	18'	55"	2,224.10	feet along Royal Patent 7844, Land Commission Award 7715, Apana 12 to Lota Kamehameha;
50.	355°	04'	03"	4,825.25	feet along Royal Patent 7844, Land Commission Award 7715, Apana 12 to Lota Kamehameha;
51.	344°	06'	40"	2,390.22	feet along Royal Patent 7844, Land Commission Award 7715, Apana 12 to Lota Kamehameha;
52.	13°	08'	43"	2,720.25	feet along Royal Patent 7844, Land Commission Award 7715, Apana 12 to Lota Kamehameha;
53.	36°	41'	52"	4,453.95	feet along Royal Patent 7844, Land Commission Award 7715, Apana 12 to Lota Kamehameha;
54.	86°	20'	35"	4,810.89	feet along Royal Patent 7844, Land Commission Award 7715, Apana 12 to Lota Kamehameha;
55.	102°	43'	24"	4,468.67	feet along Royal Patent 7844, Land Commission Award 7715, Apana 12 to Lota Kamehameha;
56.	95°	31'	02"	13,828.78	feet along Royal Patent 4513, Mahele Award 32 to Kanele, to the point of beginning and containing an area of 8,761.309 acres, and excluding Parcel D (255 acres) and Exclusion 1 (400 acres) leaving a net area of 8,106.309 acres. (Refer to

Parcel A, Parcel D, and Exclusion 1
as shown on Exhibit "A" –
Description of Exclusion 1 follows.)

EXCLUSION 1: (SITUATED AT KEALEKEKUA, SOUTH KONA, HAWAI'I)

Beginning at the Southeast corner of this parcel of land, the coordinates of said point of beginning referred to Government Survey Triangulation Station "PU'U OHAU", being 3,462.92 feet South and 56,389.37 feet East and thence running by azimuths measured clockwise from true South:

1.	104° 00'		1,667.59	feet along remainder of Royal Patents 7533 and 3607, Land Commission Award 8452, Apana 9 to A. Keohokalole;
2.	104° 36' 37"		368.02	feet along remainder of Royal Patents 7533 and 3607, Land Commission Award 8452, Apana 9 to A. Keohokalole and also the southerly boundary of Lot 1-B;
3.	137° 51' 14"		907.79	feet along remainder of Royal Patents 7533 and 3607, Land Commission Award 8452, Apana 9 to A. Keohokalole and also the southerly boundary of Lot 1-B;
4.	94° 22' 45"		515.44	feet along remainder of Royal Patents 7533 and 3607, Land Commission Award 8452, Apana 9 to A. Keohokalole and also the southerly boundary of Lot 1-B;
5.	88° 09' 13"		87.94	feet along remainder of Royal Patents 7533 and 3607, Land Commission Award 8452, Apana 9 to A. Keohokalole and also the southerly boundary of Lot 1-B;

6.	101°	40'	53"	339.46	feet along remainder of Royal Patents 7533 and 3607, Land Commission Award 8452, Apana 9 to A. Keohokalole and also the southerly boundary of Lot 1-B;
7.	140°	46'	46"	360.57	feet along remainder of Royal Patents 7533 and 3607, Land Commission Award 8452, Apana 9 to A. Keohokalole and also the southerly boundary of Lot 1-B;
8.	197°	41'	11"	320.09	feet along remainder of Royal Patents 7533 and 3607, Land Commission Award 8452, Apana 9 to A. Keohokalole and also the southerly boundary of Lot 1-B;
9.	219°	45'	43"	131.36	feet along remainder of Royal Patents 7533 and 3607, Land Commission Award 8452, Apana 9 to A. Keohokalole and also the southerly boundary of Lot 1-B;
10.	163°	33'	56"	204.04	feet along remainder of Royal Patents 7533 and 3607, Land Commission Award 8452, Apana 9 to A. Keohokalole and also the southerly boundary of Lot 1-B;
11.	173°	01'	29"	318.79	feet along remainder of Royal Patents 7533 and 3607, Land Commission Award 8452, Apana 9 to A. Keohokalole and also the southerly boundary of Lot 1-B;
12.	169°	00'		935.00	feet along remainder of Royal Patents 7533 and 3607, Land Commission Award 8452, Apana 9 to A. Keohokalole;
13.	139°	00'		800.00	feet along remainder of Royal Patents 7533 and 3607, Land Commission Award 8452, Apana 9 to A. Keohokalole;

14.	152° 00'	770.00	feet along remainder of Royal Patents 7533 and 3607, Land Commission Award 8452, Apana 9 to A. Keohokalole;
15.	174° 00'	855.00	feet along remainder of Royal Patents 7533 and 3607, Land Commission Award 8452, Apana 9 to A. Keohokalole;
16.	270° 00'	795.00	feet along remainder of Royal Patents 7533 and 3607, Land Commission Award 8452, Apana 9 to A. Keohokalole;
17.	320° 00'	245.00	feet along remainder of Royal Patents 7533 and 3607, Land Commission Award 8452, Apana 9 to A. Keohokalole;
18.	297° 00'	1,120.00	feet along remainder of Royal Patents 7533 and 3607, Land Commission Award 8452, Apana 9 to A. Keohokalole;
19.	275° 00'	675.00	feet along remainder of Royal Patents 7533 and 3607, Land Commission Award 8452, Apana 9 to A. Keohokalole;
20.	252° 00'	450.00	feet along remainder of Royal Patents 7533 and 3607, Land Commission Award 8452, Apana 9 to A. Keohokalole;
21.	278° 00'	1,000.00	feet along remainder of Royal Patents 7533 and 3607, Land Commission Award 8452, Apana 9 to A. Keohokalole;
22.	250° 00'	500.00	feet along remainder of Royal Patents 7533 and 3607, Land Commission Award 8452, Apana 9 to A. Keohokalole;

23.	225° 00'	429.84	feet along remainder of Royal Patents 7533 and 3607, Land Commission Award 8452, Apana 9 to A. Keohokalole;
24.	0° 00'	5,243.63	feet along remainder of Royal Patents 7533 and 3607, Land Commission Award 8452, Apana 9 to A. Keohokalole, to the point of beginning, and containing an area of 400 acres. (Refer to Exclusion 1 as shown on Exhibit "A".)

The district classification of the following area situated at Kealakekua, South Kona, Hawai'i, shall be Agricultural – Twenty Acres (A-20a):

PARCEL B:

Beginning at the Southwest corner of this parcel of land, being also the Southeast corner of Parcel E, the coordinates of said point of beginning referred to Government Survey Triangulation Station "PU'U OHAU", being 7,428.01 feet South and 30,453.49 feet East, and thence running by azimuths measured clockwise from true South:

1.	173° 00'	4,080.00	feet along Parcel E, along remainder of Royal Patents 7533 and 3607, Land Commission Award 8452: 9 to A. Keohokalole;
2.	83° 30'	1,925.00	feet along Parcel E, along remainder of Royal Patents 7533 and 3607, Land Commission Award 8452: 9 to A. Keohokalole;
3.	146° 30'	524.96	feet along Parcel E, along remainder of Royal Patents 7533 and 3607, Land Commission Award 8452: 9 to A. Keohokalole;
4.	236° 53' 50"	1,030.00	feet along Royal Patents 4386 and 7532, Land Commission Award 8452, Apana 11 to A. Keohokalole;

5.	260° 48'	4,110.00	feet along Parcel A, along remainder of Royal Patents 7533 and 3607, Land Commission Award 8452: 9 to A. Keohokalole;
6.	171° 00'	1,340.00	feet along Parcel A, along remainder of Royal Patents 7533 and 3607, Land Commission Award 8452: 9 to A. Keohokalole;
7.	258° 00'	2,926.00	feet along Parcel A, along remainder of Royal Patents 7533 and 3607, Land Commission Award 8452: 9 to A. Keohokalole;
8.	242° 30'	240.00	feet along Parcel A, along remainder of Royal Patents 7533 and 3607, Land Commission Award 8452: 9 to A. Keohokalole;
9.	271° 20'	468.00	feet along Parcel A, along remainder of Royal Patents 7533 and 3607, Land Commission Award 8452: 9 to A. Keohokalole;
10.	254° 00'	595.00	feet along Parcel A, along remainder of Royal Patents 7533 and 3607, Land Commission Award 8452: 9 to A. Keohokalole;
11.	248° 00'	145.00	feet along Parcel A, along remainder of Royal Patents 7533 and 3607, Land Commission Award 8452: 9 to A. Keohokalole;
12.	239° 00'	212.00	feet along Parcel A, along remainder of Royal Patents 7533 and 3607, Land Commission Award 8452: 9 to A. Keohokalole;
13.	236° 00'	368.00	feet along Parcel A, along remainder of Royal Patents 7533 and 3607, Land Commission Award 8452: 9 to A. Keohokalole;

14.	243° 30'	625.00	feet along Parcel A, along remainder of Royal Patents 7533 and 3607, Land Commission Award 8452: 9 to A. Keohokalole;
15.	234° 45'	952.00	feet along Parcel A, along remainder of Royal Patents 7533 and 3607, Land Commission Award 8452: 9 to A. Keohokalole;
16.	243° 00'	775.00	feet along Parcel A, along remainder of Royal Patents 7533 and 3607, Land Commission Award 8452: 9 to A. Keohokalole;
17.	11° 00'	150.00	feet along Parcel A, along remainder of Royal Patents 7533 and 3607, Land Commission Award 8452: 9 to A. Keohokalole;
18.	3° 00'	185.00	feet along Parcel A, along remainder of Royal Patents 7533 and 3607, Land Commission Award 8452: 9 to A. Keohokalole;
19.	355° 00'	215.00	feet along Parcel A, along remainder of Royal Patents 7533 and 3607, Land Commission Award 8452: 9 to A. Keohokalole;
20.	350° 00'	315.00	feet along Parcel A, along remainder of Royal Patents 7533 and 3607, Land Commission Award 8452: 9 to A. Keohokalole;
21.	346° 00'	240.00	feet along Parcel A, along remainder of Royal Patents 7533 and 3607, Land Commission Award 8452: 9 to A. Keohokalole;
22.	337° 00'	290.00	feet along Parcel A, along remainder of Royal Patents 7533 and 3607, Land Commission Award 8452: 9 to A. Keohokalole;

23.	328° 00'	500.00	feet along Parcel A, along remainder of Royal Patents 7533 and 3607, Land Commission Award 8452: 9 to A. Keohokalole;
24.	333° 00'	590.00	feet along Parcel A, along remainder of Royal Patents 7533 and 3607, Land Commission Award 8452: 9 to A. Keohokalole;
25.	328° 00'	591.00	feet along Parcel A, along remainder of Royal Patents 7533 and 3607, Land Commission Award 8452: 9 to A. Keohokalole;
26.	240° 00'	60.00	feet along Parcel A, along remainder of Royal Patents 7533 and 3607, Land Commission Award 8452: 9 to A. Keohokalole;
27.	356° 50'	515.00	feet along Parcel A, along remainder of Royal Patents 7533 and 3607, Land Commission Award 8452: 9 to A. Keohokalole;
28.	357° 30'	130.00	feet along Parcel A, along remainder of Royal Patents 7533 and 3607, Land Commission Award 8452: 9 to A. Keohokalole;
29.	359° 40'	783.00	feet along Parcel A, along remainder of Royal Patents 7533 and 3607, Land Commission Award 8452: 9 to A. Keohokalole;
30.	263° 00'	81.00	feet along Parcel A, along remainder of Royal Patents 7533 and 3607, Land Commission Award 8452: 9 to A. Keohokalole;
31.	2° 30'	310.00	feet along Parcel A, along remainder of Royal Patents 7533 and 3607, Land Commission Award 8452: 9 to A. Keohokalole;

32.	354°	20'	205.00	feet along Parcel A, along remainder of Royal Patents 7533 and 3607, Land Commission Award 8452: 9 to A. Keohokalole;
33.	355°	40'	300.00	feet along Parcel A, along remainder of Royal Patents 7533 and 3607, Land Commission Award 8452: 9 to A. Keohokalole;
34.	349°	30'	403.00	feet along Parcel A, along remainder of Royal Patents 7533 and 3607, Land Commission Award 8452: 9 to A. Keohokalole;
35.	359°	15'	625.00	feet along Parcel A, along remainder of Royal Patents 7533 and 3607, Land Commission Award 8452: 9 to A. Keohokalole;
36.	00°	45'	255.00	feet along Parcel A, along remainder of Royal Patents 7533 and 3607, Land Commission Award 8452: 9 to A. Keohokalole;
37.	1°	30'	79.65	feet along Parcel A, along remainder of Royal Patents 7533 and 3607, Land Commission Award 8452: 9 to A. Keohokalole;
38.	101°	00'	777.11	feet along Parcel C, along remainder of Royal Patents 7533 and 3607, Land Commission Award 8452: 9 to A. Keohokalole;
39.	40°	00'	3,346.73	feet along Parcel C, along remainder of Royal Patents 7533 and 3607, Land Commission Award 8452: 9 to A. Keohokalole;
40.	6°	00'	1,145.00	feet along Parcel C, along remainder of Royal Patents 7533 and 3607, Land Commission Award 8452: 9 to A. Keohokalole;

41.	95° 31' 02"	7,102.32	feet along Royal Patent 4513, Mahele Award 32 to Kanele, to the point of beginning and containing an area of 1,645.207 acres. (Refer to Parcel B as shown on Exhibit "A".)
-----	-------------	----------	--

The district classification of the following area situated at Kealakekua, South Kona, Hawai'i, shall be Agricultural – Twenty Acres (A-20a):

PARCEL C:

Beginning at the Southeast corner of this parcel of land, being also the Southwest corner of Parcel A, the coordinates of said point of beginning referred to Government Survey Triangulation Station "PU'U OHAU", being 8,399.29 feet South and 40,509.01 feet East and thence running by azimuths measured clockwise from true South:

1.	95° 31' 02"	3,000.00	feet along Royal Patent 4513, Mahele Award 32 to Kanele;
2.	186° 00'	1,145.00	feet along Royal Patent 4513, Mahele Award 32 to Kanele;
3.	220° 00'	3,346.73	feet along Royal Patent 4513, Mahele Award 32 to Kanele;
4.	281° 00'	777.11	feet along Royal Patent 4513, Mahele Award 32 to Kanele;
5.	1° 30'	130.35	feet along Parcel A, along Royal Patent 4513, Mahele Award 32 to Kanele;
6.	355° 30'	450.00	feet along Parcel A, along Royal Patent 4513, Mahele Award 32 to Kanele;
7.	358° 00'	255.00	feet along Parcel A, along Royal Patent 4513, Mahele Award 32 to Kanele;
8.	355° 30'	280.00	feet along Parcel A, along Royal Patent 4513, Mahele Award 32 to Kanele;

9.	357° 00'	987.00	feet along Parcel A, along Royal Patent 4513, Mahele Award 32 to Kanele;
10.	2° 00'	665.00	feet along Parcel A, along Royal Patent 4513, Mahele Award 32 to Kanele;
11.	4° 00'	485.00	feet along Parcel A, along Royal Patent 4513, Mahele Award 32 to Kanele;
12.	10° 00'	604.85	feet along Parcel A, along Royal Patent 4513, Mahele Award 32 to Kanele, to the point of beginning and containing an area of 200 acres, more or less. (Refer to Parcel C as shown on Exhibit "A".)

The district classification of the following area situated at Kealakekua, South Kona, Hawai'i, shall be Agricultural – Twenty Acres (A-20a):

PARCEL D:

Beginning at the Southwest corner of this parcel of land, being the coordinates of said point of beginning referred to Government Survey Triangulation Station "PU'U OHAU", being 4,703.10 feet South and 42,634.04 feet East and thence running by azimuths measured clockwise from true South:

1.	183° 00'	1,180.00	feet along remainder of Royal Patents 7533 and 3607, Land Commission Award 8452: 9 to A. Keohokalole;
2.	153° 00'	1,230.00	feet along remainder of Royal Patents 7533 and 3607, Land Commission Award 8452: 9 to A. Keohokalole;
3.	258° 30'	120.00	feet along remainder of Royal Patents 7533 and 3607, Land Commission Award 8452: 9 to A. Keohokalole;

4.	264° 00'	195.00	feet along remainder of Royal Patents 7533 and 3607, Land Commission Award 8452: 9 to A. Keohokalole;
5.	309° 00'	807.00	feet along remainder of Royal Patents 7533 and 3607, Land Commission Award 8452: 9 to A. Keohokalole;
6.	233° 30'	1,030.00	feet along remainder of Royal Patents 7533 and 3607, Land Commission Award 8452: 9 to A. Keohokalole;
7.	245° 00'	150.00	feet along remainder of Royal Patents 7533 and 3607, Land Commission Award 8452: 9 to A. Keohokalole;
8.	275° 00'	275.00	feet along remainder of Royal Patents 7533 and 3607, Land Commission Award 8452: 9 to A. Keohokalole;
9.	303° 00'	102.00	feet along remainder of Royal Patents 7533 and 3607, Land Commission Award 8452: 9 to A. Keohokalole;
10.	229° 30'	280.00	feet along remainder of Royal Patents 7533 and 3607, Land Commission Award 8452: 9 to A. Keohokalole;
11.	239° 00'	110.00	feet along remainder of Royal Patents 7533 and 3607, Land Commission Award 8452: 9 to A. Keohokalole;
12.	244° 00'	125.00	feet along remainder of Royal Patents 7533 and 3607, Land Commission Award 8452: 9 to A. Keohokalole;

13.	245°	30'	410.00	feet along remainder of Royal Patents 7533 and 3607, Land Commission Award 8452: 9 to A. Keohokalole;
14.	249°	00'	200.00	feet along remainder of Royal Patents 7533 and 3607, Land Commission Award 8452: 9 to A. Keohokalole;
15.	240°	00'	190.00	feet along remainder of Royal Patents 7533 and 3607, Land Commission Award 8452: 9 to A. Keohokalole;
16.	233°	00'	215.00	feet along remainder of Royal Patents 7533 and 3607, Land Commission Award 8452: 9 to A. Keohokalole;
17.	225°	00'	500.00	feet along remainder of Royal Patents 7533 and 3607, Land Commission Award 8452: 9 to A. Keohokalole;
18.	223°	30'	427.47	feet along remainder of Royal Patents 7533 and 3607, Land Commission Award 8452: 9 to A. Keohokalole;
19.	359°	30'	4,307.41	feet along remainder of Royal Patents 7533 and 3607, Land Commission Award 8452: 9 to A. Keohokalole;
20.	88°	30'	806.10	feet along remainder of Royal Patents 7533 and 3607, Land Commission Award 8452: 9 to A. Keohokalole;
21.	89°	15'	1,110.00	feet along remainder of Royal Patents 7533 and 3607, Land Commission Award 8452: 9 to A. Keohokalole;

22.	183° 00'	415.00	feet along remainder of Royal Patents 7533 and 3607, Land Commission Award 8452: 9 to A. Keohokalole;
23.	93° 00'	1,875.00	feet, to the point of beginning and containing an area of 255 acres, more or less. (Refer to Parcel D as shown on Exhibit "A".)

The district classification of the following area situated at Kealakekua, Kiloa, Waipunaula, Kalama Kumu, and Kalamakowali, South Kona, Hawai'i, shall be Agricultural – Twenty Acres (A-20a):

PARCEL E:

Beginning at the Southeast corner of this parcel of land, being also the Southwest corner of Parcel B, the coordinates of said point of beginning referred to Government Survey Triangulation Station "PU'U OHAU", being 7,428.01 feet South and 30,453.49 feet East and thence running by azimuths measured clockwise from true South:

1.	95° 31' 02"	4,097.99	feet along Royal Patent 4513, Mahele Award 32 to Kanele;
2.	21° 15' 42"	1,000.00	feet along Royal Patent 4513, Mahele Award 32 to Kanele;
3.	91° 19'	1,873.51	feet along remainder of Grant 5206 to F. Deniz;
4.	40° 00'	261.17	feet along remainder of Grant 5206 to F. Deniz;
5.	62° 00'	282.00	feet along remainder of Grant 5206 to F. Deniz;
6.	59° 00'	490.00	feet along remainder of Grant 5206 to F. Deniz;
7.	66° 00'	530.00	feet along remainder of Grant 5206 to F. Deniz;

8.	155°	59'	14"	2,439.21	feet along remainder of Grant 5206 to F. Deniz, and along remainder of Royal Patent 4497, Land Commission Award 8559 to G. Kanaina;
9.	241°	00'		139.57	feet along Royal Patent 4497, Land Commission Award 8559 to G. Kanaina;
10.	239°	00'	30"	160.75	feet along Royal Patent 4497, Land Commission Award 8559 to G. Kanaina;
11.	154°	00'		112.14	feet along remainder of Royal Patents 7533 and 3607, Land Commission Award 8452: Apana 9 to A. Keohokalole;
12.	146°	00'		517.95	feet along remainder of Royal Patents 7533 and 3607, Land Commission Award 8452: Apana 9 to A. Keohokalole;
13.	48°	22'	45"	42.66	feet along remainder of Royal Patents 7533 and 3607, Land Commission Award 8452: Apana 9 to A. Keohokalole;
14.	155°	00'		1,139.81	feet along remainder of Royal Patents 7533 and 3607, Land Commission Award 8452: Apana 9 to A. Keohokalole;
15.	158°	00'		1,150.00	feet along remainder of Royal Patents 7533 and 3607, Land Commission Award 8452: Apana 9 to A. Keohokalole;
16.	270°	58'	41"	5,849.79	feet along remainder of Royal Patents 4386 and 7532, Land Commission Award 8452: Apana 11 to A. Keohokalole;

17.	242°	00'		322.90	feet along Royal Patents 4386 and 7532, Land Commission Award 8452: Apana 11 to A. Keohokalole;
18.	236°	53'	50"	976.49	feet along Royal Patents 7533 and 3607, Land Commission Award 8452: 9 to A. Keohokalole;
19.	326°	30'		524.96	feet along remainder of Royal Patents 7533 and 3607, Land Commission Award 8452: Apana 9 to A. Keohokalole;
20.	263°	30'		1,925.00	feet along remainder of Royal Patents 7533 and 3607, Land Commission Award 8452: Apana 9 to A. Keohokalole;
21.	353°	00'		4,080.00	feet along remainder of Royal Patents 7533 and 3607, Land Commission Award 8452: Apana 9 to A. Keohokalole, to the point of beginning and containing an area of 787.589 acres. (Refer to Parcel E as shown on Exhibit "A".)

The district classification of the following area situated at Kealakekua, Kiloa, and Waipunaula, South Kona, Hawai'i, shall be Agricultural – Twenty Acres (A-20a):

PARCEL F:

Beginning at the Northwest corner of this parcel of land, the coordinates of said point of beginning referred to Government Survey Triangulation Station "PU'U OHAU", being 3,884.80 feet South and 20,507.95 feet East and thence running by azimuths measured clockwise from true South:

1.	244°	20'	21"	326.06	feet along Royal Patents 4386 and 7532, Land Commission Award 8452: Apana 11 to A. Keohokalole;
2.	338°	00'		1,150.00	feet along remainder of Royal Patents 7533 and 3607, Land Commission Award 8452: Apana 9 to A. Keohokalole;

3.	335°	00'		1,139.81	feet along remainder of Royal Patents 7533 and 3607, Land Commission Award 8452: Apana 9 to A. Keohokalole;
4.	228°	22'	45"	42.66	feet along remainder of Royal Patents 7533 and 3607, Land Commission Award 8452: Apana 9 to A. Keohokalole;
5.	326°	00'		517.95	feet along remainder of Royal Patents 7533 and 3607, Land Commission Award 8452: Apana 9 to A. Keohokalole;
6.	334°	00'		112.14	feet along remainder of Royal Patents 7533 and 3607, Land Commission Award 8452: Apana 9 to A. Keohokalole;
7.	59°	00'	30"	160.75	feet along Royal Patent 4497, Land Commission Award 8559 to G. Kanaina;
8.	61°	00'		139.57	feet along Royal Patent 4497, Land Commission Award 8559 to G. Kanaina;
9.	149°	39'	05"	82.85	feet along remainder of Royal Patents 7533 and 3607, Land Commission Award 8452: Apana 9 to A. Keohokalole;
10.	84°	19'	45"	37.74	feet along remainder of Royal Patents 7533 and 3607, Land Commission Award 8452: Apana 9 to A. Keohokalole;
11.	103°	10'	30"	69.95	feet along remainder of Royal Patents 7533 and 3607, Land Commission Award 8452: Apana 9 to A. Keohokalole;

12.	113°	51'		220.54	feet along remainder of Royal Patents 7533 and 3607, Land Commission Award 8452: Apana 9 to A. Keohokalole;
13.	147°	22'	20"	179.60	feet along remainder of Royal Patents 7533 and 3607, Land Commission Award 8452: Apana 9 to A. Keohokalole;
14.	222°	42'	20"	99.93	feet along remainder of Royal Patents 7533 and 3607, Land Commission Award 8452: Apana 9 to A. Keohokalole;
15.	160°	04'	20"	156.81	feet along remainder of Royal Patents 7533 and 3607, Land Commission Award 8452: Apana 9 to A. Keohokalole;
16.	155°	31'	20"	137.50	feet along remainder of Royal Patents 7533 and 3607, Land Commission Award 8452: Apana 9 to A. Keohokalole;
17.	152°	32'	20"	179.01	feet along remainder of Royal Patents 7533 and 3607, Land Commission Award 8452: Apana 9 to A. Keohokalole;
18.	152°	48'	50"	692.23	feet along remainder of Royal Patents 7533 and 3607, Land Commission Award 8452: Apana 9 to A. Keohokalole;
19.	155°	21'	20"	130.30	feet along remainder of Royal Patents 7533 and 3607, Land Commission Award 8452: Apana 9 to A. Keohokalole;
20.	156°	31'	20"	112.20	feet along remainder of Royal Patents 7533 and 3607, Land Commission Award 8452: Apana 9 to A. Keohokalole;

21.	67°	49'	20"	42.28	feet along remainder of Royal Patents 7533 and 3607, Land Commission Award 8452: Apana 9 to A. Keohokalole;
22.	166°	28'	20"	422.35	feet along remainder of Royal Patents 7533 and 3607, Land Commission Award 8452: Apana 9 to A. Keohokalole;
23.	163°	56'	50"	254.25	feet along remainder of Royal Patents 7533 and 3607, Land Commission Award 8452: Apana 9 to A. Keohokalole;
24.	158°	04'	50"	328.69	feet along remainder of Royal Patents 7533 and 3607, Land Commission Award 8452: Apana 9 to A. Keohokalole, to the point of beginning and containing an area of 24.796 acres. (Refer to Parcel F as shown on Exhibit "A".)

The district classification of the following area situated at Kalamakowali, South Kona, Hawai'i, shall be Agricultural – Twenty Acres (A-20a):

PARCEL G:

Beginning at the Northwest corner of this parcel of land, being also the Southwest corner of Parcel H, the coordinates of said point of beginning referred to Government Survey Triangulation Station "PU'U OHAU", being 8,723.29 feet South and 22,817.78 feet East and thence running by azimuths measured clockwise from true South:

1.	246°	00'	530.00	feet along remainder of Grant 5206 to F. Deniz;
2.	239°	00'	490.00	feet along remainder of Grant 5206 to F. Deniz;
3.	242°	00'	282.00	feet along remainder of Grant 5206 to F. Deniz;
4.				

5.	220°	00'		261.17	feet along remainder of Grant 5206 to F. Deniz;
6.	271°	19'		1,873.51	feet along remainder of Grant 5206 to F. Deniz;
7.	21°	15'	42"	1,486.02	feet along Royal Patent 4513, Mahele Award 32 to Kanele;
8.	47°	35'	48"	2,004.67	feet along Royal Patent 4513, Mahele Award 32 to Kanele;
9.	149°	18'	26"	2,301.81	feet along Grant 1613 to G.B. Kalaau to the point of beginning and containing an area of 113.838 acres. (Refer to Parcel G as shown on Exhibit "A".)

The district classification of the following area situated at Kalamakowali, South Kona, Hawai'i, shall be Agricultural – Twenty Acres (A-20a):

PARCEL H:

Beginning at the Southwest corner of this parcel of land, being also the Northeast corner of Parcel G, the coordinates of said point of beginning referred to Government Survey Triangulation Station "PU'U OHAU", being 8,723.29 feet South and 22,817.78 feet East and thence running by azimuths measured clockwise from true South:

1.	61°	28'		1,153.40	feet along Grant 1613 to G.B. Kalaau;
2.	160°	09'		30.00	feet along Grant 4015 to Francisco Diniz;
3.	197°	38'	30"	641.10	feet along Grant 4015 to Francisco Diniz;
4.	144°	20'		269.80	feet along Grant 1610 to Pupule;
5.	133°	19'		493.90	feet along Grant 1610 to Pupule;

6.	178°	11'	07"	136.74	feet along Royal Patent 1669, Land Commission Award 8516-B, Apana 2 to Kamaikui;
7.	71°	25'	49"	407.83	feet along Royal Patent 4497, Land Commission Award 8559 to G. Kanaina;
8.	152°	18'	55"	434.41	feet along stonewall, along remainder of Royal Patent 4497, Land Commission Award 8559 to G. Kanaina;
9.	216°	18'		1,080.50	feet along fence, along remainder of Royal Patent 4497, Land Commission Award 8559 to G. Kanaina;
10.	179°	58'	30"	135.23	feet along remainder of Royal Patent 4497, Land Commission Award 8559 to G. Kanaina;
11.	239°	33'		358.91	feet along Royal Patents 7533 and 3607, Land Commission Award 8452: Apana 9 to A. Keohokalole;
12.	335°	59'	12"	2,439.21	feet along remainder of Royal Patent 4497, Land Commission Award 8559 to G. Kanaina, and along remainder of Grant 5206 to F. Deniz, to the point of beginning and containing an area of 52.696 acres. (Refer to Parcel H as shown on Exhibit "A".)

All as shown on the map attached hereto, marked Exhibit "A" and by reference made a part hereof.

SECTION 3. Severability. If any provision of this ordinance, or the application thereof to any person or circumstance, is held invalid, the invalidity does not affect other provisions or applications of the ordinance which can be given effect without the invalid provision or application, and to this end the provisions of this ordinance are severable.

SECTION 4. This ordinance shall take effect upon approval.

INTRODUCED BY:

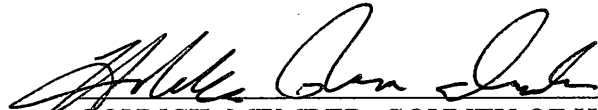
COUNCIL MEMBER, COUNTY OF HAWAI'I

 Kona , Hawai'i
Date of Introduction: July 6, 2023
Date of 1st Reading: July 6, 2023
Date of 2nd Reading: July 26, 2023
Effective Date: August 8, 2023

REFERENCE Comm. 326

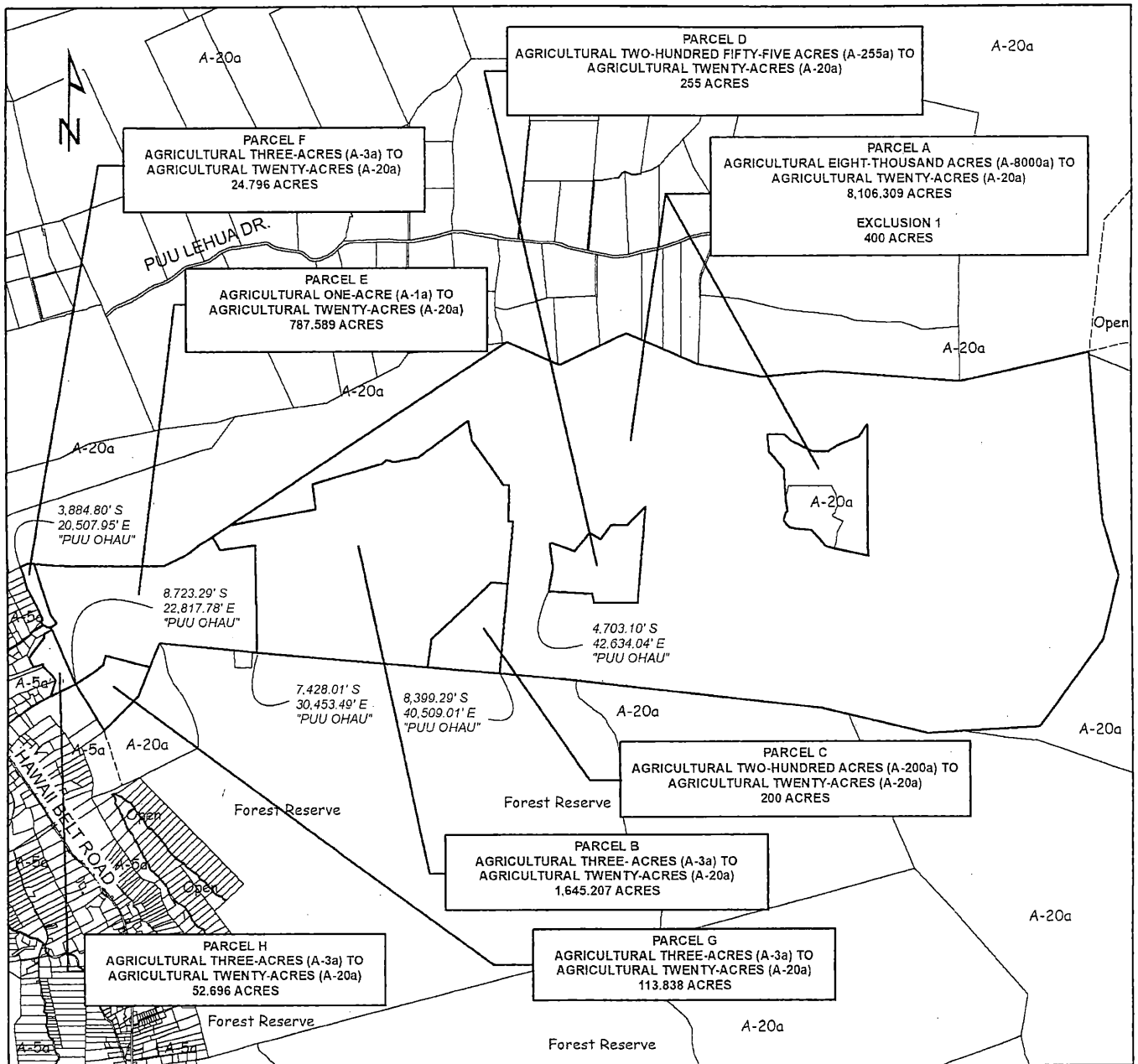

AMENDMENT TO THE ZONING CODE

AMENDING SECTION 25-8-2 (NORTH AND SOUTH KONA DISTRICTS ZONE MAP) ARTICLE 8, CHAPTER 25 (ZONING) OF THE HAWAII COUNTY CODE 1983 (2016 EDITION, AS AMENDED), BY CHANGING THE DISTRICT CLASSIFICATION FROM

AGRICULTURAL ONE-ACRE (A-1a), AGRICULTURAL THREE-ACRES (A-3a), AGRICULTURAL TWO-HUNDRED ACRES (A-200a), AGRICULTURAL TWO-HUNDRED FIFTY-FIVE ACRES (A-255a), AND AGRICULTURAL EIGHT-THOUSAND ACRES (A-8000a) TO AGRICULTURAL TWENTY-ACRES (A-20a) AT KEALAKEKUA, KILOA, WAIPUNAU, KALAMA, KUMU, AND KALAMAKOWALI, SOUTH KONA, HAWAII

TMK: (3) 8-2-012: 1, 12, por.14, 15 and (3) 8-2-001: por.101

MAP PREPARED BY:
COUNTY OF HAWAII, PLANNING DEPARTMENT

DATE: March 22, 2021

EXHIBIT "A"

Planning Director Initiated
Map: 1423

OFFICE OF THE COUNTY CLERK
 County of Hawai'i
 Kona, Hawai'i

COUNTY CLERK
 COUNTY OF HAWAII

2023 AUG 10 AM 8:09

Introduced By: Dr. Holeka Goro Inaba
 Date Introduced: July 6, 2023
 First Reading: July 6, 2023
 Published: July 14, 2023

REMARKS: _____

Second Reading: July 26, 2023
 To Mayor: August 3, 2023
 Returned: August 10, 2023
 Effective: August 8, 2023
 Published: September 1, 2023



REMARKS: _____

ROLL CALL VOTE				
	AYES	NOES	ABS	EX
Evans	X			
Galimba	X			
Inaba	X			
Kagiwada	X			
Kāneali'i-Kleinfelder	X			
Kierkiewicz	X			
Kimball	X			
Lee Loy	X			
Villegas	X			
	9	0	0	0

ROLL CALL VOTE				
	AYES	NOES	ABS	EX
Evans			X	
Galimba	X			
Inaba	X			
Kagiwada			X	
Kāneali'i-Kleinfelder			X	
Kierkiewicz	X			
Kimball	X			
Lee Loy	X			
Villegas	X			
	6	0	3	0

I DO HEREBY CERTIFY that the foregoing BILL was adopted by the County Council published as indicated above.

(Approved/Disapproved this 8th day
 of August, 2023

 MAYOR, COUNTY OF HAWAII

 COUNCIL CHAIRPERSON

 COUNTY CLERK

Bill No.: 52
 Reference: C-326/LAAC-23
 Ord No.: 23 57