

LUC general

STATE OF HAWAII  
LAND USE COMMISSION  
Suite 1795  
Pacific Trade Center  
190 S. King Street  
Honolulu, Hawaii 96813

May 31, 1978

Mr. Sidney Fuke  
Planning Director  
Hawaii Planning Department  
25 Aupuni Street  
Hilo, Hawaii 96720

Dear Mr. Fuke:

SUBJECT: Boundary Interpretation

Tax Map Key: 2-5-08: 2 and 2-5-08: 14  
Location: Hilo, Hawaii  
Requested By: Case, Kay, Clause & Lynch

For your information, we are enclosing herewith a copy of a map for the above subject property on which a boundary interpretation was completed by this office.

Very truly yours,

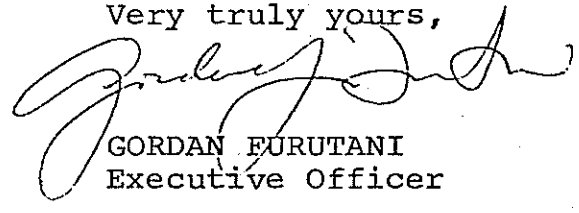

GORDAN EURUTANI  
Executive Officer

Encl.

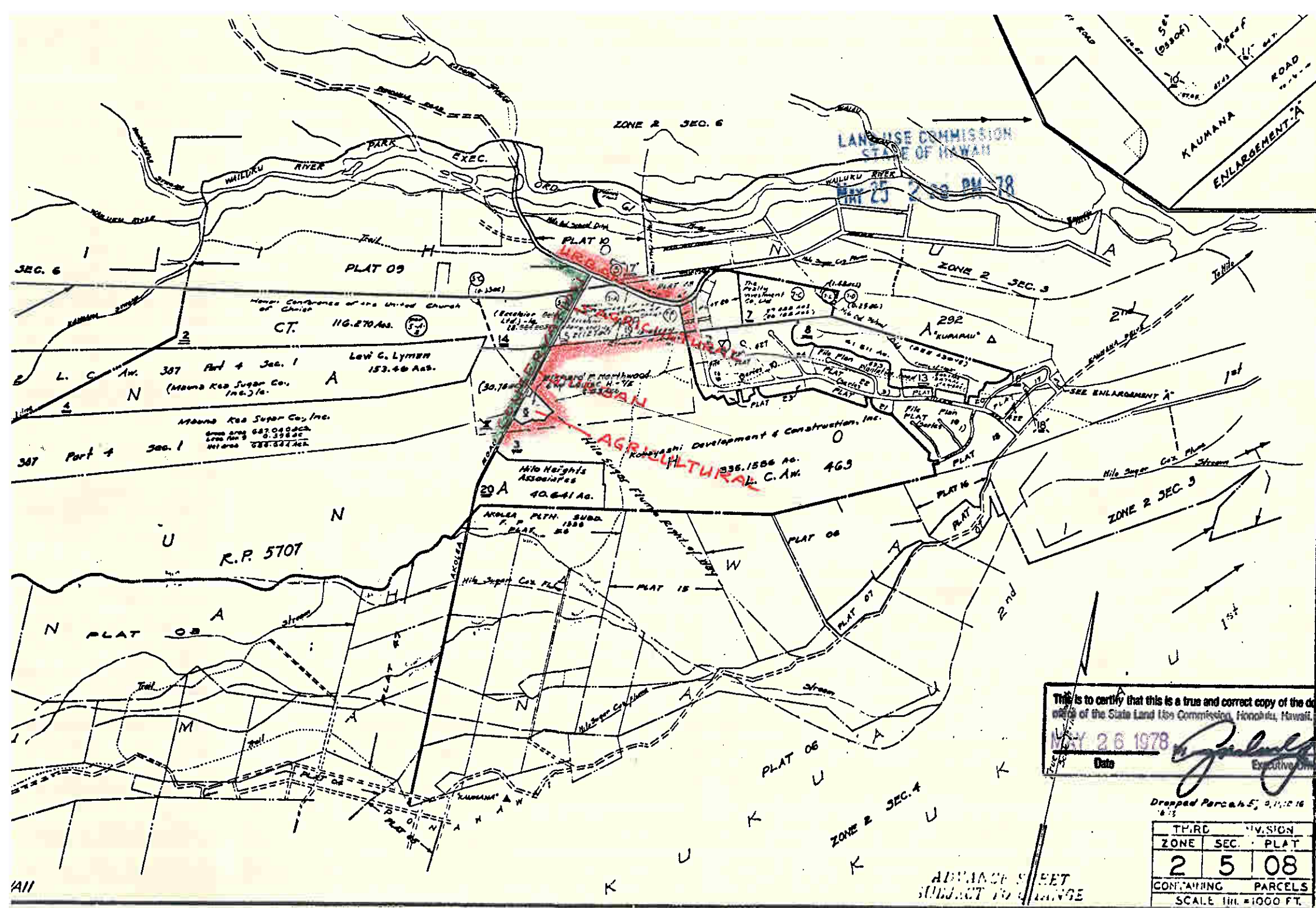

This is to certify that this is a true and correct copy of the document on file in the  
 office of the State Land Use Commission, Honolulu, Hawaii.  
 MAY 26 1978  
 Date *[Signature]*  
 Executive Director

Dropped Parcel 5, 9/11/16  
 8/3

TR. RD.	DIVISION	
ZONE	SEC.	PLAT
2	5	08
CONTAINING PARCELS		
SCALE 1 IN. = 1000 FT.		

ADVANCE SHEET  
 SUBJECT TO RANGE

PRINTED