

STATE OF HAWAII  
LAND USE COMMISSION  
Old Federal Building  
Room 104  
335 Merchant Street  
Honolulu, Hawaii 96813

March 23, 1982

Mr. Craig K. W. Leong  
John Child & Company, Inc.  
130 Merchant Street, Suite 1040  
Honolulu, Hawaii 96813

Dear Mr. Leong:

*LUC*  
SUBJECT: Boundary Interpretation

Tax Map Key : 3-4-03: 17, 22 and 43

Location : Kaiakea, North Hilo, Hawaii

Requested By: Craig K. W. Leong

Pursuant to your request of March 17, 1982  
we have delineated the State's Land Use District boundaries on the  
enclosed map.

Very truly yours,

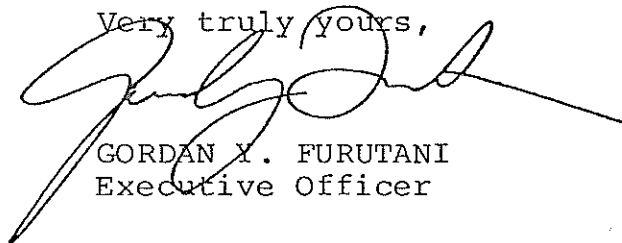
  
GORDAN Y. FURUTANI  
Executive Officer

Encl.

cc: Susumu Ono, BLNR Chairman  
Attn: Planning Office  
✓ Sidney Fuke, Hawaii Planning Director  
John Young, Tax Maps Branch  
C&C Finance Dept.

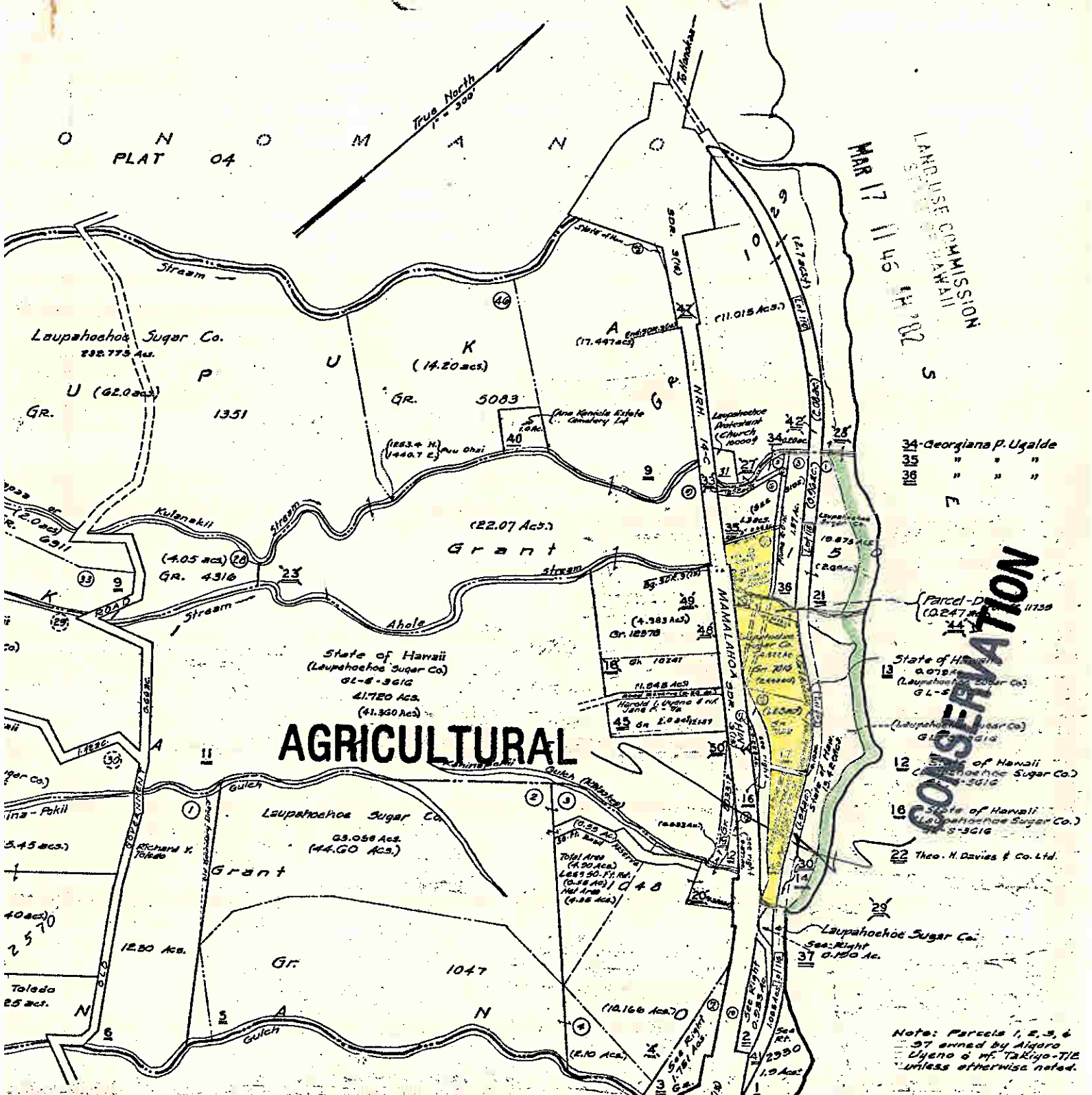

# AGRICULTURAL

# CONSERVATION

The boundary as located, named and delineated is hereby certified as the actual Land Use District Boundary adopted by the State Land Use Commission, Honolulu, Hawaii.

3/23/82  
Date Executive Officer

ADVANCE SHEET  
SUBJECT TO CHANGE

- 34-Georgiana P. Ugalde
- 35 " " "
- 36 " " "

- 13 Parcel-D (0.247 ac) 11750
- 14 State of Hawaii (Laupahoehoe Sugar Co.) 60784
- 15 State of Hawaii (Laupahoehoe Sugar Co.) 61-5-3616
- 16 State of Hawaii (Laupahoehoe Sugar Co.) 61-5-3616
- 17 Theo. H. Davies & Co. Ltd.

Note: Parcels 1, 2, 3, 4, 5, 7 owned by Aigoro Ujeno & mf. TAKIYO-TIE unless otherwise noted.

Parcels Dropped: 30, 40, 18, 16, 49, 50, 47, 28, 11, 10, 16, 15, 22, 27, 26, 34, 41

THIRD ZONE	DIVISION SEC.	PLAT
3	4	03

CONTAINING 1 PARCEL  
SCALE: 1 in. = 300 Ft.