

2-7-09:6  
MARK FILE

STATE OF HAWAII  
LAND USE COMMISSION  
Old Federal Building  
Room 104  
335 Merchant Street  
Honolulu, Hawaii 96813

RECEIVED  
FEB 11 11 03 AM '82

February 10, 1982

1982  
COUNTY OF HAWAII  
FILE NO

Mr. Herbert R. Welder, Jr.  
Bishop Trust Co., Ltd.  
P. O. Box 2390  
Honolulu, Hawaii 96804

Dear Mr. Welder:

SUBJECT: Boundary Interpretation

Tax Map Key : 2-7-9: 06

Location : Kahalii, South Hilo, Hawaii

Requested By: Herbert R. Welder, Jr.

Pursuant to your request of February 3, 1982  
we have delineated the State's Land Use District boundaries on the  
enclosed map.

Very truly yours,

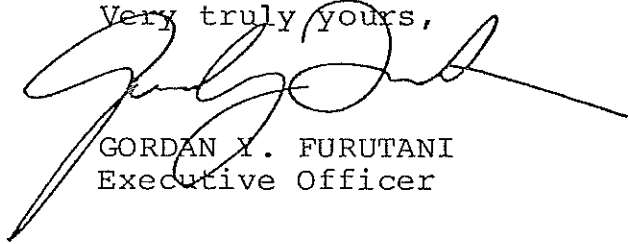

GORDAN Y. FURUTANI  
Executive Officer

Encl.

cc: Susumu Ono, BLNR Chairman  
Attn: Planning Office  
✓ Sidney Fuke, HCPD Director  
John Young, Tax Maps Branch,  
C&C Finance Dept.

E A

PLAT 10

LAND USE COMMISSION  
STATE OF HAWAII  
FEB 5 11 41 AM '82

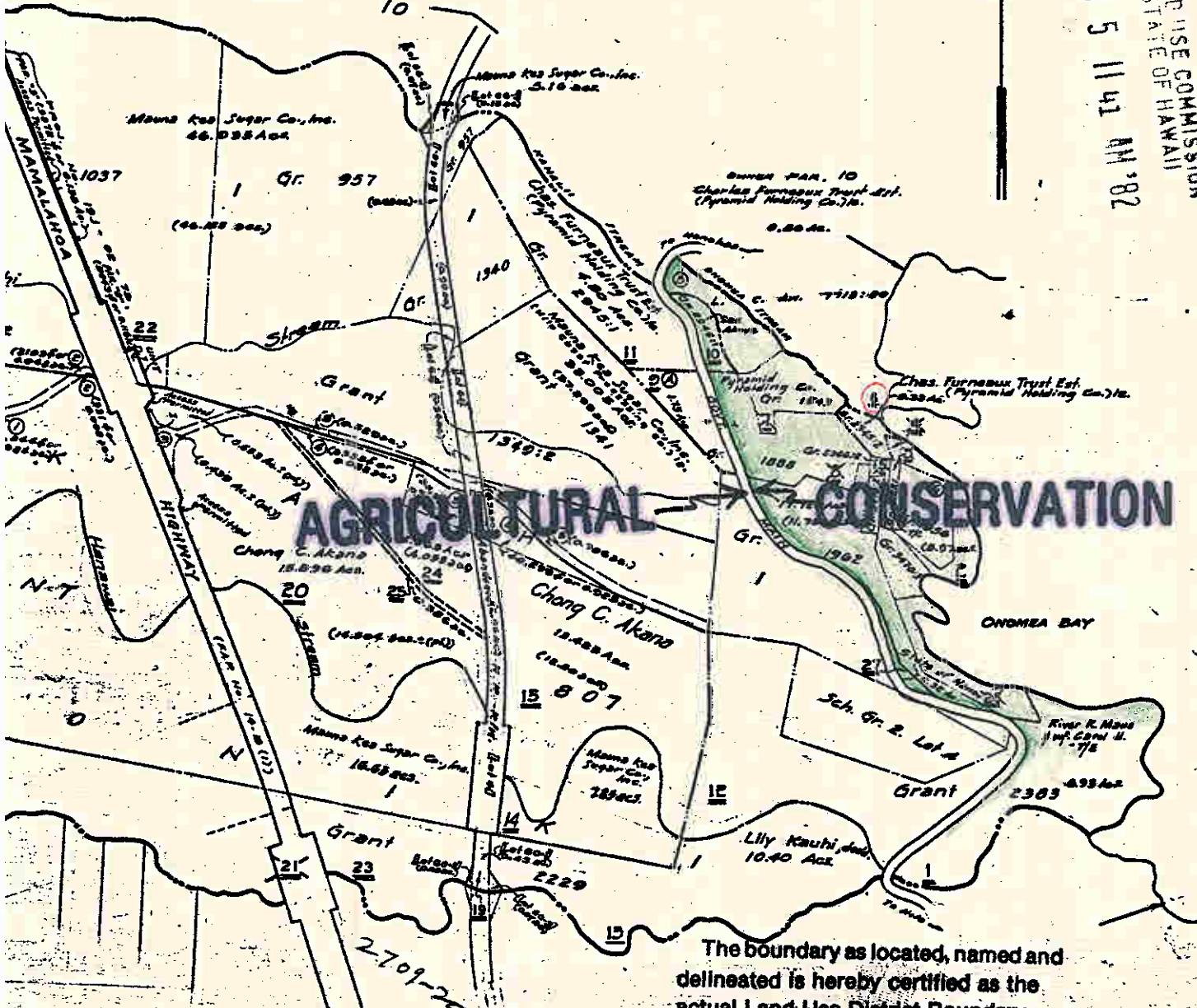

# AGRICULTURAL CONSERVATION

The boundary as located, named and delineated is hereby certified as the actual Land Use District Boundary adopted by the State Land Use Commission, Honolulu, Hawaii.

FEB 10 1982

Date

by *[Signature]*  
Executive Officer

ADVANCE SHEET  
SUBJECT TO CHANGE

Map No. 10, 11, 12, 13, 14, 15, 16, 17, 18, 19, 20, 21, 22, 23, 24, 25, 26, 27, 28, 29, 30, 31, 32, 33, 34, 35, 36, 37, 38, 39, 40, 41, 42, 43, 44, 45, 46, 47, 48, 49, 50, 51, 52, 53, 54, 55, 56, 57, 58, 59, 60, 61, 62, 63, 64, 65, 66, 67, 68, 69, 70, 71, 72, 73, 74, 75, 76, 77, 78, 79, 80, 81, 82, 83, 84, 85, 86, 87, 88, 89, 90, 91, 92, 93, 94, 95, 96, 97, 98, 99, 100

THIRD DIVISION		
ZONE	SEC.	PLAT
2	7	09
CONTAINING 14 PARCELS		
SCALE: 1 in. = 300 ft		

PRINTED