

*LUC - Boundary Interpretation*

STATE OF HAWAII  
LAND USE COMMISSION  
Room 104, Old Federal Bldg.  
335 Merchant Street  
Honolulu, Hawaii 96813

September 26, 1986

Joel La Pinta  
Winnman International Real Estate, Inc.  
688 Kinoole Street, Suite 103  
Hilo, Hawaii 96720

Attention: Mr. Joel La Pinta

Gentlemen:

SUBJECT: Boundary Interpretation

Tax Map Key: 3-2-3: 20 & 28

Location: Manoloa, North Hilo, Hawaii

Requested by: Joel La Pinta

Pursuant to your request of September 18, 1986, we have delineated the State's Land Use District boundaries on the enclosed map.

Very truly yours,

*Esther Ueda*

ESTHER UEDA  
Executive Officer

Enclosure

- CC: Susumu Ono, BLNR Chairman
- Attn: Planning Office
- Albert Lono Lyman, Hawaii Planning Director ✓
- Glenn Y. Sato, Tax Maps & Records Supervisor
- C&C, Dept. of Finance

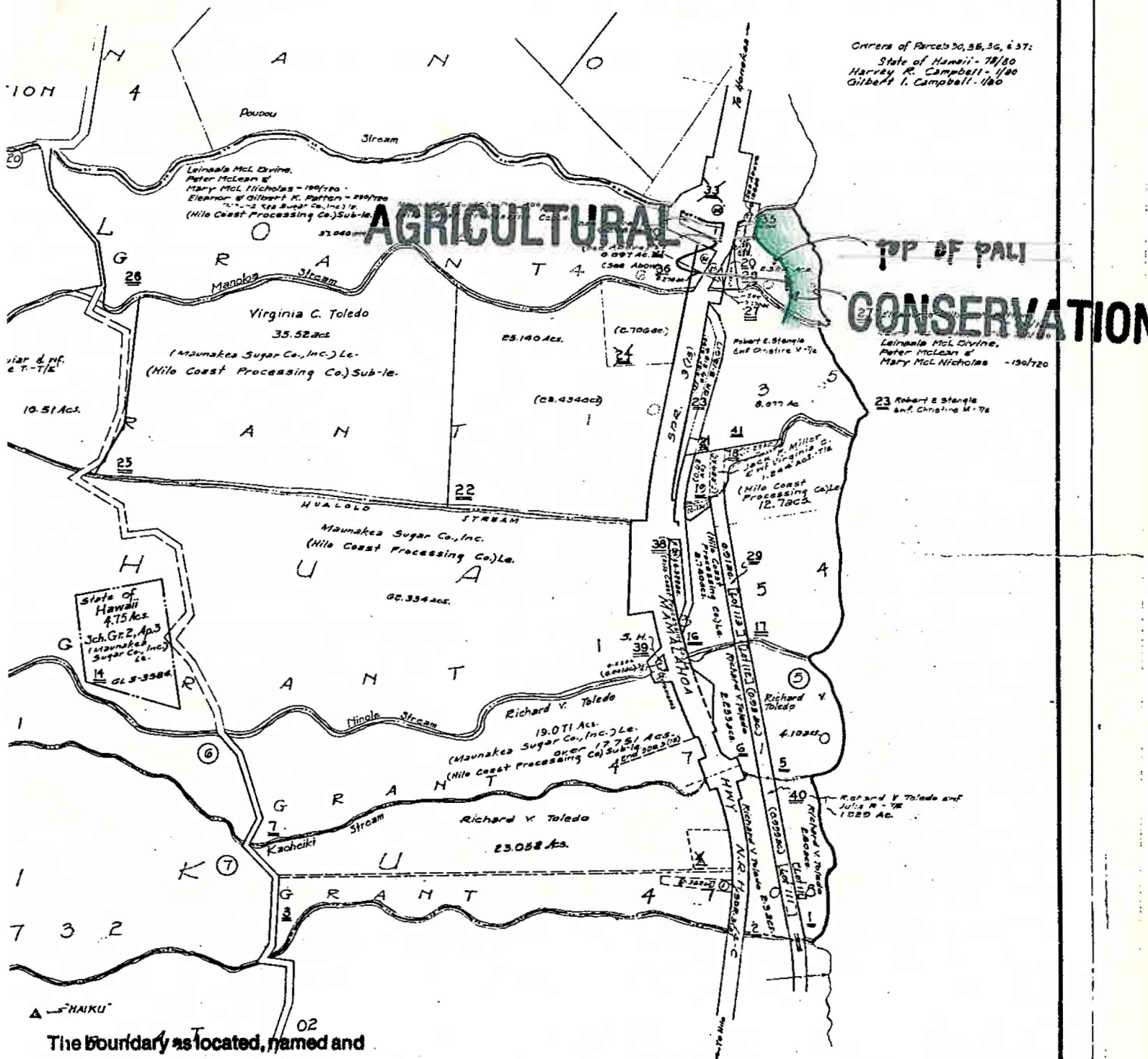

Owners of Parcels 30, 35, 36, & 37:  
 State of Hawaii - 74/80  
 Harvey R. Campbell - 1/80  
 Gilbert I. Campbell - 1/80

**TOP OF PALI  
 CONSERVATION**

State of Hawaii  
 4.75 Ac.  
 Jch. Gr. 2, Ap. 3  
 (Maunakea Sugar Co., Inc.)  
 02.33384

The boundary as located, named and delineated is hereby certified as the actual Land Use District Boundary adopted by the State Land Use Commission, Honolulu, Hawaii.

Note: All parcels owned by Maunakea Sugar Co., Inc. unless otherwise noted.

Parcels Dropped: 01, 10, 31, 24  
 (32, 33, 34 - in road)

SEP 26 1986 by *[Signature]*  
 Date Executive Officer

THIRD	DIVISION	
ZONE	SEC.	PLAT
3	2	03
CONTAINING		PARCELS
SCALE 1 in. = 300 ft.		

PRINTED