

STATE OF HAWAII  
LAND USE COMMISSION  
Room 104, Old Federal Bldg.  
335 Merchant Street  
Honolulu, Hawaii 96813

January 21, 1987

Mr. Michael Rearden  
P. O. Box 4361  
Kailua, Kona, Hawaii 96740

Dear Mr. Rearden:

SUBJECT: Boundary Interpretation

Tax Map Key: 5-7-01:05

Location: Paoo 2-6 North Kohala, Hawaii

Requested by: Michael Rearden

Pursuant to your request of January 14, 1987, we have delineated the State's Land Use District boundaries on the enclosed map.

Very truly yours,

*Esther Ueda*

ESTHER UEDA  
Executive Officer

Enclosure

cc: William Paty, BLNR Chairman  
Attn: Planning Office  
Albert Lono Lyman,  
Hawaii Planning Director  
✓ Glenn Y. Sato, Tax Maps & Records Supervisor  
C&C, Dept. of Finance

*K/REKETS  
4/16/87*

JAN 23 1987

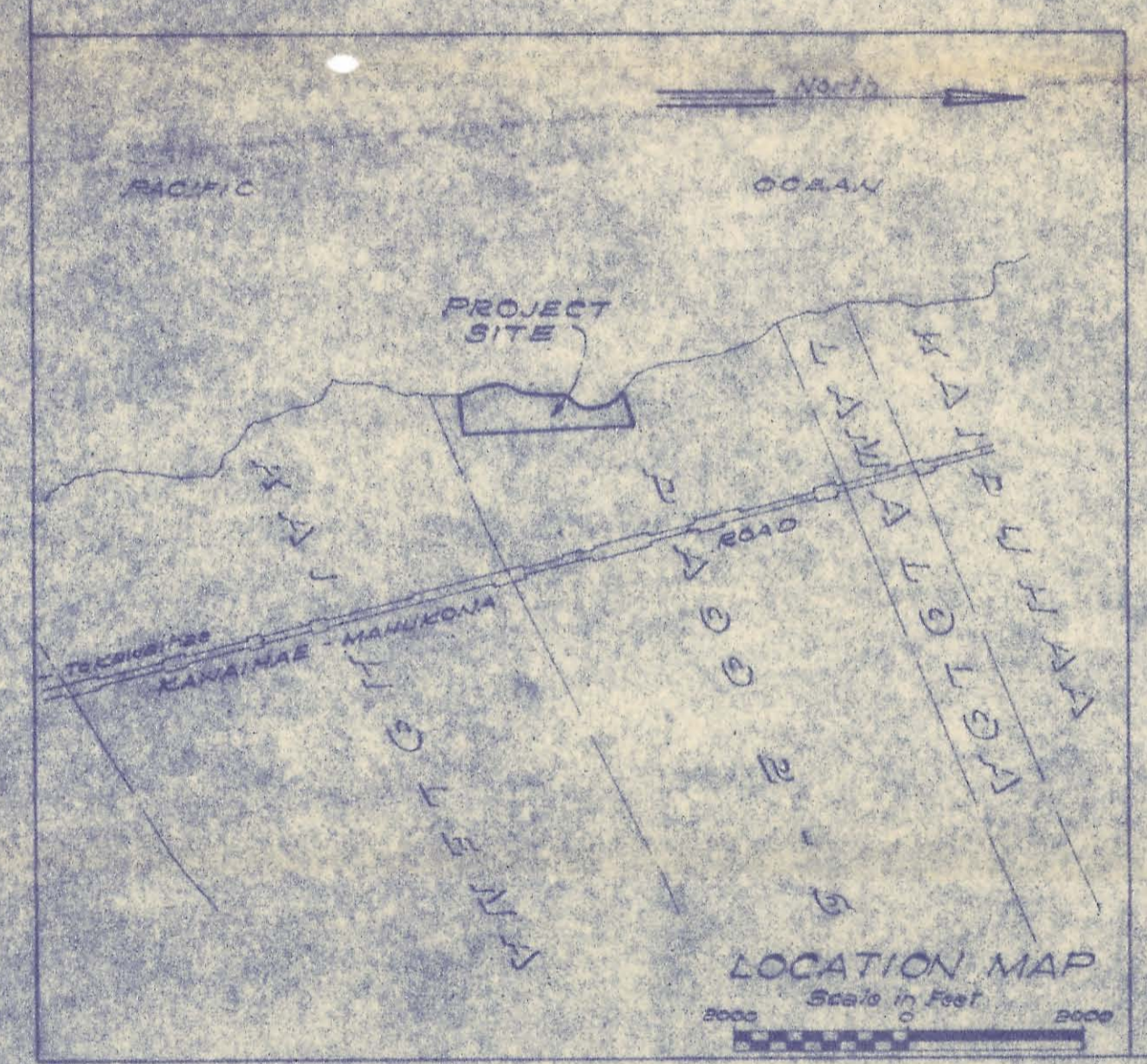
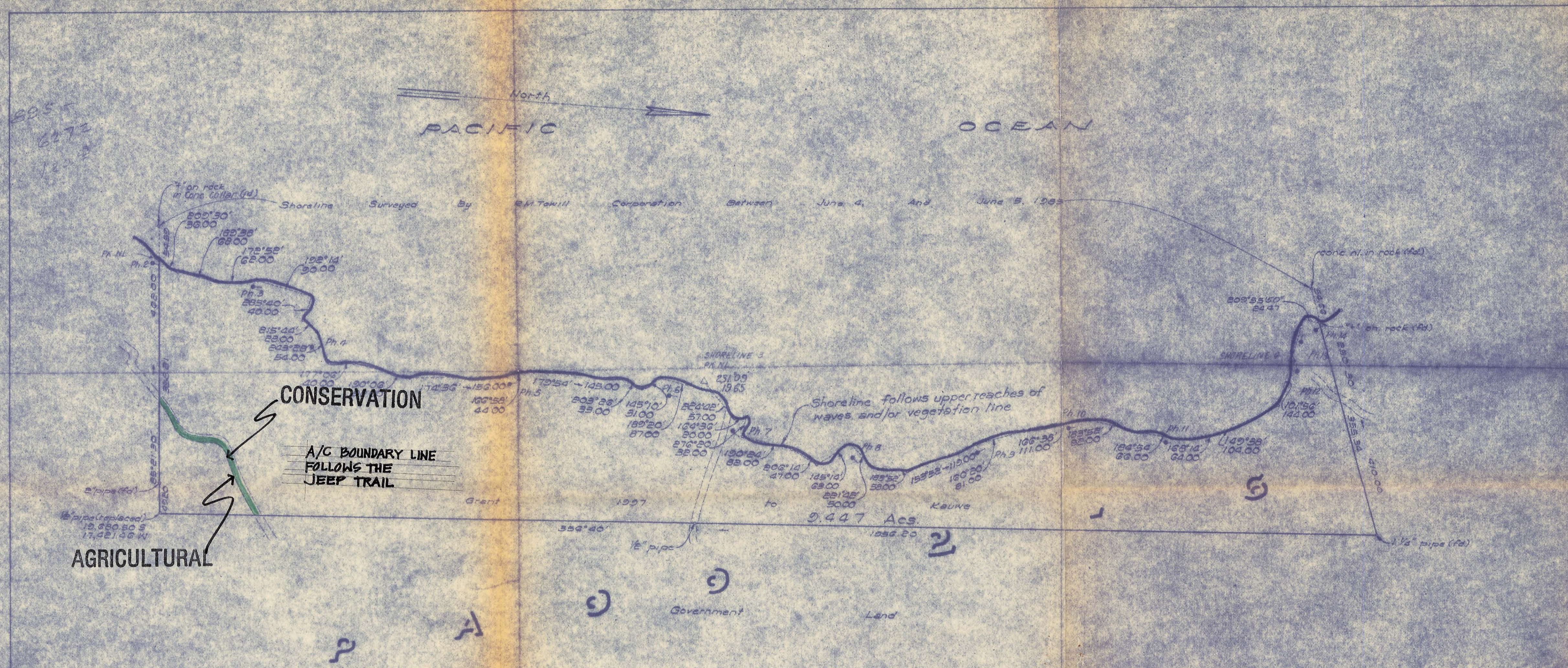

SHORELINE LOCATION  
ALONG GRANT 1997 TO KAUWE  
AT PAO 2-G, NORTH KOHALA  
ISLAND OF HAWAII, HAWAII  
TMK 5-7-015 (3RD DIV.)

The boundary as located, named and delineated is hereby certified as the actual Land Use District Boundary adopted by the State Land Use Commission, Honolulu, Hawaii.

JAN 21 1987  
Date by Executive Officer

The shoreline as located and certified and delineated is hereby certified as the actual boundary as shown on this map.  
AUG 20 1985



THIS MAP WAS PREPARED BY ME OR UNDER MY SUPERVISION

LAND USE COMMISSION  
STATE OF HAWAII  
JAN 15 10 13 AM '87