

STATE OF HAWAII
LAND USE COMMISSION
Room 104, Old Federal Bldg.
335 Merchant Street
Honolulu, Hawaii 96813

March 16, 1987

David P. Fichman
P.O. Box 1191
Kapaau, Hawaii 96755

Dear Mr. Fichman:

SUBJECT: Boundary Interpretation 87-10

Tax Map Key: 5-5-8:47

Location: North Kohala, Hawaii

Requested by: David Fichman

Pursuant to your request of March 6, 1987, we have delineated the State's Land Use District boundaries on the enclosed map.

Very truly yours,

Esther Ueda

ESTHER UEDA
Executive Officer

*WORKED
4/14/87*

Enclosure

cc: Albert Lono Lyman, Hawaii Planning Director
✓ Glenn Y. Sato, Tax Maps & Records Supervisor
C&C of Honolulu, Department of Finance

MAR 19 1987

LAND USE COMMISSION
STATE OF HAWAII
MAR 6 11 20 AM '87

Boundary Interpretation No. 87-10

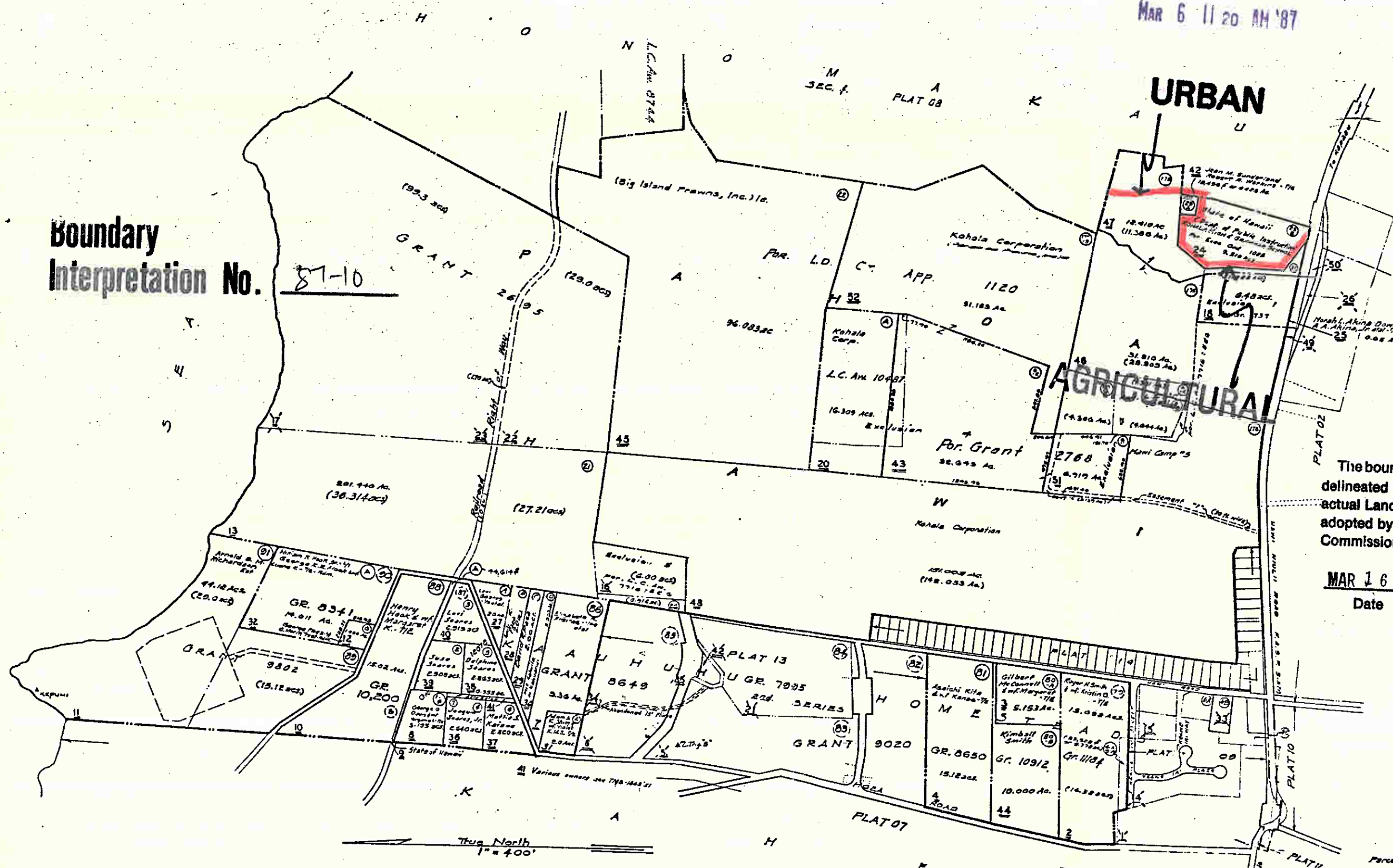

The boundary as located, named and delineated is hereby certified as the actual Land Use District Boundary adopted by the State Land Use Commission, Honolulu, Hawaii.

MAR 16 1987
Date Executive Officer

3 1291
Portions of PAHOA to KAHEI, N. KOHALA, HAWAII.

ADVANCE SHEET
SUBJECT TO CHANGE

Parcels Dropped: 18, 24, 32, 33, 35, 36, 37, 38, 39, 40, 41, 42, 43, 44, 45, 46, 47, 48, 49, 50, 51, 52, 53, 54, 55, 56, 57, 58, 59, 60, 61, 62, 63, 64, 65, 66, 67, 68, 69, 70, 71, 72, 73, 74, 75, 76, 77, 78, 79, 80, 81, 82, 83, 84, 85, 86, 87, 88, 89, 90, 91, 92, 93, 94, 95, 96, 97, 98, 99, 100

THIRD DIVISION		
ZONE	SEC.	PLAT
5	5	08
CONTAINING PARCELS		
Scale: 1 in. = 400 ft.		