

STATE OF HAWAII
LAND USE COMMISSION
Room 104, Old Federal Bldg.
335 Merchant Street
Honolulu, Hawaii 96813

August 10, 1987

Mr. Joel La Pinta
688 Kinoole Street, Suite 103
Hilo, Hawaii 96720

Dear Mr. La Pinta:

LUC
SUBJECT: Boundary Interpretation 87-46

Tax Map Key: 3-2-4: 1, 2, 3, 6, 17, 13 & 14

Location: Maulua, Waikaumalo Homesteads

Requested by: Mr. Joel La Pinta (Winniman
International Real Estate, Inc.)

Pursuant to your request of _____, we have delineated the State's Land Use District boundaries on the enclosed map.

Very truly yours,

Esther Ueda

ESTHER UEDA
Executive Officer

Enclosure Boundary Interpretation Map dated August 10, 1987

cc: William Paty, BLNR Chairman
Attn: Planning Office
✓ Albert Lono Lyman, Hawaii Planning Director
Glenn Y. Sato, Tax Maps & Records Supervisor
C&C of Honolulu, Department of Finance

ZONE 3 SECTION 4

AGRICULTURAL

AGRICULTURAL

AGRICULTURAL

CONSERVATION

CONSERVATION

NOTE: A/C LINE FOLLOWS THE EDGE OF GULCH.

The boundary as located, named and delineated is hereby certified as the actual Land Use District Boundary adopted by the State Land Use Commission, Honolulu, Hawaii.

AUG 10 1987 by [Signature] Executive Officer

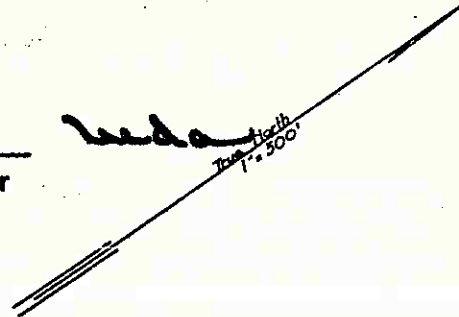

Note: All parcels owned by Mauna Kea Sugar Co., Inc. unless otherwise noted.

Boundary Interpretation No. 87-46

3 1087

THIRD DIVISION	
ZONE	PLAT
3	04

LAND USE COMMISSION STATE OF HAWAII
JUN 29 1 14 PM '87

