



STATE OF HAWAII
DEPARTMENT OF BUSINESS
AND ECONOMIC DEVELOPMENT

• • •
LAND USE COMMISSION

Room 104, Old Federal Bldg., 335 Merchant Street
Honolulu, Hawaii 96813 Telephone: 548-4611

JOHN WAIHEE
Governor
TEOFILO PHIL TACBIAN
Chairman

FREDERICK P. WHITTEMORE
Vice Chairman

COMMISSION MEMBERS:

Richard B.F. Choy
Lawrence F. Chun
Everett L. Guskaden
Sharon R. Himeno
Toru Suzuki
Robert S. Tamaye
Renton L.K. Nip

ESTHER UEDA
Executive Officer

February 2, 1988

Mr. Glenn Y. Taguchi
Department of Land & Natural Resources
Division of Land Management
P.O. Box 936
Hilo, Hawaii 96721-0936

Dear Mr. Taguchi:

SUBJECT: Boundary Interpretation 88-3

Tax Map Key: 1-8-08: 29 & 35

Location: Ola'a Reservation Lots, Volcano, Hawaii

Requested By: Mr. Glenn Y. Taguchi

Pursuant to your request of January 14, 1988,
we have delineated the State's Land Use District boundaries on
the enclosed map.

Very truly yours,

ESTHER UEDA
ESTHER UEDA
Executive Officer

Enclosure

cc: William Paty, BLNR Chairman
Attn: Planning Office
Albert Lono Lyman, Hawaii Planning Director
✓ Glenn Y. Sato, Tax Maps & Records Supervisor
C&C of Honolulu, Dept. of Finance

*No change
2/8/88*
FEB 4 1988

Boundary Interpretation No. 88-3

The boundary as located, named and delineated is hereby certified as the actual Land Use District Boundary adopted by the State Land Use Commission, Honolulu, Hawaii.

FEB 02 1988
by [Signature]
Executive Officer

CONSERVATION

AGRICULTURAL

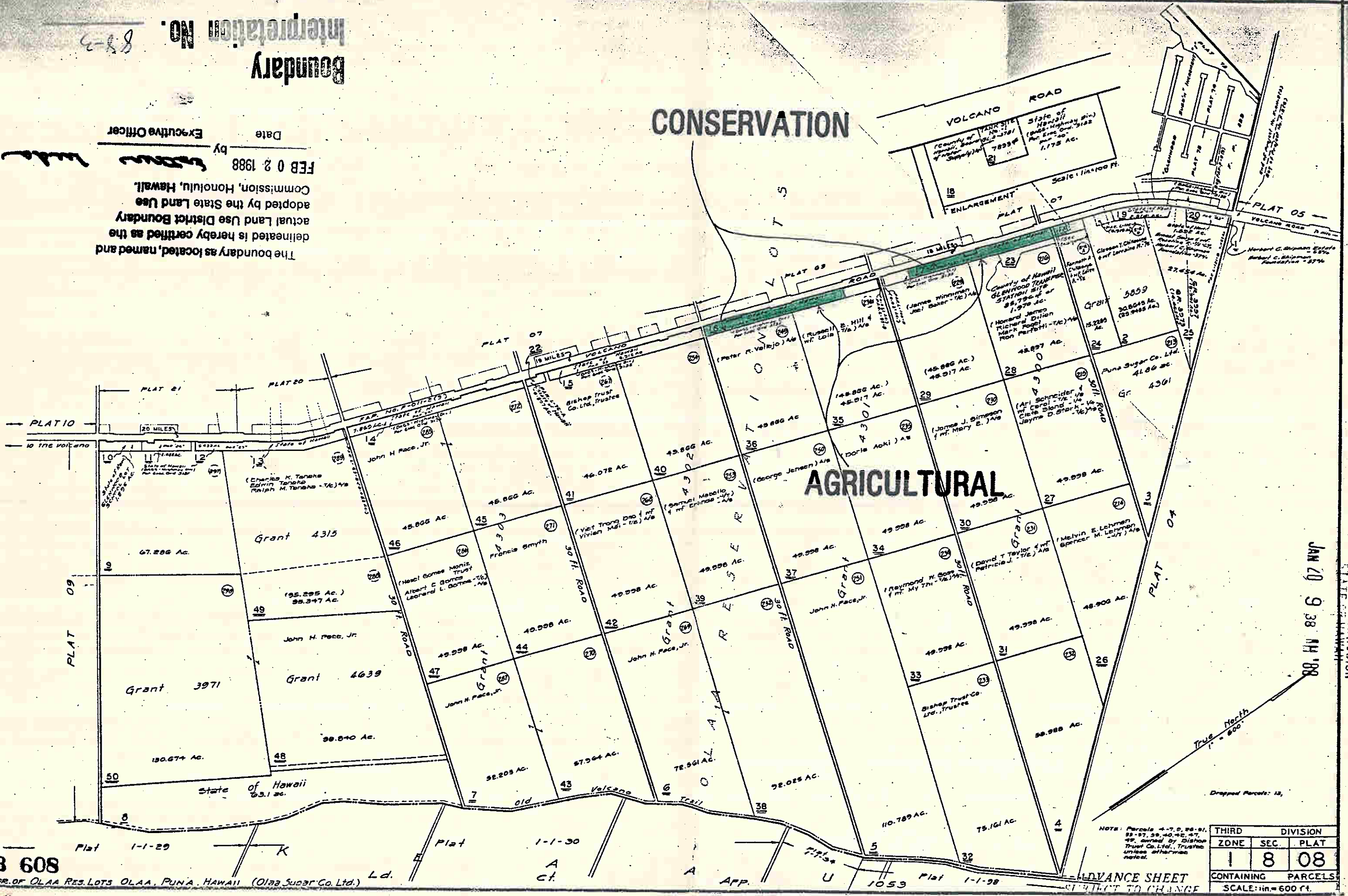

3 608
FOR OF OLAA RES. LOTS OLAA, PUNA, HAWAII (Olaa Sugar Co. Ltd.)

NOTE: Parcels 4-7, 9, 26-31, 33-37, 39, 40, 42, 47, 49, owned by Bishop Trust Co. Ltd., Trustee unless otherwise noted.

THIRD DIVISION	
ZONE	SEC. PLAT
1	8 08

CONTAINING PARCELS: 18
SCALE: 1 in. = 600 ft.

ADVANCE SHEET SUBJECT TO CHANGE

PRINTED

JAN 20 9 38 AM '88
LAND USE COMMISSION
STATE OF HAWAII