

STATE OF HAWAII

JOHN WAIHEE
Governor

DEPARTMENT OF BUSINESS
AND ECONOMIC DEVELOPMENT

RENTON L.K. NIP
Chairman

LAWRENCE F. CHUN
Vice Chairman

LAND USE COMMISSION



Room 104, Old Federal Building, 335 Merchant Street
Honolulu, Hawaii 96813 Telephone: 548-4611

COMMISSION MEMBERS:

Sharon R. Himeno
Teofilo Phil Tacbian
Everett Cuskaden
Robert Tamaye
Frederick P. Whittenore
Toru Suzuki
Richard B.F. Choy

ESTHER UEDA
Executive Officer

May 17, 1988

Mr. Robert G. Williams
Orchid Isle Properties
525 Kilauea Avenue
Suite 203
Hilo, Hawaii 96720

Dear Mr. Williams:

SUBJECT: Boundary Interpretation 88-25

Tax Map Key: 3-2-1: 8

Location: Nanue & Honohina, North Hilo, Hawaii

Requested By: Mr. Robert G. Williams

Pursuant to your request of May 2, 1988;

we have delineated the State's Land Use District boundaries on
the enclosed map.

Very truly yours,

Esther Ueda

ESTHER UEDA
Executive Officer

Enclosure: Boundary Interpretation Map dated May 17, 1988

cc: William Paty, BLNR Chairman
Attn: Planning Office
Albert Lono Lyman, Hawaii Planning Director
Glenn Y. Sato, Tax Maps & Records Supervisor
C&C, Department of Finance

MAY 19 1988

- 23 Takayoshi Fujimori & Iwaki Matsuno O-778
- 21 Richard V Toledo & Ivy T Garcia
- 20 & 22 Pepee Koo Sugar Co.
- 10 Richard V Toledo (Kenneth M. T. Nuzen & W. Kristina B. M. - 72) AS
- 7 Richard V Toledo

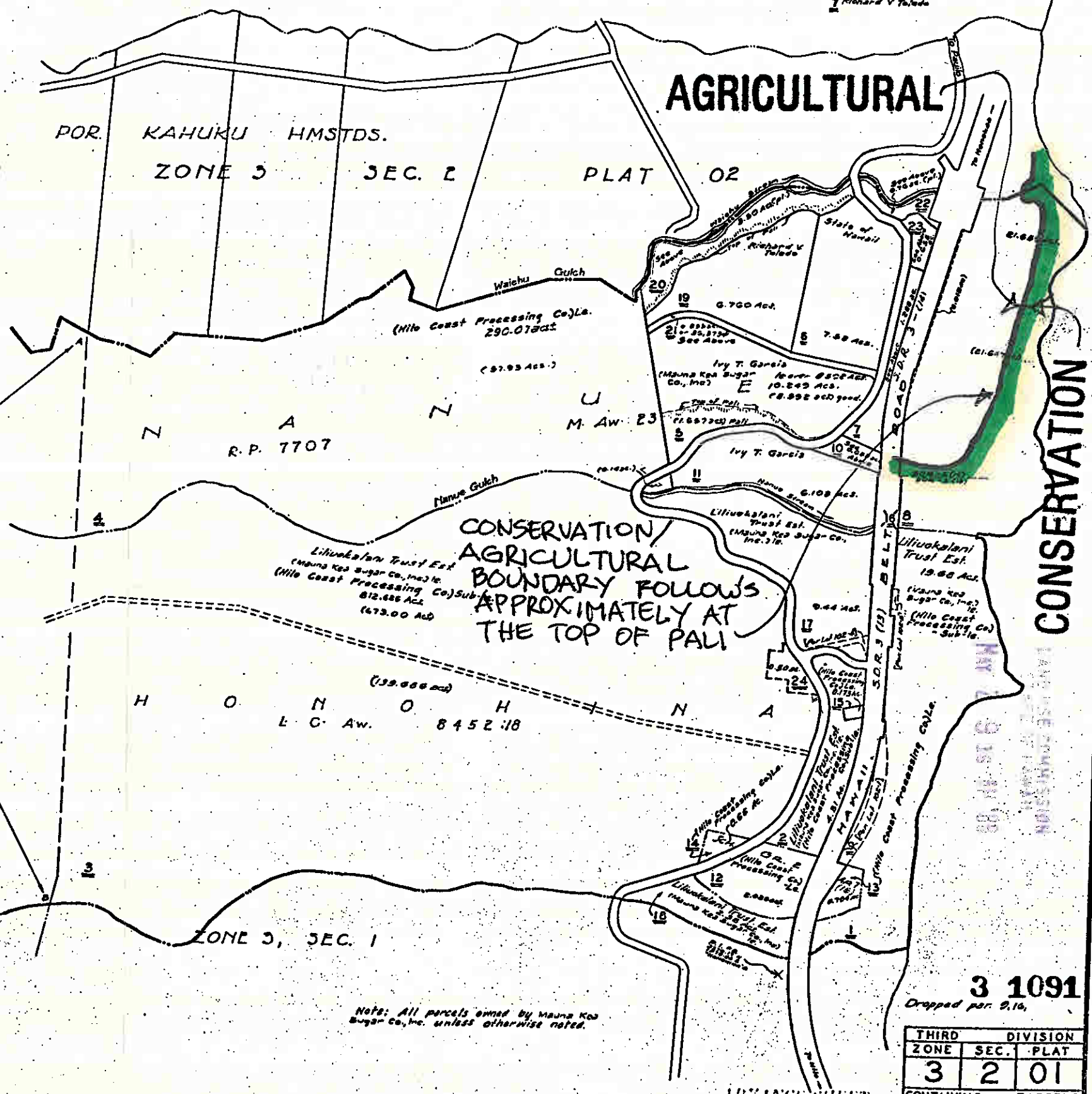
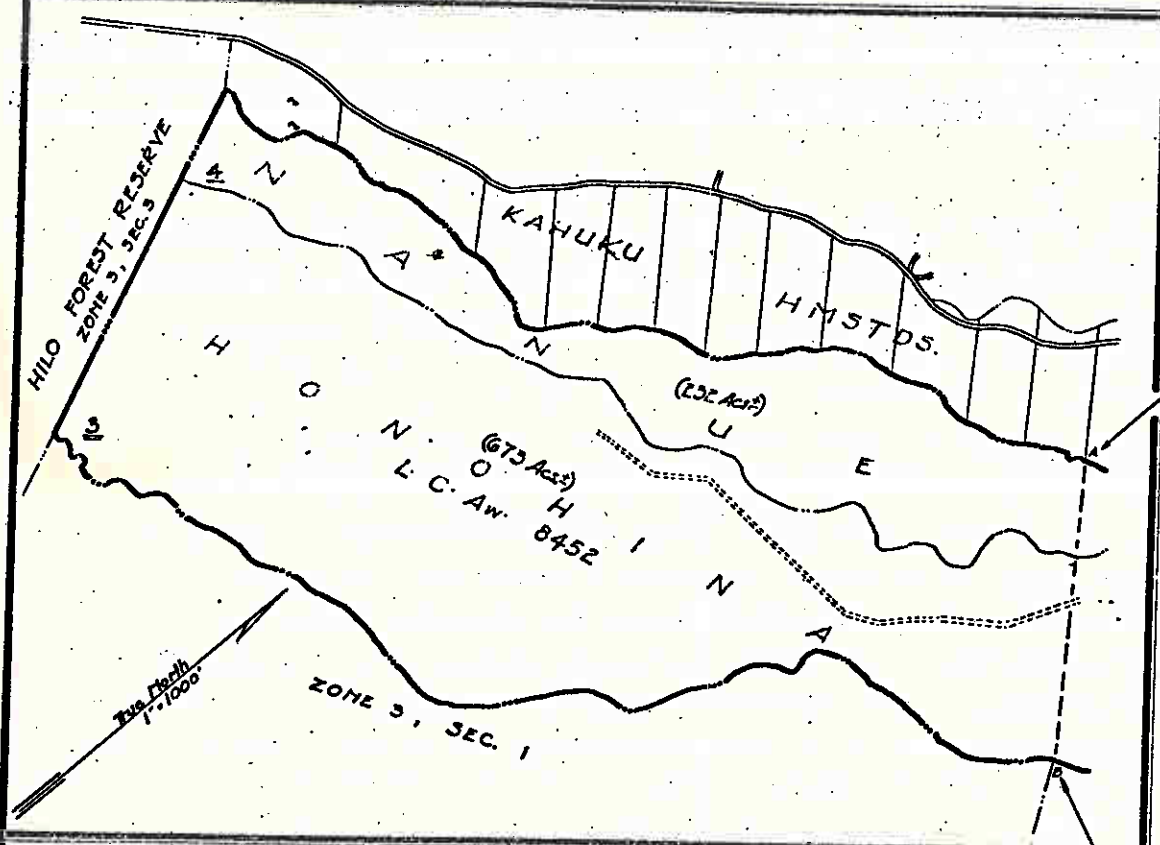

The boundary as located, named and delineated is hereby certified as the actual Land Use District Boundary adopted by the State Land Use Commission, Honolulu, Hawaii.

MAY 17 1983
Date by [Signature]
Executive Officer

Boundary Interpretation No. 88-25

NANUE & HOMOHIWA, N. HILO (Hakalau Plantation Co)

Note: All parcels owned by Mauna Kea Sugar Co., Inc. unless otherwise noted.

THIRD DIVISION		
ZONE	SEC.	PLAT
3	2	01
CONTAINING 1 PARCELS		
SCALE: As noted		

PRINTED 1" =