

DEPARTMENT OF BUSINESS
AND ECONOMIC DEVELOPMENT

LAND USE COMMISSION

Room 104, Old Federal Building, 335 Merchant Street
Honolulu, Hawaii 96813 Telephone: 548-4611

GOVERNOR
Governor

RENTON L.K. NIP
Chairman

LAWRENCE F. CHUN
Vice Chairman

COMMISSION MEMBERS:

Sharon R. Himeno
Allen K. Hoe
Allen Y. Kajioka
Eusebio Lapenta, Jr.
James M. Shinno
Elton Wada
Frederick P. Whittemore

ESTHER UEDA
Executive Officer

September 22, 1989

Mr. Greg Gadd
Big Island Land Company, Ltd
P.O. Box 342
Hilo, Hawaii 96721

Dear Mr. Gadd:

SUBJECT: Boundary Interpretation 89-51

Tax Map Key: 1-4-3: 01

Location: Halepuaa & Honolulu, Puna, Hawaii

Requested By: Mr. Greg Gadd

Superseded by 89-54

Pursuant to your request of August 8, 1989,
we have delineated the State's Land Use District boundaries on
the enclosed map.

Very truly yours,
Esther Ueda

ESTHER UEDA
Executive Officer

Enclosure: Boundary Interpretation Map dated September 22, 1989.

cc: William Paty, BLNR Chairman, Attn: Conservation Affairs Office
Duane Kanuha, Hawaii Planning Director
✓ Glenn Y. Sato, Tax Maps & Records Supervisor
C&C of Honolulu, Department of Finance

The boundary as located, named and delineated is hereby certified as the actual Land Use District Boundary adopted by the State Land Use Commission, Honolulu, Hawaii.

SEP 22 1989 Date by Executive Officer

- Mona Kanner
- Lee M. Keenani
- Robert B. Robinson, Jr.
- John J. J. J.
- Alice Chung
- Margaret S. S.
- Alfred C. C.
- Malcolm S. S.
- William S. S.
- Bernice L. L.
- William L. L.

- Owners of Parcel 3:
- Harriet B. Sawyer
 - Stephen T. T.
 - Edwin K. Maunakea, Jr.
 - Katherine K. Bright
 - Jack K. Maunakea
 - Nadine K. Meyer
 - Yvonne K. Veit
 - William K. K.
 - Harriet B. Sawyer
 - James K. Alapai
 - Ellen K. Alapai Johnson
 - Harriet K. O'Quinn
 - George K. Alapai
 - Raunald K. Alapai
 - Lyant H. Alapai

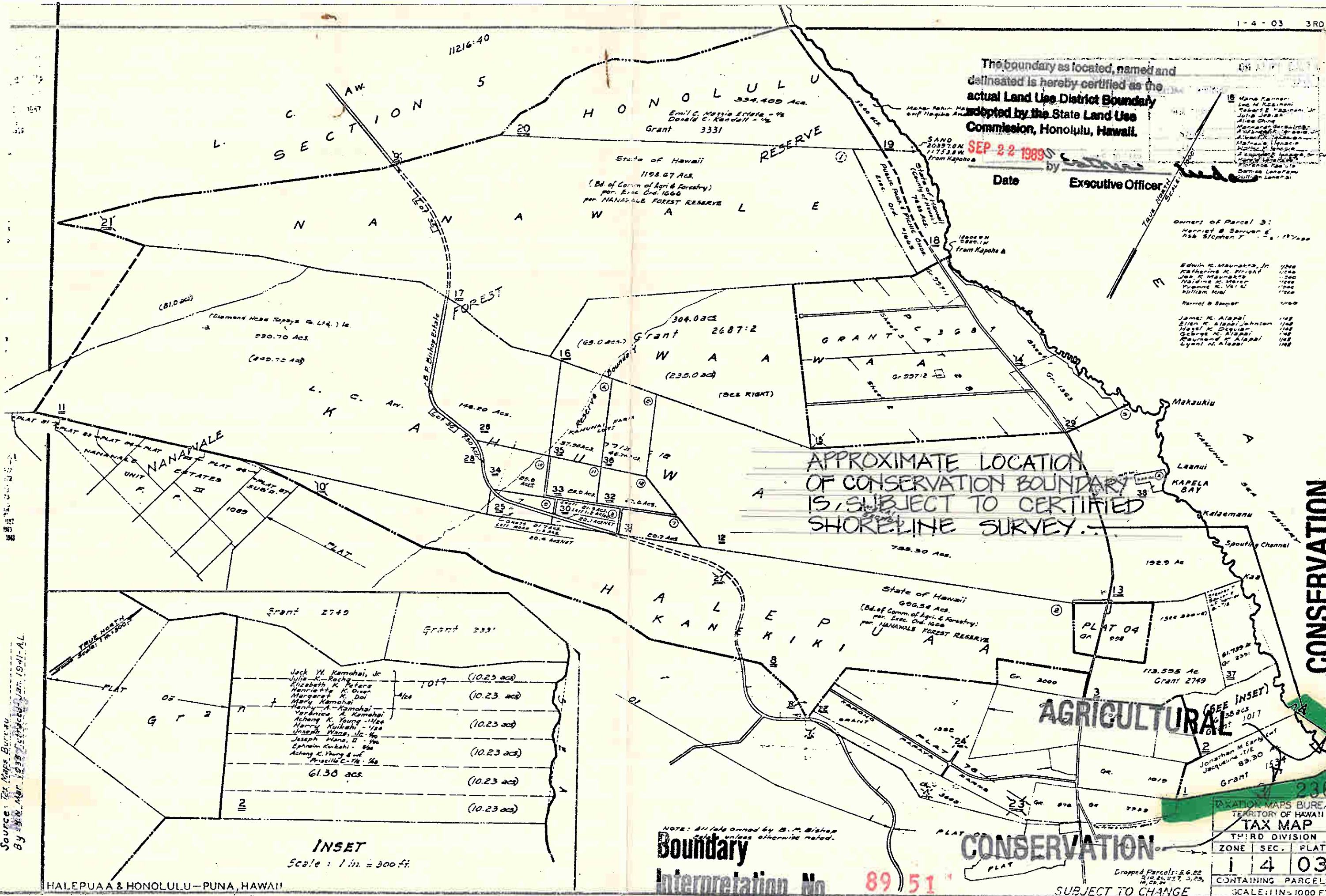

APPROXIMATE LOCATION OF CONSERVATION BOUNDARY IS SUBJECT TO CERTIFIED SHORELINE SURVEY.

CONSERVATION

AGRICULTURAL (SEE INSET)

NOTE: All lots owned by B. P. Bishop unless otherwise noted.

Boundary Interpretation No. 89 51

CONSERVATION

TAXATION MAPS BUREAU
TERRITORY OF HAWAII
TAX MAP
THIRD DIVISION

ZONE	SEC.	PLAT
1	4	03

CONTAINING PARCELS
SCALE: 1 IN. = 1000 FT.

Source: Tax Maps Bureau By W. N. M. 1939 Revised Jan. 1941-A.L.

INSET Scale: 1 in. = 300 ft.

HALEPUA & HONOLULU-PUNA, HAWAII

Cropped Parcels: 56.22 210.25, 217.5, 29, 14, 25.8

SUBJECT TO CHANGE