

STATE OF HAWAII
DEPARTMENT OF BUSINESS
AND ECONOMIC DEVELOPMENT

JOHN WAIHEE
Governor

RENTON L.K. NIP
Chairman

FREDERICK P. WHITTEMORE
Vice Chairman

LAND USE COMMISSION

Room 104, Old Federal Building, 335 Merchant Street
Honolulu, Hawaii 96813 Telephone: 548-4611

COMMISSION MEMBERS:

Lawrence F. Chun
Sharon R. Himeno
Allen K. Hoe
Allen Y. Kajfoka
Eusebio Lapenia, Jr.
James M. Shinno
Elton Hada

ESTHER UEDA
Executive Officer

*M 90-87
3rd*

March 8, 1990

Mr. Donald J. Murray
Murray, Smith & Associates, Ltd.
Hilo Hotel Office Annex
Hilo, Hawaii 96721

Dear Mr. Murray:

SUBJECT: Boundary Interpretation 90-05

Tax Map Key: 2-8-13: 10

Location: Honomu, South Hilo, Hawaii

Requested By: Mr. Donald J. Murray

Pursuant to your request of January 31, 1990,
we have delineated the State's Land Use District boundaries on
the enclosed map.

Very truly yours,

Esther Ueda

ESTHER UEDA
Executive Officer

Enclosure : Boundary Interpretation Map dated March 8, 1990

cc: William Paty, BLNR Chairman, Attn: Conservation Affairs Office
/ Duane Kanuha, Hawaii Planning Director
/ Glenn Y. Sato, Tax Maps & Records Supervisor
C&C of Honolulu, Department of Finance

MAR 12 1990

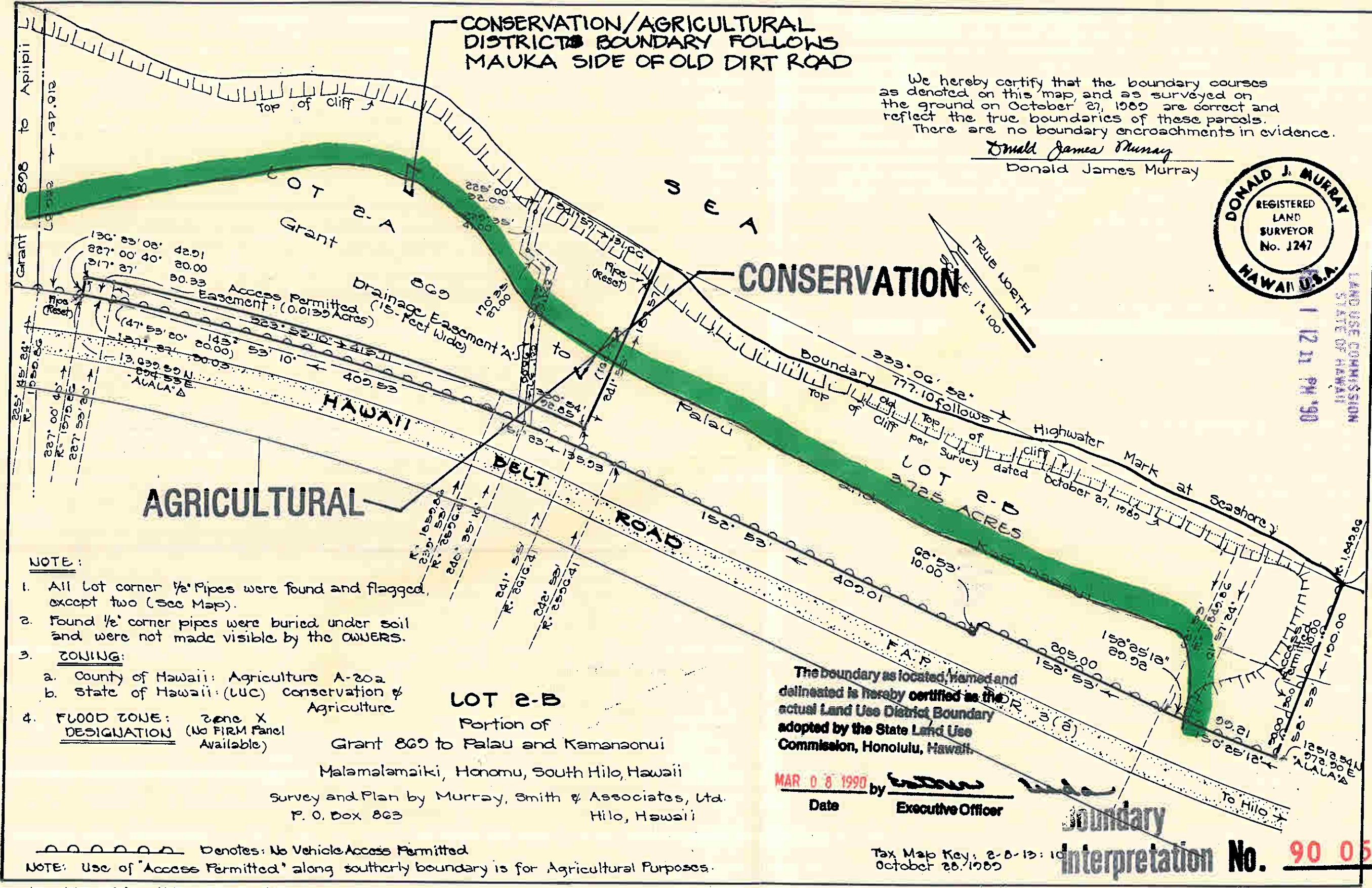

We hereby certify that the boundary courses as denoted on this map, and as surveyed on the ground on October 27, 1989 are correct and reflect the true boundaries of these parcels. There are no boundary encroachments in evidence.

Donald James Murray
Donald James Murray

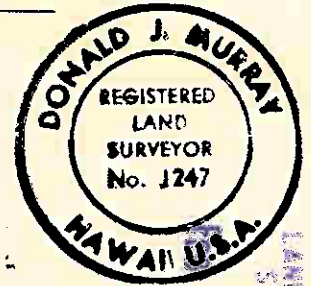

LAND USE COMMISSION
STATE OF HAWAII
12 11 PM '90

NOTE:

1. All lot corner 1/2" pipes were found and flagged, except two (See Map).
2. Found 1/2" corner pipes were buried under soil and were not made visible by the OWNERS.
3. **ZONING:**
 - a. County of Hawaii: Agriculture A-20a
 - b. State of Hawaii: (LUC) Conservation & Agriculture
4. **FLOOD ZONE:** Zone X
DESIGNATION: (No FIRM Panel Available)

LOT 2-B
Portion of
Grant 869 to Palau and Kamanaonui
Malamalamaiki, Honouliuli, South Hilo, Hawaii
Survey and Plan by Murray, Smith & Associates, Ltd.
P. O. Box 863
Hilo, Hawaii

The boundary as located, named and delineated is hereby certified as the actual Land Use District Boundary adopted by the State Land Use Commission, Honolulu, Hawaii.

MAR 08 1990 by *[Signature]*
Date Executive Officer

Boundary Interpretation No. 90 05

Denotes: No Vehicle Access Permitted
NOTE: Use of "Access Permitted" along southerly boundary is for Agricultural Purposes.

Tax Map Key: 2-B-13: 10
October 28, 1989