



STATE OF HAWAII  
DEPARTMENT OF BUSINESS, ECONOMIC DEVELOPMENT, AND TOURISM  
LAND USE COMMISSION  
Room 104, Old Federal Building  
335 Merchant Street  
Honolulu, Hawaii 96813  
Telephone: 548-4611

August 27, 1991

Ms. Leslie Kurisaki  
Helber, Hastert & Fee  
733 Bishop Street, Suite 2590  
Honolulu, Hawaii 96813

Dear Ms. Kurisaki:

SUBJECT: Boundary Interpretation 91-35

Tax Map Key: 4-5-10: 3, 5, & 92; 4-3-3: 13;  
4-3-4: 03  
Location: Hamakua, Hawaii  
Requested By: Leslie Kurisaki

Pursuant to your request of July 15, 1991,  
we have delineated the State's Land Use District boundaries on  
the enclosed map.

Very truly yours,

ESTHER UEDA  
Executive Officer

Enclosure: Boundary Interpretation Map dated August 27, 1991

cc: ✓ Norman Hayashi, Hawaii Planning Director  
Glenn Y. Sato, Tax Maps & Records Supervisor  
C&C of Honolulu, Department of Finance

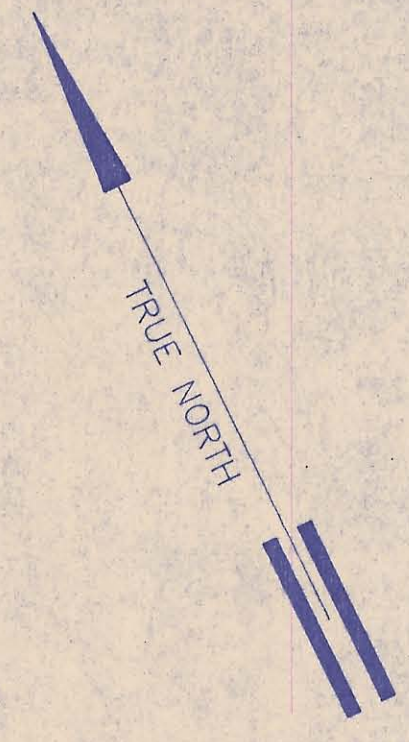
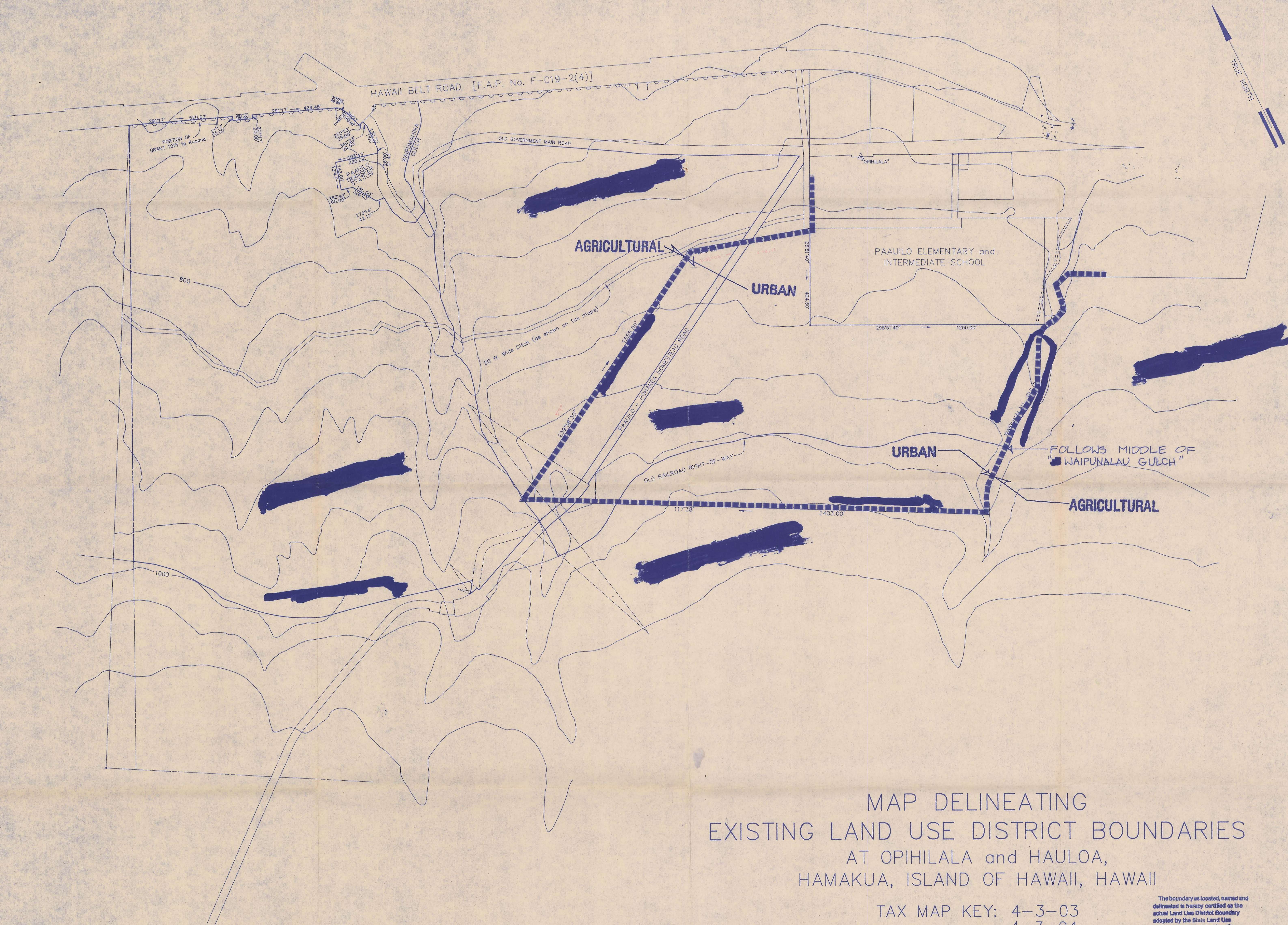

MAP DELINEATING  
 EXISTING LAND USE DISTRICT BOUNDARIES  
 AT OPIHIALALA and HAULOA,  
 HAMAKUA, ISLAND OF HAWAII, HAWAII

TAX MAP KEY: 4-3-03  
 4-3-04  
 4-3-07

The boundary as located, named and delineated is hereby certified as the actual Land Use District Boundary adopted by the State Land Use Commission, Honolulu, Hawaii.

AUG 27 1991 Date by *[Signature]* Executive Officer

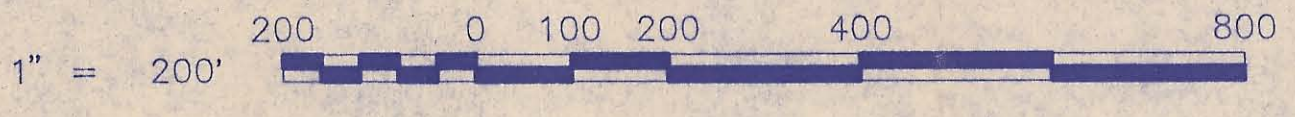

Boundary Interpretation No. 4135

RECEIVED  
 JUN 29 1991  
 State of Hawaii  
 LAND USE COMMISSION

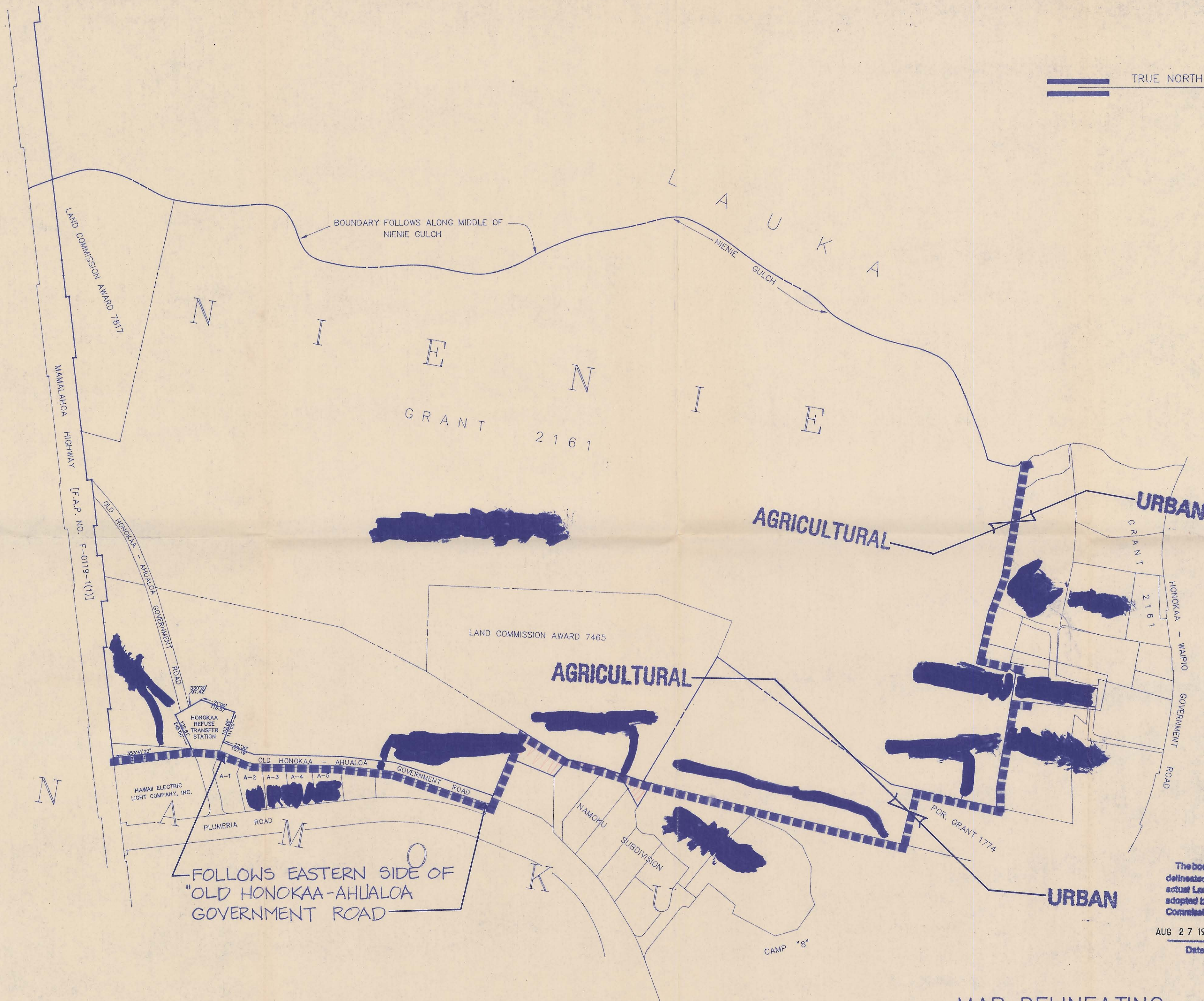
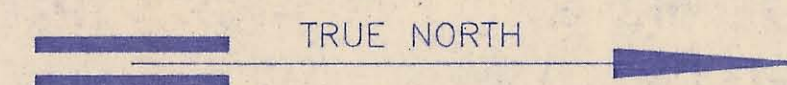

The boundary as located, named and delineated is hereby certified as the actual Land Use District Boundary adopted by the State Land Use Commission, Honolulu, Hawaii.  
AUG 27 1991 *Esther Lida*  
Date by Executive Officer

MAP DELINEATING  
EXISTING LAND USE DISTRICT BOUNDARIES  
AT NIENIE AND NAMOKU,  
HAMAKUA, ISLAND OF HAWAII, HAWAII  
TAX MAP KEY: 4-5-10



Boundary Interpretation No. 91 35

RECEIVED  
JUL 29 1991  
State of Hawaii  
LAND USE COMMISSION