



STATE OF HAWAII
DEPARTMENT OF BUSINESS, ECONOMIC DEVELOPMENT & TOURISM
LAND USE COMMISSION
Room 104, Old Federal Building
335 Merchant Street
Honolulu, Hawaii 96813
Telephone: 587-3822

February 6, 1992

Mr. Russell Figueiroa, V. P.
R. M. Towill Corporation
73-5574 Maiiau Street, Apt. #11
Kailua-Kona, Hawaii 96740-2618

No
drag

Dear Mr. Figueiroa:

Subject: BOUNDARY INTERPRETATION No. 92-01 for
T.M.K. No: 5-5-02: 23 for Hawi,
North Kohala, Hawaii

Pursuant to your January 9, 1992 letter, please be advised that the subject area is within the Agricultural/Urban Districts.

Blue-line prints of your maps with the State Land Use Agricultural/Urban District boundaries designated are enclosed for your reference.

If you have any questions, please call Fred Talon or Bert Saruwatari of my staff at 587-3822.

Sincerely,

Esther Ueda

ESTHER UEDA
Executive Officer

EU:fl

encl: Boundary Interpretation Maps dated February 6, 1992.

cc: Norman Hayashi, Hawaii Planning Director
*Glenn Y. Sato, Tax Maps & Records Supervisor,
C&C of Honolulu, Department of Finance

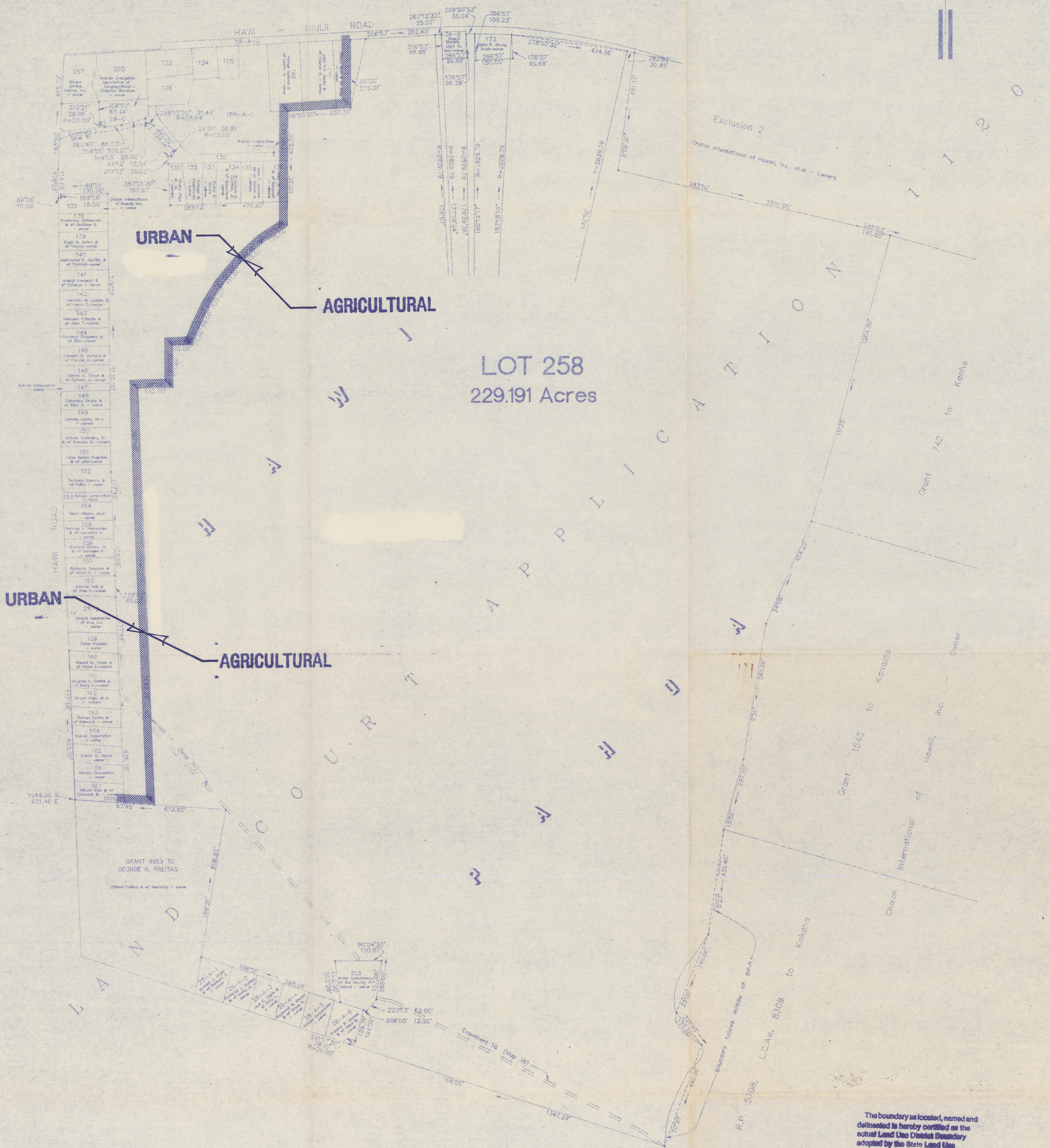

LOT 258
229.191 Acres

URBAN

AGRICULTURAL

AGRICULTURAL

URBAN

The boundary as located, named and delineated in hereby certified as the actual Land Use District Boundary adopted by the State Land Use Commission, Honolulu, Hawaii.

DATE 11.6.1992 BY [Signature] Executive Officer

RECEIVED
JAN 13 1992
State of Hawaii
LAND USE COMMISSION

LAND USE DISTRICT BOUNDARY INTERPRETATION LOT 258 (MAP 42) OF LAND COURT APPLICATION 1120 AT HAWI, PAHOA, NORTH KOHALA, ISLAND OF HAWAII, HAWAII

Boundary Interpretation No. **92 01**

This work was prepared by me or under my supervision
R. M. TOWILL CORPORATION

73-5574 MAIAU STREET, #118
KAILUA-KONA, HAWAII 96740



RUSSELL FIGUEIROA
Registered Professional Surveyor
Certificate Number 4729
Land Court No. 190

Note: Coordinates and Azimuths are referred to Government Survey Triangulation Station "Puu O Nole" &

