



STATE OF HAWAII
DEPARTMENT OF BUSINESS, ECONOMIC DEVELOPMENT & TOURISM
LAND USE COMMISSION
Room 104, Old Federal Building
335 Merchant Street
Honolulu, Hawaii 96813
Telephone: 587-3822

December 16, 1992

Mr. James Wm. McCully
James McCully Orchid Culture
P. O. Box 311
Mountain View, Hawaii 96771

Dear Mr. McCully:

Subject: BOUNDARY INTERPRETATION No. 92-48 for TMK No.: 2-9-03: 13,
Wailea, South Hilo, Hawaii

Pursuant to your November 23, 1992 letter, please be advised that the subject parcel is designated within the Conservation / Agricultural Districts.

A blueline print of your map with the State Land Use Conservation / Agricultural District boundary delineated in metes & bounds is enclosed for your reference.

With respect to your desire to seek a boundary amendment to amend the Conservation District boundary of the subject parcel, please be advised that inasmuch as such an amendment would involve the reclassification of lands out of the Conservation District, you would need the approval of the State Land Use Commission.

If you have any questions, please call Fred Talon or Bert Saruwatari of my staff at 587-3822.

Sincerely,

A handwritten signature in cursive script, appearing to read "Esther Ueda".

ESTHER UEDA
Executive Officer

EU:f1

encl: Boundary Interpretation Map dated December 16, 1992

cc: William Paty, BLNR Chairperson,
Attn: Conservation Affairs Office
Virginia Goldstein, County of Hawaii Planning Director
x Glenn Y. Sato, Tax Maps & Records Supervisor,
C&C of Honolulu, Department of Finance

DEC 18 1992

**Boundary
Interpretation No. 92 481**

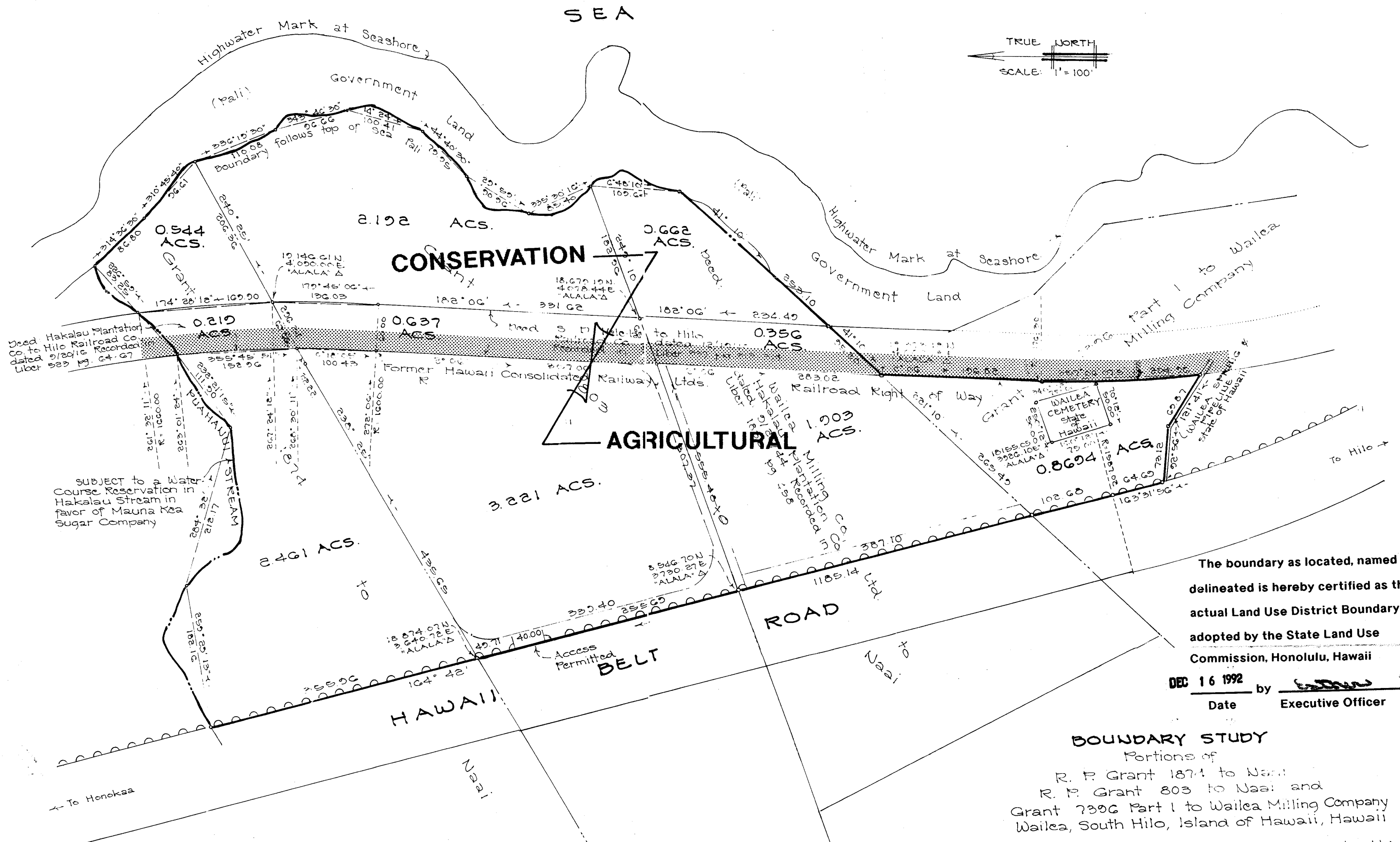

TRUE NORTH
SCALE: 1" = 100'

The boundary as located, named and delineated is hereby certified as the actual Land Use District Boundary adopted by the State Land Use Commission, Honolulu, Hawaii

DEC 16 1992 by [Signature]
Date Executive Officer

BOUNDARY STUDY
Portions of
R. P. Grant 1874 to Naa'i
R. P. Grant 803 to Naa'i and
Grant 730C Part 1 to Wailea Milling Company
Wailea, South Hilo, Island of Hawaii, Hawaii
Survey and Plan by Murray, Smith & Associates, Ltd.
P. O. Box 863 Hilo, Hawaii

Donald James Murray
TMK 3rd/2-0-03:13
October 21, 1992