

BENJAMIN J. CAYETANO
GOVERNOR



ESTHER UEDA
EXECUTIVE OFFICER

STATE OF HAWAII
DEPARTMENT OF BUSINESS, ECONOMIC DEVELOPMENT & TOURISM
LAND USE COMMISSION

Room 104, Old Federal Building
335 Merchant Street
Honolulu, Hawaii 96813
Telephone: 587-3822

February 16, 1995

Mr. Lee William Sichter
Belt Collins Hawaii
680 Ala Moana Boulevard
Honolulu, Hawaii 96813-5406

Dear Mr. Sichter:

Subject: BOUNDARY INTERPRETATION No. 95-04 for Tax Map
Key No.: 7-2-03: por. 1, 4, 5, 6, Kaupulehu,
North Kona, Hawaii

Pursuant to your January 31, 1995 letter requesting a boundary interpretation for the subject parcels, please be advised that we have determined an approximate location of the State Land Use Urban / Conservation District boundary.

Our determination is based on the Commission's records and official maps currently on file at our office, and the information that you provided.

A blueline print of your map with an approximate State Land Use Urban / Conservation District boundary delineated is enclosed for your reference.

If you have any questions, please call Fred Talon or Bert Saruwatari of my staff at 587-3822.

Sincerely,

A handwritten signature in cursive script, appearing to read "Esther Ueda".

ESTHER UEDA
Executive Officer

EU:fl

encl: Boundary Interpretation Map dated February 16, 1995

cc: Michael Wilson, BLNR Chairperson (w/encl.)

Attn: OCEA

Virginia Goldstein, County of Hawaii Planning Director
(w/encl.)

XGlenn Y. Sato, Tax Maps & Records Supervisor (w/encl.)
C&C of Honolulu, Department of Finance

FEB 22 1995



TRUE NORTH
Scale: 1 in. = 400 ft.

CONSERVATION TO URBAN
Gross Area = 1046.150 Acs.
Less Exclusion = 37.064 Acs.
NET AREA = 1009.086 Acs.

REVISED MAP SHOWING PETITION AREA

Being a portion of R.P. 7843, L.C. Av. 7715, Apana 10 to L. Kamehameha
KAUPULEHU, NORTH KONA, ISLAND OF HAWAII, HAWAII

- NOTES:
- Coordinates referred to "AKAHIPUU" Δ
 - Compiled from available data.
 - denotes no vehicular access permitted.
 - Exclusion is preliminary and subject to approval by the Dept. of Land & Natural Resources and Consulting Archeologist.

The boundaries as located, named and delineated is hereby certified as the actual Land Use District Boundary adopted by the State Land Use Commission, Honolulu, Hawaii.
Date: FEB 16 1995
Executive Officer

Boundary Interpretation No. 95 04

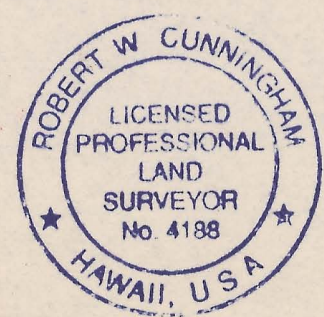

This work was prepared by me or under my supervision
Robert W. Cunningham

LUC Docket No. A93-701/
Kaupulehu Developments
Exhibit 5

BELT COLLINS HAWAII
680 Ala Moana Boulevard, First Floor
Honolulu, Hawaii 96813

RECEIVED
FEB 0 4 1995
State of Hawaii
LAND USE COMMISSION