



STATE OF HAWAII
DEPARTMENT OF BUSINESS, ECONOMIC DEVELOPMENT & TOURISM
LAND USE COMMISSION

P.O. Box 2359
Honolulu, HI 96804-2359
Telephone: 808-587-3822
Fax: 808-587-3827

February 21, 1997

Mr. Mark K. Luning
P. O. Box 1064
Mountain View, Hawai'i 96771

Dear Mr. Luning:

Subject: BOUNDARY INTERPRETATION No. 97-02 for Tax Map Key: 9-6-01:
7, Punalu'u, Ka'u, Hawai'i

Pursuant to your February 14, 1997, letter requesting a boundary interpretation for the subject parcel, please be advised that we have determined an approximate location of the State Land Use Urban / Conservation District boundary.

Our determination is based on the Commission's records and official maps currently on file at our office.

A copy of TMK: 9-6-01 with an approximate location of the State Land Use Urban / Conservation District boundary delineated is enclosed for your reference.

If you have any questions, please call Fred Talon or Bert Saruwatari of my staff at 587-3822.

Sincerely,

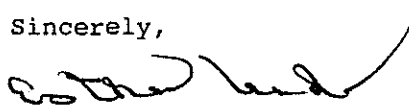
ESTHER UEDA
Executive Officer

EU:rg

encl.: Boundary Interpretation Map dated February 21, 1997

cc: Michael D. Wilson, BLNR Chairperson (w/encl.)
Attn: Dean Uchida, Land Division
Virginia Goldstein, Hawai'i County Planning Department (w/encl.)
Glenn Y. Sato, Tax Maps & Records Supervisor (w/encl.)
C&C of Honolulu, Department of Finance

FEB 27 1997

APPROXIMATE LOCATION OF STATE LAND USE
URBAN / CONSERVATION DISTRICT BOUNDARY
(SUBJECT TO STATE LAND USE DOCKET
NO. A69-224 / C. BREWER
COMPANY)

URBAN

CONSERVATION

URBAN

APPROXIMATE LOCATION OF STATE
LAND USE URBAN / CONSERVATION
DISTRICT BOUNDARY (SUBJECT TO
STATE LAND USE DOCKET NO. H74-24)

The boundary as located, named and
delineated is hereby certified as the
actual Land Use District Boundary
adopted by the State Land Use
Commission, Honolulu, Hawaii.

FEB 12 1 1997
Date by *[Signature]*
Executive Officer

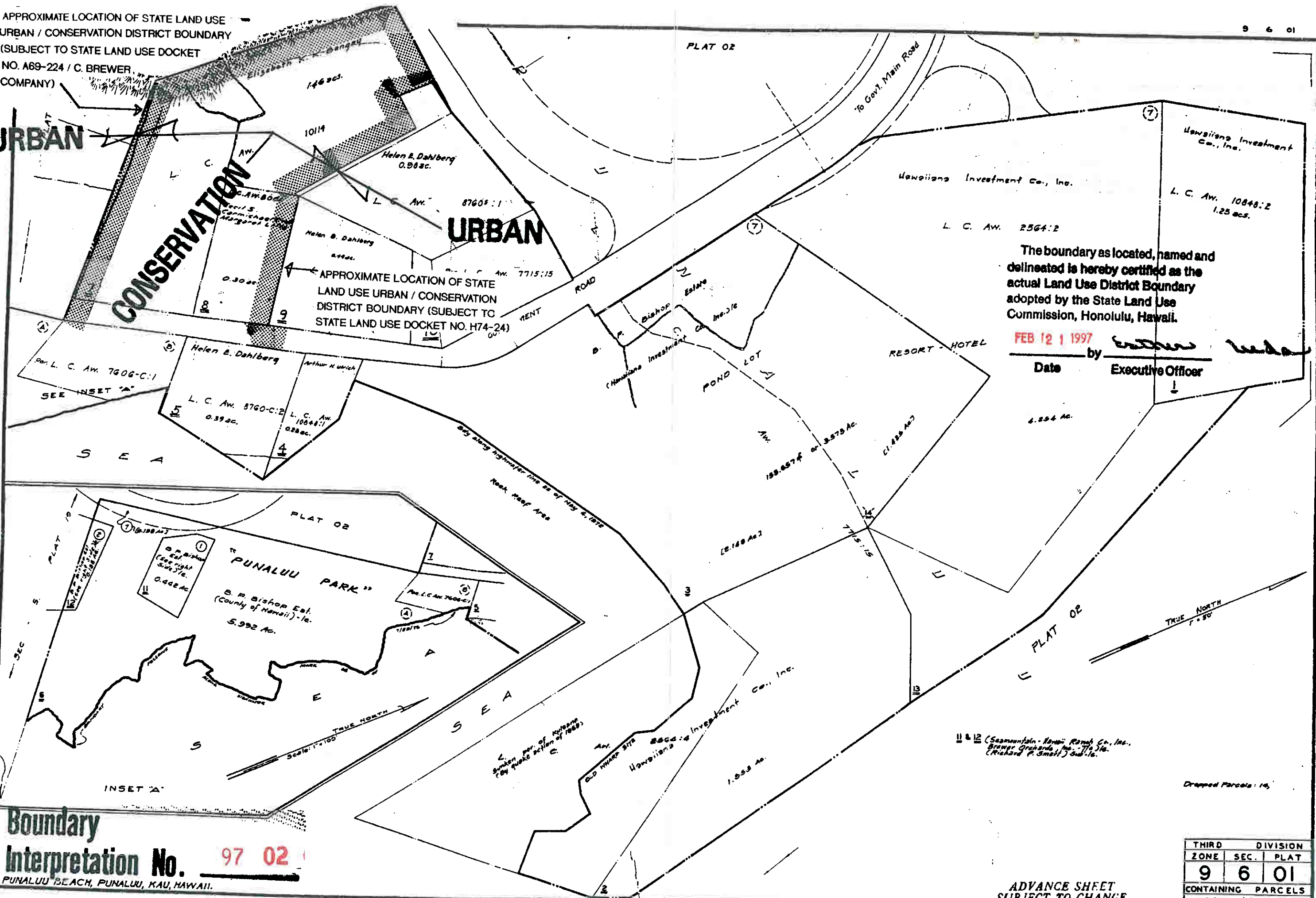

1968
1972
1974
1979
1978

By: D.S.C. & I.K.H. - Jan. 1976

Boundary Interpretation No. **97 02**
PUNALUU BEACH, PUNALUU, KAU, HAWAII.

11 & 12 (Seamountain - Hawaii Ranch Co., Inc.,
Brewer Grubbs, Inc. - The Site,
(Richard P. Small) Sub. 1c.

Dropped Parcels: 14

THIRD DIVISION		
ZONE	SEC.	PLAT
9	6	01
CONTAINING PARCELS		
SCALE: 1" = 500'		

ADVANCE SHEET
SUBJECT TO CHANGE