



STATE OF HAWAII
DEPARTMENT OF BUSINESS, ECONOMIC DEVELOPMENT & TOURISM
LAND USE COMMISSION

P.O. Box 2359
Honolulu, HI 96804-2359
Telephone: 808-587-3822
Fax: 808-587-3827

April 1, 1998

Mr. Robert K.Y. Lee, Project Manager
R. M. Towill Corporation
73-5574 Maiiau Street, #11B
Kailua-Kona, Hawai'i 96740-2618

M98-221

Dear Mr. Lee:

Subject: BOUNDARY INTERPRETATION No: 98-12 for Tax Map Key: 2-7-03:
1, Pu'u'eopaku 1st & 2nd, South Hilo, Hawai'i

Pursuant to your March 2, 1998, letter requesting a boundary interpretation for the subject parcel, please be advised that we have determined an approximate location of the State Land Use Urban / Agricultural / Conservation District boundaries.

Our determination is based on the Commission's records and official maps currently on file at our office and the map that you provided.

A copy of your map with an approximate location of the State Land Use Urban / Agricultural / Conservation District boundaries delineated is enclosed for your reference.

If you have any questions, please call Fred Talon or Bert Saruwatari of my staff at 587-3822.

Sincerely,

ESTHER UEDA
Executive Officer

EU:ft

encl: Boundary Interpretation Map dated April 1, 1998

cc: Michael D. Wilson, BLNR Chairperson (w/encl.)
Attn: Dean Uchida, Land Division
Virginia Goldstein, Hawai'i County Planning Director (w/encl.)
X Glenn Y. Sato, Tax Maps & Records Supervisor (w/encl.)
C&C of Honolulu, Department of Finance

APR 07 1998

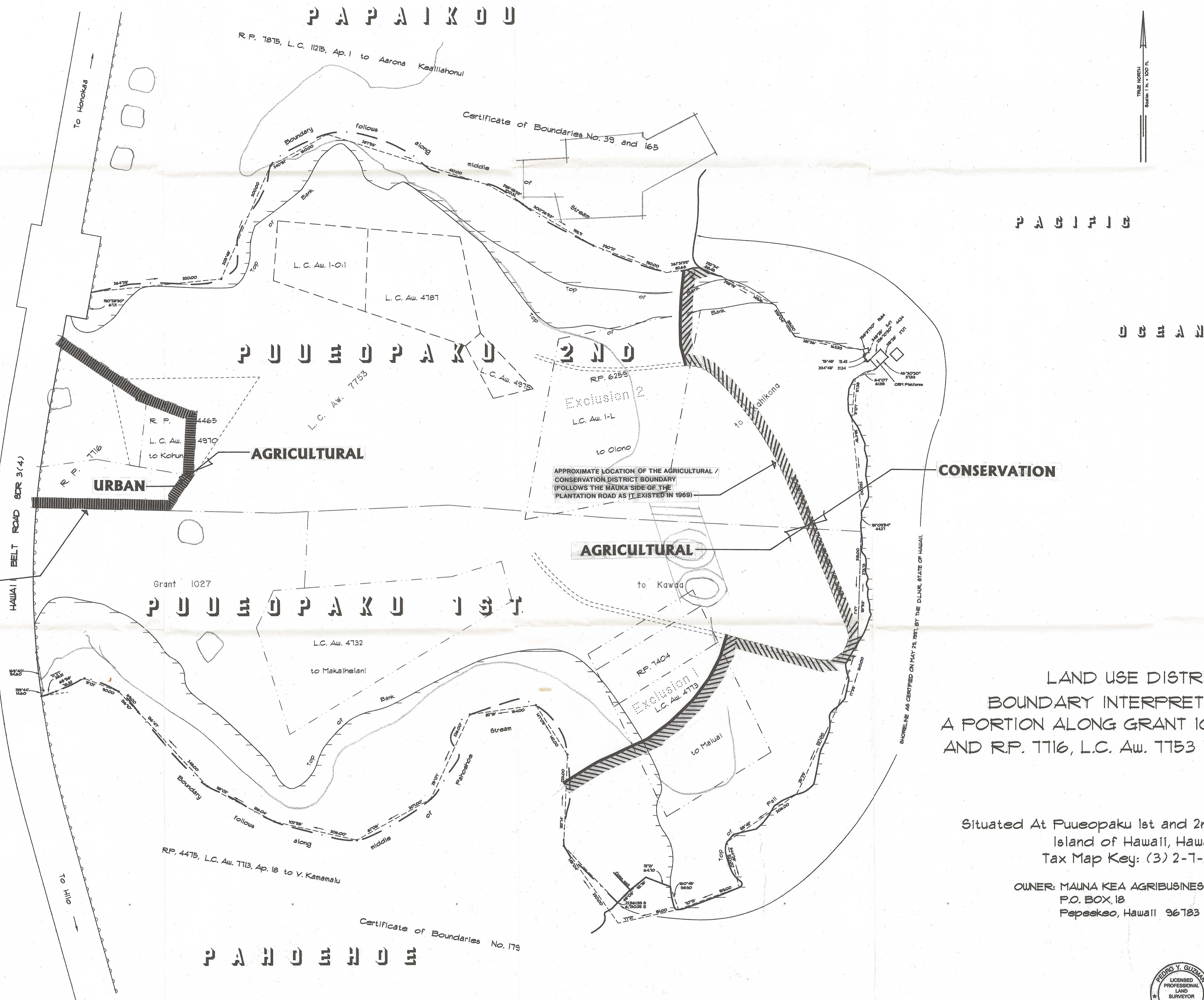

APPROXIMATE LOCATION OF THE URBAN / AGRICULTURAL DISTRICT BOUNDARY (FOLLOWS PROPERTY LINES AS THEY EXISTED IN 1964)

The boundary as located, named and delineated is hereby certified as the actual Land Use District Boundary adopted by the State Land Use Commission, Honolulu, Hawaii.
 APR 01 1998 by [Signature]
 Date Executive Officer

NOTES:
 Azimuths and coordinates are referred to Government Survey Triangulation Station "Alala" A

LAND USE DISTRICT BOUNDARY INTERPRETATION OF A PORTION ALONG GRANT 1027 TO KAWAA AND R.P. 7716, L.C. Aw. 7753 TO KAHIKONA

Situated At Papeopaku 1st and 2nd, South Hilo, Island of Hawaii, Hawaii
 Tax Map Key: (3) 2-7-3:01

OWNER: MAUNA KEA AGRIBUSINESS CO., INC.
 P.O. BOX 18
 Pepeekeo, Hawaii 96783

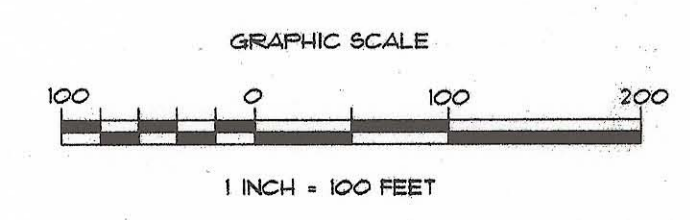

This work was prepared by me or under my direct supervision
 Pedro Y. Guzman
 Licensed Professional Surveyor
 Certificate Number 6863