

BENJAMIN J. CAYETANO
GOVERNOR



ESTHER UEDA
EXECUTIVE OFFICER

STATE OF HAWAII
DEPARTMENT OF BUSINESS, ECONOMIC DEVELOPMENT & TOURISM
LAND USE COMMISSION

P.O. Box 2359
Honolulu, HI 96804-2359
Telephone: 808-587-3822
Fax: 808-587-3827
July 10, 2000

2000 JUL 13 PM 2 37
PLANNING DEPARTMENT
COUNTY OF HAWAII

Ms. Juliette Tulang, Director
Department of Parks and Recreation
County of Hawai'i
25 Aupuni Street, Room 210
Hilo, Hawai'i 96720-4252

Dear Ms. Tulang:

Subject: BOUNDARY INTERPRETATION No.: 00-20 for Tax Map Key No.: 1-4-02: 5, 6, & 61, Ahalanui County Park, Puna, Hawai'i

Pursuant to your May 18, 2000, letter requesting a boundary interpretation for the subject parcel, please be advised that we have determined that the subject parcels, TMK: 1-4-02: 5, 6, & 61, containing approximately 1.36 acres, 1.80 acres, and 2.79 acres, respectively, are designated within the State Land Use Conservation District.

Our determination is based on the Commission's records and official maps currently on file at our office.

A half-sized copy of Tax Map 1-4-02 with the subject parcels highlighted in yellow is enclosed for your reference.

If you have any questions, please call Fred Talon or Bert Saruwatari of my staff at 587-3822.

Sincerely,

ESTHER UEDA
Executive Officer

EU:ft

encl: Tax Map 1-4-02

cc: Timothy E. Johns, BLNR Chairperson (w/encl.)
Attn: Dean Uchida, Land Division
✗ Virginia Goldstein, Hawai'i County Planning Director (w/encl.)
S. Kalani Schutte, Deputy Finance Director (w/encl.)
County of Hawai'i, Real Property Tax Division, Mapping Section

006777

JUN 2 6 1975
JUN 2 9 1977
JUN 2 10 1977
JUN 2 11 1977
JUN 2 12 1977
JUN 2 13 1977
JUN 2 14 1977
JUN 2 15 1977
JUN 2 16 1977
JUN 2 17 1977
JUN 2 18 1977
JUN 2 19 1977
JUN 2 20 1977
JUN 2 21 1977
JUN 2 22 1977
JUN 2 23 1977
JUN 2 24 1977
JUN 2 25 1977
JUN 2 26 1977
JUN 2 27 1977
JUN 2 28 1977
JUN 2 29 1977
JUN 2 30 1977

36 Hashi International, Inc.
41 Clifford T. S. Lee & wife
Jane Ann Buxton-Lee-T/E

Kenneth B. Griffin & wife
Alexa - 1/2 - 1/2
Katherine K. Moanaka - 1/3
James A. Lee & wife Ruth L. - 1/2 - 1/2

7 Graham International, Inc.
49 Ralph E. Allison & wife
Lorna D. - 1/2

61 Maxine M. Carlsmith - 1/2
Curtis H. Carlsmith - 1/2

73 Graham International, Inc.
74 Graham International, Inc.
75 Graham International, Inc.
51 Vacationland Land Trust

29 Thelma L. Hall - 1/2
Larina N. Nakua - 1/2

28 Leonard Campbell

5 & 6 James M. Redges, Inc. - 1/2
Sundown, Inc. - 1/2
Joseph Ash - 1/2
Auto Imports of Hawaii, Inc. - 1/2 - 1/2
50 Roger Schock & wife Antoinette-T/E/A's

LAEPAOO - PUUA, PUNA, HAWAII

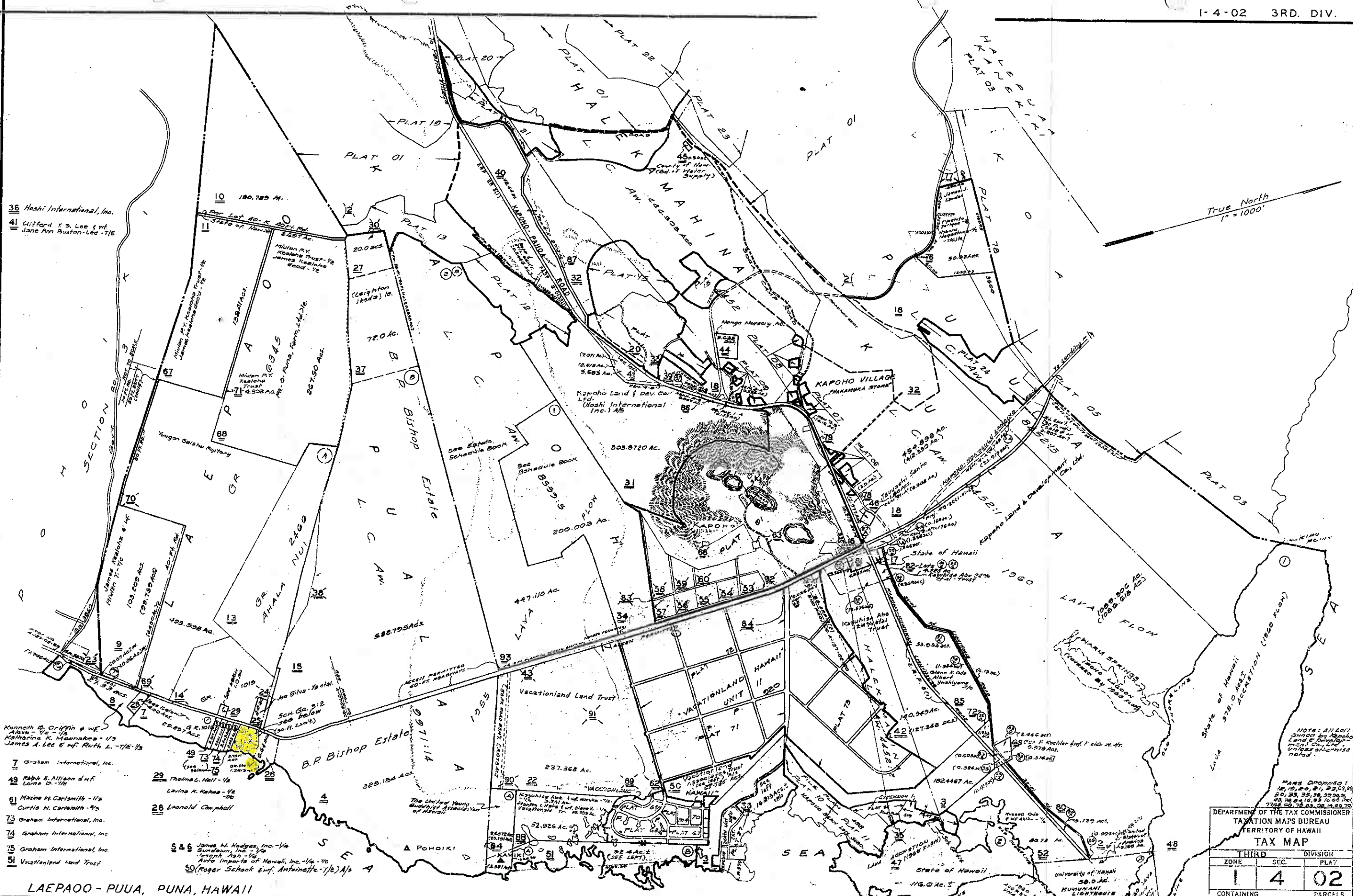

NOTES: All lots owned by Kapoho Land & Dev. Co. Ltd. are shown in yellow. All lots owned by the State of Hawaii are shown in white. All other lots are shown in light blue. All lots are shown with their respective owners and areas. All lots are shown with their respective areas. All lots are shown with their respective areas.

DEPARTMENT OF THE TAX COMMISSIONER
TAXATION MAPS BUREAU
TERRITORY OF HAWAII
TAX MAP

THIRD DIVISION		
ZONE	SEC.	PLAT
1	4	02

CONTAINING PARCELS
SCALE: 1 IN. = 1000 FT.