

RECEIVED

69 JAN 14 PM 12 39

January 13, 1969

PLANNING DEPT.
COUNTY OF HAWAII
FILE NO. 129-24C *Reopening*

Mr. and Mrs. Nischaru Ikeda
P. O. Box 293
Kailakohua
Kona, Hawaii 96750

Dear Mr. and Mrs. Ikeda:

Your petition (A68-198) to amend the land use district boundary from an Agricultural District into an Urban District at Kailakohua, Kona, Hawaii, identifiable by Tax Map Key 7-9-07: 22, was reviewed by the Land Use Commission on January 10, 1969. The Commission voted to approve one acre for reclassification from an Agricultural District into an Urban District as indicated on the attached map.

Very truly yours,

RANON DURAN
Executive Officer

Encl.
cc: Dept. of Taxation
Dept. of Land & Nat. Res.
Hawaii Planning Commission
Richard T. Ichida

ROUTE SLIP	
Date Rec'd:	
Director	<input checked="" type="checkbox"/>
Assistant	<input checked="" type="checkbox"/>
Engineer	<input checked="" type="checkbox"/>
Analyst	
Inspector	
Draftsman	<input checked="" type="checkbox"/>
Secretary	
Sr. Clk-Steno	
Clerk-Steno	
Acct. clerk	
Clerk	

Posted copies 1-22-69
 Remarks: Follow thru
 1) Improv. applicant
 the necessary
 required
 of change maps
 in file

Agnes K. P. Smith - LI
Heirs of Agnes Smith - RDM

14.667 Ac.

William J. Paris

19.609 Ac.

8559-B:7

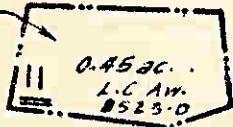

21.8435 Ac.
(20.35 Ac.)

Ethel V. Paris
0.897 acs.
(0.825 acs)

Satoru Omoto & wf. Kimiko - T/E
2.75 acs.

N Hisaharu Ikeda & wf. Kimiko S. - T/E
2.95 Ac.

L.C. No. 10138

L.C. No. 5561-BB:1

N

0

40-Ft. Rdwy Esm't in favor of M.A. Schattauer (7-9-07:14)

Masayuki Fujino & wf. Haruno T/E

Isamu Oshima

Margaret A. Schattauer

Ichi Nakamoto
Minoru Nakamoto
Junichi Nakamoto
George Nakamoto - J/T
9903#

TMK 7-9-07:2 (part)

1" = 200'

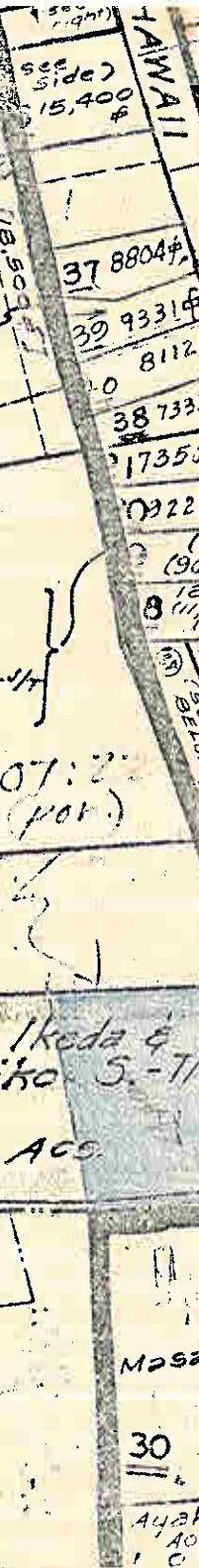

HAWAII BELT

- 37 8804#
- 39 9331#
- 0 8112#
- 38 7335#
- 17356#
- 0 2226#
- (212#)
- (9691#)
- 8 12,210#
- (11,720#)
- (14,000#)
- (14,000#)
- (14,000#)
- 17 (14,000#)
- 12,786#
- 57
- 5 Thomas A. Kobayashi D. CT. APP. 1908 30,415#
- see Side)
- 0.945 ac.
- 6
- 65 6,818#
- 75,055#
- 66
- Masami Iwasaki
- 30
- Ayako I. Aoki
- William Raposa & wf. Virginia M. 53 - 0.49 ac.

William J. Hooper, Jr.
KONA EXECUTIVE EXPERIMENT
Exec. Ord. No. 1814

KONA

KONA EXECUTIVE EXPERIMENT

10

9

19

35

34

36

16

5

see Side)

0

6

65

75,055#

66

30

10

21

19

35

34

36

16

5

see Side)

0

6

65

75,055#

66

30

10

21

19

35

34

36

16

5

see Side)

0

6

65

75,055#

66

30

10

21

19

35

34

36

16

5

see Side)

0

6

65

75,055#

66

30

10

21

19

35

34

36

16

5

see Side)

0

6

65

75,055#

66

30

10

21

19

35

34

36

16

5

see Side)

0

6

65

75,055#

66

30

10

21

19

35

34

36

16

5

see Side)

0

6

65

75,055#

66

30

10

21

19

35

34

36

16

5

see Side)

0

6

65

75,055#

66

30

10

21

19

35

34

36

16

5

see Side)

0

6

65

75,055#

66

30

10

21

19

35

34

36

16

5

see Side)

0

6

65

75,055#

66

30

10

21

19

35

34

36

16

5

see Side)

0

6

65

75,055#

66

30

Arao Matsum

Hisashi Fukuhara & wf. Mitsue - T/E 4438#

Various owners see TMB 5391

Motoji Kaneo & Fujiyo - T/E

7.25 acs.

(3.175 acs)

Frank Thompson & wf. Leilani - T/E 2.04 acs.

Fumie Inaba - LI Jeanette M., Mae S. & Annette F. Inaba - 2.023 ac.

Tamotsu Kadooka & wf. Kikuyo - T/E

Sunao Kadooka

4.909 Ac.

L.C. No. 5561:2