

COUNTY OF HAWAII STATE OF HAWAII

Bill No. 486

ORDINANCE NO. 88 116

AN ORDINANCE AMENDING THE STATE LAND USE BOUNDARIES MAP, H-7 FOR THE COUNTY OF HAWAII, BY CHANGING THE DISTRICT CLASSIFICATION FROM THE AGRICULTURAL TO THE URBAN DISTRICT AT KALAOA 4TH, NORTH KONA, HAWAII, COVERED BY TAX MAP KEY 7-3-05:87.

BE IT ORDAINED BY THE COUNCIL OF THE COUNTY OF HAWAII:

SECTION 1. The State Land Use Boundaries Map, H-7 for the County of Hawaii, is amended to change the district classification of property described hereinafter as follows:

The district classification of the following area situated at Kalaoa 4th, North Kona, Hawaii, shall be Urban:

Beginning at the southeast corner of this parcel of land, being also the northeast corner of Lot 147, Kona Palisade, Unit I (File Plan 1061), the coordinates of said point of beginning referred to Government Survey Triangulation Station "MOANUIAHEA" being 7,113.32 feet South and 10,820.04 feet West, thence running by azimuths measured clockwise from True South:

- 1. 100° 37' 30" 129.58 feet along a portion of Lot 147, Kona Palisade, Unit I (File Plan 1061);
- 2. 98° 56' 262.00 feet along a portion of Lot 147, Lot 140, Lot 139 and a portion of Lot 138, Kona Palisade, Unit I (File Plan 1061);
- 3. 87° 55' 30" 574.00 feet along a portion of Lot 138, Lot 131, Lot 130 and a portion of Lot 124, Kona Palisade, Unit I (File Plan 1061):

4. 95° 55' 219.71 feet along a portion of Lot 124, Lot 123 and Lot 119, Kona Palisade, Unit I (File Plan 1061);
5. 194° 30' 265.16 feet along the remainder of Grant 1607 to Nawahie (Lot 7, 50-Foot Road);
6. 276° 38' 46" 1,142.51 feet along the remainder of Grant 1607 to Nawahie (portion of Parcel B);
7. 6° 50' 192.29 feet along the remainder of Grant 1607 to Nawahie (Lot 6, 50-Foot Road) to the point of beginning and containing an area of 5.655 Acres.

All as shown on the map attached hereto, marked Exhibit "A" and by reference made a part hereof.

SECTION 2. In the event that any portion of this ordinance is declared invalid, such invalidity shall not affect the other parts of this ordinance.

SECTION 3. This ordinance shall take effect upon its approval.

INTRODUCED BY:

*Joseph A. Drury*

\_\_\_\_\_  
COUNCIL MEMBER, COUNTY OF HAWAII

Hilo, Hawaii

Date of Introduction: February 17, 1988  
 Date of 1st Reading: February 17, 1988  
 Date of 2nd Reading: August 3, 1988  
 Effective Date: August 17, 1988

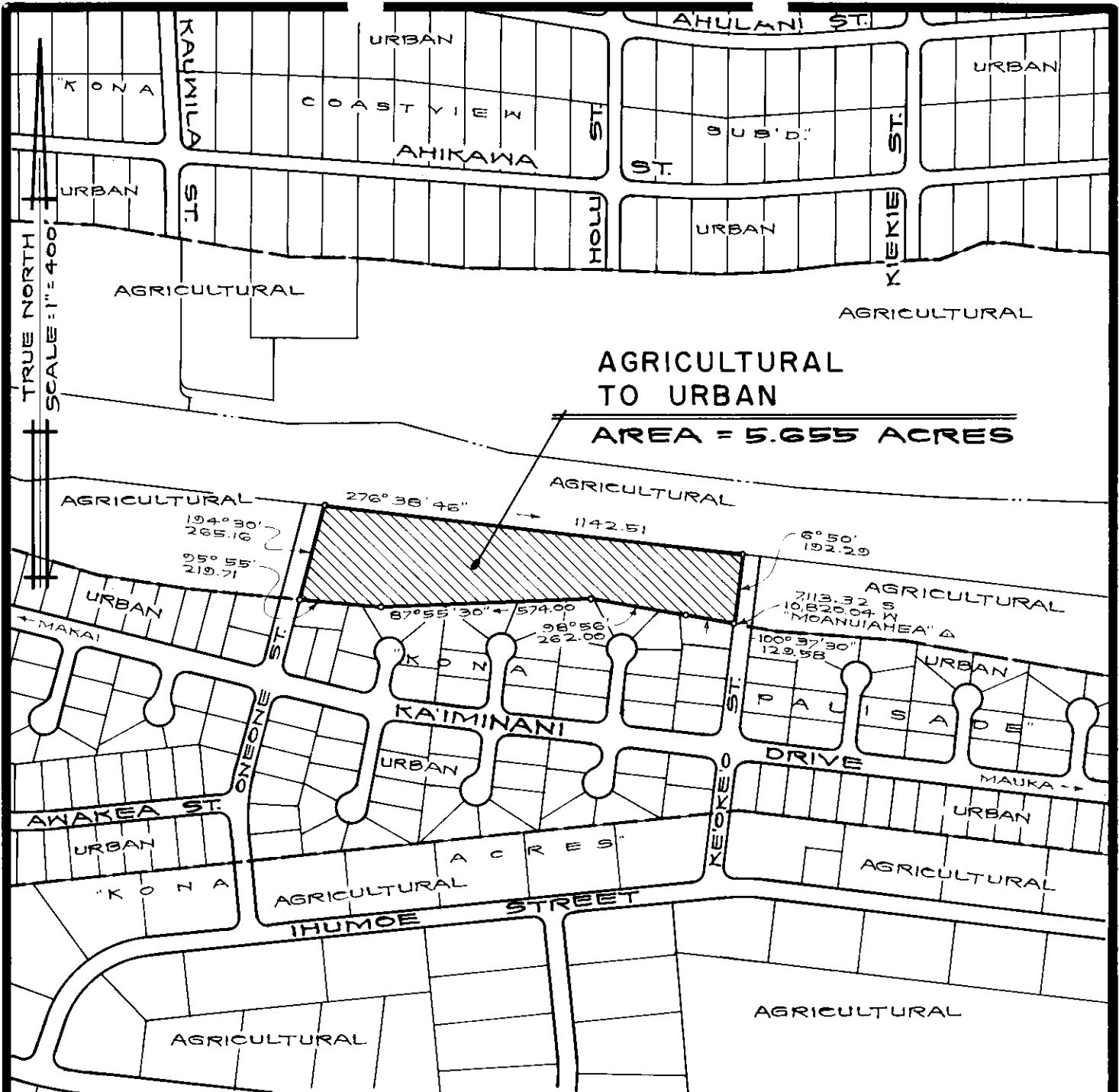

**AMENDMENT TO THE STATE LAND USE**  
**BOUNDARIES MAP**

AMENDING THE STATE LAND USE BOUNDARIES MAP, H-7 FOR THE COUNTY OF HAWAII, BY CHANGING THE DISTRICT CLASSIFICATION FROM THE AGRICULTURAL TO THE URBAN DISTRICT AT KALAOA 4TH, NORTH KONA, HAWAII.

PREPARED BY: PLANNING DEPARTMENT  
COUNTY OF HAWAII

TMK: 7-3-05: 87

NOV. 30, 1987