

# COUNTY OF HAWAII STATE OF HAWAII



Bill No. 646

## ORDINANCE NO. 88 164

AN ORDINANCE AMENDING THE STATE LAND USE BOUNDARIES MAP, H-66 FOR THE COUNTY OF HAWAII, BY CHANGING THE DISTRICT CLASSIFICATION FROM AGRICULTURAL TO THE URBAN DISTRICT AT WAIAKEA, SOUTH HILO, HAWAII COVERED BY TAX MAP KEY 2-4-65:2 (PORTION).

BE IT ORDAINED BY THE COUNCIL OF THE COUNTY OF HAWAII:

SECTION 1. The State Land Use Boundaries Map, H-66 for the County of Hawaii is amended to change the district classification of property described hereinafter as follows:

The district classification of the following area situated at Waiakea, South Hilo, Hawaii, shall be Urban:

Beginning at the northeast corner of this portion of land, being also the northwest corner of Lot 4, the coordinates of said point of beginning referred to Government Survey Triangulation Station "HALAI", being 14,490.80 feet South and 4,301.66 feet West, thence running by azimuths measured clockwise from True South:

1. 355° 40' 642.31 feet along the remainder of Grant 9460 to Henrietta D. Holt (Lot 4);
2. 85° 40' 931.89 feet along the remainder of Grant 9460 to Henrietta D. Holt (remainder of Lot 5);
3. 175° 40' 642.31 feet along Government Land (Lot 820, Waiakea Homesteads, Second Series);
4. 265° 40' 931.89 feet along Government Land to the point of beginning and containing an area of 13.741 Acres.

All as shown on the map attached hereto, marked Exhibit "A" and by reference made a part hereof.

SECTION 2. In the event that any portion of the ordinance is declared invalid, such invalidity shall not affect the other parts of this ordinance.

SECTION 3. This ordinance shall take effect upon its approval.

INTRODUCED BY:

  
COUNCIL MEMBER, COUNTY OF HAWAII

Hilo, Hawaii

Date of Introduction: October 19, 1988  
Date of 1st Reading: October 19, 1988  
Date of 2nd Reading: November 2, 1988  
Effective Date: November 7, 1988

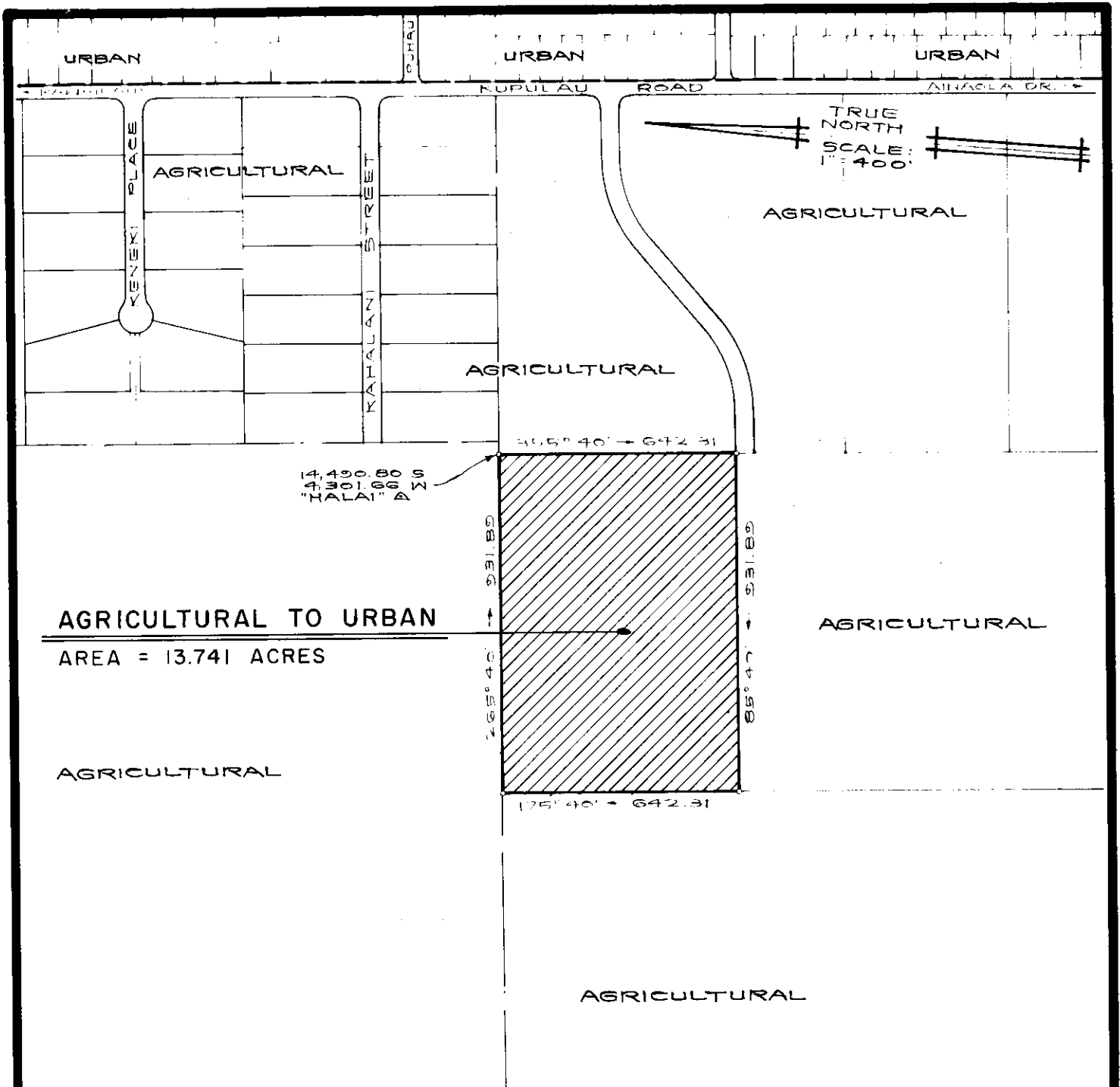

## AMENDMENT TO THE STATE LAND USE BOUNDARIES MAP

AMENDING THE STATE LAND USE BOUNDARIES MAP, H-66 FOR THE COUNTY OF HAWAII, BY CHANGING THE DISTRICT CLASSIFICATION FROM THE AGRICULTURAL TO THE URBAN DISTRICT AT WAIAKEA, SOUTH HILO, HAWAII.

PREPARED BY : PLANNING DEPARTMENT  
COUNTY OF HAWAII

TMK: 2-4-65: POR. 2

SEPT. 11, 1988

EXHIBIT "A"