

COUNTY OF HAWAII STATE OF HAWAII



Bill No. 38

ORDINANCE NO. 89 45

AN ORDINANCE AMENDING THE STATE LAND USE BOUNDARIES MAP, H-65 FOR THE COUNTY OF HAWAII, BY CHANGING THE DISTRICT CLASSIFICATION FROM THE URBAN TO THE AGRICULTURAL DISTRICT AND FROM THE AGRICULTURAL TO THE URBAN DISTRICT AT KULAIMANO HOMESTEADS, SOUTH HILO, HAWAII, COVERED BY TAX MAP KEY 2-8-06:13 (PORTION).

BE IT ORDAINED BY THE COUNCIL OF THE COUNTY OF HAWAII:

SECTION 1. The State Land Use Boundaries Map, H-65 for the County of Hawaii, is amended to change the district classification of properties described hereinafter as follows:

The district classification of the following area situated at Kulaimano Homesteads, South Hilo, Hawaii, shall be Agricultural:

Parcel 1

Beginning at the West corner of this parcel of land, the coordinates of said point of beginning referred to Government Survey Triangulation Station "ALALA" being 1,784.14 feet South and 4,682.35 feet East, thence running by azimuths measured clockwise from True South:

- 1. 244° 51' 60.00 feet along the remainder of Grant 7062 to M. S. Cordeiro;
2. 341° 48' 105.37 feet along the remainder of Grant 7062 to M. S. Cordeiro;
3. Thence along the remainder of Grant 7062 to M. S. Cordeiro, on a curve to the right with a radius of 150.00 feet, the chord azimuth and distance being: 1° 59' 103.51 feet;
4. 154° 48' 51.71 feet along the remainder of Grant 7062 to M. S. Cordeiro;

5. 154° 51' 145.00 feet along the Satellite Training Site, along the remainder of Grant 7062 to M. S. Cordeiro to the point of beginning and containing an Area of 0.193 Acre, more or less. (Refer to Parcel 1 as shown on Exhibit "A").

The district classification of the following area situated at Kulaimano Homesteads, South Hilo, Hawaii, shall be Urban:

Parcel 2

Beginning at the Southeast corner of this parcel of land, on the North side of Homestead Road, the coordinates of said point of beginning referred to Government Survey Triangulation Station "ALALA" being 2,138.62 feet South and 4,849.02 feet East, thence running by azimuths measured clockwise from True South:

1. 93° 05' 17.33 feet along the North side of Homestead Road;
2. 80° 05' 150.00 feet along the North side of Homestead Road;
3. 202° 10' 217.41 feet along the remainder of Grant 7062 to M. S. Cordeiro;
4. 334° 48' 195.00 feet along the remainder of Grant 7062 to M. S. Cordeiro to the point of beginning and containing an Area of 0.351 Acre, more or less. (Refer to Parcel 2 as shown on Exhibit "A").

All as shown on the map attached hereto, marked Exhibit "A" and by reference made a part hereof.

SECTION 2. In the event that any portion of this ordinance is declared invalid, such invalidity shall not affect the other parts of this ordinance.

SECTION 3. This ordinance shall take effect upon its approval.

INTRODUCED BY:

Jepchi Amwing
COUNCIL MEMBER, COUNTY OF HAWAII

Hilo, Hawaii

Date of Introduction: March 1, 1989
Date of 1st Reading: March 1, 1989
Date of 2nd Reading: March 15, 1989
Effective Date: March 21, 1989

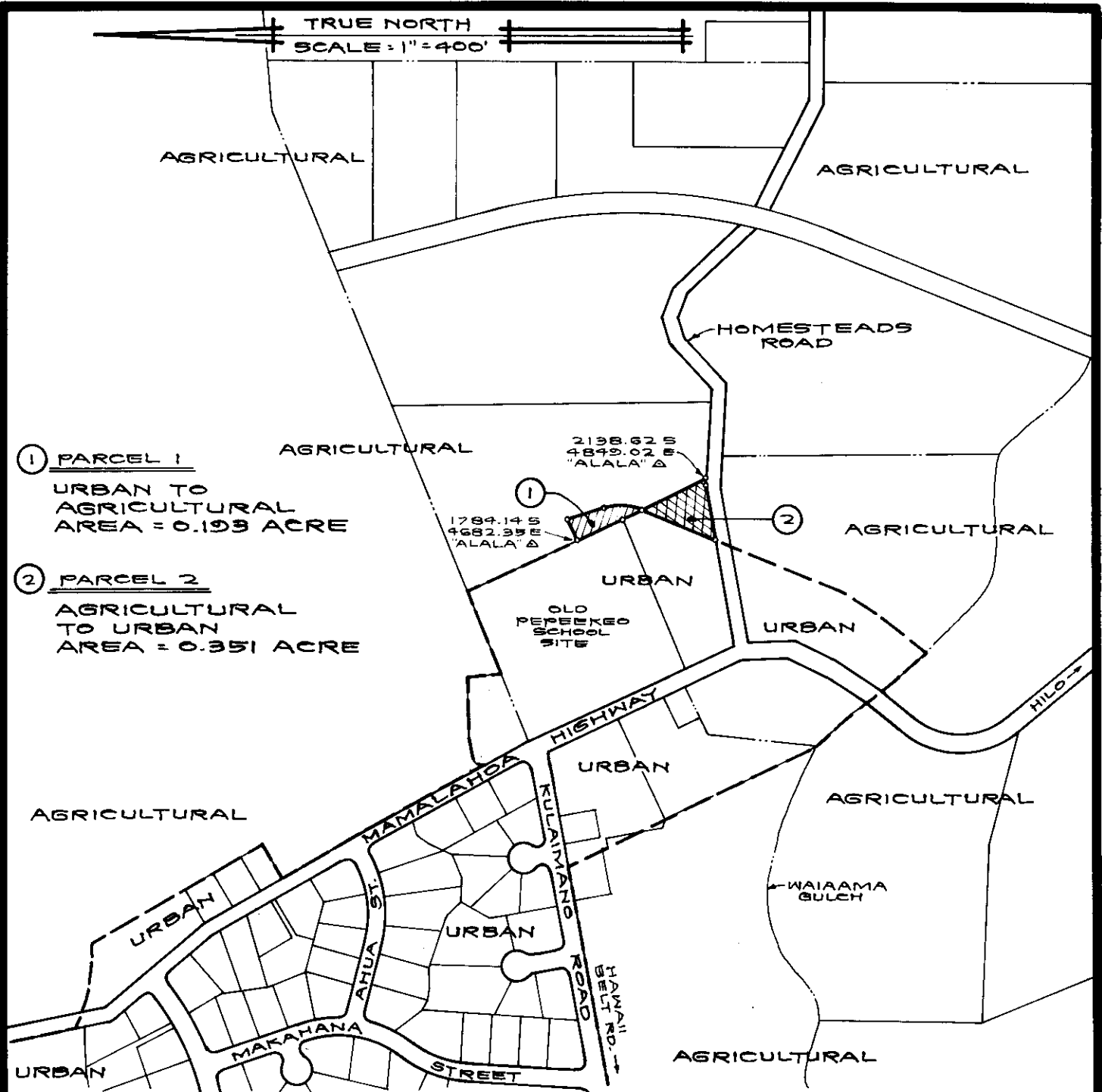

- ① PARCEL 1
 URBAN TO AGRICULTURAL
 AREA = 0.193 ACRE
- ② PARCEL 2
 AGRICULTURAL TO URBAN
 AREA = 0.351 ACRE

AMENDMENT TO THE STATE LAND USE BOUNDARIES MAP

AMENDING THE STATE LAND USE BOUNDARIES MAP, H-65 FOR THE COUNTY OF HAWAII, BY CHANGING THE DISTRICT CLASSIFICATION FROM THE URBAN TO THE AGRICULTURAL DISTRICT AND FROM THE AGRICULTURAL TO THE URBAN DISTRICT AT KULAIMANO HOMESTEADS, SOUTH HILO, HAWAII.

PREPARED BY : PLANNING DEPARTMENT
 COUNTY OF HAWAII

TMK: 2-8-06: 13 (PORTION)

JAN. 12, 1989