

COUNTY OF HAWAII STATE OF HAWAII

Bill No. 66

ORDINANCE NO. 89 123

AN ORDINANCE AMENDING THE STATE LAND USE BOUNDARIES MAP, H-8 FOR THE COUNTY OF HAWAII, BY CHANGING THE DISTRICT CLASSIFICATION FROM THE AGRICULTURAL TO THE URBAN DISTRICT AT HOLUALOA 1ST, NORTH KONA, HAWAII, COVERED BY TAX MAP KEY 7-6-24:31.

BE IT ORDAINED BY THE COUNCIL OF THE COUNTY OF HAWAII:

SECTION 1. The State Land Use Boundaries Map, H-8 for the County of Hawaii, is amended to change the district classification of property described hereinafter as follows:

The district classification of the following area situated at Holualoa 1st, North Kona, Hawaii, shall be Urban:

Beginning at the Westernmost corner of this parcel of land, being also a point on the Northerly side of Kuakini Highway, the coordinates of said point of beginning referred to Government Survey Triangulation Station "KAILUA (NORTH MERIDIAN)" being 9,139.88 feet South and 7,580.43 feet East and running by azimuths measured clockwise from True South:

1. 233° 00' 30" 244.41 feet along stonewall and along the remainder of Royal Patent 4475, Land Commission Award 7713, Apana 43 to V. Kamamalu to a spike;

Thence, for the next five (5) courses following along stonewall and along the Southerly side of the Kailua-Keauhou Middle Road:

2. 284° 32' 30" 148.26 feet to a spike;
3. 279° 43' 30" 25.40 feet to a spike;

- 4. 288° 56' 30" 64.02 feet to a 1/2 inch pipe;
- 5. 284° 25' 30" 89.83 feet to a 1/2 inch pipe;
- 6. 289° 01' 27.73 feet to a 1/2 inch pipe;
- 7. 33° 20' 307.91 feet along Lot 4 and along the remainder of Royal Patent 4475, Land Commission Award 7713, Apana 43, to V. Kamamalu to a 1/2 inch pipe;

Thence, following along stonewall and along the Northerly side of Kuakini Highway on a curve to the left with a radius of 4,623.66 feet, the chord azimuth and distance being:

- 8. 118° 58' 09.28" 421.01 feet to the point of beginning and containing an area of 2.252 Acres.

All as shown on the map attached hereon, marked Exhibit "A" and by reference made a part hereof.

SECTION 2. In the event that any portion of this ordinance is declared invalid, such invalidity shall not affect the other parts of this ordinance.

SECTION 3. This ordinance shall take effect upon its approval.

INTRODUCED BY:

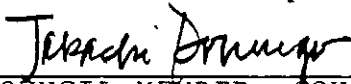
 COUNCIL MEMBER, COUNTY OF HAWAII

Hilo, Hawaii

Date of Introduction: August 16, 1989
 Date of 1st Reading: August 16, 1989
 Date of 2nd Reading: September 6, 1989
 Effective Date: September 11, 1989

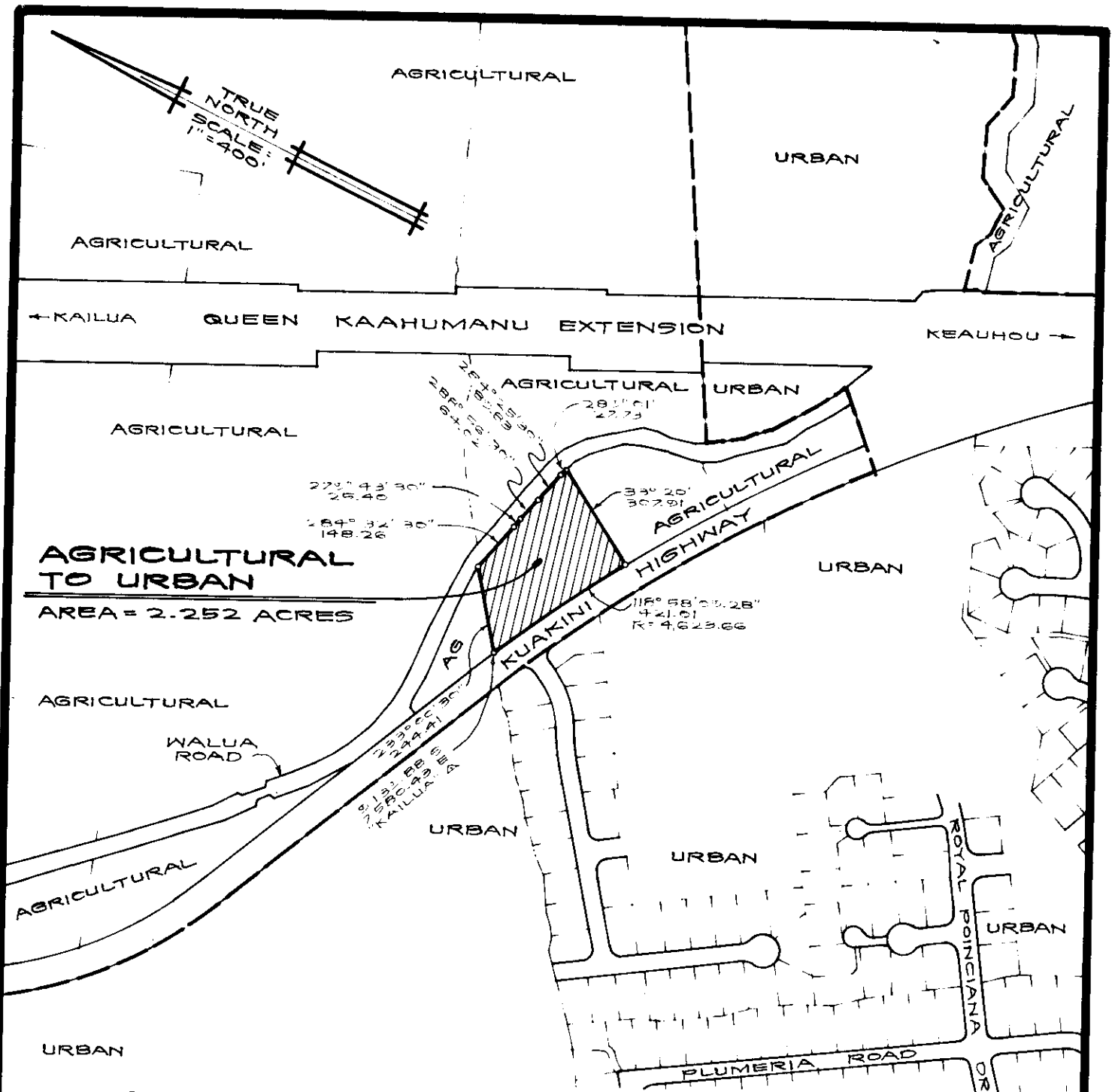

AMENDMENT TO THE STATE LAND USE
BOUNDARIES MAP

AMENDING THE STATE LAND USE BOUNDARIES MAP, H-8 FOR THE COUNTY OF HAWAII, BY CHANGING THE DISTRICT CLASSIFICATION FROM THE AGRICULTURAL TO THE URBAN DISTRICT AT HOLUALOA 1ST, NORTH KONA, HAWAII.

PREPARED BY: PLANNING DEPARTMENT
 COUNTY OF HAWAII

TMK: 7-6-24: 31

NOV. 23, 1988

EXHIBIT "A"