

MAIL ST.

BILL NO. 22

ORDINANCE NO. 95 34

AN ORDINANCE AMENDING THE STATE LAND USE BOUNDARIES MAP, H-25 FOR THE COUNTY OF HAWAII, BY CHANGING THE DISTRICT CLASSIFICATION FROM THE AGRICULTURAL TO THE URBAN DISTRICT AT WAIAKA 1 AND WAIAKA 2, WAIMEA, SOUTH KOHALA, HAWAII, COVERED BY TAX MAP KEY 6-5-01:PORTION OF 33.

BE IT ORDAINED BY THE COUNCIL OF THE COUNTY OF HAWAII:

SECTION 1. The State Land Use Boundaries Map, H-25 for the County of Hawaii, is amended to change the district classification of property described hereinafter as follows:

The district classification of the following area situated at Waiaka 1 and Waiaka 2, Waimea, South Kohala, Hawaii, shall be Urban:

Beginning at the north corner of this parcel of land, the coordinates of said point of beginning referred to Government Survey Triangulation Station "PUU PA" being 15,076.05 feet north and 2,734.62 feet east, thence running by azimuths measured clockwise from True South:

- | | | | |
|----|------|-----|--|
| 1. | 292° | 23' | 912.65 feet along the remainders
of R.P. 1668, L.C.
Aw. 8520-B to Lahilahi and
Grant 662 to Kamaikui; |
| 2. | 314° | 00' | 149.13 feet along the remainder
of Grant 662 to Kamaikui; |
| 3. | 27° | 40' | 557.63 feet along the remainder
of Grant 662 to Kamaikui; |

4. 99° 14' 804.93 feet along the remainders
of Grant 662 to Kamaikui
and R.P. 1668, L.C.
Aw. 8520-B to Lahilahi;
5. 187° 09' 822.21 feet along Grant S-14462
to Hawaii Preparatory
Academy to the point of
beginning and containing
an area of 14.900 acres.

All as shown on the map attached hereto, marked
Exhibit "A" and by reference made a part hereof.

SECTION 2. In the event that any portion of the ordinance
is declared invalid, such invalidity shall not affect the other
parts of this ordinance.

SECTION 3. This ordinance shall take effect upon its
approval.

INTRODUCED BY:



COUNCIL MEMBER, COUNTY OF HAWAII

Hilo, Hawaii

Date of Introduction: February 15, 1995
Date of 1st Reading: February 15, 1995
Date of 2nd Reading: March 1, 1995
Effective Date: March 7, 1995

APPROVED AS TO FORM AND LEGALITY:

DEPUTY CORPORATION COUNSEL

DATED: MAR - 6 1995

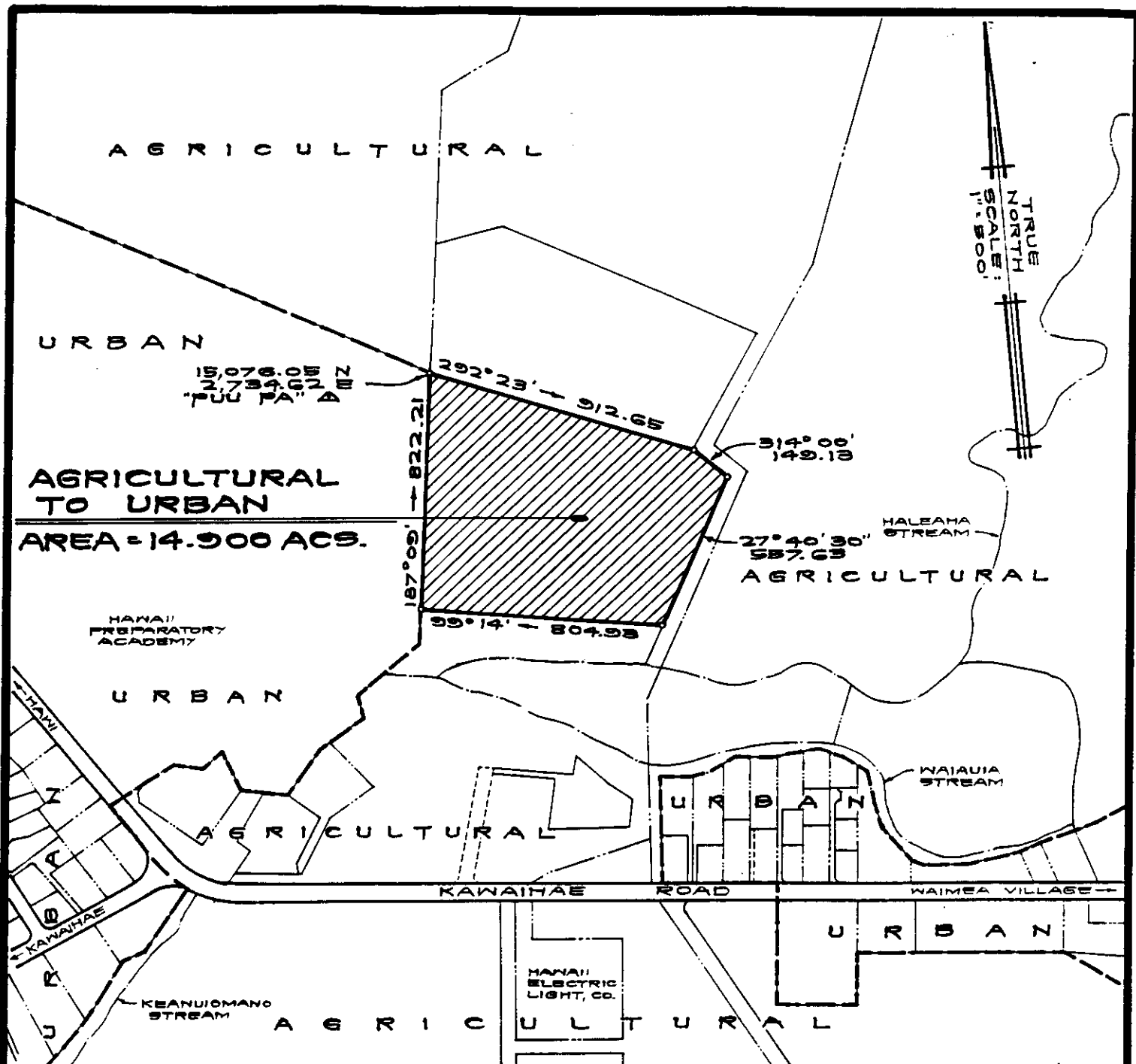

AMENDMENT TO THE STATE LAND USE BOUNDARIES MAP

AMENDING THE STATE LAND USE BOUNDARIES MAP, H-25 FOR THE COUNTY OF HAWAII BY CHANGING THE DISTRICT CLASSIFICATION FROM THE AGRICULTURAL TO THE URBAN DISTRICT AT WAIKA 1 AND WAIKA 2, WAIMEA, SOUTH KOHALA, HAWAII.

PREPARED BY : PLANNING DEPARTMENT
COUNTY OF HAWAII

TMK : 6-5-01 : PORTION OF 33

OCT. 7, 1994

EXHIBIT "A"

(HAWAII PREPARATORY ACADEMY)

OFFICE OF THE COUNTY CLERK

County of Hawaii

Hilo, Hawaii

1995 MAR 7 PM 3 49

Introduced By: Keola Childs
 Date Introduced: February 15, 1995
 First Reading: February 15, 1995
 Published: N/A

REMARKS:

ROLL CALL VOTE				
	AYES	NOES	ABS	EX
Arakaki	X			
Bonk-Abramson	X			
Childs	X			
De Lima	X			
Domingo	X			
Osorio	X			
Rath	X			
Ray	X			
Smith	X			
	9	0	0	0

Second Reading: March 1, 1995
 To Mayor: March 2, 1995
 Returned: March 7, 1995
 Effective: March 7, 1995
 Published: March 15, 1995

REMARKS:

ROLL CALL VOTE				
	AYES	NOES	ABS	EX
Arakaki	X			
Bonk-Abramson	X			
Childs	X			
De Lima	X			
Domingo			X	
Osorio	X			
Rath	X			
Ray	X			
Smith	X			
	8	0	1	0

I DO HEREBY CERTIFY that the foregoing BILL was adopted by the County Council and published as indicated above.

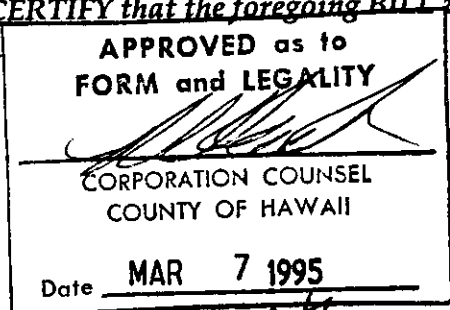

Shay L. Osorio
 COUNCIL CHAIRMAN
Patricia B. Engelhard
 COUNTY CLERK

Approved / Disapproved this 7th day
 of March, 19 95

John A. G. G. G.
 MAYOR, COUNTY OF HAWAII

Bill No.: 22
 Reference: C-141/PC-22
 Ord. No.: 95 34