

COUNTY OF HAWAII STATE OF HAWAII

BILL NO. 198

ORDINANCE NO. 96 36

AN ORDINANCE AMENDING THE STATE LAND USE BOUNDARIES MAP, H-7 FOR THE COUNTY OF HAWAII, BY CHANGING THE DISTRICT CLASSIFICATION FROM THE AGRICULTURAL TO THE URBAN DISTRICT AT KALAOA 1ST AND 2ND, NORTH KONA, HAWAII, COVERED BY TAX MAP KEY 7-3-11:43.

BE IT ORDAINED BY THE COUNCIL OF THE COUNTY OF HAWAII:

SECTION 1. The State Land Use Boundaries Map, H-7 for the County of Hawaii, is amended to change the district classification of property described hereinafter as follows:

The district classification of the following area situated at Kalaoa 1st and 2nd, North Kona, Hawaii, shall be Urban:

Beginning at the Southeasterly corner of this parcel of land, being also a point on the Northerly side of Mahilani Drive, said point of beginning bearing 88° 25' 55.63 feet from the Northeasterly corner of Mahilani Drive, the coordinates of said point of beginning referred to Government Survey Triangulation Station "MOANUIAHEA", being 4,156.56 feet South and 8,854.31 feet West and running by azimuths measured clockwise from True South:

1. 88° 25' 140.00 feet along the Northerly side of Mahilani Drive to a point;
2. 178° 25' 456.90 feet along Lots A-25, A-26, A-27, A-28 and A-29 of Kona Highlands, Section-A (File Plan 688), along Lot A-30A of Kona Highlands, Section-A and along the remainder of Grant 3027 to Heueu to a point;
3. 268° 47' 08" 203.44 feet along Lot 3-A and along Grant 4123 to D. W. Haiha to a point;

Thence, following along the Westerly side of Hawaii Belt Road (F.A.P. No. F-10 (5)) on a curve to the left with a radius of 5,769.58 feet, the chord azimuth and distance being:

4. 359° 23' 55" 455.65 feet to a point;
5. 88° 25' 55.63 feet along the Northerly side of Mahilani Drive to the point of beginning and containing an area of 2.059 Acres.

All as shown on the map attached hereto, marked Exhibit "A" and by reference made a part hereof.

SECTION 2. In the event that any portion of this ordinance is declared invalid, such invalidity shall not affect the other parts of this ordinance.

SECTION 3. This ordinance shall take effect upon its approval.

INTRODUCED BY:



COUNCIL MEMBER, COUNTY OF HAWAII

Hilo, Hawaii

Date of Introduction: March 7, 1996
Date of 1st Reading: March 7, 1996
Date of 2nd Reading: March 20, 1996
Effective Date: April 8, 1996

REFERENCE: Comm. 921

APPROVED AS TO FORM AND LEGALITY:

DEPUTY Patricia K. O'Neil
CORPORATION COUNSEL

DATE: MAR 25 1996

TRUE NORTH
Scale: 1" = 300'

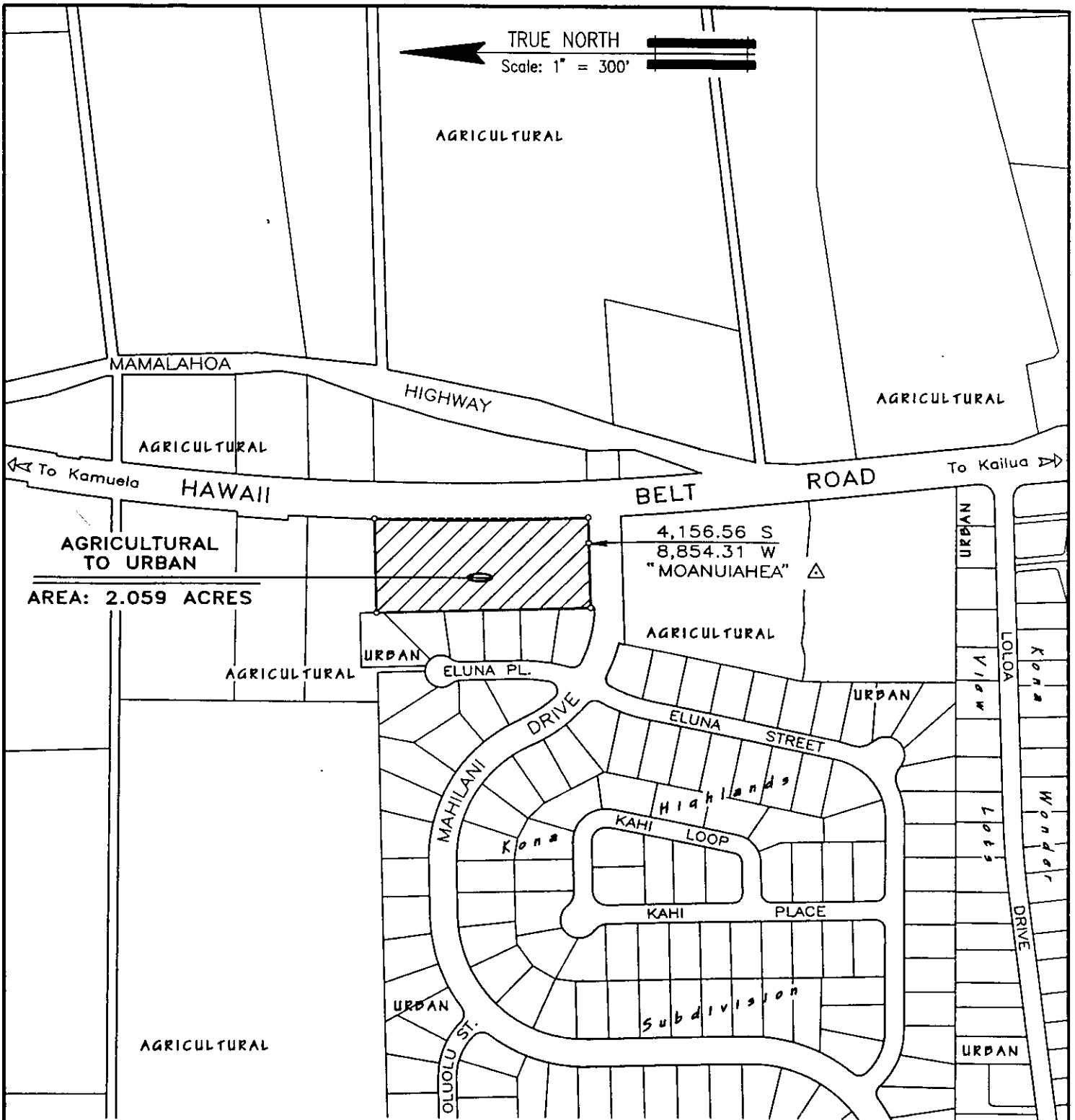

AMENDMENT TO THE STATE LAND USE BOUNDARIES MAP

AMENDING THE STATE LAND USE BOUNDARIES MAP, H-7, FOR THE COUNTY OF HAWAII, BY CHANGING THE DISTRICT CLASSIFICATION FROM THE AGRICULTURAL TO THE URBAN DISTRICT AT KALAOA 1st & 2nd, NORTH KONA, HAWAII.

PREPARED BY : PLANNING DEPARTMENT
COUNTY OF HAWAII



OFFICE OF THE COUNTY CLERK

County of Hawaii

Hilo, Hawaii

96 APR 8 AM 11 18

Introduced By: Takashi Domingo
 Date Introduced: March 7, 1996
 First Reading: March 7, 1996
 Published: N/A

REMARKS:

ROLL CALL VOTE				
	AYES	NOES	ABS	EX
Arakaki	X			
Bonk-Abramson	X			
Childs	X			
De Lima	X			
Domingo			X	
Osorio	X			
Rath	X			
Ray	X			
Smith	X			
	8	0	1	0

Second Reading: March 20, 1996
 To Mayor: March 21, 1996
 Returned: April 8, 1996
 Effective: April 8, 1996
 Published: April 15, 1996

REMARKS:

ROLL CALL VOTE				
	AYES	NOES	ABS	EX
Arakaki	X			
Bonk-Abramson	X			
Childs	X			
De Lima	X			
Domingo	X			
Osorio	X			
Rath	X			
Ray	X			
Smith	X			
	9	0	0	0

I DO HEREBY CERTIFY that the foregoing BILL was adopted by the County Council and published as indicated above.

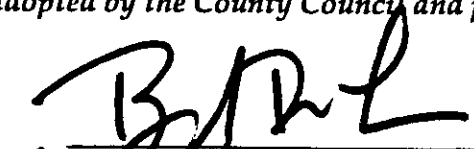

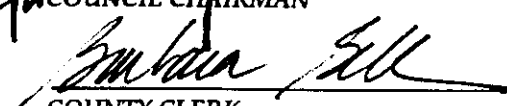
 COUNCIL CHAIRMAN

 COUNTY CLERK

Approved/Disapproved this 8 day
 of April, 1996.



 MAYOR, COUNTY OF HAWAII

Bill No.: 198
 Reference: C-921/PC-106
 Ord. No.: 96 36