

COUNTY OF HAWAII STATE OF HAWAII

BILL NO. 165

ORDINANCE NO. 98 7

AN ORDINANCE AMENDING THE STATE LAND USE BOUNDARIES MAP, H-7 FOR THE COUNTY OF HAWAII, BY CHANGING THE DISTRICT CLASSIFICATION FROM THE AGRICULTURAL TO THE RURAL DISTRICT AT HONOKOHAU 2ND, NORTH KONA, HAWAII, COVERED BY TAX MAP KEY 7-4-06:38.

BE IT ORDAINED BY THE COUNCIL OF THE COUNTY OF HAWAII:

SECTION 1. The State Land Use Boundaries Map, H-7 for the County of Hawaii, is amended to change the district classification of property described hereinafter as follows:

The district classification of the following area situated at Honokohau 2nd, North Kona, Hawaii, shall be Rural:

Beginning at the Northwesterly corner of this parcel of land, being also an angle point on the Easterly side of Palani Road, the coordinates of said point of beginning referred to Hawaiian Plane Coordinate System, Zone I, being 309,553.68 feet North and 335,638.41 feet East and running by azimuths measured clockwise from True South:

1. 262° 14' 15" 388.09 feet along the Southeasterly side of Palani Road and along the Southerly boundary of Royal Patent 7587, Land Commission Award 11216, Apana 36 to M. Kekauonohi to a point;

2. 271° 36' 20" 109.18 feet along the remainder of Land Commission Award 9971, Apana 9 to W. P. Leleiohoku to a point;

3. 349° 38' 486.76 feet along Lot 1 and along the remainder of Land Commission Award 9971, Apana 9 to W. P. Leleiohoku to a point;

- | | | | |
|----|-------------|--------|--|
| 4. | 67° 40' 36" | 205.53 | feet along Lot 2 and along the remainder of Land Commission Award 9971, Apana 9 to W. P. Leleiohoku to a point; |
| 5. | 132° 35' | 599.76 | feet along Lots 2 and 4 and along the remainder of Land Commission Award 9971, Apana 9 to W. P. Leleiohoku to a point; |
| 6. | 222° 35' | 25.00 | feet along Lot 6 and along the remainder of Land Commission Award 9971, Apana 9 to W. P. Leleiohoku to a point; |
| 7. | 132° 35' | 0.36 | feet along Lot 6 and along the remainder of Land Commission Award 9971, Apana 9 to W. P. Leleiohoku to a point; |

Thence, following along Lot 6 and along the remainder of Land Commission Award 9971, Apana 9 to W. P. Leleiohoku on a curve to the right with a radius of 20.00 feet, the chord azimuth and distance being:

- | | | | |
|----|--------------|-------|------------------|
| 8. | 176° 09' 26" | 27.57 | feet to a point; |
|----|--------------|-------|------------------|

Thence, following along the Easterly side of Palani Road on a curve to the left with a radius of 270.00 feet, the chord azimuth and distance being:

- | | | | |
|----|--------------|-------|---|
| 9. | 212° 42' 41" | 65.99 | feet to the point of beginning and containing an area of 5.055 Acres. |
|----|--------------|-------|---|

All as shown on the map attached hereto, marked Exhibit "A" and by reference made a part hereof.

SECTION 2. In the event that any portion of this ordinance is declared invalid, such invalidity shall not affect the other parts of this ordinance.

SECTION 3. This ordinance shall take effect upon its approval.

INTRODUCED BY:

Robert A. Gadd (RT)
COUNCIL MEMBER, COUNTY OF HAWAII

Hilo, Hawaii

Date of Introduction: ~~December~~ 17, 1997
Date of 1st Reading: ~~December~~ 17, 1997
Date of 2nd Reading: February 4, 1998
Effective Date: February 17, 1998

REFERENCE: Comm. 574

APPROVED AS TO FORM AND LEGALITY

Patricia K. O'Neal
DEPUTY CORPORATION COUNSEL

DATED: FEB - 6 1998

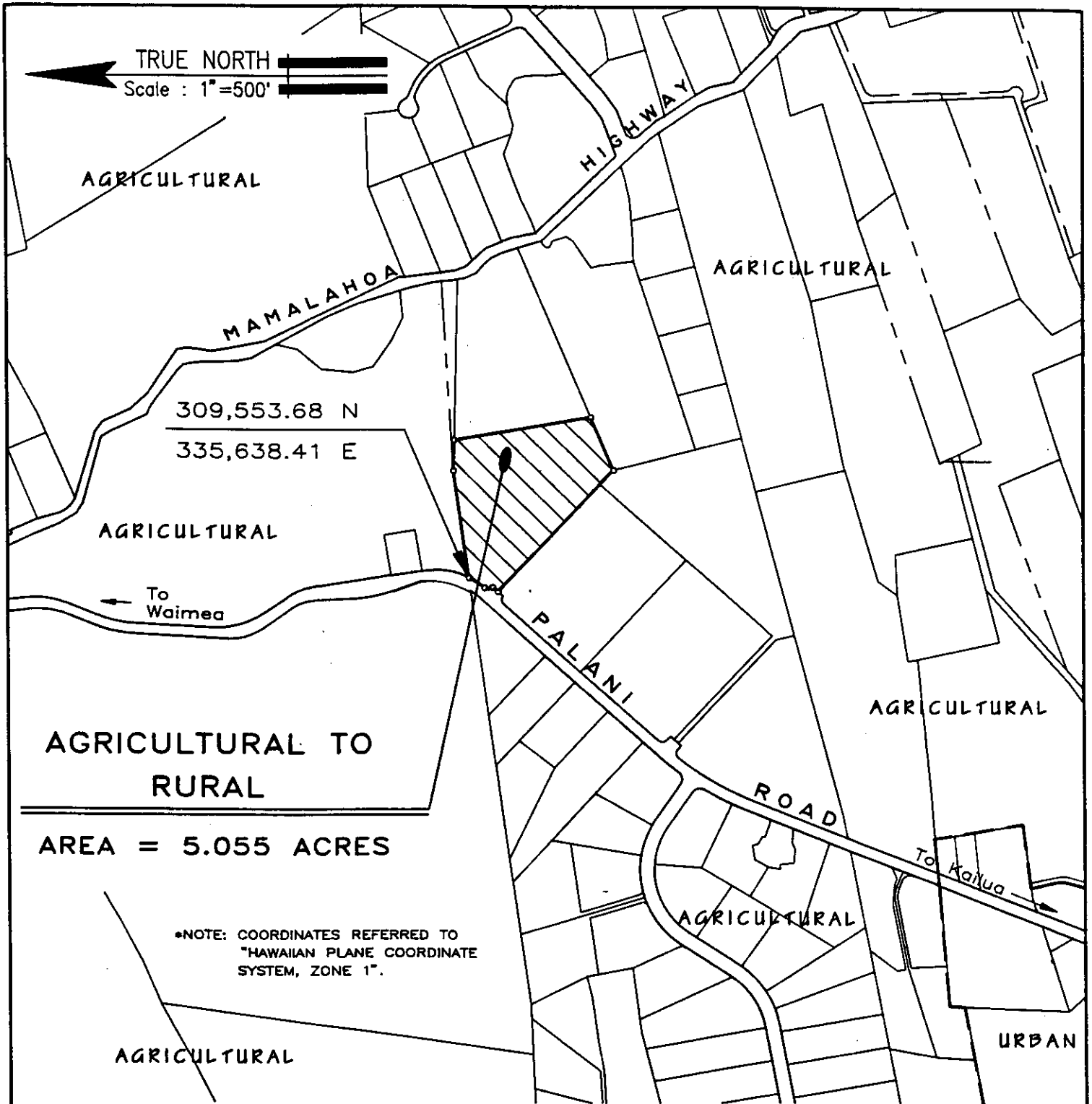

AMENDMENT TO THE STATE LAND USE BOUNDARIES MAP

AMENDING THE STATE LAND USE BOUNDARIES MAP, H-7, FOR THE COUNTY OF HAWAII, BY CHANGING THE DISTRICT CLASSIFICATION FROM THE AGRICULTURAL TO THE RURAL DISTRICT AT HONOKOHAU 2ND, NORTH KONA, HAWAII.

PREPARED BY : PLANNING DEPARTMENT
COUNTY OF HAWAII

TMK : 7-4-6:38

JULY 16, 1997

EXHIBIT "A"

(Malia Ohana Partnership)
(SLU)

OFFICE OF THE COUNTY CLERK
County of Hawaii
Hilo, Hawaii

Introduced By: Bobby Jean Leithead-Todd B/R
Date Introduced: December 17, 1997
First Reading: December 17, 1997
Published: N/A

REMARKS:

ROLL CALL VOTE				
	AYES	NOES	ABS	EX
Arakaki	X			
Chung	X			
Leithead-Todd	X			
Ray	X			
Reynolds	X			
Santangelo	X			
Smith	X			
Tyler		X		
Yagong			X	
	7	1	1	0

Second Reading: February 4, 1998
To Mayor: February 5, 1998
Returned: February 17, 1998
Effective: February 17, 1998
Published: February 24, 1998

REMARKS:
01/07/98 - Deferred.

ROLL CALL VOTE				
	AYES	NOES	ABS	EX
Arakaki	X			
Chung	X			
Leithead-Todd	X			
Ray	X			
Reynolds	X			
Santangelo	X			
Smith	X			
Tyler	X			
Yagong	X			
	9	0	0	0

I DO HEREBY CERTIFY that the foregoing BILL was adopted by the County Council and published as indicated above. APPROVED AS TO

FORM AND LEGALITY:

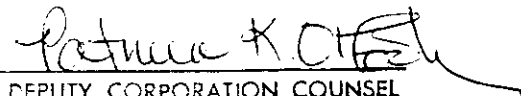
DEPUTY CORPORATION COUNSEL
COUNTY OF HAWAII
Date FEB - 6 1998

Approved/Disapproved this 17 day
of February 1998

MAYOR, COUNTY OF HAWAII

COUNCIL CHAIRMAN

COUNTY CLERK

Bill No.: 165
Reference: C-574/PC-81
Ord. No.: 98 7