

COUNTY OF HAWAII STATE OF HAWAII

BILL NO. 328

ORDINANCE NO. 99 23

AN ORDINANCE AMENDING THE STATE LAND USE BOUNDARIES MAP, H-25 FOR THE COUNTY OF HAWAII, BY CHANGING THE DISTRICT CLASSIFICATION FROM THE AGRICULTURAL TO THE URBAN DISTRICT AT PUUKAPU, WAIMEA, SOUTH KOHALA, HAWAII, COVERED BY TAX MAP KEY 6-4-1:PORTION OF 42.

BE IT ORDAINED BY THE COUNCIL OF THE COUNTY OF HAWAII:

SECTION 1. The State Land Use Boundaries Map, H-25 for the County of Hawaii, is amended to change the district classification of property described hereinafter as follows:

The district classification of the following area situated at Puukapu, Waimea, South Kohala, Hawaii shall be Urban:

Beginning at the Northwesterly corner of this parcel of land on the Easterly property line of Grant 4736 to Hee Akou, the coordinates of which refer to Government Survey Triangulation Station "WEST BASE" being 282.85 feet North and 1,516.08 feet East and running by azimuths measured clockwise from True South:

1. 239° 07' 404.02 feet along the remainders of Grant 4834 to Kahooahanohano and Grant 4564 to Kaanaana;

thence along the remainder of Grant 4564 to Kaanaana, on a curve to the left with a radius of 40.00 feet, the radial azimuth being 225° 00' and the chord azimuth and distance being;

- | | | | | | |
|-----|------|-----|-------|--------|---|
| 2. | 121° | 59' | 55.5" | 18.00 | feet; |
| | | | | | thence along the remainders of Grant 4564 to Kaanaana, Grant 4834 to Kahoohanohano and Grant 4564 to Kaanaana, on a curve to the right with a radius of 45.00 feet, the chord azimuth and distance being; |
| 3. | 239° | 07' | | 68.82 | feet; |
| | | | | | thence along the remainder of Grant 4564 to Kaanaana, on a curve to the left with a radius of 40.00 feet, the chord azimuth and distance being; |
| 4. | 349° | 10' | 34.5" | 27.44 | feet; |
| | | | | | thence along the remainder of Grant 4564 to Kaanaana, on a curve to the right with a radius of 325.00 feet, the chord azimuth and distance being; |
| 5. | 340° | 51' | 30" | 132.28 | feet; |
| 6. | 352° | 36' | | 61.20 | feet along the remainder of Grant 4564 to Kaanaana; |
| | | | | | thence along the remainder of Grant 4564 to Kaanaana on a curve to the left with a radius of 150.00 feet, the chord azimuth and distance being; |
| 7. | 250° | 51' | 30" | 61.05 | feet; |
| 8. | 239° | 07' | | 306.80 | feet along the remainder of Grant 4564 to Kaanaana; |
| 9. | 329° | 07' | | 210.87 | feet along Grant 4565 to H. Akona; |
| 10. | 70° | 21' | | 785.55 | feet along the remainders of Grant 4564 to Kaanaana and Grant 4834 to Kahoohanohano; |

11. 149° 07' 265.66 feet along Grant 4736 to Hee Akou to the point of beginning and containing an area of 4.613 Acres.

All as shown on the map attached hereto, marked Exhibit "A" and by reference made a part hereof.

SECTION 2. In the event that any portion of this ordinance is declared invalid, such invalidity shall not affect the other parts of this ordinance.

SECTION 3. This ordinance shall take effect upon its approval.

INTRODUCED BY:



COUNCIL MEMBER, COUNTY OF HAWAII

Hilo, Hawaii

Date of Introduction: November 18, 1998
Date of 1st Reading: November 18, 1998
Date of 2nd Reading: February 17, 1999
Effective Date: February 28, 1999
REFERENCE: Comm. 1048

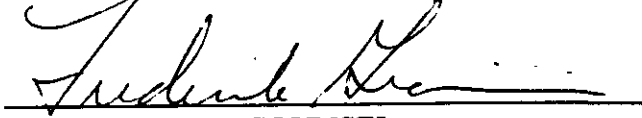
APPROVED AS TO FORM AND LEGALITY

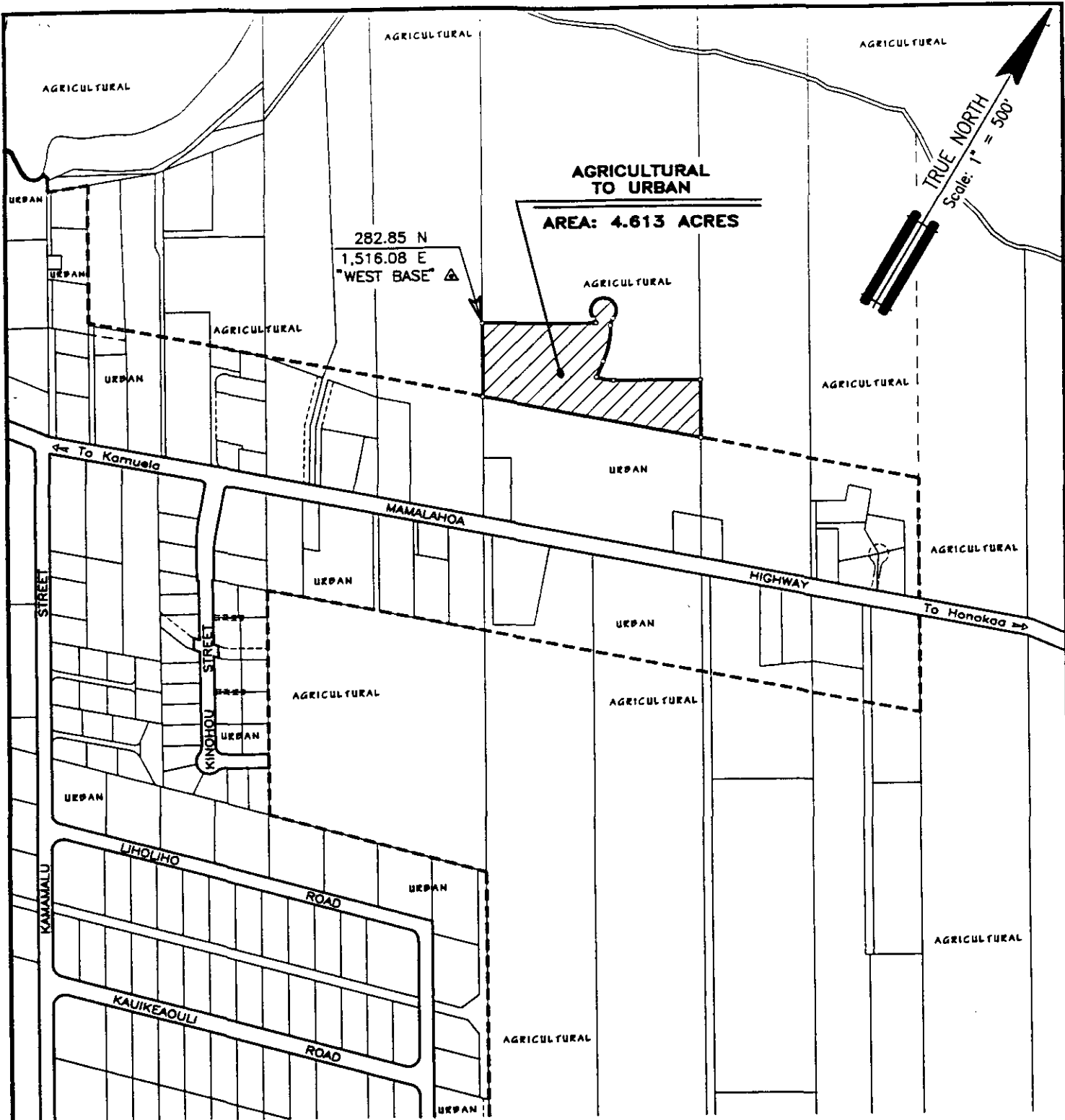
CORPORATION COUNSEL
DATED: 2/23/98



AMENDMENT TO THE STATE LAND USE BOUNDARIES MAP

AMENDING THE STATE LAND USE BOUNDARIES MAP, H-25, FOR THE COUNTY OF HAWAII, BY CHANGING THE DISTRICT CLASSIFICATION FROM THE AGRICULTURAL TO THE URBAN DISTRICT AT PUUKAPU, WAIMEA, SOUTH KOHALA, HAWAII.

PREPARED BY : PLANNING DEPARTMENT
COUNTY OF HAWAII



OFFICE OF THE COUNTY CLERK

County of Hawaii

Hilo, Hawaii

Introduced By: Bobby Jean Leithead-Todd (B/R)
 Date Introduced: November 18, 1998
 First Reading: November 18, 1998
 Published: N/A

REMARKS: _____

ROLL CALL VOTE				
	AYES	NOES	ABS	EX
Arakaki	X			
Chung	X			
Elarionoff	X			
Jacobson	X			
Leithead-Todd	X			
Pisicchio	X			
Smith	X			
Tyler	X			
Yagong	X			
	9	0	0	0

Second Reading: February 17, 1999
 To Mayor: February 19, 1999
 Returned: March 4, 1999
 Effective: February 28, 1999
 Published: March 10, 1999



REMARKS: Deferred - 12/23/98

ROLL CALL VOTE				
	AYES	NOES	ABS	EX
Arakaki	X			
Chung	X			
Elarionoff	X			
Jacobson	X			
Leithead-Todd	X			
Pisicchio	X			
Smith	X			
Tyler	X			
Yagong	X			
	9	0	0	0

I DO HEREBY CERTIFY that the foregoing BILL was adopted by the County Council published as indicated above.

APPROVED AS TO
 FORM AND LEGALITY:

 DEPUTY CORPORATION COUNSEL
 COUNTY OF HAWAII

Date 2/23/98

 COUNCIL CHAIRMAN

 COUNTY CLERK

Approved/Disapproved this 28 day
 of February, 1999

 MAYOR, COUNTY OF HAWAII

Bill No.: 328
 Reference: PC-160/C-1048
 Ord. No.: 99 23