

COUNTY OF HAWAII  STATE OF HAWAII

BILL NO. 58

ORDINANCE NO. 99 49

AN ORDINANCE AMENDING THE STATE LAND USE BOUNDARIES MAP, H-14 FOR THE COUNTY OF HAWAII, BY CHANGING THE DISTRICT CLASSIFICATION FROM THE AGRICULTURAL TO THE RURAL DISTRICT AT OULI, SOUTH KOHALA, HAWAII, COVERED BY TAX MAP KEY 6-2-11:6.

BE IT ORDAINED BY THE COUNCIL OF THE COUNTY OF HAWAII:

SECTION 1. The State Land Use Boundaries Map, H-14 for the County of Hawaii, is amended to change the district classification of property described hereinafter as follows:

The district classification of the following area situated at Ouli, South Kohala, Hawaii, shall be Urban:

Beginning at the Southwesterly corner of this parcel of land, being also the Southeasterly corner of Lot 5 and being a point on the Northerly side of Road Lot "B" of Anekona Estates, the coordinates of said point of beginning referred to Government Survey Triangulation Station "PUU PA" being 11,120.02 feet North and 16,049.54 feet West and running by azimuths measured clockwise from True South:

- |    |              |        |  |
|----|--------------|--------|--|
| 1. | 196° 23' 40" | 750.00 | feet along Lot 5 of Anekona Estates and along the remainder of Royal Patent 2237, Land Commission Award 8518-B, Apana 1 to James Young Kanehoa to a point; |
| 2. | 286° 23' 40" | 222.82 | feet along the Southerly side of Kawaihae-Waimea Road (F.A.P. No. NRH 11-C) to a point;  |
| 3. | 5° 39'       | 735.72 | feet along Lot 7 of Anekona Estates and along the remainder of Royal Patent 2237, Land Commission Award 8518-B, Apana 1 to James Young Kanehoa to a point; |

Thence, following along the Northerly side of Road Lot "B" of Anekona Estates on a curve to the right with a radius of 1,550.00 feet, the chord azimuth and distance being:

- 4. 101° 01' 20" 290.24 feet to a point;
- 5. 106° 23' 40" 71.02 feet along the Northerly side of Road Lot "B" of Anekona Estates to the point of beginning and containing an area of 5.0001 Acres.

All as shown on the map attached hereto, marked Exhibit "A" and by reference made a part hereof.

SECTION 2. In the event that any portion of this ordinance is declared invalid, such invalidity shall not affect the other parts of this ordinance.

SECTION 3. This ordinance shall take effect upon its approval.

INTRODUCED BY:

  
COUNCIL MEMBER, COUNTY OF HAWAII

Hilo, Hawaii

Date of Introduction: April 6, 1999  
Date of 1st Reading: April 6, 1999  
Date of 2nd Reading: April 21, 1999  
Effective Date: May 4, 1999

REFERENCE: Comm. ~~44.003~~

APPROVED AS TO FORM AND LEGALITY

  
CORPORATION COUNSEL

DATED: 4/26/99

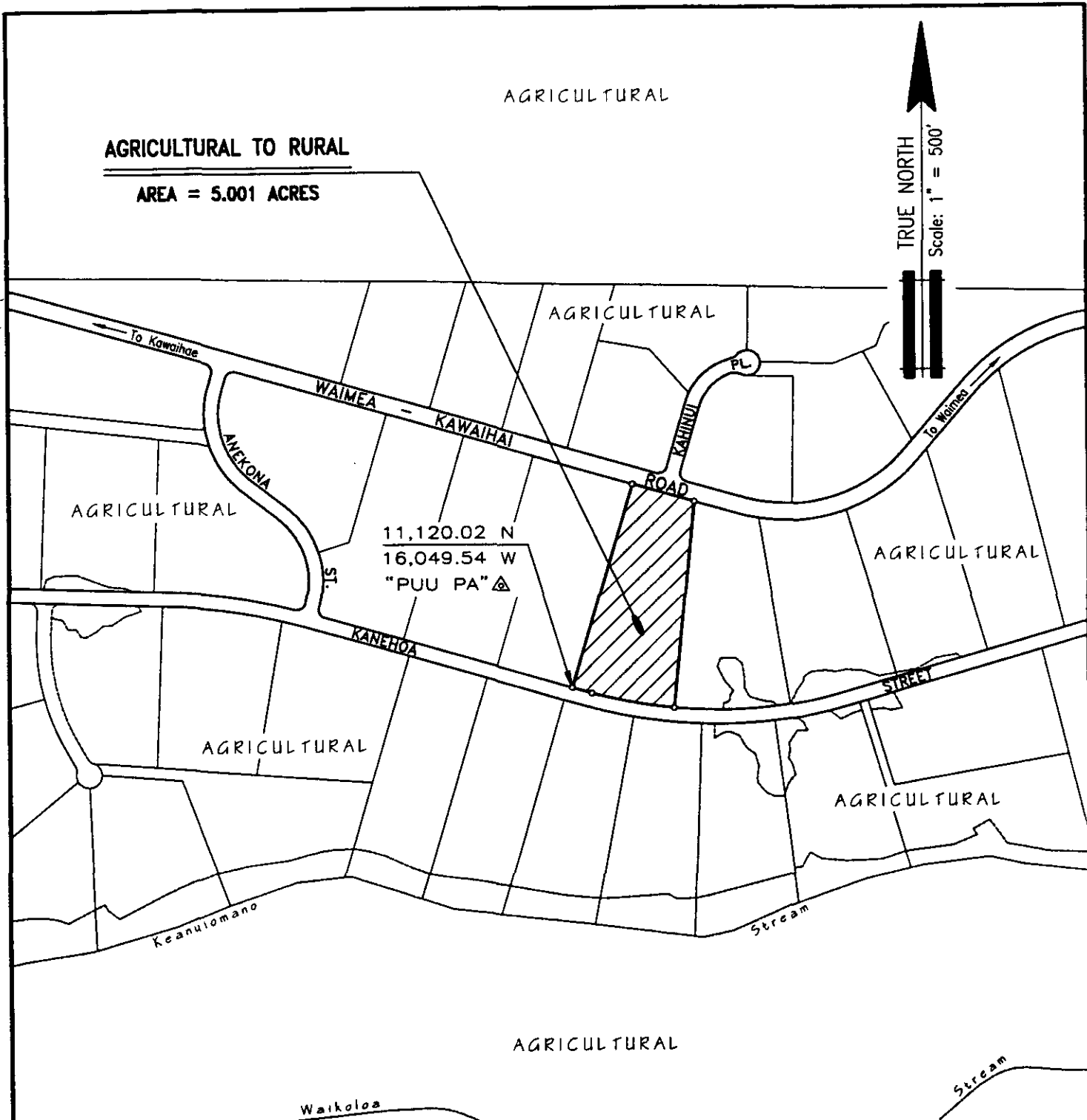

**AMENDMENT TO THE STATE LAND USE  
BOUNDARIES MAP**

AMENDING THE STATE LAND USE BOUNDARIES MAP, H-14 , FOR THE COUNTY OF HAWAII, BY CHANGING THE DISTRICT CLASSIFICATION FROM THE AGRICULTURAL TO THE RURAL DISTRICT AT OULI, SOUTH KOHALA, HAWAII.

PREPARED BY: PLANNING DEPARTMENT  
COUNTY OF HAWAII

OFFICE OF THE COUNTY CLERK  
County of Hawaii  
Hilo, Hawaii

Introduced By: Bobby Jean Leithead-Todd  
Date Introduced: April 6, 1999  
First Reading: April 6, 1999  
Published: N/A

REMARKS: \_\_\_\_\_  
\_\_\_\_\_  
\_\_\_\_\_  
\_\_\_\_\_

Second Reading: April 21, 1999  
To Mayor: April 23, 1999  
Returned: May 4, 1999  
Effective: May 4, 1999  
Published: May 19, 1999 (HTH & WHT)  
May 24, 1999 (RFD Publications)

REMARKS: \_\_\_\_\_  
\_\_\_\_\_  
\_\_\_\_\_  
\_\_\_\_\_

ROLL CALL VOTE				
	AYES	NOES	ABS	EX
Arakaki	X			
Chung	X			
Elarionoff	X			
Jacobson	X			
Leithead-Todd	X			
Pisicchio	X			
Smith	X			
Tyler	X			
Yagong	X			
	9	0	0	0

ROLL CALL VOTE				
	AYES	NOES	ABS	EX
Arakaki	X			
Chung	X			
Elarionoff	X			
Jacobson		X		
Leithead-Todd	X			
Pisicchio	X			
Smith	X			
Tyler	X			
Yagong	X			
	8	1	0	0

I DO HEREBY CERTIFY that the foregoing BILL was adopted by the County Council published as indicated above.

APPROVED AS TO  
FORM AND LEGALITY:  
Frederick Kinnear  
DEPUTY CORPORATION COUNSEL  
COUNTY OF HAWAII  
Date 4/26/99

[Signature]  
COUNCIL CHAIRMAN  
[Signature]  
COUNTY CLERK

Approved/Disapproved this 4 day  
of May, 19 99.

[Signature]  
MAYOR, COUNTY OF HAWAII

Bill No.: 58  
Reference: C-48.003  
Ord. No.: 99 49