

AN ORDINANCE AMENDING THE STATE LAND USE BOUNDARIES MAP, H-14 FOR THE COUNTY OF HAWAII, BY CHANGING THE DISTRICT CLASSIFICATION FROM THE AGRICULTURAL TO THE RURAL DISTRICT AT OULI, SOUTH KOHALA, HAWAII, COVERED BY TAX MAP KEY 6-2-11:5.

BE IT ORDAINED BY THE COUNCIL OF THE COUNTY OF HAWAII:

SECTION 1. The State Land Use Boundaries Map, H-14 for the County of Hawaii, is amended to change the district classification of property described hereinafter as follows:

The district classification of the following area situated at Ouli, South Kohala, Hawaii, shall be Rural:

Beginning at the Southeasterly corner of this parcel of land, being also the Southwesterly corner of Lot 6 of Anekona Estates and being a point on the Northerly side of Road Lot "B" of Anekona Estates, the coordinates of said point of beginning referred to Government Survey Triangulation Station "PUU PA" being 11,120.02 feet North and 16,049.54 feet West and running by azimuths measured clockwise from True South:

- 1. 106° 23' 40" 275.00 feet along the Northerly side of Road Lot "B" of Anekona Estates to a point;

Thence, for the next three (3) courses following along Lot 4 of Anekona Estates and along the remainder of Royal Patent 2237, Land Commission Award 8518-B, Apana 1 to James Young Kanehoa:

- 2. 196° 23' 40" 299.99 feet to a point;
- 3. 156° 02' 131.25 feet to a point;
- 4. 196° 23' 40" 350.00 feet to a point;
- 5. 286° 23' 40" 360.00 feet along the Southerly side of Kawaihae-Waimea Road (F.A.P. No. NRH 11-C) to a point;

6. 16° 23' 40" 750.00 feet along Lot 6 of Anekona Estates and along the remainder of Royal Patent 2237, Land Commission Award 8518-B, Apana 1 to James Young Kanehoa to the point of beginning and containing an area of 5.5154 Acres.

All as shown on the map attached hereto, marked Exhibit "A" and by reference made a part hereof.

SECTION 2. In the event that any portion of this ordinance is declared invalid, such invalidity shall not affect the other parts of this ordinance.

SECTION 3. This ordinance shall take effect upon its approval.

INTRODUCED BY:



COUNCIL MEMBER, COUNTY OF HAWAII

Hilo, Hawaii

Date of Introduction: April 21, 1999
Date of 1st Reading: April 21, 1999
Date of 2nd Reading: May 5, 1999
Effective Date: May 13, 1999

REFERENCE: Comm: 198

APPROVED AS TO FORM AND LEGALITY

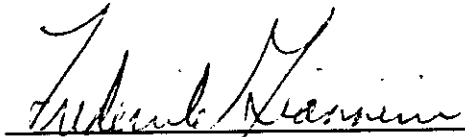

CORPORATION COUNSEL

DATED: 5/11/99

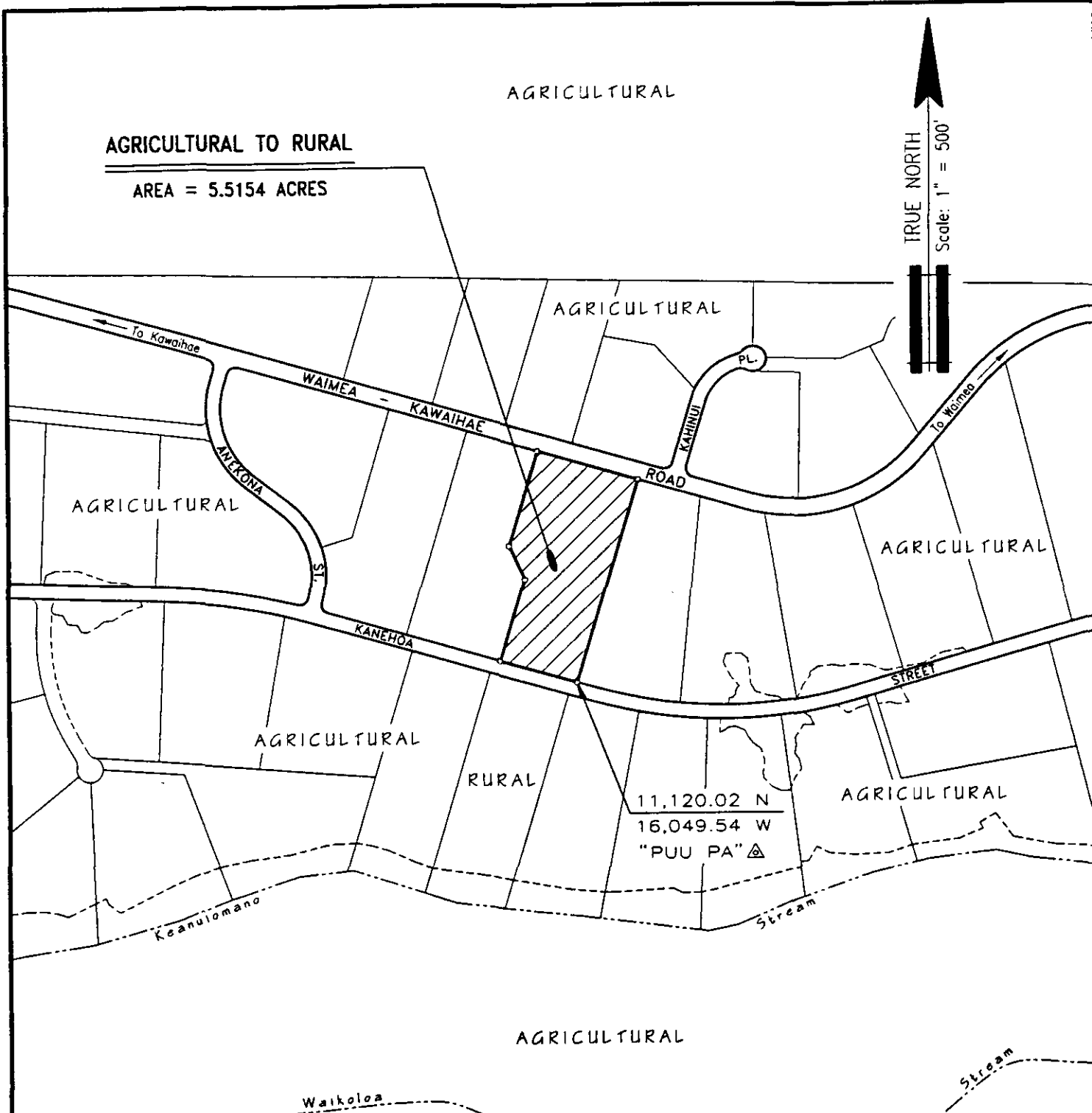

AMENDMENT TO THE STATE LAND USE
BOUNDARIES MAP

AMENDING THE STATE LAND USE BOUNDARIES MAP, H-14 , FOR THE COUNTY OF HAWAII, BY CHANGING THE DISTRICT CLASSIFICATION FROM THE AGRICULTURAL TO THE RURAL DISTRICT AT OULI, SOUTH KOHALA, HAWAII.

PREPARED BY: PLANNING DEPARTMENT
 COUNTY OF HAWAII

TMK : 6-2-11:05

FEBRUARY 26, 1999

(WILLIS C. MORRIS)

EXHIBIT "A"

OFFICE OF THE COUNTY CLERK

County of Hawaii

Hilo, Hawaii

99 MAY 14 AM 9 19

Introduced By: Bobby Jean Leithead-Todd
 Date Introduced: April 21, 1999
 First Reading: April 21, 1999
 Published: N/A

REMARKS: _____

Second Reading: May 5, 1999
 To Mayor: May 10, 1999
 Returned: May 14, 1999
 Effective: May 13, 1999
 Published: May 26, 1999 (HTH & WHT)
June 1, 1999 (RFD Publications)

REMARKS: _____

ROLL CALL VOTE				
	AYES	NOES	ABS	EX
Arakaki	X			
Chung			X	
Elarionoff	X			
Jacobson	X			
Leithead-Todd	X			
Pisicchio	X			
Smith	X			
Tyler	X			
Yagong	X			
	8	0	1	0

ROLL CALL VOTE				
	AYES	NOES	ABS	EX
Arakaki	X			
Chung	X			
Elarionoff	X			
Jacobson	X			
Leithead-Todd			X	
Pisicchio	X			
Smith	X			
Tyler	X			
Yagong	X			
	8	0	1	0

I DO HEREBY CERTIFY that the foregoing BILL was adopted by the County Council published as indicated above.

APPROVED AS TO
 FORM AND LEGALITY:
Fredrick Hansen
 DEPUTY CORPORATION COUNSEL
 COUNTY OF HAWAII

Date 5/11/99

John A. ...
 COUNCIL CHAIRMAN
...
 COUNTY CLERK

Approved/Disapproved this 13 day
 of May, 19 99

...
 MAYOR, COUNTY OF HAWAII

Bill No.: 53
 Reference: C-198/PC-13
 Ord. No.: 99 63