

ORDINANCE NO. 99 74

AN ORDINANCE AMENDING THE STATE LAND USE BOUNDARIES MAP, H-14 FOR THE COUNTY OF HAWAII, BY CHANGING THE DISTRICT CLASSIFICATION FROM THE AGRICULTURAL TO THE RURAL DISTRICT AT OULI, SOUTH KOHALA, HAWAII, COVERED BY TAX MAP KEY 6-2-11:27.

BE IT ORDAINED BY THE COUNCIL OF THE COUNTY OF HAWAII:

SECTION 1. The State Land Use Boundaries Map, H-14 for the County of Hawaii, is amended to change the district classification of property described hereinafter as follows:

The district classification of the following area situated at Ouli, South Kohala, Hawaii, shall be Rural:

Beginning at the Northwesterly corner of this parcel of land, being also the Northeasterly corner of Lot 28 of Anekona Estates and being a point on the Southerly end of existing Easement 22 for Road and Utility Purposes, the coordinates of said point of beginning referred to Government Survey Triangulation Station "PUU PA" being 10,780.59 feet North and 17,733.00 feet West and running by azimuths measured clockwise from True South:

Thence, for the next three (3) courses following along the remainder of Royal Patent 2237, Land Commission Award 8518-B, Apana 1 to James Young Kanehoa:

Thence, following along Lot 30 of Anekona Estates, and along the Southerly end of existing Easement 22 for Road and Utility Purposes on a curve to the left with a radius of 45.00 feet, the chord azimuth and distance being:

- 1. 224° 12' 03" 61.99 feet to a point;
- 2. 274° 38' 279.53 feet along Lot 26 of Anekona Estates to a point;

3. 339° 33' 473.85 feet along Lot 26 of Anekona Estates to a point;

Thence, for the next two (2) courses following along Government Land (State of Hawaii) and along the middle of Keanuiomano Stream, the direct azimuths and distances being:

4. 68° 07' 30" 196.62 feet to a point;  
5. 74° 06' 10" 293.36 feet to a point;  
6. 177° 44' 576.19 feet along Lot 28 of Anekona Estates and along the remainder of Royal Patent 2237, Land Commission Award 8518-B, Apana 1 to James Young Kanehoa to the point of beginning and containing an area of 5.002 Acres, more or less.

All as shown on the map attached hereto, marked Exhibit "A" and by reference made a part hereof.

SECTION 2. In the event that any portion of this ordinance is declared invalid, such invalidity shall not affect the other parts of this ordinance.

SECTION 3. This ordinance shall take effect upon its approval.

INTRODUCED BY:

  
COUNCIL MEMBER, COUNTY OF HAWAII

Hilo, Hawaii

Date of Introduction: May 25, 1999  
Date of 1st Reading: May 25, 1999  
Date of 2nd Reading: June 8, 1999  
Effective Date: June 16, 1999  
REFERENCE: Comm. 245

APPROVED AS TO FORM AND LEGALITY

\_\_\_\_\_  
CORPORATION COUNSEL

DATED: \_\_\_\_\_

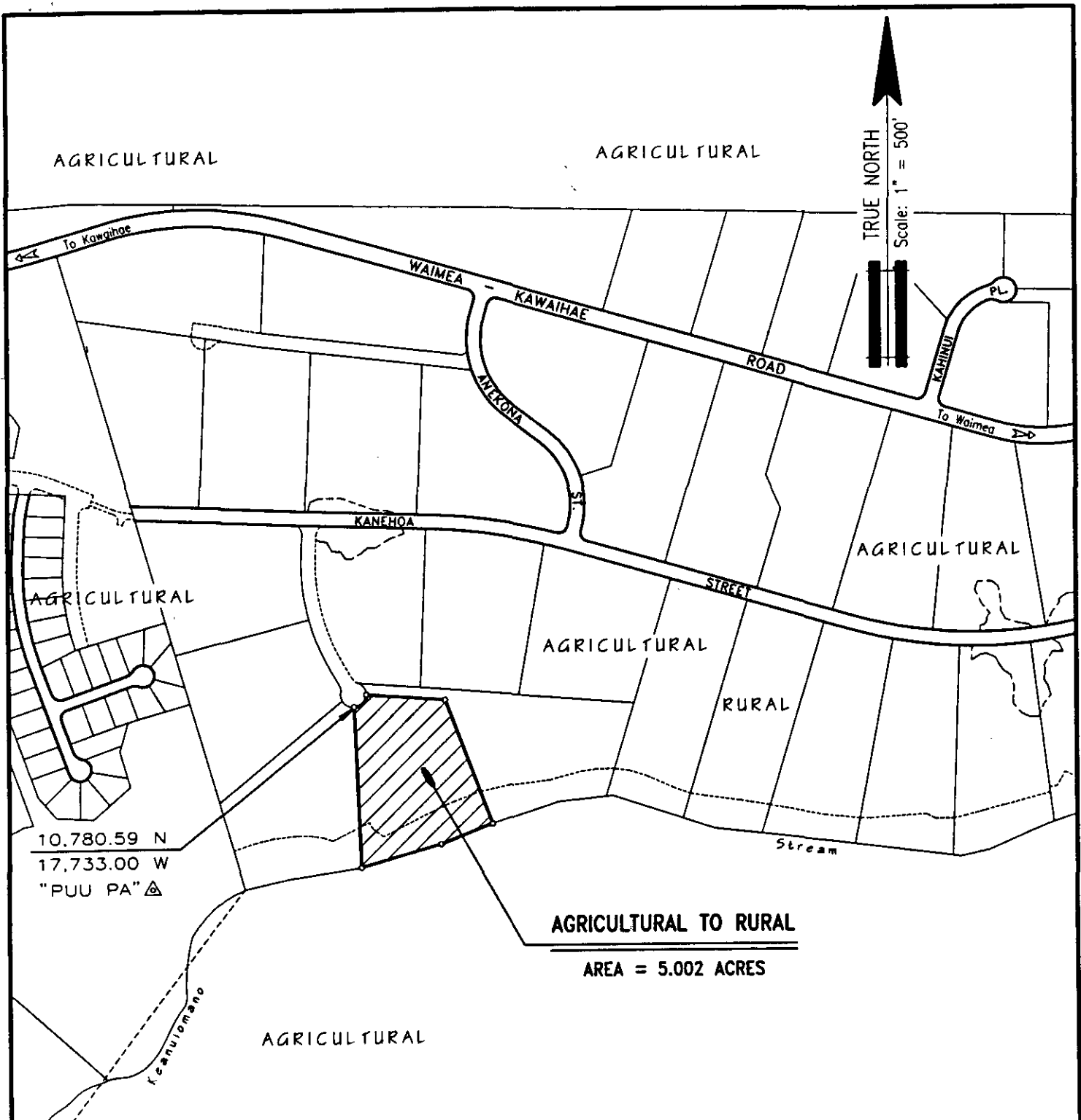

## AMENDMENT TO THE STATE LAND USE BOUNDARIES MAP

AMENDING THE STATE LAND USE BOUNDARIES MAP, H-14, FOR THE COUNTY OF HAWAII, BY CHANGING THE DISTRICT CLASSIFICATION FROM THE AGRICULTURAL TO THE RURAL DISTRICT AT OULI, SOUTH KOHALA, HAWAII.

PREPARED BY: PLANNING DEPARTMENT  
COUNTY OF HAWAII

OFFICE OF THE COUNTY CLERK  
 County of Hawaii  
Hilo, Hawaii

Introduced By: Bobby Jean Leithead-Todd  
 Date Introduced: May 25, 1999  
 First Reading: May 25, 1999  
 Published: N/A

REMARKS: \_\_\_\_\_  
 \_\_\_\_\_  
 \_\_\_\_\_  
 \_\_\_\_\_

Second Reading: June 8, 1999  
 To Mayor: June 10, 1999  
 Returned: June 16, 1999  
 Effective: June 16, 1999  
 Published: June 28, 1999

REMARKS: \_\_\_\_\_  
 \_\_\_\_\_  
 \_\_\_\_\_  
 \_\_\_\_\_

ROLL CALL VOTE				
	AYES	NOES	ABS	EX
Arakaki	X			
Chung	X			
Elarionoff	X			
Jacobson		X		
Leithead-Todd	X			
Pisicchio	X			
Smith	X			
Tyler	X			
Yagong	X			
	8			0

ROLL CALL VOTE				
	AYES	NOES	ABS	EX
Arakaki	X			
Chung	X			
Elarionoff	X			
Jacobson		X		
Leithead-Todd	X			
Pisicchio	X			
Smith	X			
Tyler	X			
Yagong	X			
	8	1	0	0

I DO HEREBY CERTIFY that the foregoing BILL was adopted by the County Council published as indicated above.

APPROVED AS TO  
 FORM AND LEGALITY:

[Signature]  
 DEPUTY CORPORATION COUNSEL  
 COUNTY OF HAWAII

Date 6/15/99

[Signature]  
 COUNCIL CHAIRMAN  
[Signature]  
 COUNTY CLERK

Approved/Disapproved this 16<sup>th</sup> day

of June, 1999.

[Signature]  
 MAYOR, COUNTY OF HAWAII

Bill No.: 65

Reference: C-245/PC-25

Ord. No.: 99 74