

ORDINANCE NO. 99 123

AN ORDINANCE AMENDING THE STATE LAND USE BOUNDARIES MAP, H-72 FOR THE COUNTY OF HAWAII, BY CHANGING THE DISTRICT CLASSIFICATION FROM THE AGRICULTURAL TO THE URBAN DISTRICT AT WAIAKAHIULA, PUNA, HAWAII, COVERED BY TAX MAP KEY 1-5-6:23.

BE IT ORDAINED BY THE COUNCIL OF THE COUNTY OF HAWAII:

SECTION 1. The State Land Use Boundaries Map, H-72 for the County of Hawaii, is amended to change the district classification of property described hereinafter as follows:

The district classification of the following area situated at Waiakahiula, Puna, Hawaii, shall be Urban:

All of that certain parcel of land (being portion(s) of the land(s) described in and covered by Part 2 of Land Patent Number 8095, Land Commission Award 11216, Apana 40 to Kekauonohi) situate, lying and being at Waiakahiula, Puna, Island and County of Hawaii, State of Hawaii, and thus bounded and described:

Beginning at a pipe at the south corner of this parcel of land and on the northeast side of Main Government Road, the coordinates of said point of beginning referred to Government Survey Triangulation Station "PAHOA" being 3,661.43 feet south and 5,222.94 feet east, thence running by azimuths measured clockwise from true South:

- | | | | |
|----|----------|--------|-----------------------------------------------------------------------------------------------------------|
| 1. | 124° 00' | 166.90 | feet along the northeast side of Main Government Road to a pipe; |
| 2. | 221° 33' | 157.40 | feet to a pipe; |
| 3. | 301° 01' | 124.51 | feet to a pipe; |
| 4. | 26° 20' | 163.99 | feet to the point of beginning and containing an area of 23,196 square feet or 0.5325 acre, more or less. |

All as shown on the map attached hereto, marked Exhibit "A" and by reference made a part hereof.

SECTION 2. In the event that any portion of this ordinance is declared invalid, such invalidity shall not affect the other parts of this ordinance.

SECTION 3. This ordinance shall take effect upon its approval.

INTRODUCED BY:

COUNCIL MEMBER, COUNTY OF HAWAII

Hilo, Hawaii

Date of Introduction: October 14, 1999

Date of 1st Reading: October 14, 1999

Date of 2nd Reading: October 27, 1999

Effective Date: November 1, 1999

REFERENCE: Comm. 429

APPROVED AS TO FORM AND LEGALITY

CORPORATION COUNSEL

DATED: 10/28/99

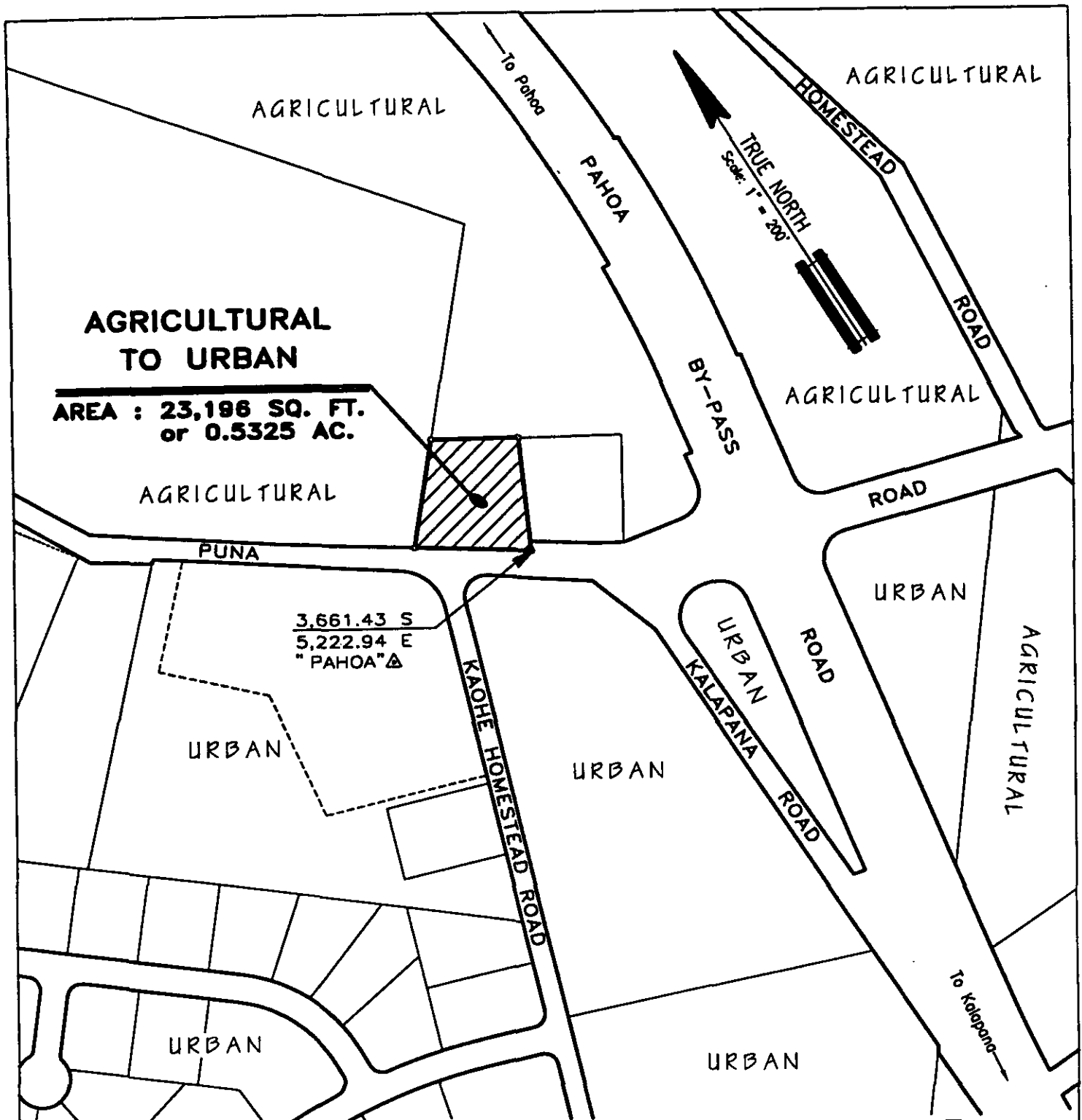

AMENDMENT TO THE STATE LAND USE BOUNDARIES MAP

AMENDING THE STATE LAND USE BOUNDARIES MAP, H-72, FOR THE COUNTY OF HAWAII,
 BY CHANGING THE DISTRICT CLASSIFICATION FROM THE AGRICULTURAL TO THE URBAN
 DISTRICT AT WAIKAKIULA, PUNA, HAWAII.

PREPARED BY : PLANNING DEPARTMENT
 COUNTY OF HAWAII

TMK : 1-5-6:23

AUGUST 9, 1999
 (RUTH W. WARD)

EXHIBIT "A"

OFFICE OF THE COUNTY CLERK

County of Hawaii

Hilo, Hawaii

Introduced By: Bobby Jean Leithead-Todd (B/R)
 Date Introduced: October 14, 1999
 First Reading: October 14, 1999
 Published: N/A

REMARKS: _____

Second Reading: October 27, 1999
 To Mayor: October 28, 1999
 Returned: November 1, 1999
 Effective: November 1, 1999
 Published: November 15, 1999

REMARKS: _____

ROLL CALL VOTE				
	AYES	NOES	ABS	EX
Arakaki	X			
Chung	X			
Elarionoff	X			
Jacobson	X			
Leithead-Todd	X			
Pisicchio	X			
Smith	X			
Tyler	X			
Yagong	X			
	9	0	0	0

ROLL CALL VOTE				
	AYES	NOES	ABS	EX
Arakaki	X			
Chung	X			
Elarionoff	X			
Jacobson	X			
Leithead-Todd	X			
Pisicchio	X			
Smith	X			
Tyler	X			
Yagong	X			
	9	0	0	0

I DO HEREBY CERTIFY that the foregoing BILL was adopted by the County Council published as indicated above.

APPROVED AS TO FORM AND LEGALITY:

Frederick Kamin
 DEPUTY CORPORATION COUNSEL
 COUNTY OF HAWAII

Date 10/29/99

Donna C. ...
 COUNCIL CHAIRMAN
[Signature]
 COUNTY CLERK

Approved/Disapproved this 1 day
 of Nov, 1999

Hugh Yamada
 MAYOR, COUNTY OF HAWAII

Bill No.: 124
 Reference: C-429/PC-57
 Ord. No.: 99 123