

COUNTY OF HAWAII STATE OF HAWAII

BILL NO. 189

ORDINANCE NO. 00 13

AN ORDINANCE AMENDING THE STATE LAND USE BOUNDARIES MAP, H-25 FOR THE COUNTY OF HAWAII, BY CHANGING THE DISTRICT CLASSIFICATION FROM THE AGRICULTURAL TO THE RURAL DISTRICT AT OULI, SOUTH KOHALA, HAWAII, COVERED BY TAX MAP KEY 6-2-11:11.

BE IT ORDAINED BY THE COUNCIL OF THE COUNTY OF HAWAII:

SECTION 1. The State Land Use Boundaries Map, H-25 for the County of Hawaii, is amended to change the district classification of property described hereinafter as follows:

The district classification of the following area situated at Ouli, South Kohala, Hawaii, shall be Rural:

Beginning at the southwest corner of this parcel of land, being the southeast corner of Lot 10 and on the northerly side of Road Lot "B", the coordinates of said point of beginning referred to Government Survey Triangulation Station "PUU PA" being 11,323.25 feet north and 14,342.86 feet west, thence running by azimuths measured clockwise from true south:

1. 166° 21' 27" 944.51 feet along Lot 10;
2. Thence along Kawaihae-Waimea Road (F.A.P. NRH 11-C), along a curve to the right with a radius of 686.30 feet, the chord azimuth and distance being:
248° 06' 10" 412.94 feet;
3. 359° 04' 49" 1,026.10 feet along Lot 12;
4. Thence along Road Lot "B", along a curve to the left with a radius of 1,350.00 feet, the chord azimuth and distance being:
76° 18' 20" 122.74 feet;
5. 73° 42' 60.00 feet along Road Lot "B" to the point

of beginning and containing an area of 6.7172 acres, more or less.

All as shown on the map attached hereto, marked Exhibit "A" and by reference made a part hereof.

SECTION 2. In the event that any portion of this ordinance is declared invalid, such invalidity shall not affect the other parts of this ordinance.

SECTION 3. This ordinance shall take effect upon its approval.

INTRODUCED BY:



COUNCIL MEMBER, COUNTY OF HAWAII

Hilo, Hawaii

Date of Introduction: January 20, 2000
Date of 1st Reading: January 20, 2000
Date of 2nd Reading: February 2, 2000
Effective Date: February 8, 2000

REFERENCE: Comm. 596

APPROVED AS TO FORM AND LEGALITY

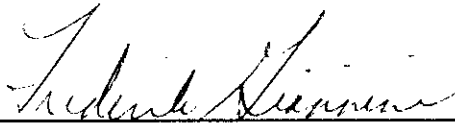

CORPORATION COUNSEL

DATED: 2/5/00

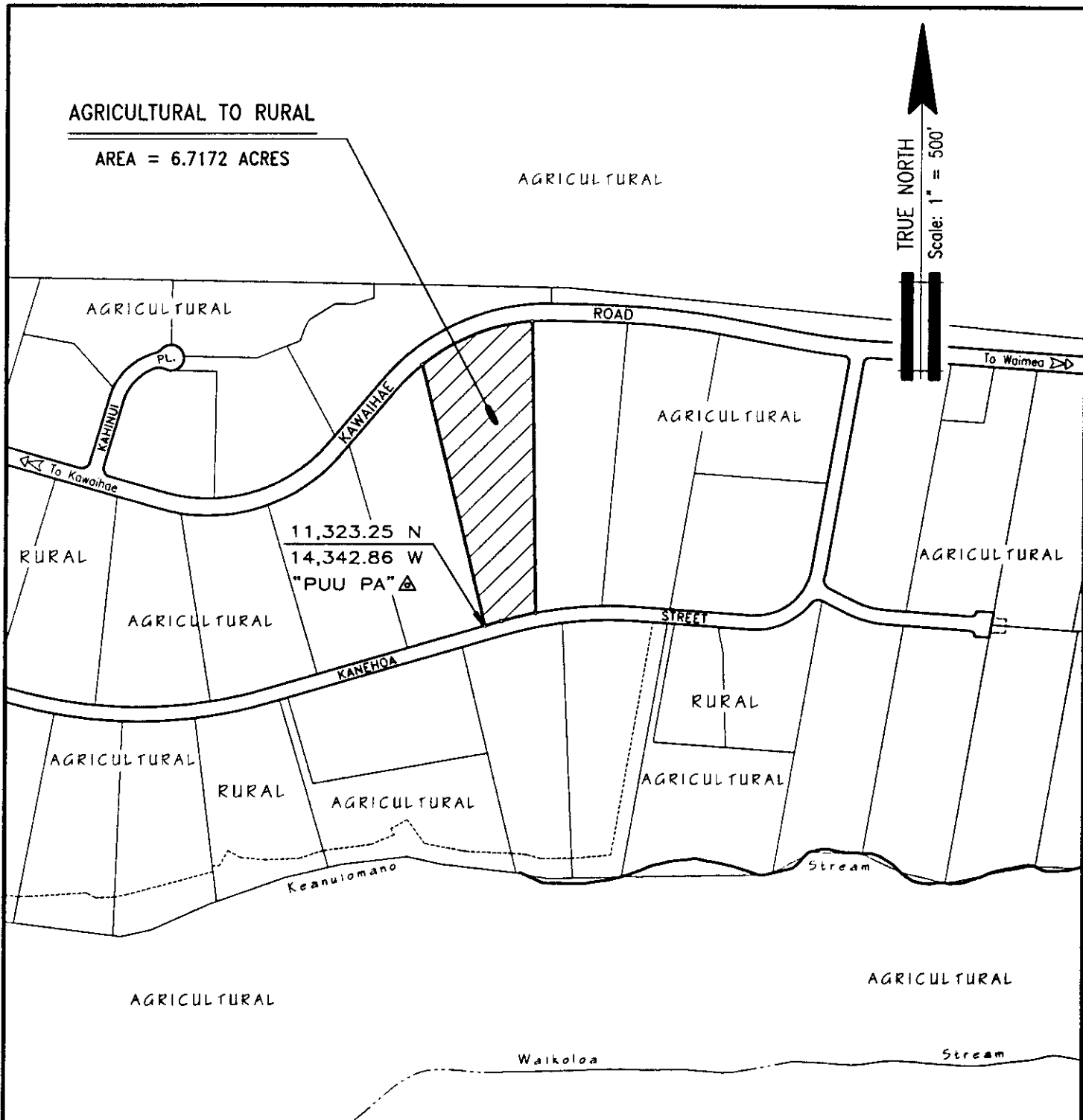

AMENDMENT TO THE STATE LAND USE BOUNDARIES MAP

AMENDING THE STATE LAND USE BOUNDARIES MAP, H-25, FOR THE COUNTY OF HAWAII, BY CHANGING THE DISTRICT CLASSIFICATION FROM THE AGRICULTURAL TO THE RURAL DISTRICT AT OULI, SOUTH KOHALA, HAWAII.

PREPARED BY: PLANNING DEPARTMENT
COUNTY OF HAWAII



OFFICE OF THE COUNTY CLERK
 County of Hawaii
 Hilo, Hawaii

RECEIVED

'00 FEB 10 AM 7 56

Introduced By: Bobby Jean Leithead-Todd
 Date Introduced: January 20, 2000
 First Reading: January 20, 2000
 Published: N/A

REMARKS: _____

Second Reading: February 2, 2000
 To Mayor: February 3, 2000
 Returned: February 10, 2000
 Effective: February 8, 2000
 Published: February 21, 2000



REMARKS: _____

ROLL CALL VOTE				
	AYES	NOES	ABS	EX
Arakaki	X			
Chung	X			
Elarionoff	X			
Jacobson		X		
Leithead-Todd			X	
Pisicchio	X			
Smith	X			
Tyler	X			
Yagong	X			
	7	1	1	0

ROLL CALL VOTE				
	AYES	NOES	ABS	EX
Arakaki	X			
Chung	X			
Elarionoff	X			
Jacobson		X		
Leithead-Todd			X	
Pisicchio	X			
Smith	X			
Tyler	X			
Yagong			X	
	6	1	2	0

I DO HEREBY CERTIFY that the foregoing BILL was adopted by the County Council published as indicated above.

APPROVED AS TO
 FORM AND LEGALITY:

 DEPUTY CORPORATION COUNSEL
 COUNTY OF HAWAII
 Date 2/5/00

 COUNCIL CHAIRMAN

 COUNTY CLERK

Approved/Disapproved this 8 day
 of February, 2000

 MAYOR, COUNTY OF HAWAII

Bill No.: 189
 Reference: C-596/PC-83
 Ord. No.: 00 13