

COUNTY OF HAWAI'I



STATE OF HAWAI'I

BILL NO. 258

ORDINANCE NO. 00 76

AN ORDINANCE AMENDING THE STATE LAND USE BOUNDARIES MAP, H-71 FOR THE COUNTY OF HAWAII, BY CHANGING THE DISTRICT CLASSIFICATION FROM THE AGRICULTURAL TO THE URBAN DISTRICT AT KEONEPOKO-IKI, PUNA, HAWAII, COVERED BY TAX MAP KEY 1-5-7:80.

BE IT ORDAINED BY THE COUNCIL OF THE COUNTY OF HAWAII:

SECTION 1. The State Land Use Boundaries Map H-71, for the County of Hawaii, is amended to change the district classification of property described hereinafter as follows:

The district classification of the following area situated at Keonepoko-Iki, Puna, Hawaii, shall be Urban:

Beginning at a pipe set at the Eastern corner of this parcel of land, also being on the Southwest right-of-way of the Keaau-Pahoa Road, the coordinates of said point of beginning referred to Government Survey Triangulation Station "PAHOA" being 1,120.28 feet North and 68.96 feet East and thence running by azimuths measured clockwise from true South:

- 1. 58° 50' 00" 810.20 feet along Lot 11 of Keonepoko Homesteads to a pipe found;
- 2. 148° 50' 00" 600.00 feet along lands of the State of Hawaii to a pipe found;
- 3. 238° 50' 00" 408.98 feet along Lot 15-B of Keonepoko Homesteads to a pipe set;
- 4. 328° 43' 00" 300.00 feet along Lot 13-A of Keonepoko Homesteads to a pipe found;
- 5. 238° 50' 00" 400.00 feet along same to a pipe found;

6. 328° 43' 00" 300.00 feet along the right-of-way of the Keaau-Pahoa Road to the point of beginning and containing an area of 8.397 acres more or less.

All as shown on the map attached hereto, marked Exhibit "A" and by reference made a part hereof.

SECTION 2. In the event that any portion of this ordinance is declared invalid, such invalidity shall not affect the other parts of this ordinance.

SECTION 3. This ordinance shall take effect upon its approval.

INTRODUCED BY:

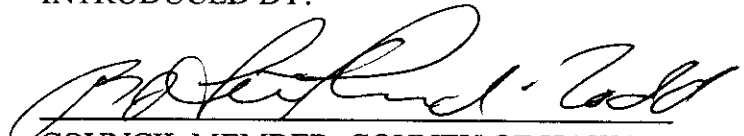
COUNCIL MEMBER, COUNTY OF HAWAII

Hilo, Hawaii

Date of Introduction: June 21, 2000

Date of 1st Reading: June 21, 2000

Date of 2nd Reading: July 7, 2000

REFERENCE: Comm. 776

Effective Date: July 18, 2000

APPROVED AS TO FORM AND LEGALITY

CORPORATION COUNSEL

DATED: _____

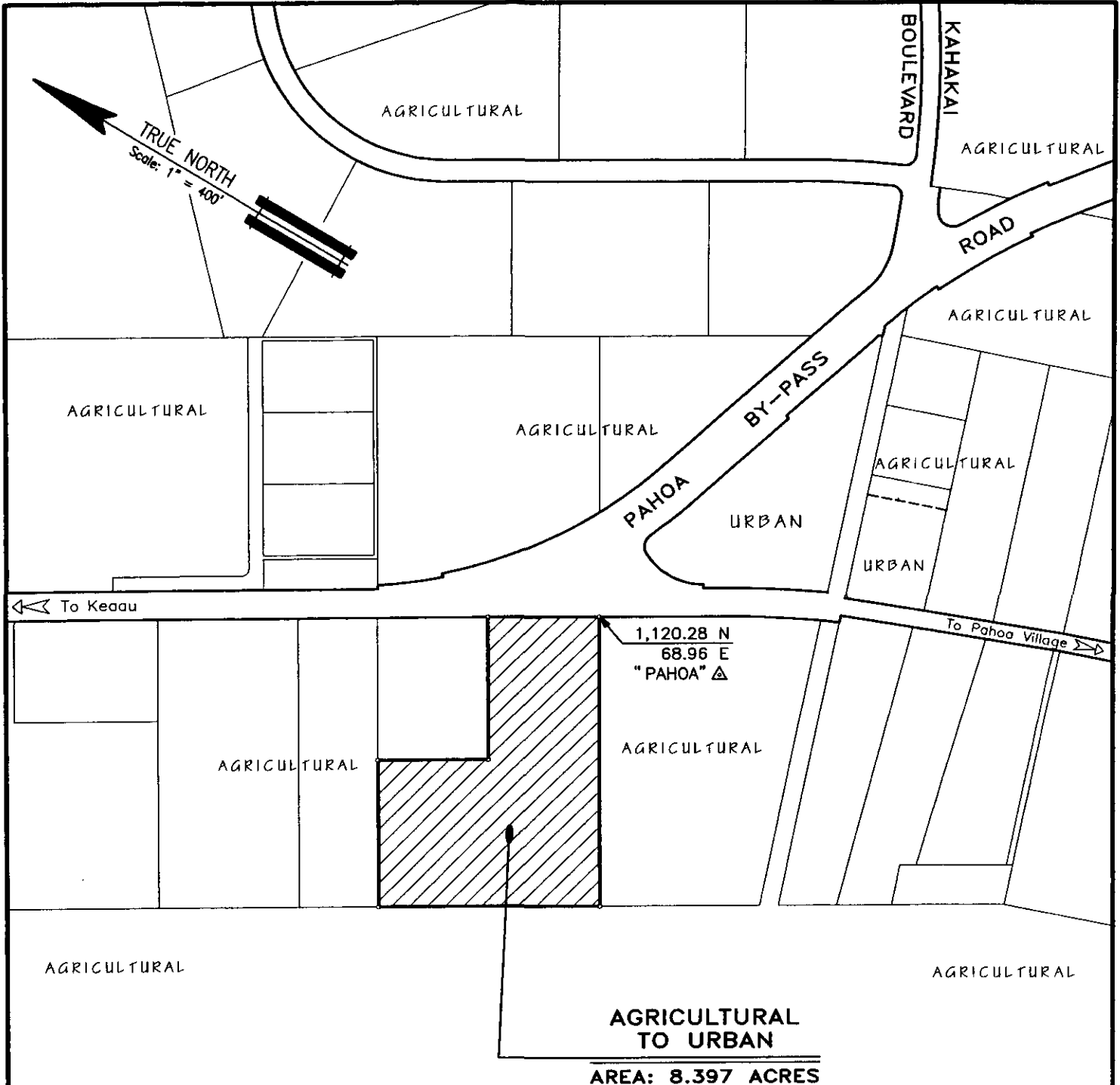

AMENDMENT TO THE STATE LAND USE BOUNDARIES MAP

AMENDING THE STATE LAND USE BOUNDARIES MAP, H-71, FOR THE COUNTY OF HAWAII, BY CHANGING THE DISTRICT CLASSIFICATION FROM THE AGRICULTURAL TO THE URBAN DISTRICT AT KEONEPOKO-IKI, PUNA, HAWAII.

PREPARED BY : PLANNING DEPARTMENT
COUNTY OF HAWAII



OFFICE OF THE COUNTY CLERK
 County of Hawaii
 Hilo, Hawaii

Introduced By: Ms. Leithead-Todd
 Date Introduced: June 21, 2000
 First Reading: June 21, 2000
 Published: N/A

REMARKS: _____

Second Reading: July 7, 2000
 To Mayor: July 11, 2000
 Returned: July 18, 2000
 Effective: July 18, 2000
 Published: July 31, 2000

REMARKS: _____

RECEIVED

ROLL CALL VOTE				
*00 JUL 18	AYES	NOES	ABS	EX
Arakaki	X			
Chung	X			
Elarionoff	X			
Jacobson	X			
Leithead-Todd	X			
Pisicchio	X			
Smith	X			
Tyler	X			
Yagong	X			
	9	0	0	0



ROLL CALL VOTE				
	AYES	NOES	ABS	EX
Arakaki	X			
Chung			X	
Elarionoff	X			
Jacobson	X			
Leithead-Todd	X			
Pisicchio	X			
Smith	X			
Tyler	X			
Yagong	X			
	8	0	1	0

I DO HEREBY CERTIFY that the foregoing BILL was adopted by the County Council published as indicated above.

APPROVED AS TO
 FORM AND LEGALITY:

 DEPUTY CORPORATION COUNSEL
 COUNTY OF HAWAII

Date 7/17/00

 COUNCIL CHAIRMAN

 COUNTY CLERK

Approved/Disapproved this 18 day
 of July, 2000.

 MAYOR, COUNTY OF HAWAII

Bill No.: 258
 Reference: C-776/PC-99
 Ord. No.: 00 76