

COUNTY OF HAWAII STATE OF HAWAII

BILL NO. 282

ORDINANCE NO. 00 94

AN ORDINANCE AMENDING THE STATE LAND USE BOUNDARIES MAP, H-14 FOR THE COUNTY OF HAWAII, BY CHANGING THE DISTRICT CLASSIFICATION FROM THE AGRICULTURAL TO THE RURAL DISTRICT AT OULI, SOUTH KOHALA, HAWAII, COVERED BY TAX MAP KEY 6-2-11:36.

BE IT ORDAINED BY THE COUNCIL OF THE COUNTY OF HAWAII:

SECTION 1. The State Land Use Boundaries Map, H-14 for the County of Hawaii, is amended to change the district classification of property described hereinafter as follows:

The district classification of the following area situated at Ouli, South Kohala, Hawaii, shall be Rural:

Beginning at the northeast corner of this parcel of land, being the north corner of Road Lot "A" and on the southerly side of Kawaihae-Waimea Road (F.A.P. NRH 11-C), the coordinates of said point of beginning referred to Government Survey Triangulation Station "PUU PA" being 12,276.13 feet North and 17,321.87 feet West, thence running by azimuths measured clockwise from True South:

1. Following along Road Lot "A", along a curve to the right with a radius of 30.00 feet, the chord azimuth and distance being:
331° 23' 40" 42.43 feet;
2. 16° 23' 40" 45.00 feet along Road Lot "A";
3. Thence along Road Lot "A", along a curve to the left with a radius of 350.00 feet, the chord azimuth and distance being:
5° 24' 08.5" 133.47 feet;
4. Thence along Lot 33, along a curve to the right with a radius of 20.00 feet, the chord azimuth and distance being:
45° 42' 18.5" 31.22 feet;
5. 97° 00' 708.64 feet along Lot 33;

6. 182° 20' 357.03 feet along Lot 33;
7. Thence along Kawaihae-Waimea Road (F.A.P. NRH 11-C), along a curve to the right with a radius of 1,116.00 feet, the chord azimuth and distance being:
284° 26' 40" 75.95 feet;
8. 286° 23' 40" 669.80 feet along Kawaihae-Waimea Road (F.A.P. NRH 11-C) to the point of beginning and containing an area of 5.0014 Acres.

All as shown on the map attached hereto, marked Exhibit "A" and by reference made a part hereof.

SECTION 2. In the event that any portion of this ordinance is declared invalid, such invalidity shall not affect the other parts of this ordinance.

SECTION 3. This ordinance shall take effect upon its approval.

INTRODUCED BY:



COUNCIL MEMBER, COUNTY OF HAWAII

Hilo, Hawaii

Date of Introduction: August 9, 2000
Date of 1st Reading: August 9, 2000
Date of 2nd Reading: August 23, 2000
Effective Date: September 1, 2000

REFERENCE: Comm. 843

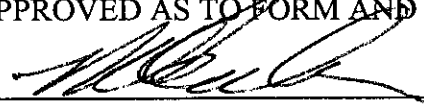
APPROVED AS TO FORM AND LEGALITY

CORPORATION COUNSEL
DATED: AUG 30 2000

12,276.13 N
 17,321.87 W
 "PUU PA" \triangle

AGRICULTURAL TO RURAL

AREA = 5.0014 ACRES
 AGRICULTURAL

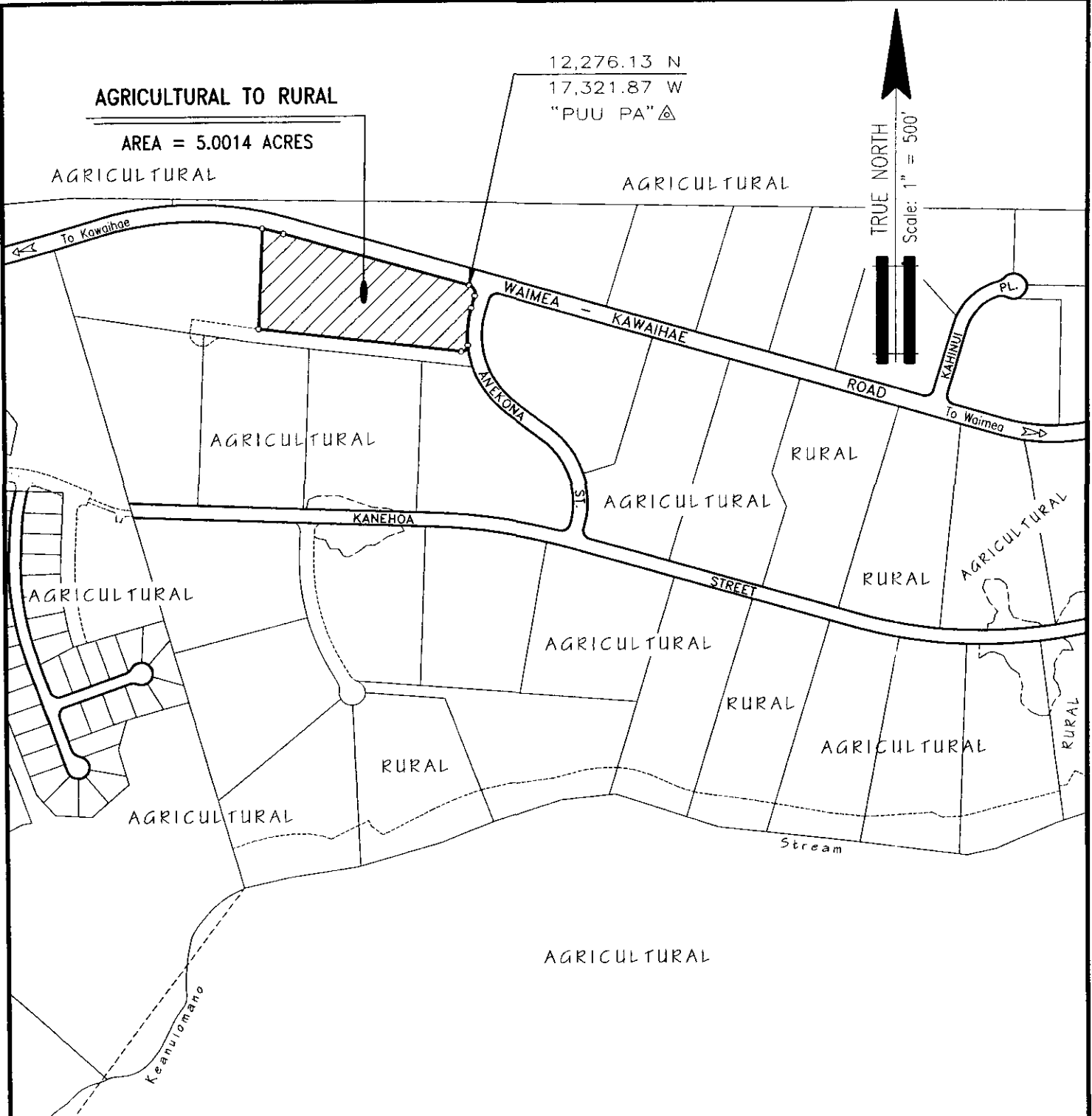
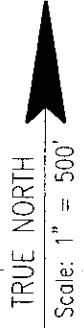

AMENDMENT TO THE STATE LAND USE
BOUNDARIES MAP

AMENDING THE STATE LAND USE BOUNDARIES MAP, H-14 , FOR THE COUNTY OF HAWAII, BY CHANGING THE DISTRICT CLASSIFICATION FROM THE AGRICULTURAL TO THE RURAL DISTRICT AT OULI, SOUTH KOHALA, HAWAII.

PREPARED BY: PLANNING DEPARTMENT
 COUNTY OF HAWAII



OFFICE OF THE COUNTY CLERK
 County of Hawaii
 Hilo, Hawaii

Introduced By: Bobby Jean Leithead-Todd
 Date Introduced: August 9, 2000
 First Reading: August 9, 2000
 Published: N/A

REMARKS: _____

Second Reading: August 23, 2000
 To Mayor: August 25, 2000
 Returned: September 5, 2000
 Effective: September 1, 2000
 Published: September 18, 2000

REMARKS: _____

ROLL CALL VOTE				
	AYES	NOES	ABS	EX
Arakaki	X			
Chung			X	
Elarionoff	X			
Jacobson		X		
Leithead-Todd	X			
Pisicchio	X			
Smith	X			
Tyler	X			
Yagong	X			
	7	1	1	0

ROLL CALL VOTE				
	AYES	NOES	ABS	EX
Arakaki	X			
Chung	X			
Elarionoff	X			
Jacobson		X		
Leithead-Todd	X			
Pisicchio	X			
Smith	X			
Tyler	X			
Yagong	X			
	8	1	0	0

I DO HEREBY CERTIFY that the foregoing BILL was adopted by the County Council published as indicated above.

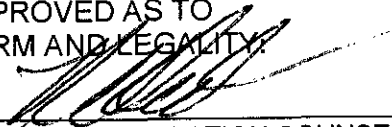
APPROVED AS TO
 FORM AND LEGALITY:

 DEPUTY CORPORATION COUNSEL
 COUNTY OF HAWAII
 Date AUG 30 2000

 COUNCIL CHAIRMAN

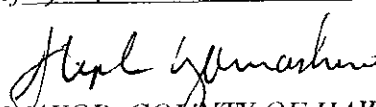
 COUNTY CLERK

Approved/Disapproved this 18 day
 of September, 2000.

 MAYOR, COUNTY OF HAWAII

Bill No.: 282
 Reference: C-843/PC-107
 Ord. No.: 00 94